

B.M. "B" R.D.L.B. 921.49 ELEV. 159.085
Mills Ave. & Trumbull St. m.w.d. "N2 173"
Spr. in ld. in c.b. ± 7' N. c.b. return
at N.W. corner.
SANTA FE QUAD 1955

IF INTERFERING PORTION OF CHAIN LINK FENCE ALONG THE SOUTH SIDE OF MILLS AVE. HAS TO BE REMOVED FOR CONSTRUCTION PURPOSE, THE CONTRACTOR MUST OBTAIN PERMISSION FROM THE OWNER AND FENCE MUST BE REPLACED AT HIS OWN EXPENSE TO THE SATISFACTION OF THE OWNER BEFORE THE PROJECT IS ACCEPTED.
ALL CONCRETE SIDEWALK BROKEN DURING CONSTRUCTION MUST BE REPLACED PER L. A. COUNTY ROAD DEPARTMENT REQUIREMENTS.

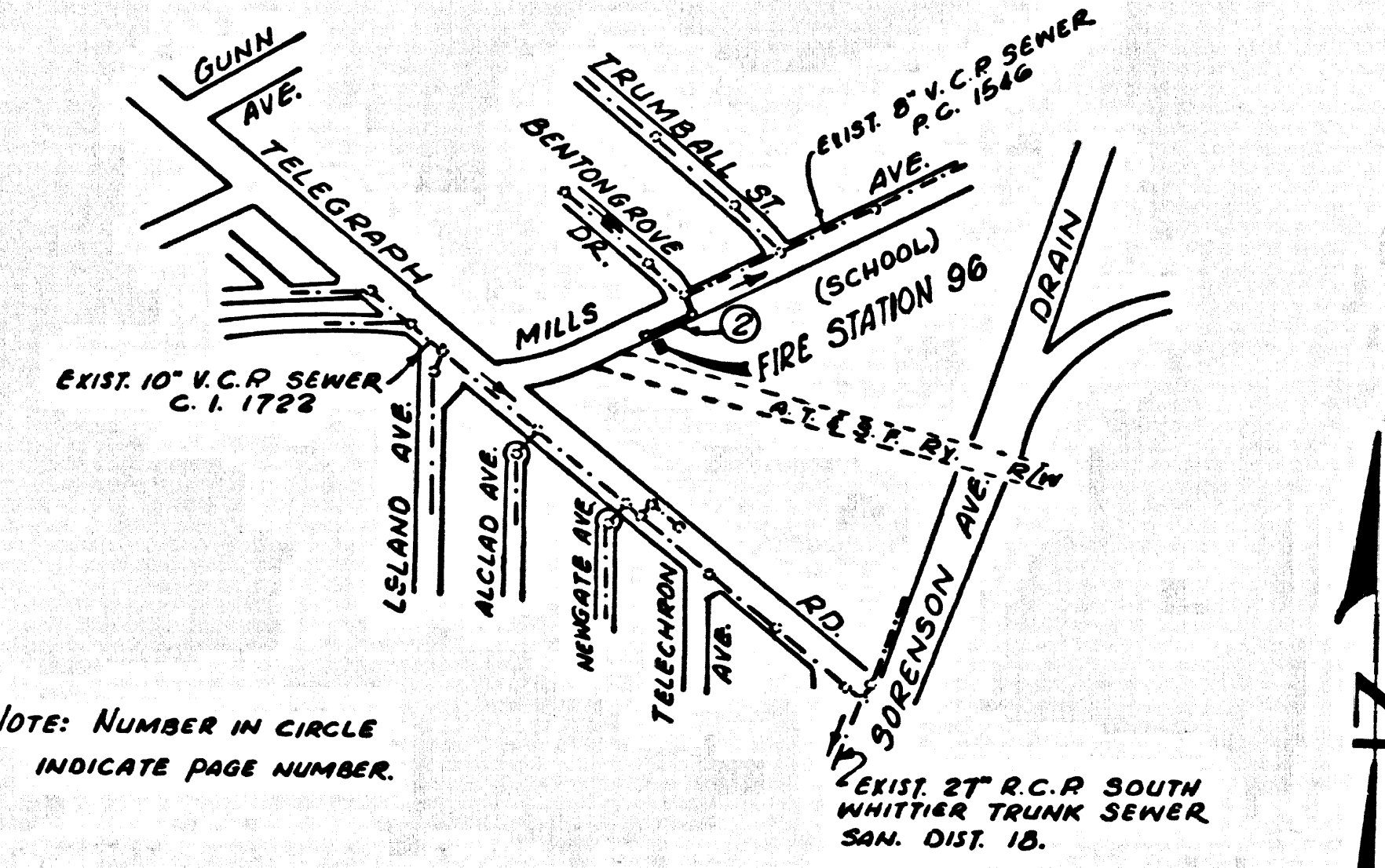

No connections for the disposal of industrial wastes shall be made to sewers shown on these drawings without written permission from the Chief Engineer and General Manager of the County Sanitation Districts.
County Sanitation Districts shall be notified prior to the following so that required inspections can be made (Phone 237-1025 - 636-3097)
Acceptance of the project.

INDEX MAP
FIRE STATION 96 C.C. 8409
SCALE: 1"=600'

WHITTIER BUILDING DISTRICT No. 11

J. N. 0802.79

PAGE 1

CASH CONTRACT NO. 8409
PROFILE, ALIGNMENT AND GRADE OF
SANITARY SEWERS (42004)
TO BE CONSTRUCTED FOR
FIRE STATION 96
1 SHEET 2 PAGES

SCALE VERT. 1"=4'
HORIZ. 1"=20'
FEBRUARY 1970
COUNTY OF LOS ANGELES, CALIFORNIA

JOHN A. LAMBIE COUNTY ENGINEER
APPROVED BY [Signature] 2-11-70
ASSISTANT SANITATION DISTRICT ENGINEER

DESIGNED BY [Signature]
CONSOLIDATED FIRE PROTECTION DISTRICT
APPROVED BY [Signature]

NOTES:
WORK SHALL BE CONSTRUCTED ACCORDING TO STANDARD SPECIFICATIONS FOR PUBLIC WORKS CONSTRUCTION AND COUNTY ENGINEER SPECIAL ORDINANCES FOR THE CONSTRUCTION OF SANITARY SEWERS DATED JAN. 2, 1969, AS REVISED, AND SHALL BE PROSECUTED IN THE PRESENCE OF THE COUNTY ENGINEER. GRADES TO WHICH THIS IMPROVEMENT IS TO BE CONSTRUCTED ARE SHOWN ON PLANS AND PROFILE. GRADE POINTS FOR TOP OF CURB, CENTER LINE OF STREET OR CENTER LINE OF ALLEY ARE SHOWN BY CIRCLES ON PROFILES AT ALL POINTS BETWEEN DESIGNATED POINTS.
ELEVATIONS ARE IN FEET ABOVE U.S.C. & G.S. SEA LEVEL DATUM OF 1929. UNIT PRICES FOR ADDITIONAL WORK WHICH MAY BE REQUIRED BUT WHICH CANNOT BE ASCERTAINED IN ADVANCE, SHALL BE SUBMITTED IN THE PROPOSAL.
THIS DRAWING AND THE DATA HEREON ARE HEREBY MADE A PART OF THE SPECIFICATIONS.

LAYOUT	MANDA	FEB. 1970	UNDERGROUND	
TRACED	MANDA	FEB. 1970	BENCH MARKS	I. J. BOWLES FEB-11-70
CHECKED	YEN	FEB. 1970	MAINTENANCE	C. PEARSON FEB-11-70
F. B. 3915			INSPECTOR	
A. B.			RECORD PLANS	

- USE EXTRA STRENGTH PIPE ALL PIPE IS STANDARD DEPTH.
- VITRIFIED CLAY PIPE JOINTS SHALL BE TYPE "C", 8" x 3" PER STD. SPECS., SEC. 208-B.
- ALL STRUCTURES SHALL BE BRICK MANHOLES.
- USE STANDARD MANHOLE FRAMES AND COVERS, EXCEPT AS NOTED.
- SEWERS TO BE TESTED FOR LEAKAGE PER SEC. 208-2.8.7 OF STD. SPECS.
- CONCRETE-MANHOLE-SIDEWALK-SWITCHES-AT-PUBLIC-USE-OR-CONSUMER-USE-OR-CHURCH-OR-SCHOOL-OR-OTHER-SIMILAR-USE-OR-OTHER-USE-AT-100'-0" OR DEEPER.
- PROFILES IN CURVES AT ENDS OF HOUSE LATERALS INDICATE DEPTH BELOW CURB SHALL BE GRADE OF SEWER LINE.
- PROFILES IN STRAIGHTS AT ENDS OF HOUSE LATERALS INDICATE DEPTH BELOW CURB SHALL BE GRADE OF SEWER LINE.
- PROFILES IN CURVES AT ENDS OF HOUSE LATERALS INDICATE DEPTH BELOW CURB SHALL BE GRADE OF SEWER LINE.
- PROFILES IN STRAIGHTS AT ENDS OF HOUSE LATERALS INDICATE DEPTH BELOW CURB SHALL BE GRADE OF SEWER LINE.
- ALL HOUSE LATERALS SHALL BE CONSTRUCTED IN A STRAIGHT ALIGNMENT AT RIGHT ANGLES FROM THE MAIN LINE SEWER EXCEPT AS SHOWN ON THE PLANS. HOUSE LATERALS FROM CHIMNEYS SHALL NOT HAVE AN ANGLE OF LESS THAN 45 DEGREES WITH THE MAIN LINE SEWER.
- THE CONTRACTOR SHALL NOTIFY THE CONSTRUCTION DIVISION BY TELEPHONE MADISON 9-470, EXT. 81561 AT LEAST 24 HOURS BEFORE STARTING ANY WORK UNDER THIS CONTRACT.
- CONSTRUCTION IN STATE HIGHWAYS SHALL CONFORM WITH STATE HIGHWAY PERMIT AND THE CONTRACTOR SHALL PAY ALL COSTS IN CONNECTION THEREWITH.
- ALL STATE AND LOCAL TRENCH SAFETY ORDERS WILL BE RIGIDLY ENFORCED.
- RESURFACING SCHEDULE: RESURFACE TRENCH WITHIN PAVED AREA WITH BRICK ROCK AND OR 1.5 INCHES IN THICKNESS ON 12 INCHES OF AGGREGATE BASE MATERIALS. CONTRACTOR MUST COMPLY WITH ALL L. A. COUNTY ROAD DEPT. CONSTRUCTION AND TRAFFIC REQUIREMENTS.
- ALL CAST IRON SEWER PIPE AND JOINTS SHALL BE IN ACCORDANCE WITH SEC. 207.31(b) AND 207.37 OF THE SPEC. PROVISIONS AND 306-2.3.4(4,d,e) OF THE STD. SPECS.
- THE CONTRACTOR SHALL OBTAIN A FEE-EXEMPT CONSTRUCTION PERMIT FROM THE BELLFLOWER OFFICE 9557 E. FLOWER ST., BELLFLOWER, CALIFORNIA.
- THE CONTRACTOR SHALL OBTAIN A FEE-EXEMPT ROAD PERMIT FROM THE LOS ANGELES COUNTY ROAD DEPT.
- ALL CONCRETE CROSS CUTTERS, CURBS, GUTTERS, PAVEMENT, AND DRIVEWAYS SHALL BE TUNNELED OR JACED PER LOS ANGELES COUNTY ROAD DEPARTMENT REQUIREMENTS.
- THE FOLLOWING LATEST REVISED STANDARD PLANS ON FILE IN THE OFFICE OF COUNTY ENGINEER SHALL APPLY IN THE CONSTRUCTION OF THIS PROJECT:

ABANDON THE EXISTING SEPTIC TANK, CESSPOOL, LEACHING LINE, AND PORTION OF 4" CAST IRON SEWER PIPE PER LOS ANGELES COUNTY UNIFORM PLUMBING CODE, SEC. 1112.

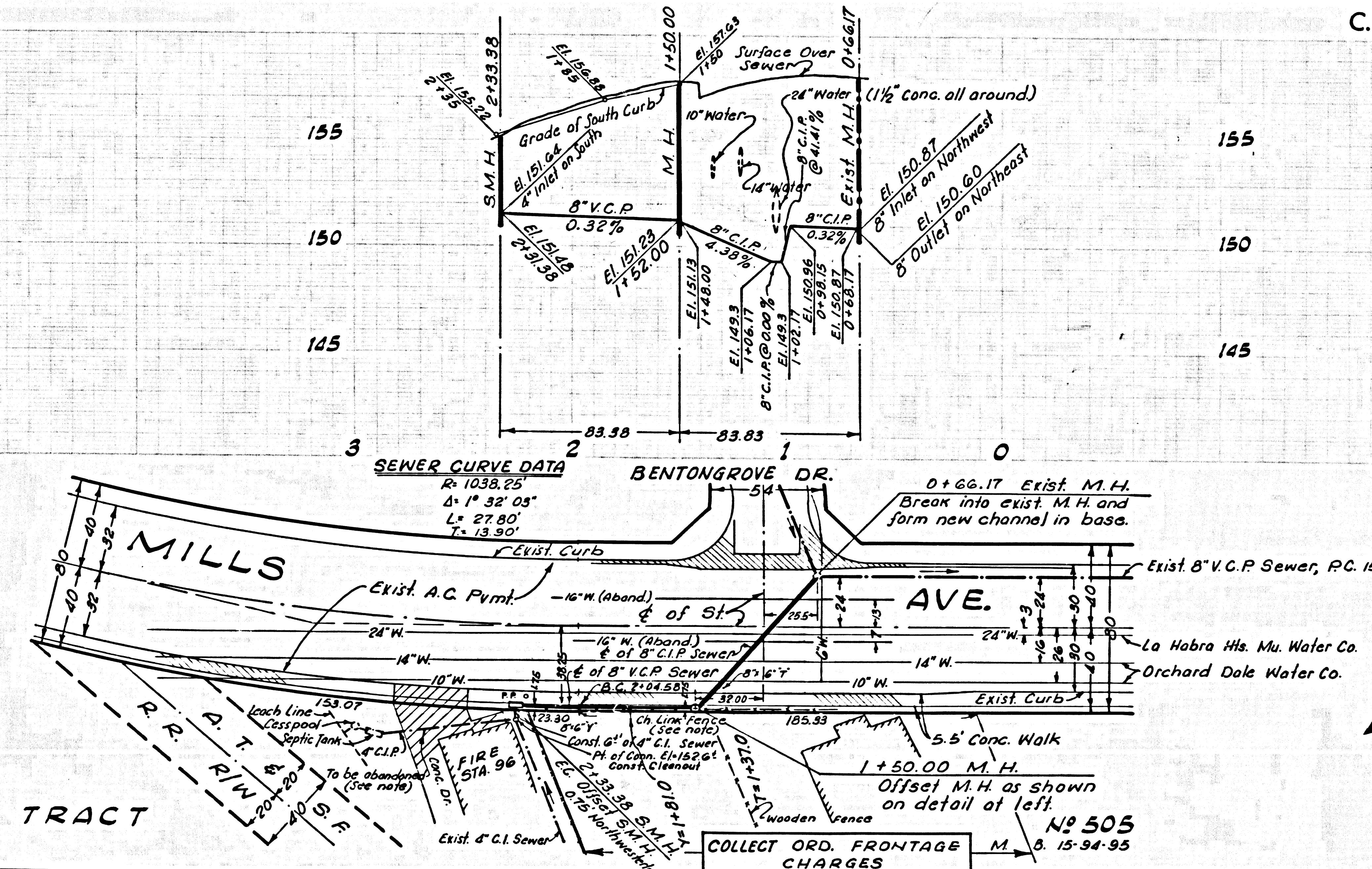
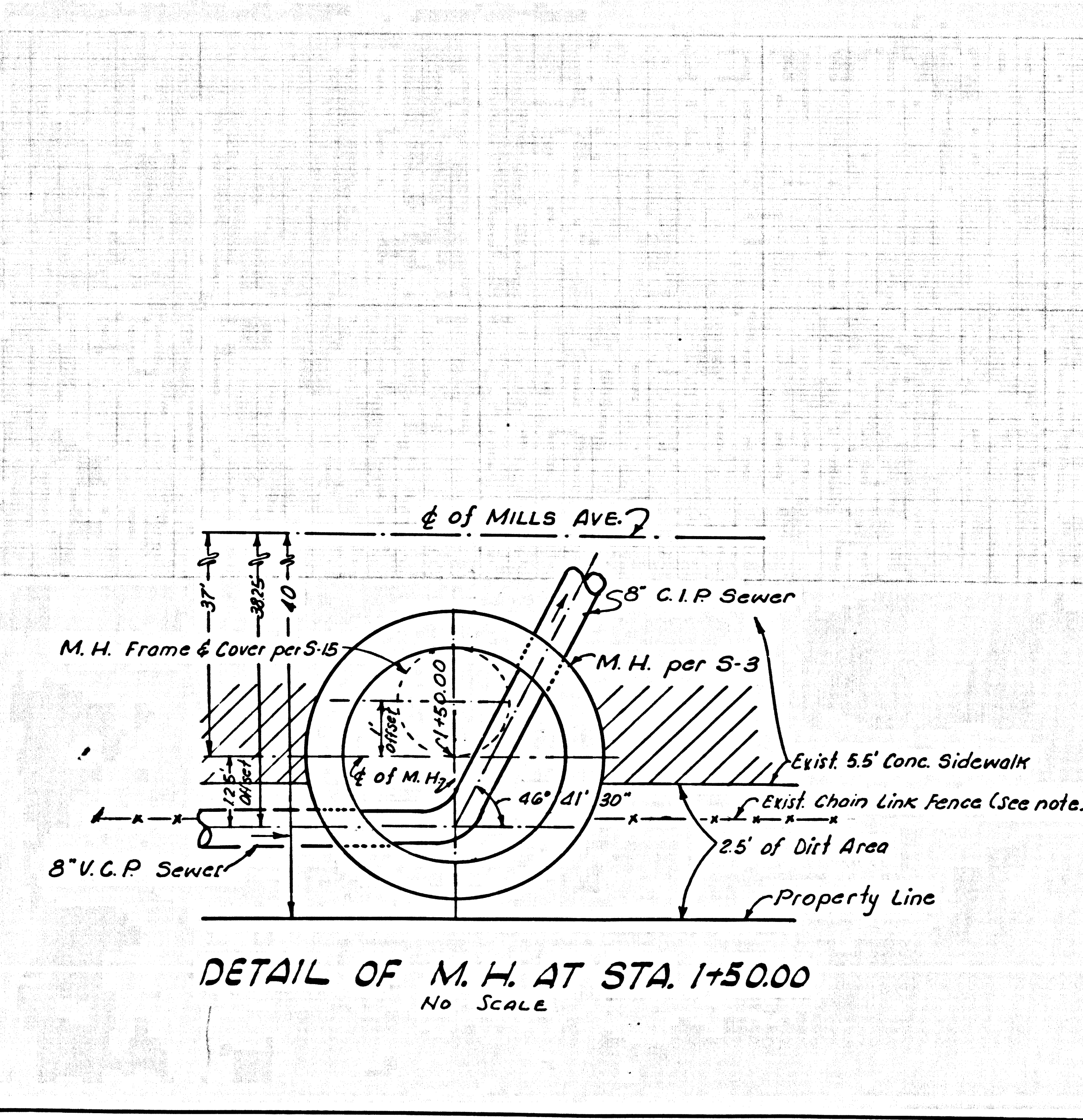

C.C. 8409 PAGE 2

COLLECT CHARGES AS INDICATED

42005

COLLECT ORD. FRONTAGE CHARGES M. O. 15-94-95
NO 505