

B.M. 21 1774 ELEV. 1078.072
 FROM T&G CO. TRAFFIC ISL. 15 FT. N.E.
 5' FROM HENRY MARY DR. * 70 FT. W. E.
 GOLDEN ST FERRY BRIDGE 853-1625

NEWHALL QUAD. 19 65

No connections for the disposal of industrial wastes shall be made to sewers shown on these drawings without written permission from the Chief Engineer and General Manager of the County Sanitation Districts.

County Sanitation Districts shall be notified prior to the following so that required inspection can be made (Phone 337-1025 or 337-2025)

Breaking into existing manhole on District trunk sewer.

Acceptance of the project.

THE FOLLOWING COUNTY ENGINEER STANDARD PLANS APPLY TO THIS PROJECT

| | |
|------------------------------------|------|
| LEGEND | 5-1 |
| MINIMUM PUBLIC SAFETY REQUIREMENTS | 5-2 |
| BRICK MANHOLE | 5-3 |
| STANDARD MANHOLE STEP | 5-17 |
| BEDDING FOR SEWER PIPE | 5-21 |
| CRADLING & ENCASUREMENT | 5-23 |
| WYE & TEE SUPPORT | 5-26 |
| ALLOWABLE TRENCH WIDTHS | 5-33 |
| CHIMNEY PIPE AND BASE | 5-37 |
| LOCKING MANHOLE FRAME & COVER | 5-35 |

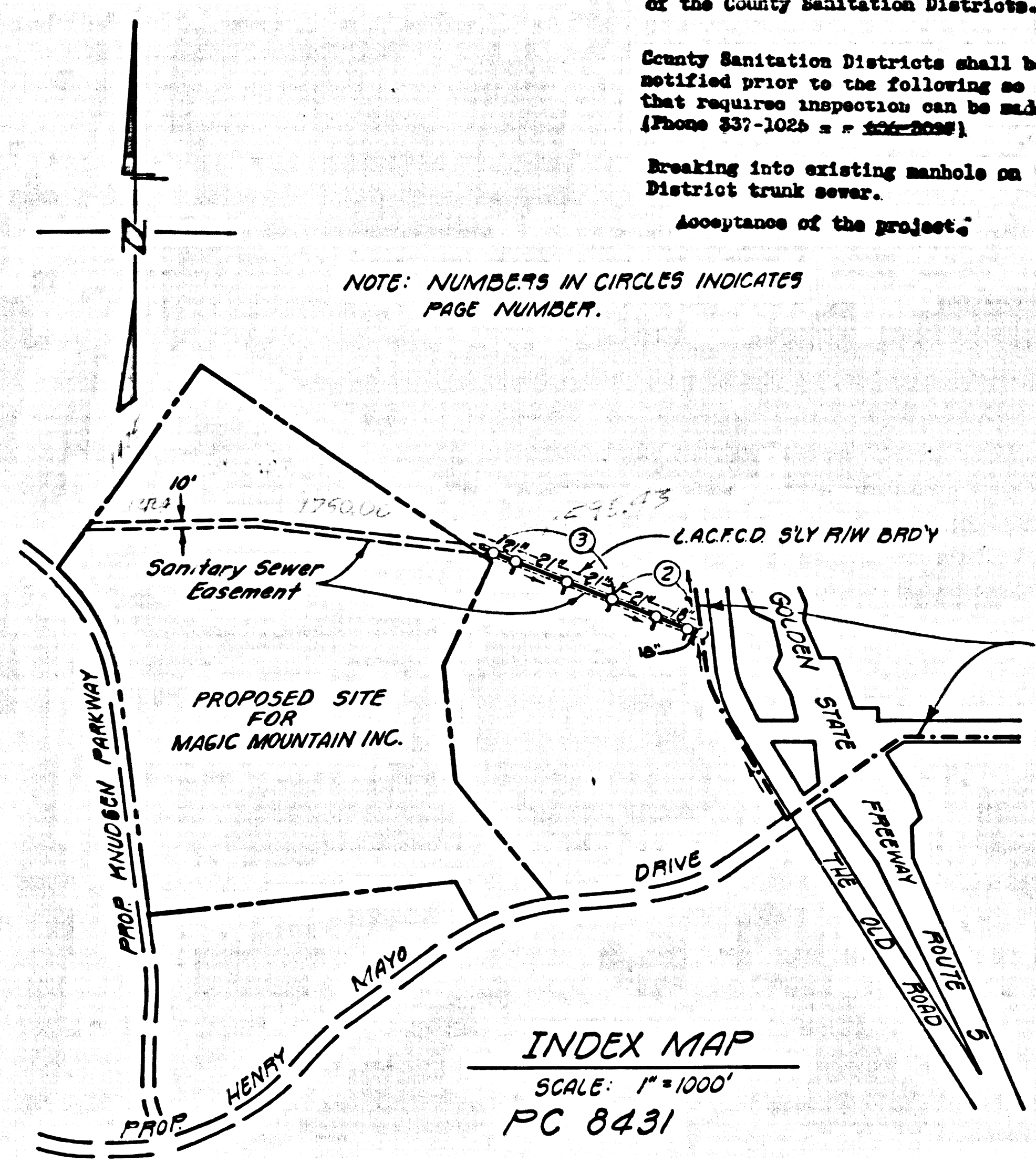

NOTE: NUMBERS IN CIRCLES INDICATES PAGE NUMBER.

INDEX MAP
 SCALE: 1"=1000'
 PC 8431

EX. 30" L.A. CO. SAN. DIST. NR. 32 MAIN TRUNK SEWER

OR BACKFILL TRENCH AND REPLACE OTHER EARTH REMOVED SO AS TO ACHIEVE THE NATURAL OR FINISHED GRADES AND SLOPES SHOWN ON THE SEWER PLAN APPROVED FOR THIS DEVELOPMENT.

WALL BACKFILL AND EARTH REPLACED SHALL BE COMPACTED TO A MINIMUM OF 90% OF MAXIMUM DENSITY PER ASTM STANDARD METHOD OF TEST D698-BT AS MODIFIED. ACCEPTABLE CERTIFICATION OF SUCH COMPACTION SHALL BE SUBMITTED TO THE CONSTRUCTION DIVISION.

ISSUE NO PERMITS UNTIL R/W IS CLEAR.

COLLECT CHARGES AS INDICATED

DOUBLE SCALE
 NEWHALL BLDG. DIST. NO. 8.2

- PROVIDE STABLE ON THE PROPERTY LINE OR PROPERTY LINES PRODUCED AT RIGHT ANGLES TO THE SEWER LINE AT THE CENTER LINE OF EACH MANHOLE.
- NO REPRESENTATIVE OF THE COUNTY ENGINEER WILL SURVEY OR LAY OUT ANY PORTION OF THE WORK.
- THE PRIVATE ENGINEER SHALL FURNISH THE COUNTY ENGINEER WITH GRADE SHEETS AND STATIONING FOR ALL "V" OR "T" BRANCHES AND SHALL PROVIDE STAKES FOR THEM AT THEIR PROPER LOCATIONS WITH STATIONING PLAINLY MARKED.
- THE HOUSE LATERAL SHALL BE CONSTRUCTED IN A STRAIGHT ALIGNMENT AS SHOWN FROM THE MAIN LINE SEWER EXCEPT AS SHOWN ON THE PLANS. HOUSE LATERALS FROM CHIMNEYS SHALL NOT HAVE AN ANGLE OF LESS THAN 45° WITH THE MAIN LINE SEWER. ANY CHANGE IN ALIGNMENT SHALL BE REQUESTED IN WRITING BY THE PRIVATE ENGINEER.
- THE PRIVATE ENGINEER SHALL FURNISH THE HOUSE LATERAL DEPTH AT THE PROPERTY LINE BELOW THE TOP OF CURB ELEVATION FOR EACH HOUSE LATERAL ON THE GRADE SHEET.
- NO REVISIONS SHALL BE MADE IN THESE PLANS WITHOUT THE APPROVAL OF THE COUNTY ENGINEER.
- THE CONTRACTOR SHALL NOTIFY THE CONSTRUCTION DIVISION BY TELEPHONE, MADISON 5-2747, EXT. 8151, AT LEAST TWENTY-FOUR HOURS BEFORE STARTING ANY WORK UNDER THIS CONTRACT.
- ALL STRUCTURES SHALL BE PER 5-36
- USE STANDARD MANHOLE FRAMES AND COVERS, 5-16, EXCEPT AS NOTED.
- MANHOLE TOPS IN UNIMPROVED RIGHTS-OF-WAY TO BE SIX INCHES ABOVE FINISHED GRADE.
- USE EXTRA STRENGTH PIPE. ALL PIPE IS STANDARD DEPTH EXCEPT AS NOTED.
- USE MECHANICAL COMPRESSION JOINTS FOR ALL V.C.P. JOINTS PER SPECS. SECS. 54, 48 & 49.
- IF A POWER POLE IS WITHIN THIRTY FEET OF THE SEWER, THE SEWER SHALL BE ENCASED, PER 5-23, TWO FEET ON EACH SIDE FROM THE POINT OF INTERFERENCE.
- IF DURING THE COURSE OF CONSTRUCTION IT IS DETERMINED THAT THERE IS LESS THAN FOUR FEET OF COVER OVER THE TOP OF A MAIN LINE OR HOUSE LATERAL V.C.P. SEWER WHICH IS NOT INDICATED ON THE PLANS, THE PIPE SHALL BE ENCASED PER 5-23, UNLESS OTHERWISE APPROVED BY THE COUNTY ENGINEER.
- HOUSE LATERALS TO BE CONSTRUCTED WITH INVERTS AT PROPERTY LINE & FIVE FEET BELOW CURB GRADE EXCEPT AS NOTED.
- RESURFACE ALL TRENCHES WITHIN PAVED AREAS TO MEET L.A. COUNTY ROAD DEPT. OR CALIFORNIA STATE HIGHWAY REQUIREMENTS IN ACCORDANCE WITH PERMITS.
- FOR MANHOLE HEADS PER USE FORMULA NO. 2, SPEC. SEC. 54.
- ALL STATE AND LOCAL TRENCH SAFETY ORDERS WILL BE STRICTLY ENFORCED.
- ALL JOINTS BETWEEN CAST IRON PIPE AND VITRIFIED CLAY PIPE SHALL BE MADE WITH A RUBBER GULCH JOINT, TYPE "C" OR "D" (WITH BUBBLING, IF NECESSARY) PER STANDARD SPEC'S SEC. 208-E
- VITRIFIED CLAY PIPE JOINTS SHALL BE TYPE "D", "F" OR "G" PER STANDARD SPEC'S SECTION 208-E
- SEWERS TO BE TESTED FOR LEAKAGE PER SECTION 305-2.3.7 OF STANDARD SPEC'S
- REFER TO SEC. 7-10.1 OF STANDARD SPEC'S REGARDING SAFETY ANDERS
- USE OF WYE BRANCHES MAY BE USED FOR CONNECTIONS TO MAIN LINE SEWER EXCEPT AS NOTED.

NOTICE TO CONTRACTOR

The existence and location of any underground utility lines or structures shown on these plans are obtained by a search of the available records. To the best of my knowledge there are no existing utilities except as shown on these plans. The contractor is required to take due precautionary measures to protect the utility lines shown and any other lines not of record or not shown on these plans.

R.G.E.

PROFILE, ALIGNMENT AND GRADE OF
 SANITARY SEWERS PAGE 1
 CONSTRUCTED IN

R/W FOR MAGIC MOUNTAIN (OFFSITE)
 PRIVATE CONTRACT NO. 8431

W.S. 63
 2 SHEETS, 3 PAGES
 SCALE: VERT. 1"=8' HORIZ. 1"=40'
 FEB. 1970

PREPARED BY THE OFFICES OF
 SIKAND ENGINEERING ASSOCIATES INC.
 1320 S. BURBANK BOULEVARD
 VAN NUYS, CALIFORNIA, 91401
 767-6332
 REG. C. E. NO. 9554

NOTE: GRADES TO WHICH THIS IMPROVEMENT IS TO BE CONSTRUCTED ARE SHOWN ON PLANS AND PROFILE. GRADE POINTS FOR TOP OF CURBS, CENTER LINE OF STREETS, OR CENTER LINE OF ALLEYS ARE SHOWN BY CIRCLES ON PROFILES. AT ALL POINTS BETWEEN DESIGNATED POINTS THE GRADE SHALL BE ESTABLISHED SO AS TO CONFORM TO A STRAIGHT LINE DRAWN BETWEEN SAID DESIGNATED POINTS. REVISIONS ARE IN PENCIL AND IN RED. ORIGINAL COPY OF SANITARY SEWERS WORK SHALL BE CONSTRUCTED ACCORDING TO THE STANDARD SPECIFICATIONS FOR PUBLIC WORKS AND CONSTRUCTION REVISIONS ARE IN PENCIL AND IN RED. ORIGINAL COPY OF SANITARY SEWERS DATED APRIL 7, 1970, AND SHALL BE PROSECUTED ONLY IN THE PRESENCE OF THE COUNTY ENGINEER. BEFORE WORK CAN BE STARTED, THE CONTRACTOR MUST OBTAIN A PERMIT TO EXCAVATE IN COUNTY STREETS FROM THE L.A. COUNTY ROAD DEPT., DISTRICT OFFICE NO. 3, AND PAY A FEE TO THE COUNTY ENGINEER, ROOM 300, COUNTY ENGINEERING BUILDING, 100 WEST SECOND STREET, LOS ANGELES, CALIFORNIA. ORIGINAL COPIES, SUBJECT TO COSTS OF CONSTRUCTION INSPECTION AND RECORD PLANS. APPROVAL OF THIS PLAN BY THE COUNTY OF LOS ANGELES DOES NOT CONSTITUTE A REPRESENTATION AS TO THE ACCURACY OF THE LOCATION OF OR THE EXISTENCE OR NON-EXISTENCE OF ANY UNDERGROUND UTILITY PIPE, OR STRUCTURE WITHIN THE LIMITS OF THIS PROJECT. THIS NOTE APPLIES TO ALL PAGES. IF WORK IS TO BE DONE IN A STATE HIGHWAY, A PERMIT MUST BE OBTAINED FROM THE STATE OF CALIFORNIA, DIVISION OF HIGHWAYS, 120 SOUTH SPRING STREET, LOS ANGELES, CALIFORNIA.

COUNTY OF LOS ANGELES, CALIFORNIA
 JOHN A. LAMBIE, COUNTY ENGINEER
 J. D. PARKHURST, CHIEF ENGINEER
 CO. SAN. DIST. NO. 32

APPROVED BY: [Signature] REGIONAL ENGINEER
 APPROVED BY: [Signature] OFFICE ENGINEER

CHECKED BY: [Signature] 5-12-70
 REG. C.E. NO. 14330
 41894
 J.N.0370.32

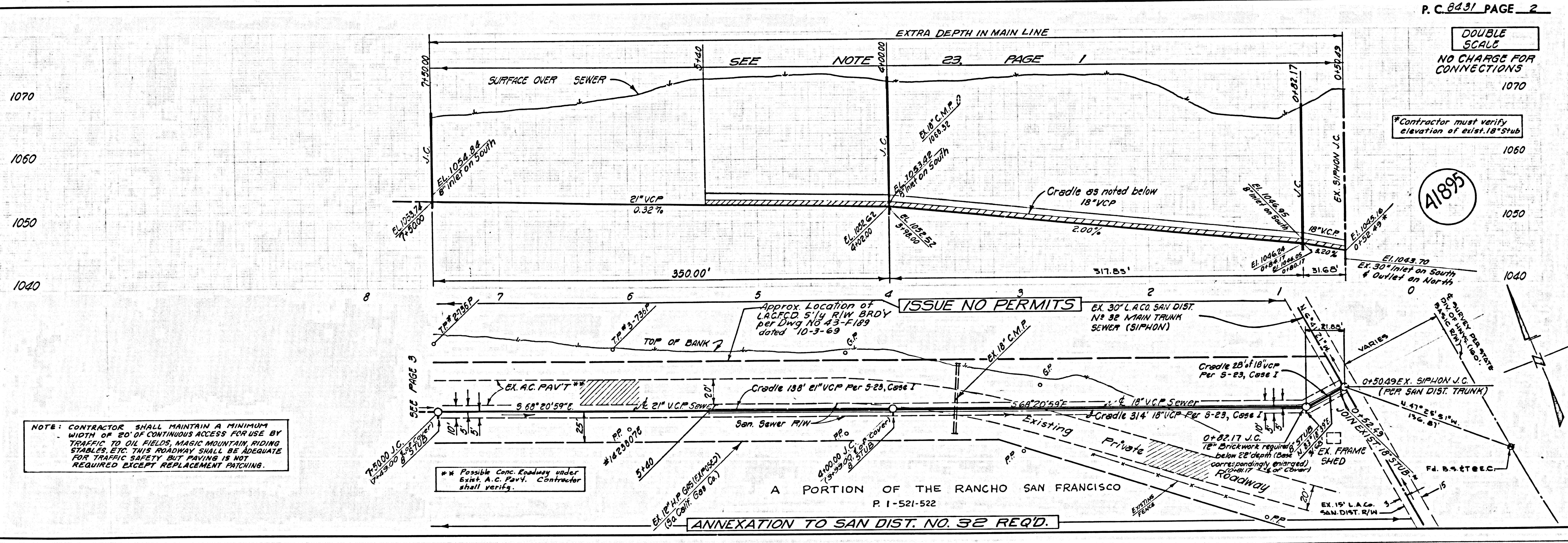

NOTE: CONTRACTOR SHALL MAINTAIN A MINIMUM WIDTH OF 20' OF CONTINUOUS ACCESS FOR USE BY TRAFFIC TO OIL FIELDS, MAGIC MOUNTAIN, RIDING STABLES, ETC. THIS ROADWAY SHALL BE ADEQUATE FOR TRAFFIC SAFETY BUT PAVING IS NOT REQUIRED EXCEPT REPLACEMENT PATCHING.

** Possible Conc. Roadway under Ex. A.C. Pav. Contractor shall verify.

A PORTION OF THE RANCHO SAN FRANCISCO
 P. I - 521-522
 ANNEXATION TO SAN DIST. NO. 32 REQ'D.

P.C. 8431 PAGE 2

DOUBLE SCALE
 NO CHARGE FOR CONNECTIONS

Contractor must verify elevation of exist. 18" Stub

41895

SEE NOTE 23, PAGE 1

