

REFLECTED BY C. MERJON
DIMENSIONS SHOWN IN FEET AND INCHES

D.D. INV. 159.78
B. 159.78

ON INCLUSIVE SURVING CO. PLAN
L.A. 159.78

REFLECTED BY C. MERJON
DIMENSIONS SHOWN IN FEET AND INCHES

Trim Prints to this Line

REFLECTED BY C. MERJON
DIMENSIONS SHOWN IN FEET AND INCHES

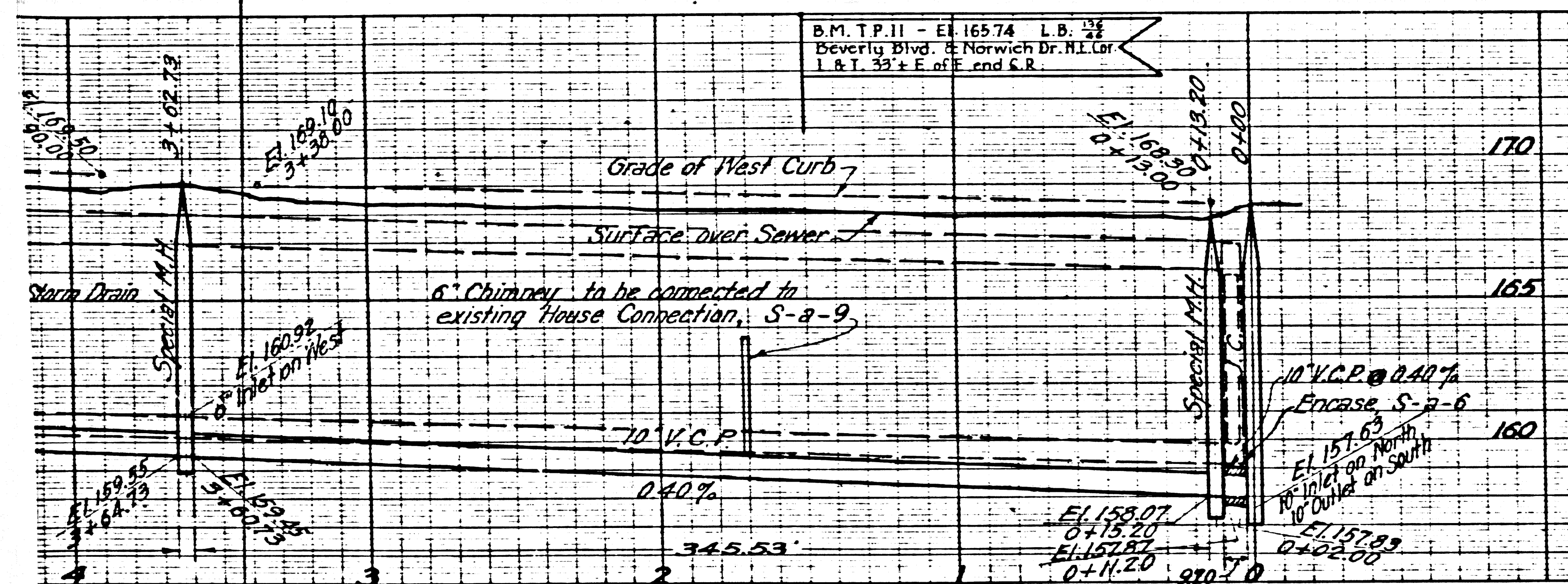

NOTE:-
 WESTON'S GASKETS AND FORMS FOR PIPE JOINTS OR EQUAL TO BE USED WITH ALL SEWERS AND HOUSE CONNECTIONS SHOWN ON THIS SHEET.

Where Sewer is shown crossing existing Sewers, construct Special Manholes, Drop Manholes, or Junction Chambers around the Sewers and break out pipe for connections.

Remove interfering Sections of all existing Sewers and House Connections.

Seal all abandoned Inlets to existing structures and upper ends of abandoned House Connections with Class B Concrete.

41548

DRAINAGE DISTRICT IMPROVEMENT NO. 29

OF THE COUNTY OF LOS ANGELES

PLAN AND PROFILE OF SANITARY SEWER RECONSTRUCTION TO PERMIT INSTALLATION OF STORM DRAIN SAN VICENTE BLVD. BETWEEN BEVERLY BLVD. AND MELROSE AVE.

SCALES VERTICAL 1"=4' HORIZONTAL 1"=40'

FEBRUARY 1930

SHEET 6 OF 6 SHEETS

J. E. ROCKHOLD - COUNTY SURVEYOR

Submitted by: *Alfred Jones* Chief Deputy

Approved by: *J. E. Rockhold* County Surveyor

Approved as to form Everett W. Mattoon County Counsel

By: *J. G. Conway* Assistant

PC. 8450 REF. ONLY

NOTE:-
 FOR LEGEND SEE PLAN NO S-9-64

GRADES TO WHICH THIS IMPROVEMENT IS TO BE CONSTRUCTED ARE SHOWN ON PLANS AND PROFILES. GRADE POINTS FOR TOP OF CURB, CENTER LINE OF STREET, OR CENTER LINE OF ALLEY ARE SHOWN BY CIRCLES ON PROFILES. AT ALL POINTS BETWEEN DESIGNATED POINTS THE GRADE SHALL BE ESTABLISHED SO AS TO CONFORM TO A STRAIGHT LINE DRAWN BETWEEN SAID DESIGNATED POINTS.

ELEVATIONS ARE IN FEET ABOVE U.S.G.S. DATUM, OR MEAN SEA LEVEL.

THIS DRAWING AND THE DATA HEREON ARE HEREBY MADE A PART OF THE SPECIFICATIONS.

REFERENCES	D.D.I. No 29	
W.S. 22	DESIGNED	PICKETT JAN. 1930
A.B. 446	TRACED	KUENZEL JAN. 1930
L.D.	CHECKED	BENJIS JAN. 1930

