

B.M. 80 2621 ELEV. 445.408  
 City of Industry, brass man in main footing of W. 2nd part of structure No. 24975, located  
 Ave. 1800 N. of 15th Av. (Column No.) 1 25'  
 W. of E. Main (Column No.) 1 25'  
 OTTERBEIN QUAD. 1965.

THE FOLLOWING LATEST REVISED STANDARDS IN FORCE IN THE OFFICE OF THE ENGINEER SHALL APPLY IN THE CASE OF THIS PROJECT.

LEGEND	3/1
MINIMUM EXCAVATION SAFETY REQUIREMENTS	3/2
SEWER MAINS	3/3
MAN-POWERED PRECAST CONCRETE MANHOLE	3/4
MANHOLE FRAMES AND COVERS	3/5
STANDARD MANHOLE STEPS	3/6
REGULATED SEWER PIPE	3/7
CABLELAYS AND ENCLOSURES	3/8
ALLOWABLE TRENCH WIDTHS	3/9

No connection for the disposal of industrial wastes shall be made to sewer shown on same drawings without written permission from the Chief Engineer and General Manager of the County Sanitation Districts.

County Sanitation Districts shall be notified under the following conditions:

Acceptance of the project.

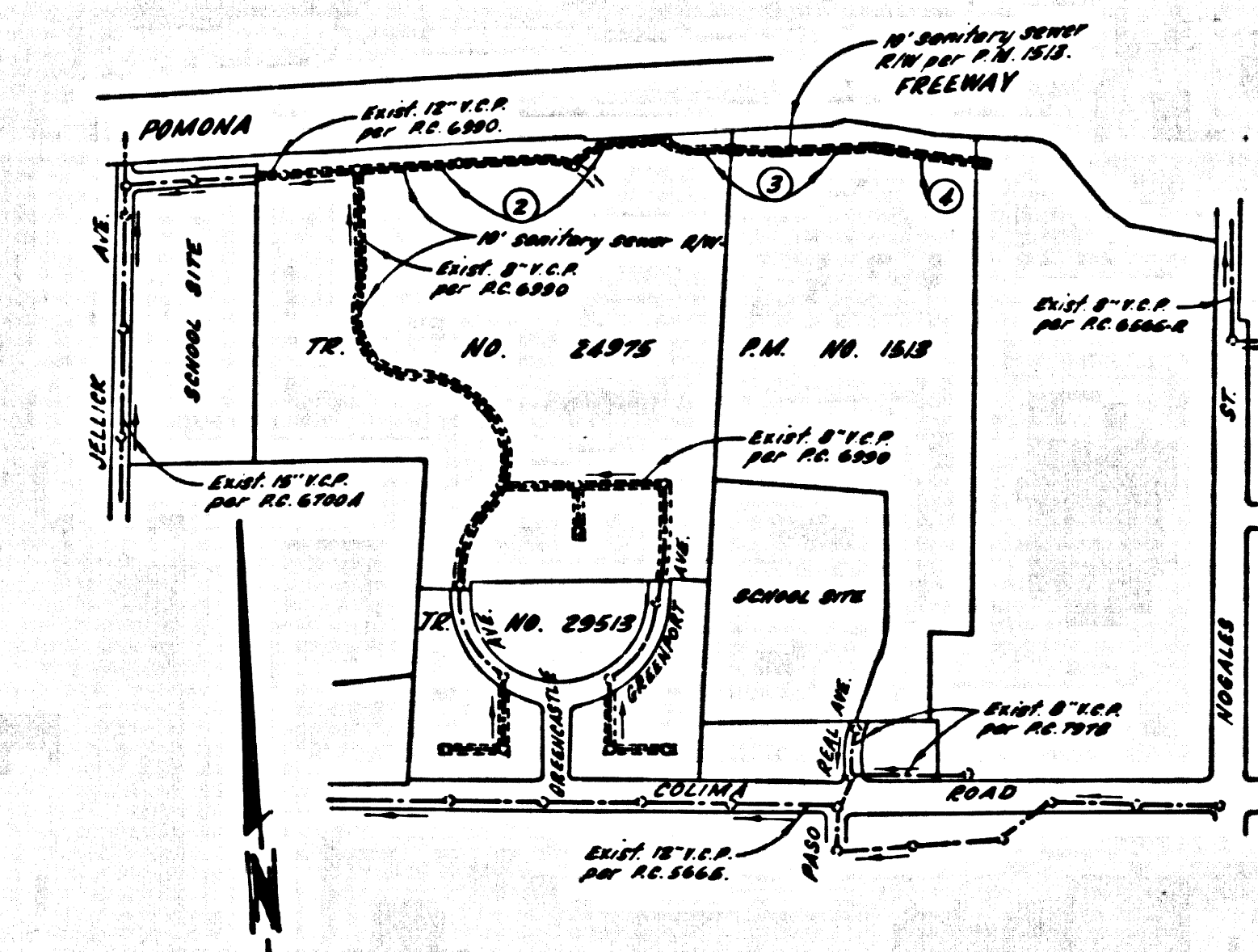

INDEX MAP  
 P.C. 8473  
 P.M. NO 1513

Finish grading for P.M. 1513 to be in place prior to construction of sewers.

LA PUENTE BLDG. DIST. NO. 2

- NOTES:
- PROVIDE STAKES ON THE PROPERTY LINE OR PROPERTY LINES PRODUCED AT RIGHT ANGLES TO THE SEWER LINE AT THE CENTER LINE OF EACH MANHOLE.
  - NO REPRESENTATIVE OF THE COUNTY ENGINEER WILL SURVEY OR LAY OUT ANY PORTION OF THE WORK.
  - THE PRIVATE ENGINEER SHALL FURNISH THE COUNTY ENGINEER WITH GRADE SHEETS AND STATIONING FOR ALL HOUSE LATERALS. 4" X 4" MANHOLES AND SHALL PROVIDE STAKES FOR THEM AT THEIR PROPER LOCATIONS WITH STATIONING PLAINLY MARKED. ALL HOUSE LATERALS SHALL BE CONSTRUCTED IN A STRAIGHT ALIGNMENT AT RIGHT ANGLES FROM THE MAIN LINE SEWER EXCEPT AS SHOWN ON THE PLANS. HOUSE LATERALS FROM CONCRETE SHALL NOT HAVE AN ANGLE OF LESS THAN 45° WITH THE MAIN LINE SEWER. ANY CHANGE IN ALIGNMENT SHALL BE INDICATED IN WRITING BY THE PRIVATE ENGINEER.
  - THE PRIVATE ENGINEER SHALL FURNISH THE HOUSE LATERAL BENCH AT THE PROPERTY LINE BELOW THE TOP OF CURB ELEVATION FOR EACH HOUSE LATERAL ON THE GRADE SHEET.
  - NO MANHOLES SHALL BE MADE IN THESE PLANS WITHOUT THE APPROVAL OF THE COUNTY ENGINEER.
  - THE CONTRACTOR SHALL NOTIFY THE CONSTRUCTION DIVISION BY TELEPHONE, BARBERS 4-4247, EXT. 8131, AT LEAST TWENTY-FOUR HOURS BEFORE STARTING ANY WORK UNDER THE CONTRACT.
  - MANHOLES SHALL BE BRICK SEWER STRUCTURES PER SPECIFIC CONCRETE MANHOLES PER 3-26 EXCEPT AS NOTED.
  - "V" OR "Y" BELLINGS MAY BE USED FOR CHARACTERISTICS IN MANHOLE SEWERS EXCEPT AS NOTED.
  - MANHOLE TOPS IN UNIMPROVED RIGHTS OF WAY TO BE SIX INCHES ABOVE FINISHED GRADE.
  - USE EXTRA STRENGTH PIPE. ALL PIPE IS STANDARD DEPTH EXCEPT AS NOTED.
  - INTERFED CLAY PIPE JOINTS SHALL BE TYPE "S" OR "K" JOINTS STANDARD SPECIFICATION SECTION 209-2.
  - IF A POWER POLE IS WITHIN THREE FEET OF THE SEWER, THE SEWER SHALL BE ENCASED, PER 3-23, TWO FEET ON EACH SIDE FROM THE POINT OF INTERFERENCE.
  - IF DURING THE COURSE OF CONSTRUCTION IT IS DETERMINED THAT THERE IS LESS THAN FOUR FEET OF COVER OVER THE TOP OF A MAIN LINE OR HOUSE LATERAL V.C.P. SEWER WHICH IS NOT INDICATED ON THE PLANS, THE PIPE SHALL BE ENCASED PER 3-23, UNLESS OTHERWISE APPROVED BY THE COUNTY ENGINEER.
  - HOUSE LATERALS TO BE CONSTRUCTED WITH JOINTS AT PROPERTY LINE & FEET BELOW CURB GRADE EXCEPT AS NOTED.
  - RESURFACE ALL TRENCHES WITHIN PAVED AREAS TO MEET L.A. COUNTY ROAD DEPT. OR CALIFORNIA STATE HIGHWAY REQUIREMENTS IN ACCORDANCE WITH PERMITS.
  - REVISIONS TO THIS DRAWING FOR GRADING PER SECTION 209-2.3.5 OF STANDARD SPECIFICATIONS.
  - REVISION TO SECTION 209-2.1 OF STANDARD SPECIFICATIONS, STANDARDIZATION, PRIVATE ENGINEER.
  - ALL JOINTS BETWEEN CAST IRON PIPE AND INTERFED CLAY PIPE SHALL BE MADE WITH A RUBBER BUSH JOINT, TYPE "S" OR "K", (NOTE JOINTS IF NECESSARY) PER 3-26, SEAK JOINT.

COLLECT CHARGES AS INDICATED

NOTICE TO CONTRACTOR

The existence and location of any underground utility pipes or structures shown on these plans are obtained by a search of the available records to the best of my knowledge there are no existing utilities except as shown on these plans. The contractor is required to take due precautionary measures to protect the utility lines shown and any other lines not of record or not shown on these plans.

George J. Jenkins

PROFILE ALIGNMENT AND GRADE OF  
 SANITARY SEWERS  
 CONSTRUCTED IN  
 PARCEL MAP NO. 1513  
 AND  
 RIGHTS OF WAY  
 PRIVATE CONTRACT NO. 8473

W.S. 58  
 2 SHEETS, 4 PAGES  
 SCALE: VERT. 1"=4'  
 HORIZ. 1"=40'  
 JUNE, 1970  
 PREPARED IN THE OFFICE OF  
 H. M. SCOTT & ASSOCIATES, INC.  
 ROSENHEAD, CALIFORNIA  
 BY: George J. Jenkins  
 REG. C. E. NO. 17994

FOR LEGEND SEE PLAN NO. 5-1

GRADE TO WHICH THE IMPROVEMENT IS TO BE CONSTRUCTED AS SHOWN ON PLANS AND PROFILES. GRADE POINTS FOR TOP OF CURBS, CENTER LINE OF STREETS, OR CENTER LINE OF ALLEYS ARE SHOWN BY CIRCLES ON PROFILES AT ALL POINTS WITHIN DESIGNATED POINTS THE GRADE SHALL BE ESTABLISHED SO AS TO CONFORM TO A STRAIGHT LINE BETWEEN SAID DESIGNATED POINTS.

NOTES: ALL CONTRACTORS ATTEMPTING TO EXCAVATE ANY PUBLIC HIGHWAY OR STATE HIGHWAY (PER EDITION) AND COUNTY ENGINEER SPECIAL PROVISIONS FOR THE CONTRACT FOR ANY PUBLIC HIGHWAY OR STATE HIGHWAY (PER EDITION) BEFORE WORK CAN BE STARTED. THE CONTRACTOR MUST OBTAIN A PERMIT TO EXCAVATE IN COUNTY STREETS FROM THE L.A. COUNTY ROAD DEPT. DISTRICT OFFICE NO. 1 AND PAY A FEE TO THE COUNTY ENGINEER, ROOM 308, COUNTY ENGINEERING BUILDING, 100 WEST SECOND STREET, LOS ANGELES, CALIFORNIA. THE COUNTY ENGINEER'S OFFICE, SUPPLEMENT TO COVER THE COST OF APPROVAL OF THIS PLAN BY THE COUNTY OF LOS ANGELES DOES NOT CONSTITUTE A REPRESENTATION AS TO THE ACCURACY OF THE LOCATION OF OR THE EXISTENCE OR NON-EXISTENCE OF ANY UNDERGROUND UTILITY PIPE, OR STRUCTURE WITHIN THE LIMITS OF THE PROJECT. THIS NOTE APPLIES TO ALL PAGES.

IF WORK IS TO BE DONE IN A STATE HIGHWAY, A PERMIT MUST BE OBTAINED FROM THE STATE OF CALIFORNIA, DIVISION OF HIGHWAYS, 126 SOUTH SPRING STREET, LOS ANGELES, CALIFORNIA.

COUNTY OF LOS ANGELES, CALIFORNIA  
 JOHN A. LAMBE, COUNTY ENGINEER  
 J. D. PARKHURST, CHIEF ENGINEER

APPROVED BY: [Signature]  
 APPROVED BY: [Signature]  
 CHECKED BY: [Signature] 6/4/70  
 REG. C. E. NO. 13466

42068

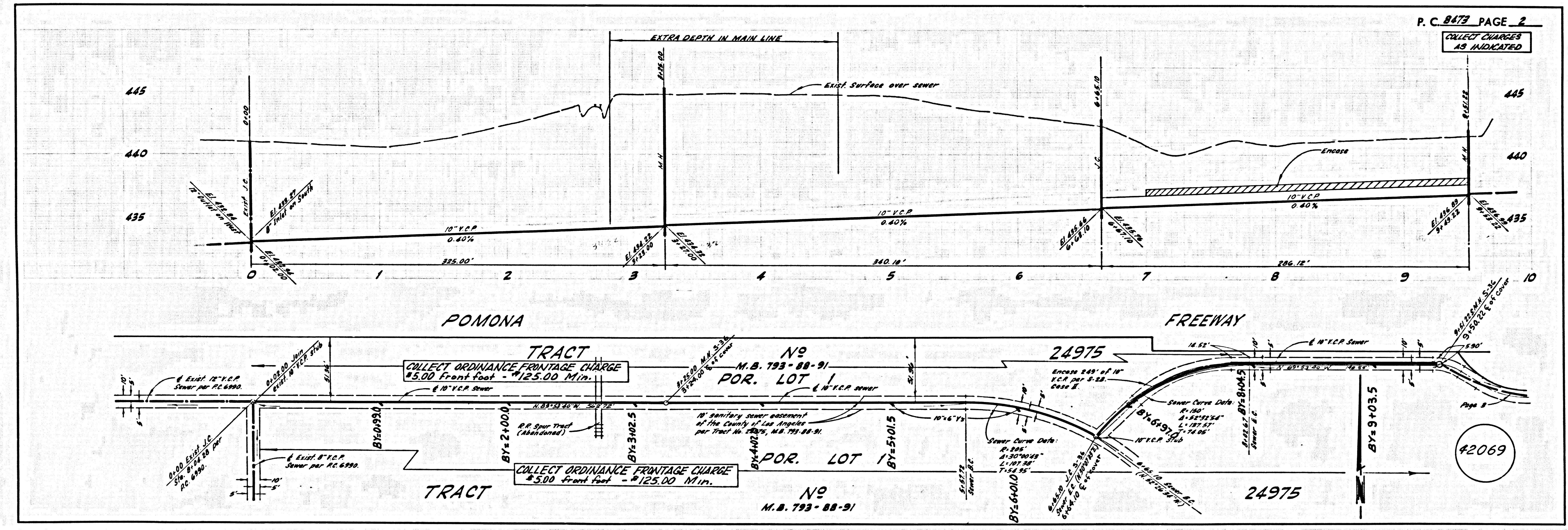

P.C. 8473 PAGE 2

COLLECT CHARGES AS INDICATED

42069

