

B.M. 861730 ELEV 418 5/2
 L&T (MKD. BM) ON NORTH SIDE OF CONC.
 WALK TO HOUSE NO. 1344 ANAHEIM -
 PUENTE ROAD 50 FT. EAST OF E AND
 340 FT. NORTH OF E BONITA VISTA LANE
 OTTERBEIN QUAD. 1965

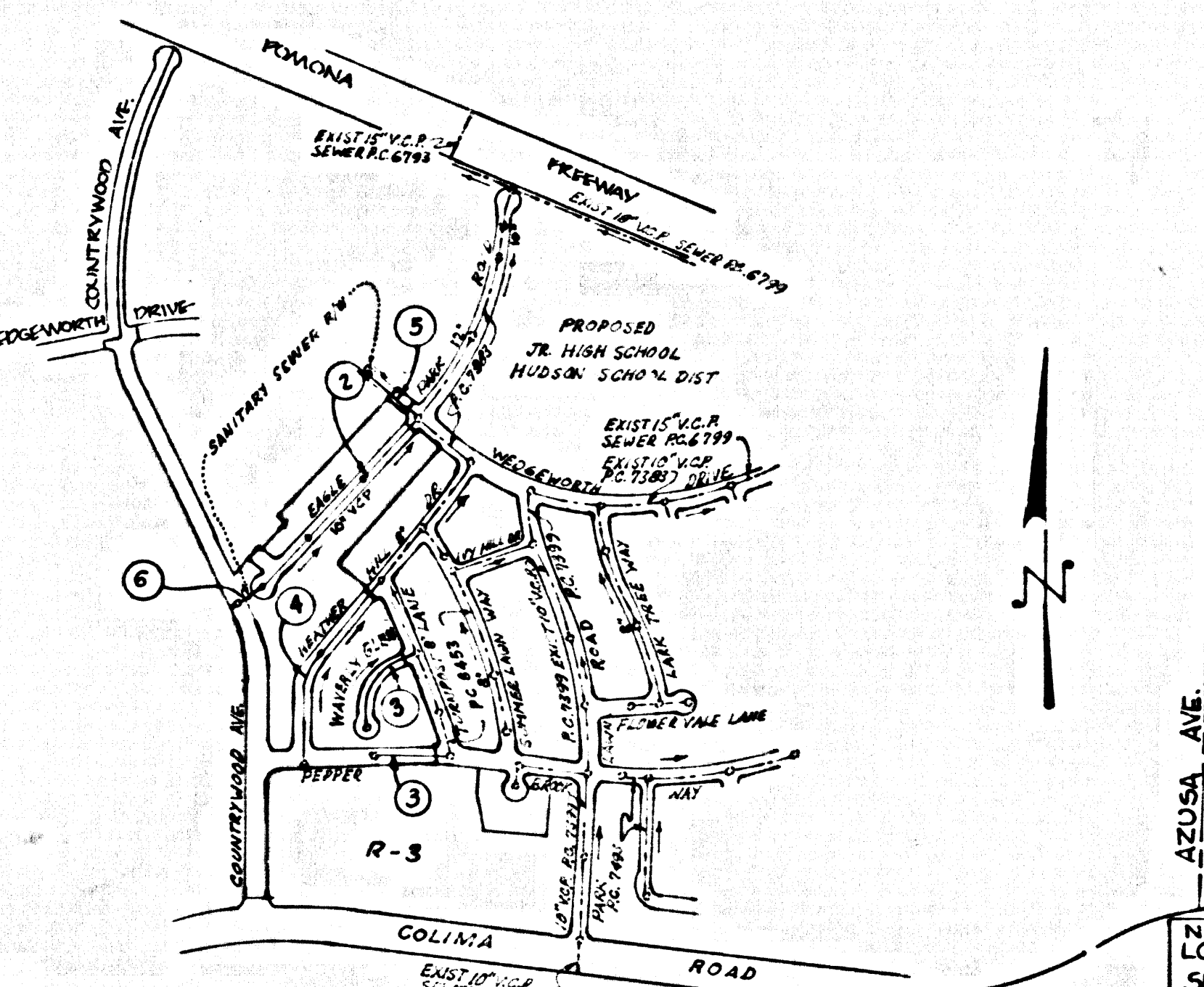

REVISION NO. 1 - ADDED SEWER ON PAGE 6. 10"
 V.C.P. FROM TACKL PARK TO COUNTRY WOOD AVE.
 STA. 17+59.43 TO 17+59.44
 HAROLD K. HEDLUND DATE: 8-10-71
 COUNTY ENGINEER

KEY MAP
 SCALE: 1" = 600'

NOTE: 19
 LOTS 1, 2, 3, 4, 10, 11, 17
 SERVED BY H.L.'S BUILT
 IN 1965 (TR. 27719)
 IN TURNPOST LANE.

LA PUENTE BLDG. DIST. NO. 2

- NOTES:
- HOUSE LATERALS TO BE CONSTRUCTED WITH INVERTS AT PROPERTY LINE 4 FEET BELOW CURB GRADE EXCEPT AS NOTED.
 - PROVIDE STAGES ON THE PROPERTY LINE OR PROPERTY LINES PRODUCED AT RIGHT ANGLES TO THE SEWER LINE AT THE CENTER LINE OF EACH MANHOLE.
 - NO REPRESENTATIVE OF THE COUNTY ENGINEER WILL SURVEY OR LAY OUT ANY PORTION OF THE WORK.
 - THE PRIVATE ENGINEER SHALL FURNISH THE COUNTY ENGINEER WITH GRADE SHEETS AND STATIONING FOR ALL HOUSE LATERALS AND "T" OR "Y" BRANCHES AND SHALL PROVIDE STAKES FOR THEM AT THESE PROPOSED LOCATIONS WITH STATIONING PLAINLY MARKED. ALL HOUSE LATERALS SHALL BE CONSTRUCTED IN A STRAIGHT ALIGNMENT AT RIGHT ANGLES FROM THE MAIN LINE SEWER EXCEPT AS SHOWN ON THE PLANS. HOUSE LATERALS FROM CHIMNEYS SHALL NOT HAVE AN ANGLE OF LESS THAN 45° WITH THE MAIN LINE SEWER. ANY CHANGE IN ALIGNMENT SHALL BE REQUESTED IN WRITING BY THE PRIVATE ENGINEER.
 - THE PRIVATE ENGINEER SHALL FURNISH THE HOUSE LATERAL DEPTH AT THE PROPERTY LINE BELOW THE TOP OF CURB ELEVATION FOR EACH HOUSE LATERAL ON THE GRADE SHEET.
 - NO REVISIONS SHALL BE MADE IN THESE PLANS WITHOUT THE APPROVAL OF THE COUNTY ENGINEER.
 - THE CONTRACTOR SHALL NOTIFY THE CONSTRUCTION DIVISION BY TELEPHONE, MANHOLE #400, EXT. 8150, AT LEAST TWENTY-FOUR HOURS BEFORE STARTING ANY WORK UNDER THIS CONTRACT.
 - ALL STRUCTURES SHALL BE EITHER BRICK MANHOLES PER S-3 OR PRECAST CONCRETE MANHOLES PER S-36 EXCEPT AS NOTED.
 - "T" OR "Y" BRANCHES MAY BE USED FOR CONNECTIONS TO MAINLINE SEWERS EXCEPT AS NOTED.
 - MANHOLE TOPS IN UNIMPROVED RIGHTS OF WAY TO BE 6 INCHES ABOVE FINISHED GRADE.
 - USE EXTRA STRENGTH PIPE. ALL PIPE IS STANDARD DEPTH EXCEPT AS NOTED.
 - VITRIFIED CLAY PIPE JOINTS SHALL BE TYPE "B", "F", OR "G" PER STANDARD SPECIFICATIONS SECTION 308-3.
 - IF A POWER POLE IS WITHIN THREE FEET OF THE SEWER, THE SEWER SHALL BE ENCASED, PER S-25, TWO FEET ON EACH SIDE FROM THE POINT OF INTERFERENCE.
 - IF DURING THE COURSE OF CONSTRUCTION IT IS DETERMINED THAT THERE IS LESS THAN FOUR FEET OF COVER OVER THE TOP OF A MAIN LINE OR HOUSE LATERAL V.C.P. SEWER WHICH IS NOT INDICATED ON THE PLANS, THE PIPE SHALL BE ENCASED PER S-25, UNLESS OTHERWISE APPROVED BY THE COUNTY ENGINEER.
 - REINFORCE ALL TRENCHES WITHIN PAVED AREAS TO MEET LA COUNTY ROAD DEPT. OR CALIFORNIA STATE HIGHWAY REQUIREMENTS IN ACCORDANCE WITH PERMITS.
 - SEWERS TO BE TESTED FOR LEAKAGE PER SECTION 308-3.2.2 OF THE STANDARD SPECIFICATIONS.
 - REFER TO SECTION 7-8.1.1 OF THE STANDARD SPECIFICATIONS, REGARDING SAFETY GARDERS.
 - ALL JOINTS BETWEEN CAST IRON PIPE AND VITRIFIED CLAY PIPE SHALL BE MADE WITH A RUBBER SLEEVE JOINT, TYPE "C" OR "D", WITH BUSHING IF NECESSARY PER STANDARD SPECIFICATIONS, SECTION 308-3.

THE FOLLOWING LATEST REVISED STANDARD PLANS ON FILE IN THE OFFICE OF THE COUNTY ENGINEER SHALL APPLY IN THE CONSTRUCTION OF THIS PROJECT:

STANDARD	SECTION	NO.
MINIMUM PLUMB LAYOUT REQUIREMENTS	S-1	1-1
BRICK MANHOLE	S-3	3-1
NON-REINFORCED PRECAST CONCRETE MANHOLE	S-36	3-36
LOCKING	MANHOLE FRAME AND COVER	S-33
STANDARD MANHOLE STEP	S-37	
RECORDS FOR SEWER PIPE	S-38	
CHANGING AND MEASURING	S-39	
WYE OF THE SUPPORT	S-38	
ALLOWABLE TRENCH WIDTHS	S-38	

County Sanitation Districts shall be notified prior to the following so that required inspection can be made (Phone 337-1025 - 838-1101) Superintendent of the project.

No connections for the disposal of industrial wastes shall be made to sewers unless the owner obtains a permit from the Chief Engineer and general manager of the County Sanitation Districts.

PROFILE, ALIGNMENT AND GRADE OF
 SANITARY SEWERS P.C. 8504
 PAGE 1

CONSTRUCTED IN
 TRACT NO. 27720

PRIVATE CONTRACT NO. 8504

W.S. 38-B4
 3 SHEETS; 6 PAGES

SCALE: VERT. 1" = 4'
 HORIZ. 1" = 60' AUGUST, 1970

PREPARED IN THE OFFICES OF
 HOPEN, HEDLUND & DARBY INC.
 REG. C. E. NO. 16028

NOTE:
 GRADES TO WHICH THIS IMPROVEMENT IS TO BE CONSTRUCTED ARE SHOWN ON PLANS AND PROFILES. GRADE POINTS FOR TOP OF CURB, CENTER LINE OF STREETS, OR CENTER LINE OF ALLEYS ARE SHOWN BY CIRCLES ON PROFILES. ALL POINTS BETWEEN DESIGNATED POINTS THE GRADE SHALL BE ESTABLISHED SO AS TO CONFORM TO A STRAIGHT LINE DRAWN BETWEEN SAID DESIGNATED POINTS. ELEVATIONS ARE IN FEET ABOVE U.S.C. & G.S. SEA LEVEL BATHY OF 1929.

PROVISIONS FOR THE CONSTRUCTION OF SANITARY SEWERS DATED APRIL 7, 1970 AS REVISED, AND SHALL BE PROSECUTED ONLY IN THE PRESENCE OF THE COUNTY ENGINEER.

IF WORK IS TO BE DONE IN A STATE HIGHWAY, A PERMIT MUST BE OBTAINED FROM THE STATE OF CALIFORNIA, DIVISION OF HIGHWAYS, 138 FOURTH STREET, LOS ANGELES, CALIFORNIA.

COUNTY OF LOS ANGELES, CALIFORNIA
 HARVEY T. SHAMPT COUNTY ENGINEER J. D. PARKHURST, CHIEF ENGINEER
 CO. SAN DIST. NO. 2

APPROVED BY: *Harold K. Hedlund* DATE: 8/10/71
 COUNTY ENGINEER OFFICE ENGINEER

CHECKED BY: *Thomas E. Howard* DATE: 8/10/71
 SAN DIST. NO. 2

COLLECT CHARGES
 AS INDICATED

42466

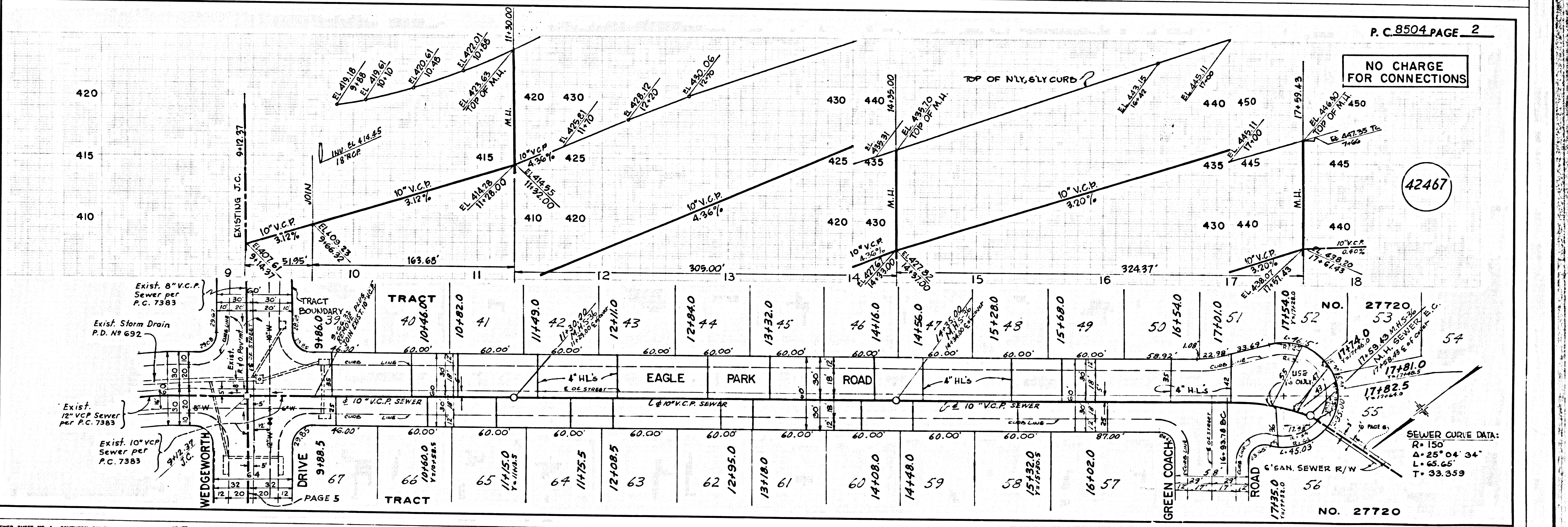

P.C. 8504 PAGE 2

NO CHARGE
 FOR CONNECTIONS

42467

SEWER CURVE DATA:
 R=150
 Δ=25°04'34"
 L=65.65'
 T=33.359'

