

B.M. BY 6303 ELEV. 160.774  
 C.E. Top Southwest corner concrete base  
 of gas vent island on N.E. corner Imperial  
 Hwy. and Burgess Ave. 50' N. 140' E. of 8 Int.  
 to Mirada QUAD. 19 65.

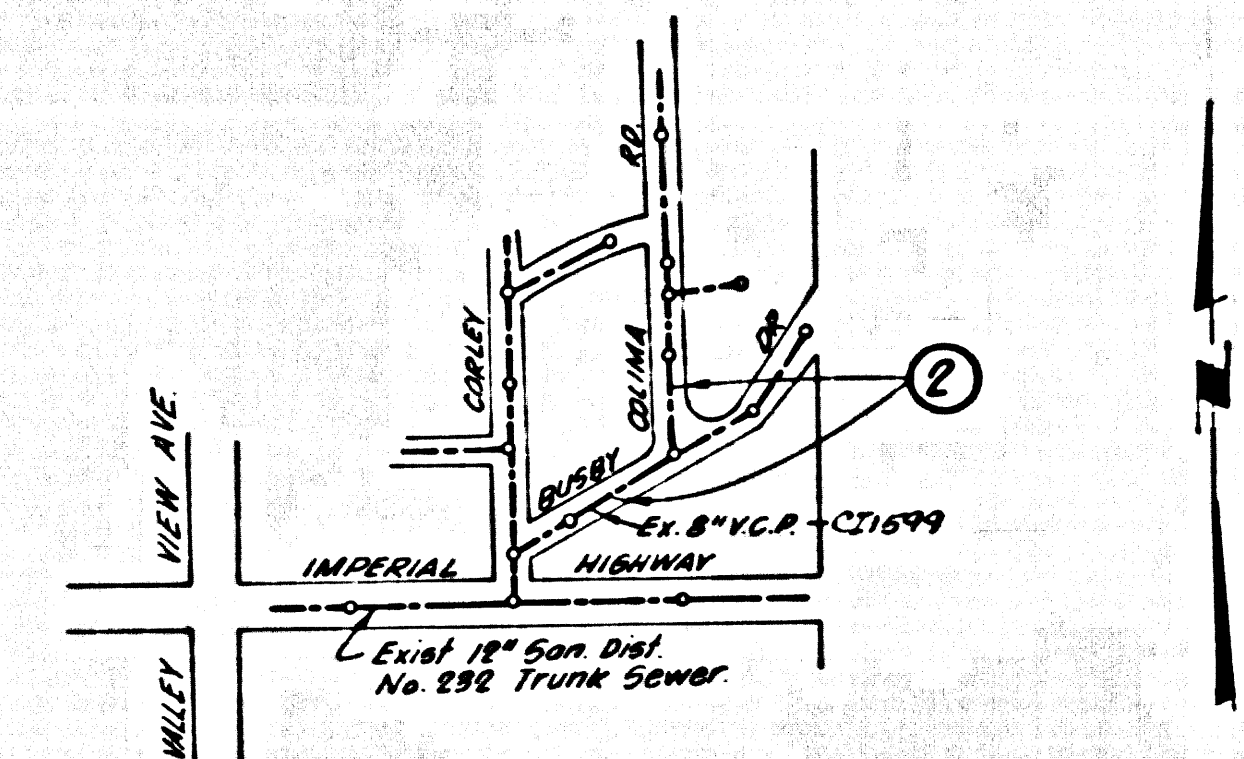

INDEX MAP  
 Scale: 1" = 600'  
 P.C. 8524  
 TRACT NO. 29615

DOUBLE VERTICAL SCALE  
 WHITTIER BLDG. DIST. NO. 11

- NOTE:
- HOUSE LATERALS TO BE CONSTRUCTED WITH INVERTS AT PROPERTY LINE 4 FEET BELOW CURB GRADE EXCEPT AS NOTED.
  - PROVIDE STAKES ON THE PROPERTY LINE OR PROPERTY LINES PRODUCED AT RIGHT ANGLES TO THE SEWER LINE AT THE CENTER LINE OF EACH MANHOLE.
  - NO REPRESENTATIVE OF THE COUNTY ENGINEER WILL SURVEY OR LAY OUT ANY PORTION OF THE WORK.
  - THE PRIVATE ENGINEER SHALL FURNISH THE COUNTY ENGINEER WITH GRADE SHEETS AND STATIONING FOR ALL HOUSE LATERALS AND "T" OR "Y" BRANCHES AND SHALL PROVIDE STAKES FOR THEM AT THEIR PROPER LOCATIONS WITH STATIONING PLAINLY MARKED. ALL HOUSE LATERALS SHALL BE CONSTRUCTED IN A STRAIGHT ALIGNMENT AT RIGHT ANGLES FROM THE MAIN LINE SEWER EXCEPT AS SHOWN ON THE PLANS. HOUSE LATERALS FROM CHIMNEYS SHALL NOT HAVE AN ANGLE OF LESS THAN 45° WITH THE MAIN LINE SEWER. ANY CHANGE IN ALIGNMENT SHALL BE REQUESTED BY WRITING BY THE PRIVATE ENGINEER.
  - THE PRIVATE ENGINEER SHALL FURNISH THE HOUSE LATERAL INVERT AT THE PROPERTY LINE BELOW THE TOP OF CURB ELEVATION FOR EACH HOUSE LATERAL ON THE GRADE SHEET.
  - NO REVISIONS SHALL BE MADE IN THESE PLANS WITHOUT THE APPROVAL OF THE COUNTY ENGINEER.
  - THE CONTRACTOR SHALL NOTIFY THE CONSTRUCTION DIVISION BY TELEPHONE, MAILBOX 9-27-07, EXT. 81328, AT LEAST TWENTY-FOUR HOURS BEFORE STARTING ANY WORK UNDER THIS CONTRACT.
  - SEE SPECIFICATIONS UNDER THE SEWER DIVISION FOR THE CONSTRUCTION OF SEWERS AND MANHOLES.
  - "T" OR "Y" BRANCHES MAY BE USED FOR CONNECTIONS TO MAINLINE SEWERS EXCEPT AS NOTED.
  - MANHOLE TOPS ON UNIMPROVED AREAS OR HAD TO BE SIX INCHES ABOVE FINISHED GRADE.
  - USE EXTRA STRENGTH PIPE. ALL PIPE IS STANDARD DEPTH EXCEPT AS NOTED.
  - WITHESED CLAY PIPE JOINTS SHALL BE TYPE "B", "C", OR "D" PER STANDARD SPECIFICATIONS SECTION 306.2.
  - IF A POWER POLE IS WITHIN THREE FEET OF THE SEWER, THE SEWER SHALL BE ENCASED, PER S-25, TWO FEET ON EACH SIDE FROM THE POINT OF INTERFERENCE.
  - IF DURING THE COURSE OF CONSTRUCTION IT IS DETERMINED THAT THERE IS LESS THAN FOUR FEET OF COVER OVER THE TOP OF A MAIN LINE OR HOUSE LATERAL V.C.P. SEWER WHICH IS NOT INDICATED ON THE PLANS, THE PIPE SHALL BE ENCASED PER S-25, UNLESS OTHERWISE APPROVED BY THE COUNTY ENGINEER.
  - REINFORCE ALL TRENCHES WITHIN PAVED AREAS TO MEET L.A. COUNTY ROAD DEPT. OR CALIFORNIA STATE HIGHWAY REQUIREMENTS IN ACCORDANCE WITH PERMITS.
  - SEWERS TO BE TESTED FOR LEAKAGE PER SECTION 306.2.5 BY THE STANDARD SPECIFICATIONS.
  - REFER TO SECTION 3-1.4.1 OF THE STANDARD SPECIFICATIONS, REGARDING SAFETY CHANGES.
  - ALL JOINTS BETWEEN CAST IRON PIPE AND WITHESED CLAY PIPE SHALL BE MADE WITH A RUBBER GASKET JOINT, TYPE "C" OR "D", WITH WASHING IF NECESSARY PER STANDARD SPECIFICATIONS, SECTION 306.2.
- THE FOLLOWING LATEST SEWER STANDARDS PLANS ON FILE IN THE OFFICE OF THE COUNTY ENGINEER SHALL APPLY IN THE CONSTRUCTION OF THIS PROJECT:
- |  |      |
|--|------|
| LEGEND                                   | 3-23 |
| MINIMUM PERMISSIBLE SLOPES               | 3-23 |
| UNDER MANHOLES                           | 3-23 |
| NON-UNIMPROVED AREAS                     | 3-23 |
| STANDARD MANHOLE DEPT.                   | 3-23 |
| STANDARD MANHOLE DEPT.                   | 3-23 |
| REVISIONS FOR SEWER PIPE                 | 3-23 |
| CALLING AND ENCLOSURE                    | 3-23 |
| TYPE OF THE SUPPORT                      | 3-23 |
| ALLOWABLE TRENCH WIDTHS                  | 3-23 |
| SEE C. E. 1899 FOR EXISTING SEWER LINES. | 3-23 |

PROFILE, ALIGNMENT AND GRADE OF  
 SANITARY SEWERS P.C. 8524  
 TO BE CONSTRUCTED IN PAGE 1

TRACT No 29615  
 PRIVATE CONTRACT NO. 8524

W.S. 34  
 SHEET 1 OF 2 PAGES  
 SCALE: VERT. 1" = 4'  
 HORIZ. 1" = 40'  
 PREPARED IN THE OFFICES OF  
 T.A. SHINN & ASSOCIATES  
 781 QUINN WAY PLACENTIA, CALIF.  
 REG. C. E. NO. 2646

NOTE:  
 GRADES TO WHICH THIS IMPROVEMENT IS TO BE CONSTRUCTED ARE SHOWN ON PLANS AND PROFILE. GRADE POINTS FOR TOP OF CURB, CENTER LINE OF STREETS, OR CENTER LINE OF ALLEYS ARE SHOWN BY CIRCLES ON PROFILE. ALL POINTS BETWEEN DESIGNATED POINTS THE GRADE SHALL BE ESTABLISHED SO AS TO CONFORM TO A STRAIGHT LINE DRAWN BETWEEN SAID DESIGNATED POINTS. ELEVATIONS ARE IN FEET ABOVE U.S.C. & G.S. MEAN SEA LEVEL UNLESS OTHERWISE NOTED.  
 WORK SHALL BE CONSTRUCTED ACCORDING TO THE STANDARD SPECIFICATIONS FOR PUBLIC WORKS CONSTRUCTION 1970 EDITION FOR THE CONSTRUCTION OF SANITARY SEWERS PARTS 1, 2, 1700, 1810, 1820, AND SHALL BE INSPECTED AND APPROVED BY THE PRESENCE OF THE COUNTY ENGINEER.  
 APPROVAL OF THIS PLAN BY THE COUNTY OF LOS ANGELES DOES NOT CONSTITUTE A REPRESENTATION AS TO THE ACCURACY OF THE LOCATION OF OR THE EXISTENCE OR NON-EXISTENCE OF ANY UNDERGROUND UTILITY PIPE OR STRUCTURE WITHIN THE LIMITS OF THE PROJECT. THE NOTE APPLIES TO ALL PAGES.  
 IF WORK IS TO BE DONE IN A STATE HIGHWAY, A PERMIT MUST BE OBTAINED FROM THE STATE OF CALIFORNIA, DIVISION OF HIGHWAYS, 130 SOUTH SPRING STREET, LOS ANGELES, CALIFORNIA.

COUNTY OF LOS ANGELES, CALIFORNIA  
 JOHN A. LAMMIE, COUNTY ENGINEER  
 APPROVED BY: [Signature]  
 REGIONAL ENGINEER  
 CHECKED BY: [Signature]  
 DATE: 3/26/71  
 REG. C. E. NO. 15731

COLLECT CHARGES  
 AS INDICATED

J.N. 0250.02

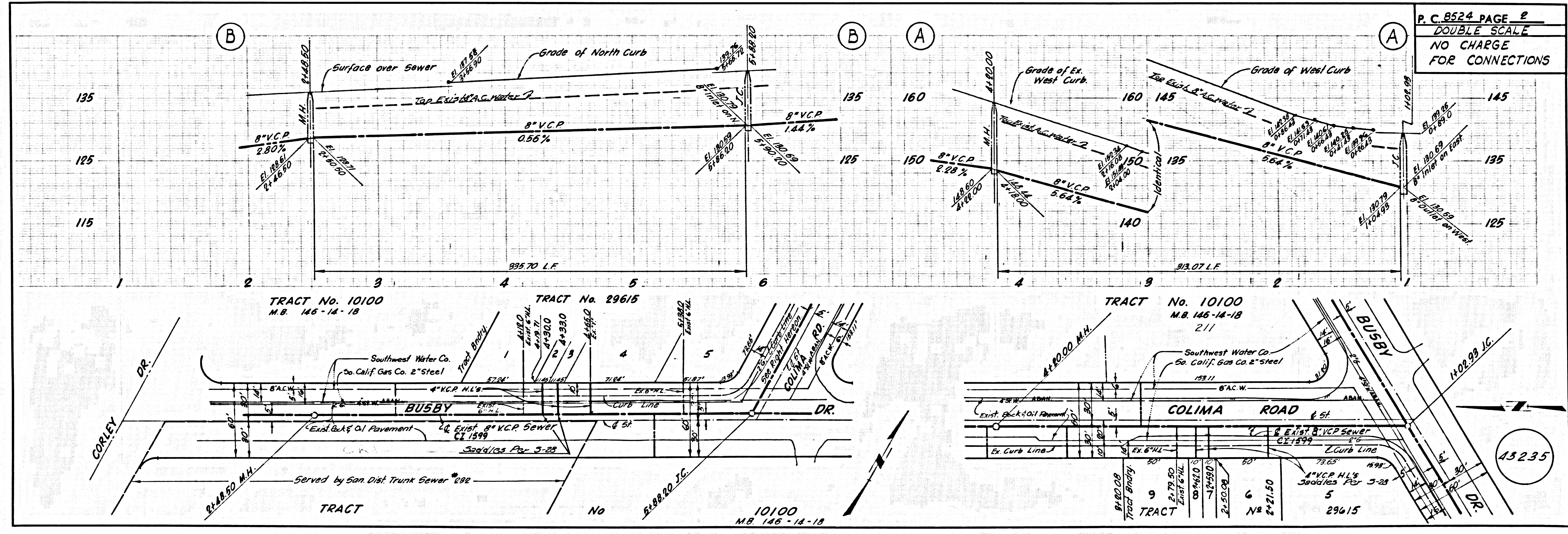

P.C. 8524 PAGE 2  
 DOUBLE SCALE  
 NO CHARGE  
 FOR CONNECTIONS

43235