

B.M. 11103 ELEV. 162.168  
BY SPK. IN CB. 15' N. OF S. END OF CB. 10  
M.E. COR. CARMELITA RD. & T.S.S.F. R.R. RW

QUAD. 1962.

P.C. P.B. 2179 PG. 10, BASED ON  
PRECISE LEVEL LINE NO. 4 R.M. 4-8  
REF. P.B. 1205 PG. 13.

Notes continued  
Telegraph Road sewer crossing Jack or tunnel. No interference allowed with existing traffic lanes. Be open cut only on Saturday or Sunday in accordance with the following requirements:  
1. Provide one 12' wide traffic lane in each direction with out detouring traffic across median.  
2. Use sand backfill for entire trench.  
3. Cover immediately with 5" of Type II A.C. over 18" of crushed aggregate base  
4. Seal with SS-2 H emulsion and 1/4" crushed rock.

NOTE by private engineer: The existence and approximate location of underground utilities or structures was determined by a search of the available public records. To the best of our knowledge there are no existing underground utilities or structures except as shown on these plans. The contractor is required to take precautionary measures to protect the utilities or structures shown on any other utility or structures at the site. It shall be the contractor's responsibility to notify the owners of the utilities or structures concerned before starting work.

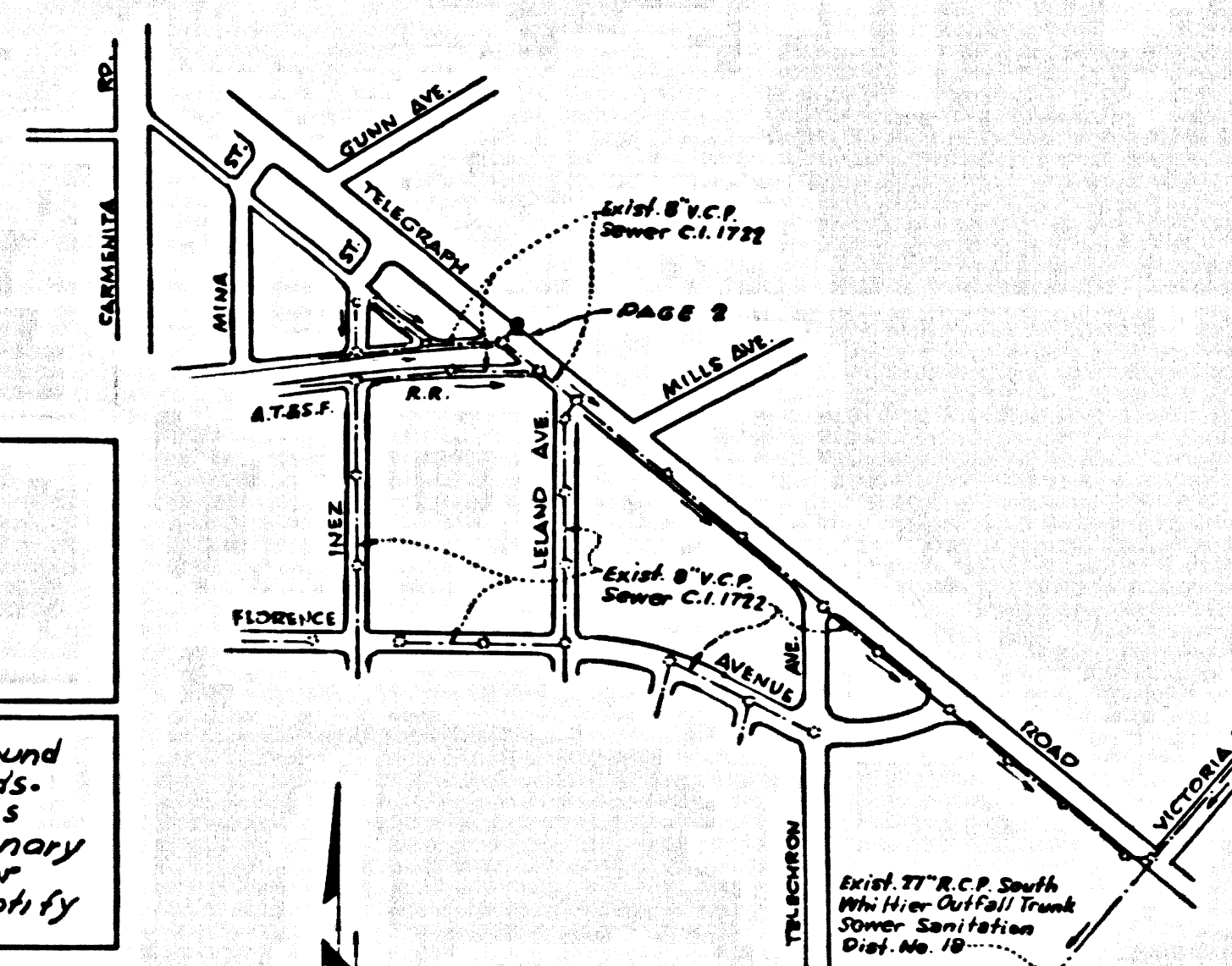

No connections for the disposal of industrial wastes shall be made to sewer shown on these drawings without written permission from the Chief Engineer and General Manager of the County Sanitation Districts.

County Sanitation Districts shall be notified prior to the following so that required inspection can be made (Phone 337-1025).

Acceptance of the project

COLLECT CHARGES AS INDICATED

WHITTIER BLDG. DIST. NO. 11

- NOTES:
- HOUSE LATERALS TO BE CONSTRUCTED WITH INVERTS AT PROPERTY LINE 4 FEET BELOW CURB GRADE EXCEPT AS NOTED.
  - PROVIDE STAKES ON THE PROPERTY LINE OR PROPERTY LINES PRODUCED AT RIGHT ANGLES TO THE SEWER LINE AT THE CENTER LINE OF EACH MANHOLE.
  - NO REPRESENTATIVE OF THE COUNTY ENGINEER WILL SURVEY OR LAY OUT ANY PORTION OF THE WORK.
  - THE PRIVATE ENGINEER SHALL FURNISH THE COUNTY ENGINEER WITH GRADE SHEETS AND STATIONING FOR ALL HOUSE LATERALS AND 12" BRANCHES AND SHALL PROVIDE STAKES FOR THEM AT THESE PROPER LOCATIONS WITH STATIONING PLAINLY MARKED. ALL HOUSE LATERALS SHALL BE CONSTRUCTED IN A STRAIGHT ALIGNMENT AT RIGHT ANGLES FROM THE MAIN LINE SEWER EXCEPT AS SHOWN ON THE PLANS. HOUSE LATERALS FROM CHIMNEYS SHALL NOT HAVE AN ANGLE OF LESS THAN 45° WITH THE MAIN LINE SEWER. ANY CHANGE IN ALIGNMENT SHALL BE REQUESTED BY WRITING BY THE PRIVATE ENGINEER.
  - THE PRIVATE ENGINEER SHALL FURNISH THE HOUSE LATERAL DEPTH AT THE PROPERTY LINE BELOW THE TOP OF CURB ELEVATION FOR EACH HOUSE LATERAL ON THE GRADE SHEET.
  - NO REVISIONS SHALL BE MADE ON THESE PLANS WITHOUT THE APPROVAL OF THE COUNTY ENGINEER.
  - THE CONTRACTOR SHALL NOTIFY THE CONSTRUCTION DIVISION BY TELEPHONE, MADISON 9-267, EXT. 2150, AT LEAST TWENTY-FOUR HOURS BEFORE STARTING ANY WORK UNDER THIS CONTRACT.
  - ALL STRUCTURES SHALL BE EITHER BRICK MANHOLES PER S-3 OR PRECAST CONCRETE MANHOLES PER S-3-B.
  - 12" BRANCHES TO BE USED FOR CONNECTIONS TO MAINLINE SEWERS EXCEPT AS NOTED.
  - MANHOLE TOPS IN UNIMPROVED AREAS OF WAY TO BE 12" FINISHED GRADE.
  - USE EXTRA STRENGTH PIPE, ALL PIPE IS STANDARD DEPTH EXCEPT AS NOTED.
  - WITHIN CLAY PIPE JOINTS SHALL BE TYPE "H", "F", OR "G" PER STANDARD SPECIFICATIONS SECTION 306-5.
  - IF A POWER POLE IS WITHIN 10'-12' FEET OF THE SEWER, THE SEWER SHALL BE ENCASED, PER S-2, TWO FEET ON EACH SIDE FROM THE POINT OF INTERFERENCE.
  - IF DURING THE COURSE OF CONSTRUCTION IT IS DETERMINED THAT THERE IS LESS THAN FOUR FEET OF COVER OVER THE TOP OF A MAIN LINE OR HOUSE LATERAL V.C.P. SEWER WHICH IS NOT INDICATED ON THE PLANS, THE PIPE SHALL BE ENCASED PER S-2, UNLESS OTHERWISE APPROVED BY THE COUNTY ENGINEER.
  - REINFORCE ALL TRENCHES WITHIN PAVED AREAS TO MEET L.A. COUNTY ROAD DEPT. OR CALIFORNIA STATE HIGHWAY REQUIREMENTS IN ACCORDANCE WITH PERMITS. SEE NOTES ON LEFT.
  - SEWERS TO BE TESTED FOR LEAKAGE PER SECTION 306-5.3.7 OF THE STANDARD SPECIFICATIONS.
  - OPEN TO SECTION 314.1 OF THE STANDARD SPECIFICATIONS, INCLUDING LAVITY OWNERS.
  - ALL JOINTS BETWEEN CAST IRON PIPE AND WITHIN CLAY PIPE SHALL BE MADE WITH A RUBBER SLAVE JOINT, TYPE "C" OR "D", WITH BUSHING IF NECESSARY PER STANDARD SPECIFICATIONS, SECTION 306-2.

THE FOLLOWING LATEST REVISED STANDARD PLANS ON FILE IN THE OFFICE OF THE COUNTY ENGINEER SHALL APPLY IN THE CONSTRUCTION OF THIS PROJECT:

BRIDGE	SECTION 306-5.3.7
BRICK MANHOLE	S-3
MANHOLE FRAMES & COVERS FOR 12" MAIN	S-3-B
PRECAST CONCRETE MANHOLE	S-3-B
MANHOLE FRAME AND COVER	S-3-B
STANDARD MANHOLE EIP	S-3-B
BRIDGING FOR SEWER PIPE	S-3-B
CALLING AND ENCASING	S-2
WYE	S-2
ABSOLUTE TRENCH WIDTH	S-2
BRANCH CONNECTION INTO EXIST. M.H.	S-2

Notes continued to left hereon

PROFILE, ALIGNMENT AND GRADE OF  
SANITARY SEWERS  
TO BE CONSTRUCTED IN

TELEGRAPH ROAD

PRIVATE CONTRACT NO. 8533

W.S. 34  
SHEET 1 OF 2 PAGES

SCALE: VERT. 1" = 4' Sept. 1970  
HORIZ. 1" = 40'

PREPARED IN THE OFFICES OF  
GILBERT ENGINEERING CO.  
HARRY GILBERT REG. C.E. NO. 1737

NOTE: GRADES TO WHICH THIS IMPROVEMENT IS TO BE CONSTRUCTED ARE SHOWN ON PLANS AND PROFILE. GRADE POINTS FOR TOP OF CURB, CENTER LINE OF STREETS, OR CENTER LINE OF ALLEYS ARE SHOWN BY CIRCLES ON PROFILE. AT ALL POINTS BETWEEN INDICATED POINTS THE GRADE SHALL BE ESTABLISHED SO AS TO CONFORM TO A STRAIGHT LINE DRAWN BETWEEN SAID DESIGNATED POINTS. ELEVATIONS ARE IN FEET ABOVE U.S.C. & G.S. MEAN SEA LEVEL DATUM OF 1929.

WORK SHALL BE CONSTRUCTED ACCORDING TO THE STANDARD SPECIFICATIONS FOR PUBLIC WORKS CONSTRUCTION AND SPECIAL PROVISIONS FOR THE CONSTRUCTION OF SANITARY SEWERS DATED APRIL 1, 1968 AS REVISED, AND SHALL BE PROCEEDED ONLY IN THE PRESENCE OF THE COUNTY ENGINEER.

WHEN WORK CAN BE STARTED, THE CONTRACTOR MUST OBTAIN A PERMIT TO EXCAVATE IN COUNTY TRACTS FROM THE L. A. COUNTY ROAD DEPT., DISTRICT OFFICE NO. 11, AND PAY A FEE TO THE COUNTY ENGINEER, ROOM 308, COUNTY ENGINEERING BUILDING, 116 WEST SECOND STREET OR ..... 500 S. GARDEN ST. REGIONAL OFFICE, SUFFICIENT TO COVER THE COST OF CONSTRUCTION INSPECTION AND RECORD PLANS.

APPROVAL OF THIS PLAN BY THE COUNTY OF LOS ANGELES DOES NOT CONSTITUTE A REPRESENTATION AS TO THE ACCURACY OF THE LOCATION OF OR THE EXISTENCE OR NON-EXISTENCE OF ANY UNDERGROUND UTILITY PIPE, OR STRUCTURE WITHIN THE LIMITS OF THIS PROJECT. THE USER APPEALS TO ALL PAGES.

IF WORK IS TO BE DONE IN A STATE HIGHWAY, A PERMIT MUST BE OBTAINED FROM THE STATE OF CALIFORNIA, DIVISION OF HIGHWAYS, 120 SOUTH BRIDGE STREET, LOS ANGELES, CALIFORNIA.

COUNTY OF LOS ANGELES, CALIFORNIA  
JOHN A. LAMBE, COUNTY ENGINEER J. D. PARKHURST, CHIEF ENGINEER

APPROVED BY: [Signature] DATE: 11/12/70 APPROVED BY: [Signature] DATE: 11/12/70  
REGIONAL ENGINEER OFFICE ENGINEER

CHECKED BY: [Signature] DATE: 11/12/70  
REG. C.E. NO. 15931

42105

J.N. 0370.72

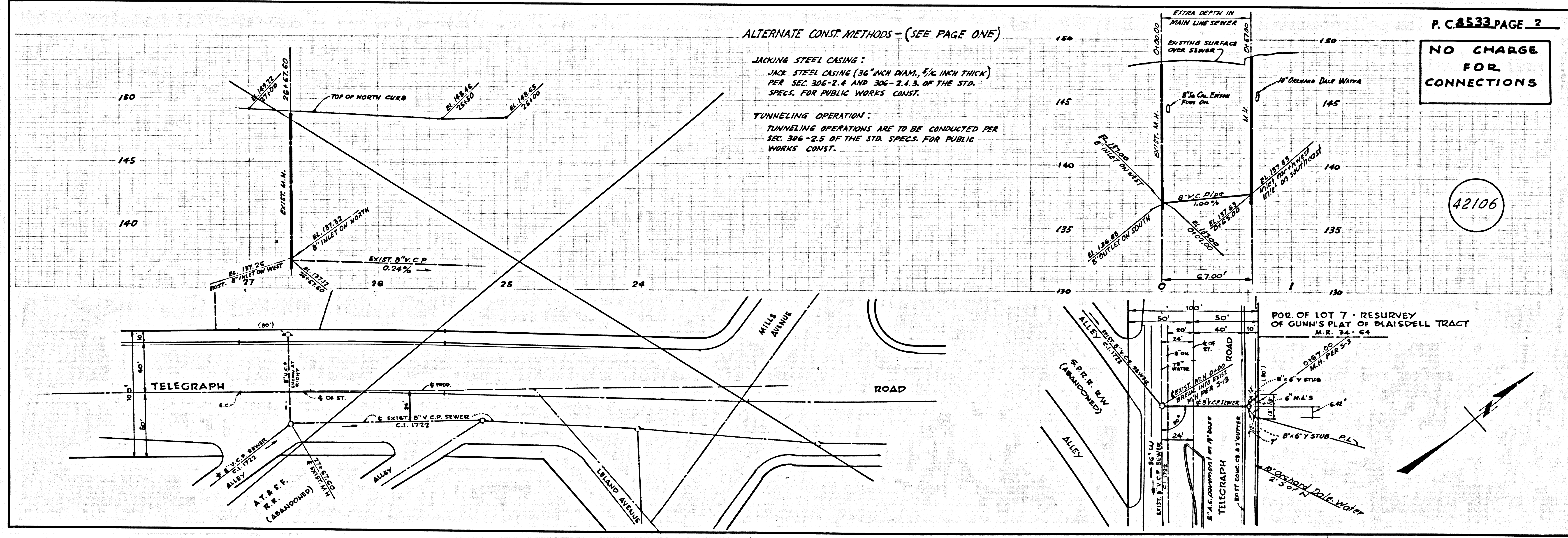

ALTERNATE CONST. METHODS - (SEE PAGE ONE)

JACKING STEEL CASING:  
JACK STEEL CASING (36" DIAM., 5/16" THICK)  
PER SEC. 306-2.4 AND 306-2.4.3 OF THE STD. SPECS. FOR PUBLIC WORKS CONST.

TUNNELING OPERATION:  
TUNNELING OPERATIONS ARE TO BE CONDUCTED PER SEC. 306-2.5 OF THE STD. SPECS. FOR PUBLIC WORKS CONST.

P.C. 8533 PAGE 2

NO CHARGE FOR CONNECTIONS

42106