

B.M. BY 2979 ELEV. 62.969  
 F.C. BR. CAP 5 1/4" S ANGLE POINT WING-  
 WALL S.W. COR. BRIDGE N. 774 ON  
 ALAMEDA ST. OVER COMPTON CREEK  
 25' IN V. 1:600 = S. ADITIA BLD. N. 1011-331  
 BASELINE QUAD. 1902

THE FOLLOWING LATEST REVISED STANDARD PLANS  
 ON FILE IN THE OFFICE OF THE COUNTY ENGINEER  
 SHALL APPLY IN THE CONSTRUCTION OF THIS PROJECT

LEGEND	
MINIMUM PUBLIC SAFETY REQUIREMENTS	5-1
BRICK MANHOLE	5-2
NEW-REINFORCED PRECAST CONCRETE MANHOLE	5-3
MANHOLE FRAME AND COVER	5-3B
STANDARD MANHOLE STEP	5-17
BEDDING FOR SEWER PIPE	5-21
CRADLING AND ENCASMENT	5-23
WIRE OR TIE SUPPORT	5-26
ALLOWABLE TRENCH WIDTHS	5-39

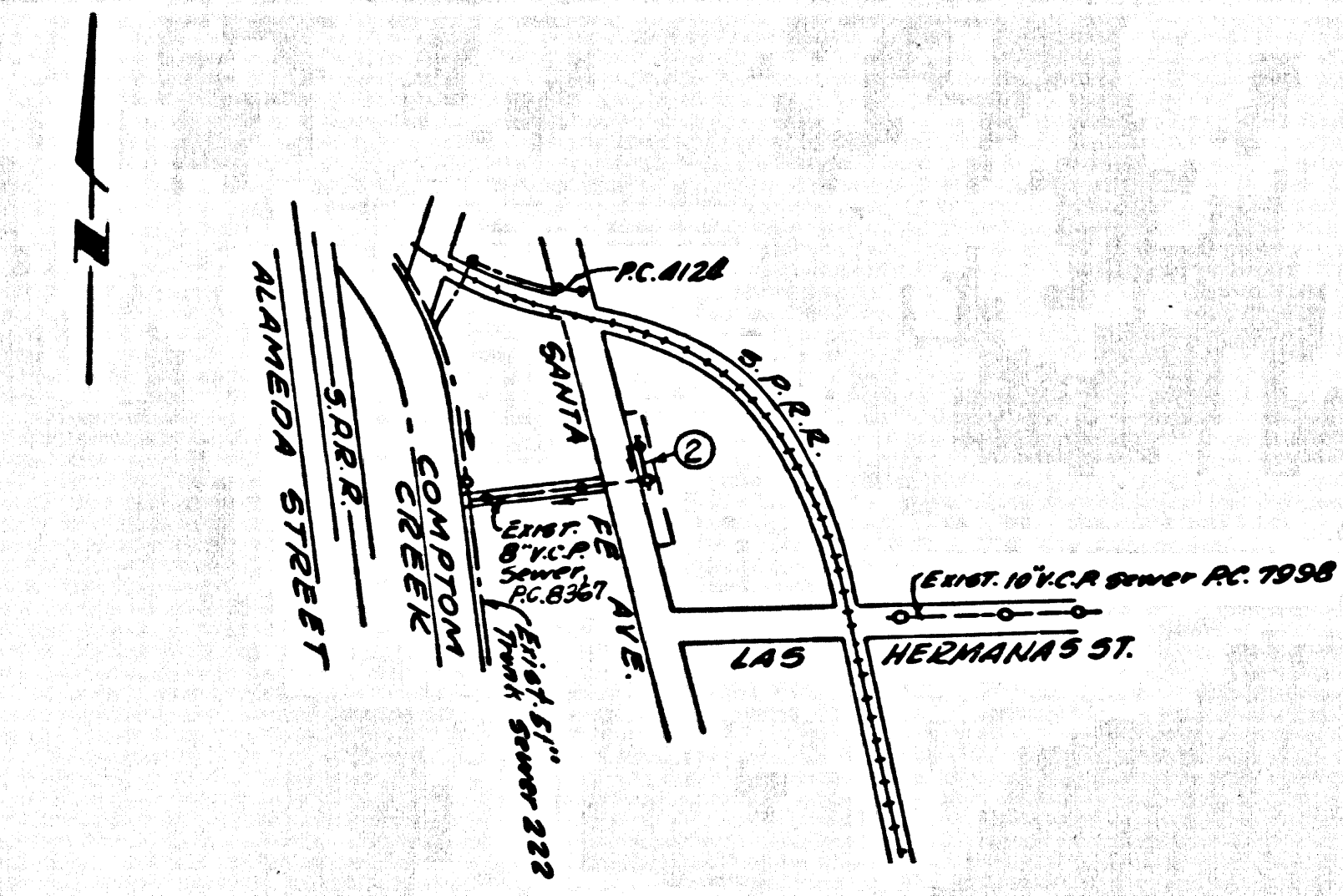

INDEX MAP  
 P.C. 8553  
 Scale: 1" = 600'

No connections for the disposal of  
 industrial wastes shall be made to  
 sewers shown on these drawings  
 without written permission from the  
 Chief Engineer and General Manager  
 of the County Sanitation Districts.

County Sanitation Districts shall be  
 notified prior to the following so  
 that required inspection can be made  
 (Phone numbers: 538-116)

Acceptance of the project.

**NOTICE TO CONTRACTOR - CONT'D.**  
 CONTRACTORS ARE CAUTIONED TO OBSERVE THE FOLLOWING RULE  
 IN USING THE GRADE STAKES GIVEN BY THE ENGINEER FOR POINTS  
 IN PLANS. THESE CONSECUTIVE POINTS THAT ARE SHOWN TO BE  
 ON THE SAME DATE OF SETTING MUST BE USED IN COMMON IN  
 ORDER THAT ANY VARIATION OUT OF A PERFECT STRAIGHT  
 GRADE MAY BE DETECTED, AND IN CASE ANY SUCH DISCREP-  
 ANCY IS FOUND, THE SAME MUST BE REPORTED. OTHERWISE  
 THIS OFFICE WILL NOT BE RESPONSIBLE FOR ANY ERROR IN  
 THE GRADE OF THE FINISHED WORK.

**DOMINGUEZ BLDG. DIST. NO. 13**

- NOTES:
- PROVIDE STAKES ON THE PROPERTY LINE OR PROPERTY LINES PRODUCED AT RIGHT ANGLES TO THE SEWER LINE AT THE CENTER LINE OF EACH MANHOLE.
  - NO REPRESENTATIVE OF THE COUNTY ENGINEER WILL SURVEY OR LAY OUT ANY PORTION OF THE WORK.
  - THE PRIVATE ENGINEER SHALL FURNISH THE COUNTY ENGINEER WITH GRADE SHEETS AND STATIONING FOR ALL HOUSE LATERALS AND "T" BRANCHES AND SHALL PROVIDE STAKES FOR THEM AT THEIR PROPER LOCATIONS WITH STATIONING PLAINLY MARKED. ALL HOUSE LATERALS SHALL BE CONSTRUCTED IN A STRAIGHT ALIGNMENT AT RIGHT ANGLES FROM THE MAIN LINE SEWER EXCEPT AS SHOWN ON THE PLANS. HOUSE LATERALS FROM CHIMNEYS SHALL NOT HAVE AN ANGLE OF LESS THAN 45° WITH THE MAIN LINE SEWER. ANY CHANGE IN ALIGNMENT SHALL BE REQUESTED IN WRITING BY THE PRIVATE ENGINEER.
  - THE PRIVATE ENGINEER SHALL FURNISH THE HOUSE LATERAL DEPTH AT THE PROPERTY LINE BELOW THE TOP OF CURB ELEVATION FOR EACH HOUSE LATERAL ON THE GRADE SHEET.
  - NO REVISIONS SHALL BE MADE IN THESE PLANS WITHOUT THE APPROVAL OF THE COUNTY ENGINEER.
  - THE CONTRACTOR SHALL NOTIFY THE CONSTRUCTION DIVISION BY TELEPHONE, MADISON 9-0200, EXT. 8148, AT LEAST TWENTY-FOUR HOURS BEFORE STARTING ANY WORK UNDER THIS CONTRACT.
  - ALL STRUCTURES SHALL BE EITHER BRICK MANHOLES PER 5-3 OR PRECAST CONCRETE MANHOLES PER 5-3B, EXCEPT AS NOTED.
  - USE STANDARD MANHOLE FRAMES AND COVERS, 5-3B, EXCEPT AS NOTED.
  - MANHOLE TOPS IN UNIMPROVED RIGHTS-OF-WAY TO BE SIX INCHES ABOVE FINISHED GRADE.
  - USE EXTRA STRENGTH PIPE. ALL PIPE IS STANDARD DEPTH EXCEPT AS NOTED.
  - UNGRADED CLAY PIPE JOINTS SHALL BE TYPE "D", 12" OR 8" PER S.D. S.P.C.S., SEC. 208-2.
  - IF A POWER POLE IS WITHIN THREE FEET OF THE SEWER, THE SEWER SHALL BE ENCASED, PER 5-23, TWO FEET ON EACH SIDE FROM THE POINT OF INTERFERENCE.
  - IF DURING THE COURSE OF CONSTRUCTION IT IS DETERMINED THAT THERE IS LESS THAN FOUR FEET OF COVER OVER THE TOP OF A MAIN LINE OR HOUSE LATERAL V.C.P. SEWER WHICH IS NOT INDICATED ON THE PLANS, THE PIPE SHALL BE ENCASED PER 5-23, UNLESS OTHERWISE APPROVED BY THE COUNTY ENGINEER.
  - HOUSE LATERALS TO BE CONSTRUCTED WITH INVERTS AT PROPERTY LINE & FEET BELOW CURB GRADE EXCEPT AS NOTED.
  - RESURFACE ALL TRENCHES WITHIN PAVED AREAS TO MEET L.A. COUNTY ROAD DEPT. OR CALIFORNIA STATE HIGHWAY REQUIREMENTS IN ACCORDANCE WITH PERMITS.
  - SEWERS TO BE TRENCHED FOR LATERALS PER SECTION 308-2.3.7 OF THE S.D. S.P.C.S.
  - REFER TO SECTION 204-1.1 OF THE S.D. S.P.C.S., REGARDING SAFETY ORDERS.
  - ALL JOINTS BETWEEN CAST-IRON PIPE AND UNGRADED CLAY PIPE SHALL BE MADE WITH A RUBBER BLEBLET JOINT, TYPE "C" OR "D", WITH BUSHING IN NECESSARY PER S.D. S.P.C.S. 208-2.

**COLLECT CHARGES AS INDICATED**

**NOTICE TO CONTRACTOR**  
 The existence and location of any underground utility pipes of structures shown on these plans to the best of my knowledge there are no existing utility records shown on these plans. The contractor is required to take due precautionary measures to protect the utility lines shown and any other lines not of record. If the showings on these plans are incorrect, the contractor shall be responsible therefor.  
 J. D. Parkhurst  
 OCT. 1950

PROFILE ALIGNMENT AND GRADE OF **P.C. 8553**

**SANITARY SEWERS PAGE 1**

TO BE CONSTRUCTED IN

**PARCEL MAP NO. 1625**

**PRIVATE CONTRACT NO. 8553**

W.S. 32

1 SHEET 2 PAGES

SCALE: HORIZ. 1" = 40'

VERT. 1" = 4'

DATE: **OCT. 1950**

PREPARED IN THE OFFICES OF

**E.L. PEARSON & ASSOC.**

REG. C. E. NO. 13560

FOR LEGEND SEE PLAN NO. 5-1

NOTE:  
 GRADES TO WHICH THE IMPROVEMENT IS TO BE CONSTRUCTED ARE SHOWN ON PLANS AND PROFILES. GRADE POINTS FOR TOP OF CURBS, CENTER LINE OF STREETS, OR CENTER LINE OF ALLEYS ARE SHOWN BY CIRCLES ON PROFILES. AT ALL POINTS BETWEEN DESIGNATED POINTS THE GRADE SHALL BE ESTABLISHED SO AS TO CONFORM TO A STRAIGHT LINE DRAWN BETWEEN SAID DESIGNATED POINTS. ELEVATIONS ARE IN FEET ABOVE U.S.C. & G.S. MEAN LEVEL DATUM OF 1929.  
 THIS DRAWING AND THE DATA HEREON ARE HEREBY MADE A PART OF THE SPECIFICATIONS.  
 BEFORE THE CONSTRUCTION OF SANITARY SEWERS UNDER THIS CONTRACT SHALL BE PROCEEDED BY THE CONTRACTOR AND COUNTY ENGINEER SHALL BE STATED, THE CONTRACTOR MUST OBTAIN A PERMIT TO EXCAVATE IN COUNTY RIGHTS FROM THE L.A. COUNTY ROAD DEPT., DISTRICT OFFICE NO. 30 AND PAY A FEE TO THE COUNTY ENGINEER, ROOM 300, COUNTY ENGINEERING BUILDING, 100 WEST SECOND STREET, LOS ANGELES, CALIFORNIA. REGULAR OFFICE HOURS TO COVER THE COST OF CONSTRUCTION INSPECTION AND RECORD PLANS.  
 APPROVAL OF THIS PLAN BY THE COUNTY OF LOS ANGELES DOES NOT CONSTITUTE A REPRESENTATION AS TO THE ACCURACY OF THE LOCATION OF OR THE EXISTENCE OR NON-EXISTENCE OF ANY UNDERGROUND UTILITY PIPE, OR STRUCTURE WITHIN THE LIMITS OF THIS PROJECT. THIS NOTE APPLIES TO ALL PAGES.  
 IF WORK IS TO BE DONE IN A STATE HIGHWAY, A PERMIT MUST BE OBTAINED FROM THE STATE OF CALIFORNIA, DIVISION OF HIGHWAYS, 136 SOUTH BRINK STREET, LOS ANGELES, CALIFORNIA.

**COUNTY OF LOS ANGELES, CALIFORNIA**  
**JOHN A. LAMBE, COUNTY ENGINEER**  
**J. D. PARKHURST, CHIEF ENGINEER**  
 CO. SAN. DIS. NO. 13560  
 APPROVED BY: *[Signature]* OFFICE ENGINEER

CHECKED BY: *[Signature]* 10/28/50  
 REG. C. E. NO. 13563

**P.C. 8553 PAGE 2**  
**NO CHARGE FOR CONNECTIONS**

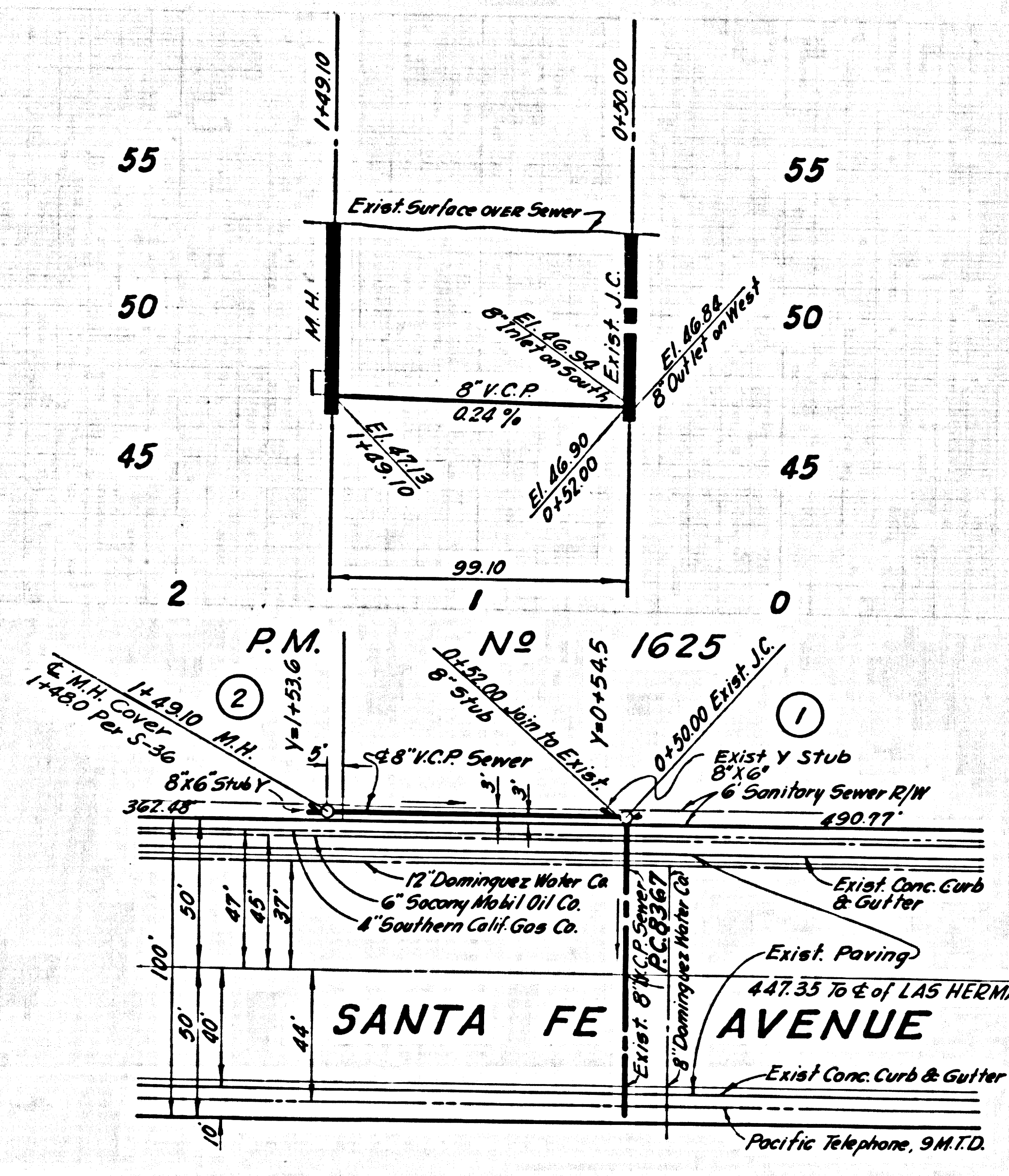

43472