

B.M. B.Q. 3130 ELEV. 854.704
 R.O.B.M. 710 N. Co. 117 W. S.C.R. @
 NW COR. PATRICKS FERRY ROAD
 SPONGS DRIVE. 40' F.N. 132' F.W.
 AT APPROX. 4 INT.
 DISTANCE
 QUAD. 19 65

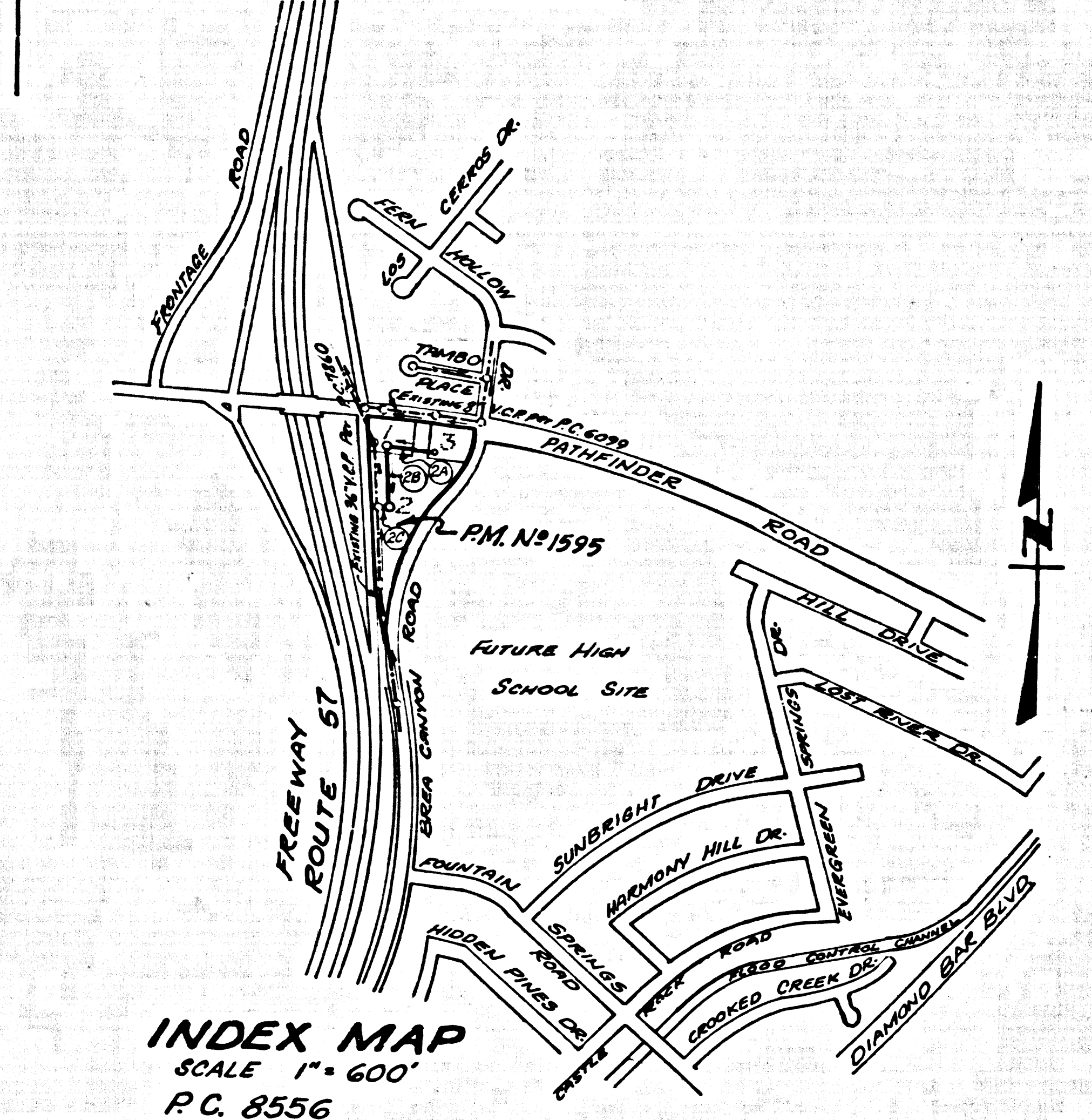

INDEX MAP
 SCALE 1" = 600'
 P.C. 8556

- THE FOLLOWING LATEST REVISED STANDARD PLANS ON FILE IN THE OFFICE OF THE COUNTY ENGINEER SHALL APPLY IN THE CONSTRUCTION OF THIS PROJECT.
- LEGEND
- MINIMUM PUBLIC SAFETY REQUIREMENTS - S-1
 - BRICK MANHOLES - S-2
 - STANDARD MANHOLE STEPS - S-3
 - BEDDING FOR SEWER PIPE - S-4
 - PIPE OR TEE SUPPORT - S-5
 - ALLOWABLE TRENCH WIDTHS - S-6
 - LOADING MANHOLE FRAMES AND COVER - S-7
 - NON-REINFORCED PRECAST CONCRETE MANHOLE - S-8

No connections for the disposal of industrial wastes shall be made to sewers shown on these drawings without written permission from the Chief Engineer and General Manager of the County Sanitation Districts.

County Sanitation Districts shall be notified prior to the following so that required inspections can be made (Phone 337-1925)

Acceptance of the project.

DOUBLE SCALE VERTICAL
 SAN DIMAS BLDG. DIST. NO. 10

- NOTES
1. PROVIDE STAKES ON THE PROPERTY LINE OR PROPERTY LINES PRODUCED AT RIGHT ANGLES TO THE SEWER LINE AT THE CENTER LINE OF EACH MANHOLE.
 2. THE PRIVATE ENGINEER SHALL FURNISH THE COUNTY ENGINEER WITH GRADE SHEETS AND STATIONINGS FOR ALL HOUSE LATERALS AND 60" V.C.P. BRANCHES AND SHALL PROVIDE STAKES FOR THEM AT THEIR PROPER LOCATIONS WITH STATIONING PLAINLY MARKED. ALL HOUSE LATERALS SHALL BE CONSTRUCTED IN A STRAIGHT ALIGNMENT AT RIGHT ANGLES FROM THE MAIN LINE SEWER EXCEPT AS SHOWN ON THE PLANS. HOUSE LATERALS FROM CHIMNEYS SHALL HAVE AN ANGLE OF LESS THAN 45° WITH THE MAIN LINE SEWER. ANY CHANGE IN ALIGNMENT SHALL BE REQUESTED BY WRITING BY THE PRIVATE ENGINEER.
 3. THE PRIVATE ENGINEER SHALL FURNISH THE HOUSE LATERAL DEPTH AT THE PROPERTY LINE BELOW THE TOP OF CURB ELEVATION FOR EACH HOUSE LATERAL ON THE GRADE SHEET.
 4. NO REVISIONS SHALL BE MADE IN THESE PLANS WITHOUT THE APPROVAL OF THE COUNTY ENGINEER.
 5. THE CONTRACTOR SHALL NOTIFY THE CONSTRUCTION DIVISION BY TELEPHONE, MADISON 9-8747, EXT. 81281, AT LEAST TWENTY-FOUR HOURS BEFORE STARTING ANY WORK UNDER THIS CONTRACT.
 6. MANHOLES SHALL BE BRICK SEWER STRUCTURES PER S-2, EXCEPT FOR MANHOLES PER S-3, WHICH ARE AS NOTED.
 7. USE STANDARD MANHOLE STEPS AND COVERS.
 8. MANHOLE TOPS IN UNIMPROVED RIGHTS-OF-WAY TO BE SIX INCHES ABOVE FINISHED GRADE.
 9. USE EXTRA STRENGTH PIPE. ALL PIPE IS STANDARD DEPTH EXCEPT AS NOTED.
 10. IF A POWER POLE IS WITHIN THREE FEET OF THE SEWER, THE SEWER SHALL BE ENCASED, PER S-23, ONE (1) FOOT EACH SIDE FROM THE POINT OF INTERFERENCE.
 11. IF DURING THE COURSE OF CONSTRUCTION IT IS DETERMINED THAT THERE IS LESS THAN FOUR FEET OF COVER OVER THE TOP OF A MAIN LINE OR HOUSE LATERAL V.C.P. SEWER WHICH IS NOT INDICATED ON THE PLANS, THE PIPE SHALL BE ENCASED PER S-23, ONE (1) FOOT EACH SIDE FROM THE POINT OF INTERFERENCE.
 12. HOUSE LATERALS TO BE CONSTRUCTED WITH INVERTS AT PROPERTY LINE 4 FEET BELOW CURB GRADE EXCEPT AS NOTED.
 13. REINFORCE ALL TRENCHES WITHIN PAVED AREAS TO MEET L.A. COUNTY ROAD DEPT. OR CALIFORNIA STATE HIGHWAY REQUIREMENTS IN ACCORDANCE WITH PERMITS.
 14. SHOW IN THE PLANS THE LOCATION AND DEPTH OF ALL EXISTING UTILITIES AND SPECIAL PROVISIONS.
 15. ALL UTILITIES SHOWN ON THE PLANS ARE TO BE MAINTAINED AND PROTECTED BY THE CONTRACTOR THROUGHOUT THE CONSTRUCTION PERIOD. THE CONTRACTOR SHALL BE RESPONSIBLE FOR THE PROTECTION OF ALL UTILITIES AND SHALL BE RESPONSIBLE FOR THE REPAIR OF ANY UTILITIES DAMAGED BY THE CONSTRUCTION OF THIS PROJECT.
 16. REINFORCE ALL TRENCHES WITHIN PAVED AREAS TO MEET L.A. COUNTY ROAD DEPT. OR CALIFORNIA STATE HIGHWAY REQUIREMENTS IN ACCORDANCE WITH PERMITS.

COLLECT CHARGES AS INDICATED

NOTICE TO CONTRACTOR

The existence and location of any underground utility pipes or structures shown on these plans are obtained by a search of the available records. To the best of my knowledge there are no existing utilities except as shown on these plans. The contractor is required to take the usual customary measures to protect the utility lines and any other structures shown on these plans. Lines not of record or not shown on these plans.

4/27/57
 R.L.L./BBOT

PROFILE, ALIGNMENT AND GRADE OF
 SANITARY SEWERS PAGE 1
 CONSTRUCTED IN

PARCEL MAP NO. 1595
 PRIVATE CONTRACT NO. 8556

W.S. 39
 1 SHEETS, 2 PAGES
 SCALE: VERT. 1" = 8'
 HORIZ. 1" = 40'
 OCTOBER, 1970
 PREPARED IN THE OFFICES OF
 THE STATE ENGINEERING COMPANY
 615 24th STREET, LOS ANGELES, CALIFORNIA 90012
 REG. C.E. NO. 12207

NOTES

GRADES TO WHICH THIS IMPROVEMENT IS TO BE CONSTRUCTED ARE SHOWN ON PLANS AND PROFILES. GREAT POINTS FOR TOP OF CURB, CENTER LINE OF STREETS, OR CENTER LINE OF ALLEYS ARE SHOWN BY CIRCLES ON PROFILES. AT ALL POINTS BETWEEN DESIGNATED ELEVATIONS ARE IN FEET ABOVE U.C. & G.E. SEA LEVEL DATUM OF 1929. THIS DRAWING AND THE DATA HEREON ARE HEREBY MADE A PART OF THE SPECIFICATIONS WHICH SHALL BE CONSTRUCTED ACCORDING TO STANDARD SPECIFICATIONS FOR PUBLIC UTILITIES (SECTION 100-10) AND COUNTY ENGINEER'S MANUAL, COUNTY OF LOS ANGELES, CALIFORNIA, 1968. THE CONTRACTOR SHALL BE RESPONSIBLE FOR THE PROTECTION OF ALL UTILITIES AND SHALL BE RESPONSIBLE FOR THE REPAIR OF ANY UTILITIES DAMAGED BY THE CONSTRUCTION OF THIS PROJECT. THE CONTRACTOR SHALL BE RESPONSIBLE FOR THE PROTECTION OF ALL UTILITIES AND SHALL BE RESPONSIBLE FOR THE REPAIR OF ANY UTILITIES DAMAGED BY THE CONSTRUCTION OF THIS PROJECT. THE CONTRACTOR SHALL BE RESPONSIBLE FOR THE PROTECTION OF ALL UTILITIES AND SHALL BE RESPONSIBLE FOR THE REPAIR OF ANY UTILITIES DAMAGED BY THE CONSTRUCTION OF THIS PROJECT.

COUNTY OF LOS ANGELES, CALIFORNIA
 JOHN A. LAMBE, COUNTY ENGINEER
 I. D. PARKHURST, CHIEF ENGINEER
 CO. SAN. DIST. NO. 10
 APPROVED BY: [Signature]
 OFFICE ENGINEER

CHECKED BY: Thomas Howard, 11 Dec 70
 REG. C.E. NO. 12122

42641

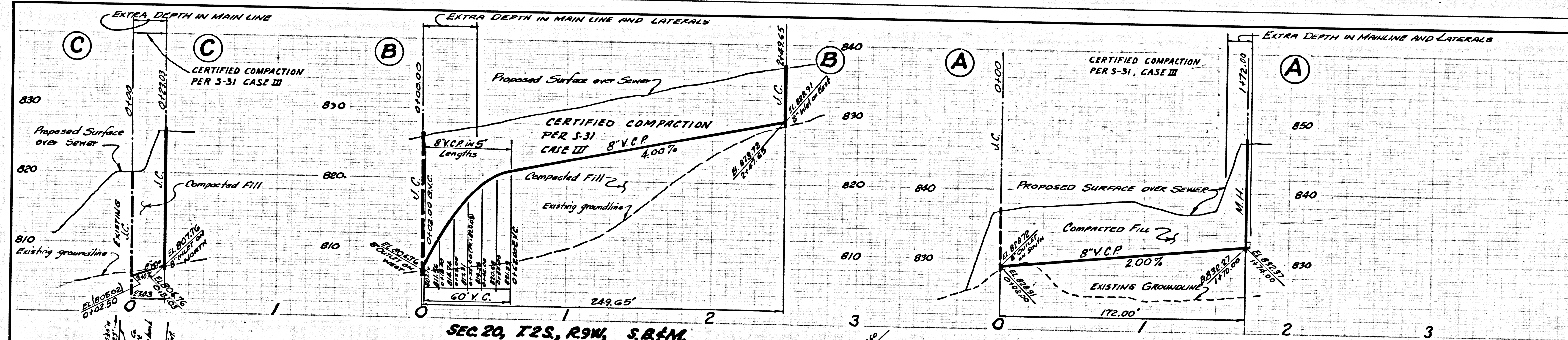

P.C. 8556 PAGE 2
 NO CHARGE FOR CONNECTIONS
 DOUBLE SCALE

42642

