

B.M. BY 1230 ELEV. 216.752  
 L. & T. N.E. Cor. Conc. Wk. 20' W.  
 E. Colima Rd. 45' S. E. Broadway  
 House #10901 Colima Rd.  
 SANTA FE QUAD. 19 65

NOTES CONTINUED FROM BELOW AT RIGHT  
 19. ALL JOINTS BETWEEN CAST IRON AND VITRIFIED CLAY PIPE SHALL BE MADE WITH A RUBBER SLEEVE JOINT TYPE C OR D (WITH BUSHING IF NECESSARY) PER STANDARD SPECIFICATIONS, SECTION 208.2  
 20. SEWERS TO BE TESTED FOR LEAKAGE PER SECTION 806-237 OF THE STANDARD SPECIFICATIONS AND SPECIAL PROVISIONS.

THE FOLLOWING LATEST REVISED STANDARD PLANS ON FILE IN THE OFFICE OF THE COUNTY ENGINEER SHALL APPLY IN THE CONSTRUCTION OF THIS PROJECT.

LEGEND	5-1
MINIMUM PUBLIC SAFETY REQUIREMENTS	5-2
BRICK MANHOLE	5-3
STANDARD MANHOLE STEP	5-17
BEDDING FOR SEWER PIPE	5-21
CRAWLING AND ENCASMENT	5-23
WYE OR TEE SUPPORT	5-24
ALLOWABLE TRENCH WIDTHS	5-33
LOCKING MANHOLE FRAME AND COVER (FOR 8-36 M.H.)	5-35
NON REINFORCED PRECAST CONCRETE MANHOLE	5-36

County Sanitation Districts shall be notified prior to the following so that required inspection can be made (Phone 537-1025 or 538-1151)

County Sanitation Districts shall be notified prior to the following so that required inspection can be made (Phone 537-1025 or 538-1151)

No connections for the disposal of industrial wastes shall be made to sewers shown on these drawings without written permission from the Chief Engineer and General Manager of the County Sanitation Districts.

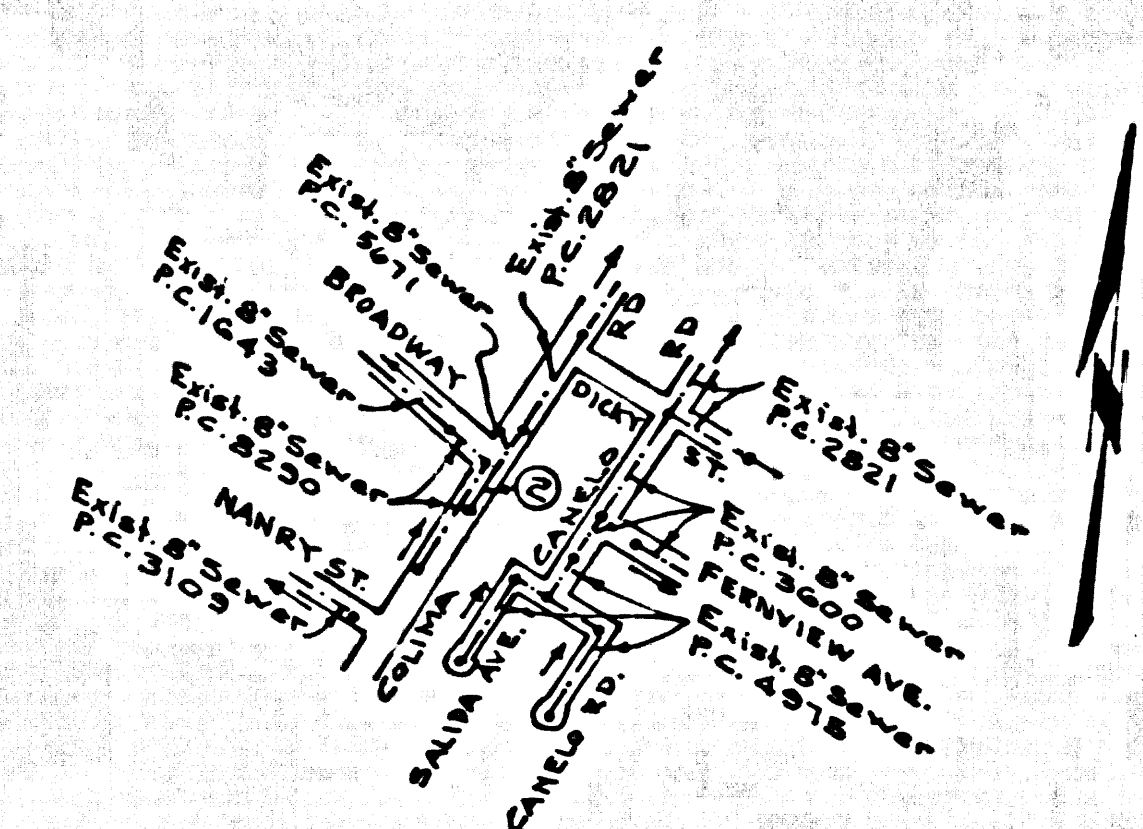

TRAFFIC REQUIREMENTS FOR COLIMA ROAD:  
 DURING THE HOURS OF 8:30 A.M. TO 3:30 P.M. TRAFFIC MAY BE REDUCED TO ONE LANE CONTROLLED BY A FLAGMAN. AT ALL OTHER TIMES MAINTAIN ONE LANE IN EACH DIRECTION.

WHITTIER BLDG. DIST. NO. 11

- NOTES:
1. PROFILE STAGES ON THE PROPERTY LINE OR PROPERTY LINES PRODUCED AT RIGHT ANGLES TO THE SEWER LINE AT THE CENTER LINE OF EACH MANHOLE.
  2. NO REPRESENTATIVE OF THE COUNTY ENGINEER WILL SURVEY OR LAY OUT ANY PORTION OF THE WORK.
  3. THE PRIVATE ENGINEER SHALL FURNISH THE COUNTY ENGINEER WITH GRADE SHEETS AND STATIONING FOR ALL HOUSE LATERALS AND "Y" OR "T" BRANCHES AND SHALL PROVIDE STAKES FOR THEM AT THEIR PROPER LOCATIONS WITH STATIONING PLAINLY MARKED. ALL HOUSE LATERALS SHALL BE CONSTRUCTED IN A STRAIGHT ALIGNMENT AT RIGHT ANGLES FROM THE MAIN LINE SEWER EXCEPT AS SHOWN ON THE PLANS. HOUSE LATERALS FROM CHIMNEYS SHALL NOT HAVE AN ANGLE OF LESS THAN 45° WITH THE MAIN LINE SEWER. ANY CHANGE IN ALIGNMENT SHALL BE REQUESTED IN WRITING BY THE PRIVATE ENGINEER.
  4. THE PRIVATE ENGINEER SHALL MARK THE HOUSE LATERAL DEPTH AT THE PROPERTY LINE BELOW THE 1/4 OF STREET ELEVATION FOR EACH HOUSE LATERAL ON THE GRADE SHEET.
  5. NO REVISIONS SHALL BE MADE IN THESE PLANS WITHOUT THE APPROVAL OF THE COUNTY ENGINEER.
  6. THE CONTRACTOR SHALL NOTIFY THE CONSTRUCTION DIVISION BY TELEPHONE, MADISON 6-4747, EXT. 8181, AT LEAST TWENTY-FOUR HOURS BEFORE STARTING ANY WORK UNDER THIS CONTRACT.
  7. MANHOLES SHALL BE BRICK SEWER STRUCTURES PER S.S. PRECAST CONCRETE MANHOLES PER S.S. PER STANDARD SPECIFICATIONS, SECTION 208.2.
  8. USE STANDARD MANHOLE FRAMES AND COVERS, S.S. TYPE AS NOTED.
  9. MANHOLE TOPS TO BE SET AT FINISHED GRADE, UNLESS OTHERWISE NOTED.
  10. USE EXTRA STRENGTH PIPE AND FITS IN STRONGLY SLOPED SEWER LINES.
  11. ALL MANHOLE CONNECTIONS SHALL BE MADE WITH 90° JOINTS PER S.S. PER STANDARD SPECIFICATIONS, SECTION 208.2.
  12. IF A POWER POLE IS WITHIN THREE FEET OF THE SEWER, THE SEWER SHALL BE ENCASED, PER S.S. CASE II TWO FEET ON EACH SIDE OF THE POINT OF INTERFERENCE.
  13. IF DURING THE COURSE OF CONSTRUCTION IT IS DETERMINED THAT THERE IS LESS THAN FOUR FEET OF COVER OVER THE TOP OF A MAIN LINE OR HOUSE LATERAL V.C.P. SEWER WHICH IS NOT INDICATED ON THE PLANS, THE PIPE SHALL BE ENCASED PER S.S. CASE II UNLESS OTHERWISE APPROVED BY THE COUNTY ENGINEER.
  14. HOUSE LATERALS TO BE CONSTRUCTED WITH INVERTS AT PROPERTY LINE 6 FEET BELOW 1/4 OF STREET GRADE EXCEPT AS NOTED.
  15. RESURFACE ALL TRENCHES WITHIN PAVED AREAS TO MEET L.A. COUNTY ROAD DEPT. OR CALIFORNIA STATE HIGHWAY REQUIREMENTS IN ACCORDANCE WITH MANUALS.
  16. REFER TO SECTION 110-41 OF THE STANDARD SPECIFICATIONS REGARDING SAFETY ORDERS.
  17. WORK SHALL BE CONSTRUCTED ACCORDING TO THE STANDARD SPECIFICATIONS FOR PUBLIC WORKS CONSTRUCTION 1970 EDITION AND COUNTY ENGINEER SPECIAL PROVISIONS FOR THE CONSTRUCTION OF SANITARY SEWERS DATED APRIL 7, 1970 AND SHALL BE PROSECUTED ONLY IN THE PRESENCE OF THE COUNTY ENGINEER.
  18. WYE OR TEE BRANCHES MAY BE USED FOR CONNECTIONS TO MAINLINE SEWERS EXCEPT AS NOTED.
  19. VITRIFIED CLAY PIPE JOINTS SHALL BE TYPE "D" "F" OR "G" PER STANDARD SPECIFICATIONS SECTION 208.2.

NOTES CONTINUED ABOVE AT LEFT

NOTICE TO CONTRACTOR

The existence and location of any underground utility pipes or structures shown on these plans are obtained by a search of the available records. To the best of my knowledge there are no existing utilities except as shown on these plans. The contractor is required to take due precautions to protect the utility lines shown and any other lines not of record if not shown on these plans.

Ronald W. Bishop  
 E.L.C.

COLLECT CHARGES AS INDICATED

PROFILE ALIGNMENT AND GRADE OF  
 SANITARY SEWERS PAGE 1

COLIMA ROAD  
 AT BROADWAY  
 PRIVATE CONTRACT NO. 8560

W.S. 34  
 SHEET 1 OF 2 PAGES

SCALE: VERT. 1"=4' HORIZ. 1"=40' OCT. 1970

PREPARED IN THE OFFICES OF  
 OLSON SURVEYING SERVICE, INC.

By: Ronald W. Bishop  
 REG. C.E. NO. 9510

FOR LEGEND SEE PLAN NO. S-1

NOTE: GRADES TO WHICH THIS IMPROVEMENT IS TO BE CONSTRUCTED ARE SHOWN ON PLANS AND PROFILES. GRADE POINTS FOR TOP OF CURB, CENTER LINE OF STREETS, OR CENTER LINE OF ALLEYS ARE SHOWN BY CIRCLES ON PROFILES. AT ALL POINTS BETWEEN DESIGNATED STATIONATIONS ARE IN FEET ABOVE U.S.C. & G.S. SEA LEVEL DATUM OF 1929.

BEFORE WORK CAN BE STARTED, THE CONTRACTOR MUST OBTAIN A PERMIT TO EXCAVATE IN COUNTY STREETS FROM THE L.A. COUNTY ROAD DEPT., DISTRICT OFFICE NO. 2 AND PAY A FEE TO THE COUNTY ENGINEER, ROOM 300, COUNTY ENGINEERING BUILDING, CONSTRUCTION INSPECTION AND RECORD PLANE. APPROVAL OF THIS PLAN BY THE COUNTY OF LOS ANGELES DOES NOT CONSTITUTE A REPRESENTATION AS TO THE ACCURACY OF THE LOCATION OF OR THE EXISTENCE OR NON-EXISTENCE OF ANY UNDERGROUND UTILITY PIPE, OR STRUCTURE WITHIN THE LIMITS OF THE PROJECT. THIS NOTE APPLIES TO ALL PAGES.

COUNTY OF LOS ANGELES, CALIFORNIA  
 JOHN A. LAMBIE, COUNTY ENGINEER  
 J. D. PARKHURST, CHIEF ENGINEER

APPROVED BY: [Signature]  
 REGIONAL ENGINEER 12-2-70

CHECKED BY: [Signature] 11/30/70  
 REG. C.E. NO. 15931

J. N. 0370.82

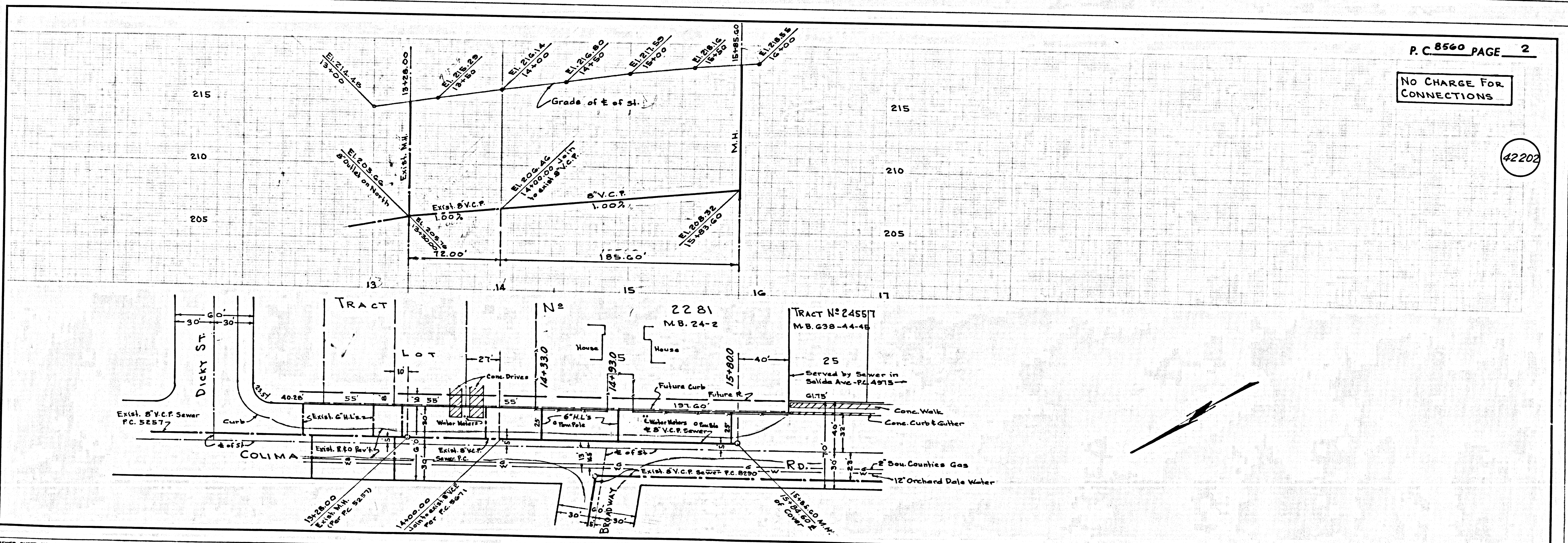

P. C. 8560 PAGE 2

NO CHARGE FOR CONNECTIONS

42202