

B.M. 8Y-3339 ELEV. 315.566
 L.I.N. @ M. End Conc. H.W.L. 27 Ft.
 N.V. - E Arroyo Drive @ 1425 Ft.
 E. Potrero Grande Drive.
 RIVERA QUAD. 19.65

TEMPLE CITY BLDG. DIST. NO. 50

PROFILE, ALIGNMENT AND GRADE OF
SANITARY SEWERS P.C. 8574
 TO BE CONSTRUCTED IN PAGE 1
TRACT N^o 29256

PRIVATE CONTRACT NO. 8574

W.S. 36, D-2
 1 SHEETS, 2 PAGES
 SCALE: HORIZ. 1" = 40' VERT. 1" = 4'
 FEBRUARY, 1971
 PREPARED IN THE OFFICES OF
EVANS & ASSOCIATES INC.
 1643 W. GARVEY AVE. WEST COVINA CALIF.
 BY *Richard Nottingham*
 REG. C. E. NO. 12472

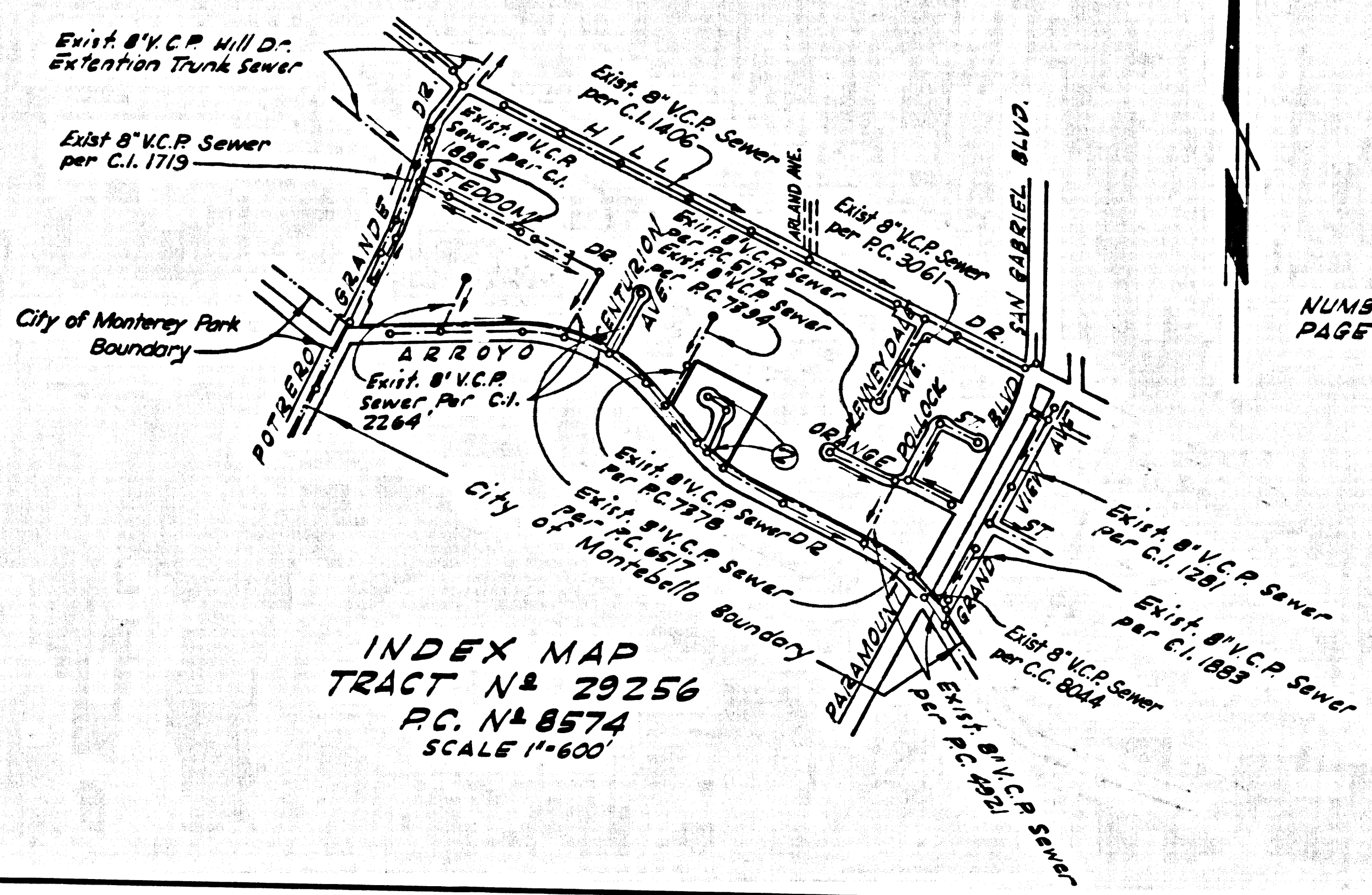

County Sanitation Districts shall be notified prior to the following so that required inspection can be made (Phone 337-1023 s = 638-1161)

Acceptance of the project.

No connections for the disposal of industrial wastes shall be made to sewers shown on these drawings without written permission from the Chief Engineer and General Manager of the County Sanitation Districts.

- NOTES:
1. HOUSE LATERALS TO BE CONSTRUCTED WITH INVERTS AT PROPERTY LINE 4 FEET BELOW CURB GRADE EXCEPT AS NOTED.
 2. PROVIDE STAKES ON THE PROPERTY LINE OR PROPERTY LINES PRODUCED AT RIGHT ANGLES TO THE SEWER LINE AT THE CENTER LINE OF EACH MANHOLE.
 3. NO REPRESENTATIVE OF THE COUNTY ENGINEER WILL SURVEY OR LAY OUT ANY PORTION OF THE WORK.
 4. THE PRIVATE ENGINEER SHALL FURNISH THE COUNTY ENGINEER WITH GRADE SHEETS AND STATIONING FOR ALL HOUSE LATERALS AND "T" OR "Y" BRANCHES AND SHALL PROVIDE STAKES FOR THEM AT THEIR PROPER LOCATIONS WITH STATIONING PLAINLY MARKED. ALL HOUSE LATERALS SHALL BE CONSTRUCTED IN A STRAIGHT ALIGNMENT AT RIGHT ANGLES FROM THE MAIN LINE SEWER EXCEPT AS SHOWN ON THE PLANS. HOUSE LATERALS FROM CHIMNEYS SHALL NOT HAVE AN ANGLE OF LESS THAN 45° WITH THE MAIN LINE SEWER. ANY CHANGE IN ALIGNMENT SHALL BE REQUESTED BY THE PRIVATE ENGINEER.
 5. THE PRIVATE ENGINEER SHALL FURNISH THE HOUSE LATERAL DEPTH AT THE PROPERTY LINE BELOW THE TOP OF CURB ELEVATION FOR EACH HOUSE LATERAL ON THE GRADE SHEET.
 6. NO DEPRESSIONS SHALL BE MADE IN THESE PLANS WITHOUT THE APPROVAL OF THE COUNTY ENGINEER.
 7. THE CONTRACTOR SHALL NOTIFY THE CONSTRUCTION DEPARTMENT BY TELEPHONE, MADISON 9-5747, EXT. 81381, AT LEAST TWENTY-FOUR HOURS BEFORE STARTING ANY WORK UNDER THIS CONTRACT.
 8. ALL STRUCTURES SHALL BE BUILT IN ACCORDANCE WITH THE STANDARD SPECIFICATIONS, AND SPECIAL PROVISIONS.
 9. "T" OR "Y" BRANCHES MAY BE USED FOR CONNECTIONS TO MAINLINE SEWERS EXCEPT AS NOTED.
 10. MANHOLE TOPS IN UNIMPROVED RIGHTS OF WAY TO BE 2 1/2 INCHES ABOVE FINISHED GRADE.
 11. WITHIN CLAY PIPE JOINTS SHALL BE TYPE "T", "Y", OR "G" PER STANDARD SPECIFICATIONS SECTION 206.2.
 12. IF A POWER POLE IS WITHIN THREE FEET OF THE "T", "Y", OR "G" PER STANDARD SPECIFICATIONS SECTION 206.2.
 13. IF DURING THE COURSE OF CONSTRUCTION IT IS DETERMINED THAT THERE IS LESS THAN FOUR FEET OF COVER OVER THE TOP OF A MAIN LINE OR HOUSE LATERAL "V.C.P. SEWER" WHICH IS NOT INDICATED ON THE PLANS, THE PIPE SHALL BE ENCASED PER 2-26, CASE B.
 14. REPLACE ALL TRUCKS WITHIN PAVED AREAS TO MEET L.A. COUNTY ROAD DEPT. OR CALIFORNIA STATE HIGHWAY REQUIREMENTS IN ACCORDANCE WITH PERMITS.
 15. SEWERS TO BE TESTED FOR LEAKAGE PER SECTION 206.3.3.7 OF THE STANDARD SPECIFICATIONS, AND SPECIAL PROVISIONS.
 16. SEWERS TO SECTION 218.4.3 OF THE STANDARD SPECIFICATIONS, REGARDING SAFETY ORDS.
 17. SEWER JOINTS BETWEEN CAST IRON PIPE AND VITRIFIED CLAY PIPE SHALL BE MADE WITH A RUBBER SLAVE JOINT, TYPE "C" OR "W", FIFTH RUNNING IF NECESSARY PER STANDARD SPECIFICATIONS, SECTION 206.2.
 18. ALL JOINTS BETWEEN CAST IRON PIPE AND VITRIFIED CLAY PIPE SHALL BE MADE WITH A RUBBER SLAVE JOINT, TYPE "C" OR "W", FIFTH RUNNING IF NECESSARY PER STANDARD SPECIFICATIONS, SECTION 206.2.
- THE FOLLOWING LATEST REVISED STANDARD PLANS ON FILE IN THE OFFICE OF THE COUNTY ENGINEER SHALL APPLY IN THE CONSTRUCTION OF THIS PROJECT.
- | | |
|--|------|
| LEGEND | 5-1 |
| MINIMUM PUBLIC SAFETY REQUIREMENTS | 5-2 |
| RIBBON MANHOLES | 5-3 |
| NON-REINFORCED PRECAST CONCRETE MANHOLES | 5-3a |
| LOCKING | 5-3b |
| STANDARD MANHOLE STEP | 5-3c |
| REBAR FOR SEWER PIPE | 5-3d |
| CRACKING AND ENCASING | 5-3e |
| WYE OR TEE SUPPORT | 5-3f |
| ALLOWABLE TRENCH WIDTH | 5-3g |

GRADES TO WHICH THE IMPROVEMENT IS TO BE CONSTRUCTED ARE SHOWN ON PLANS AND PROFILE. GRADE POINTS FOR TOP OF CURB, CENTER LINE OF STREET, OR CENTER LINE OF ALLEYS ARE SHOWN BY CIRCLES ON PROFILES. AT ALL POINTS BETWEEN DESIGNATED POINTS THE GRADE SHALL BE ESTABLISHED SO AS TO CONFORM TO A STRAIGHT LINE DRAWN BETWEEN SAID DESIGNATED POINTS. ELEVATIONS ARE IN FEET ABOVE U.S.C. & G.S. MEAN LEVEL DATUM OF 1929.

WORK SHALL BE CONSTRUCTED ACCORDING TO THE STANDARD SPECIFICATIONS FOR PUBLIC WORKS CONSTRUCTION AND SPECIAL PROVISIONS FOR THE CONSTRUCTION OF SANITARY SEWERS DATED APRIL 7, 1970. AND SHALL BE PROSECUTED ONLY BEFORE WORK CAN BE STARTED. THE CONTRACTOR SHALL OBTAIN A PERMIT TO EXCAVATE IN COUNTY STREETS FROM THE L.A. COUNTY ROAD DEPT., DISTRICT OFFICE NO. 2, 11111 N. GARDEN ST., GARDEN CITY, CALIF. 91731. AND SHALL BE PROSECUTED ONLY BY THE COUNTY ENGINEER'S OFFICE.

APPROVAL OF THIS PLAN BY THE COUNTY OF LOS ANGELES DOES NOT CONSTITUTE A REPRESENTATION AS TO THE ACCURACY OF THE LOCATION OF OR THE EXISTENCE OR NON-EXISTENCE OF ANY UNDERGROUND UTILITY PIPE, OR STRUCTURE WITHIN THE LIMITS OF THIS PROJECT. THIS NOTE APPLIES TO ALL PAGES.

IF WORK IS TO BE DONE IN A STATE HIGHWAY, A PERMIT MUST BE OBTAINED FROM THE STATE OF CALIFORNIA, DIVISION OF HIGHWAYS, THE SOUTH BRIDGE STREET, LOS ANGELES, CALIFORNIA.

COUNTY OF LOS ANGELES, CALIFORNIA
 JOHN A. LAMBE, COUNTY ENGINEER J. D. PARKHURST, CHIEF ENGINEER
 APPROVED BY: *Richard Nottingham* 2-18-71 APPROVED BY: *J. D. Parkhurst*
 REGIONAL ENGINEER OFFICE ENGINEER
 CHECKED BY: *Richard Nottingham* 2-18-71 APPROVED BY: *Richard Nottingham*
 REG. C.E. NO. 7853 DATE: 2-18-71 CITY ENGINEER DATE: CITY OF MONTEBELLO

COLLECT CHARGES AS INDICATED

JN. 0250.02

