

B.M. E-13 ELEV 361.00 F.O. 3804-84
INTERSECTION OF INDIANA AND FOWLER STREET, S.W. SIDE
FOUND FOR THE POINT TO BE IN CONC. CURB ON CURB RETURN
APPROX. 30' W. OF C.R. @ ELY END

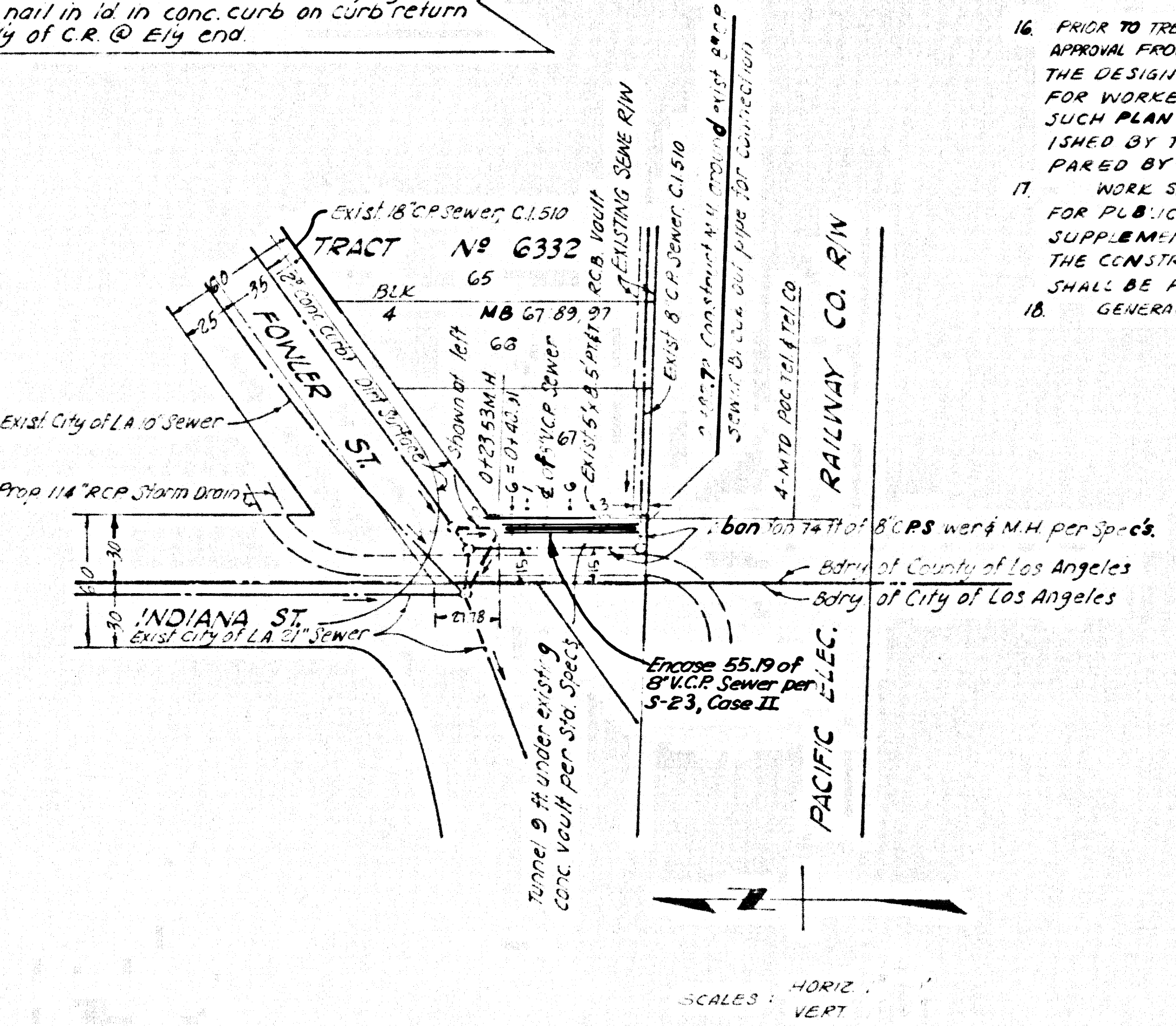

GENERAL SEWER NOTES, CONTINUED

16. PRIOR TO TRENCH EXCAVATION THE CONTRACTOR SHALL SUBMIT TO AND OBTAIN APPROVAL FROM THE COUNTY ENGINEER OF A DETAILED PLAN SHOWING THE DESIGN OF SHORING, BRACING, SLOPING OR OTHER PROVISIONS FOR WORKER PROTECTION FROM THE HAZARD OF COLLAPSE OF GROUND. IF SUCH PLAN VARIES FROM THE SHORING SYSTEM STANDARDS ESTABLISHED BY THE CONSTRUCTION SAFETY ORDERS, IT SHALL BE PREPARED BY A REGISTERED CIVIL OR STRUCTURAL ENGINEER.
17. WORK SHALL BE CONSTRUCTED ACCORDING TO THE STD. SPECIFICATIONS FOR PUBLIC WORKS CONSTRUCTION (1970 EDITION WITH 1971 AND 1972 SUPPLEMENTS) AND THE COUNTY ENGINEER SPECIAL PROVISIONS FOR THE CONSTRUCTION OF SANITARY SEWERS DATED APRIL 10, 1971 AND SHALL BE PROSECUTED ONLY IN THE PRESENCE OF THE COUNTY ENGINEER.
18. GENERAL SEWER NOTE #17 SUPERSEDES NOTE #1.

County Engineer's Office shall be notified prior to the following so that any and all necessary permits may be made (Phone: 441-1111 - 441-1111)

APPROVED BY: _____

DATE: _____

INDUSTRIAL PLANTS SHALL BE MADE TO MAKE SURE ALL TRENCHES ARE WITHOUT EXCESS PERMEATION FROM THE OTHER SIDE AND SHALL BE MADE TO MAKE SURE ALL TRENCHES ARE WITHOUT EXCESS PERMEATION FROM THE OTHER SIDE AND SHALL BE MADE TO MAKE SURE ALL TRENCHES ARE WITHOUT EXCESS PERMEATION FROM THE OTHER SIDE.

07 LA 10 C 183/C 217

PROJECT ENGINEER: J.W. Kim
APPROVED: June 21, 1972
12739

43816

C.C. 8614
(SUPPLEMENT TO CASH CONTRACT 8614) 1A

19. ALL STANDARD PLANS, SPECIFICATIONS AND GENERAL SEWER NOTES, OF C.C. 8614, SHALL APPLY TO THIS SEWER PROJECT.
20. IF A WORKER IS WITHIN THREE FEET OF THE SEWER, THE SEWER SHALL BE ENCASED, PER S-23, TWO FEET ON EACH SIDE FROM THE POINT OF INTERFERENCE.
21. MANHOLE TOPS IN AVENUES OF WAY SHALL BE CONSTRUCTED SIX INCHES ABOVE EXISTING GROUND SURFACE.
22. BEFORE WORK CAN BE STARTED, THE CONTRACTOR MUST OBTAIN A PERMIT TO EXCAVATE IN COUNTY STREETS FROM THE L.A. COUNTY ROAD DEPT. DIST. OFFICE #14 AND PAY A FEE TO THE COUNTY ENGINEER, 850 E. IMPERIAL HIGHWAY, GLENDALE, CA 91201 AT THE SAN GABRIEL VALLEY REGIONAL OFFICE, 5308 N. KLUFFMAN AVE., TENSILE CITY, CA. TO COVER THE COST OF CONSTRUCTION INSPECTION AND RECORD PLANS.

COUNTY OF LOS ANGELES, CALIFORNIA
HARVEY T. BRANDT COUNTY ENGINEER

APPROVED BY: _____ DATE: _____
ASST. DIVISION ENGINEER

DESIGNED BY: _____ DATE: _____
R.E. NEVILL

JOHN D. PARKHURST CHIEF ENGINEER OF SANITATION DIST. #12

APPROVED BY: _____ DATE: _____
OFFICE ENGINEER

CITY OF LOS ANGELES, CALIFORNIA
APPROVED: _____ DATE: _____
CITY ENGINEER

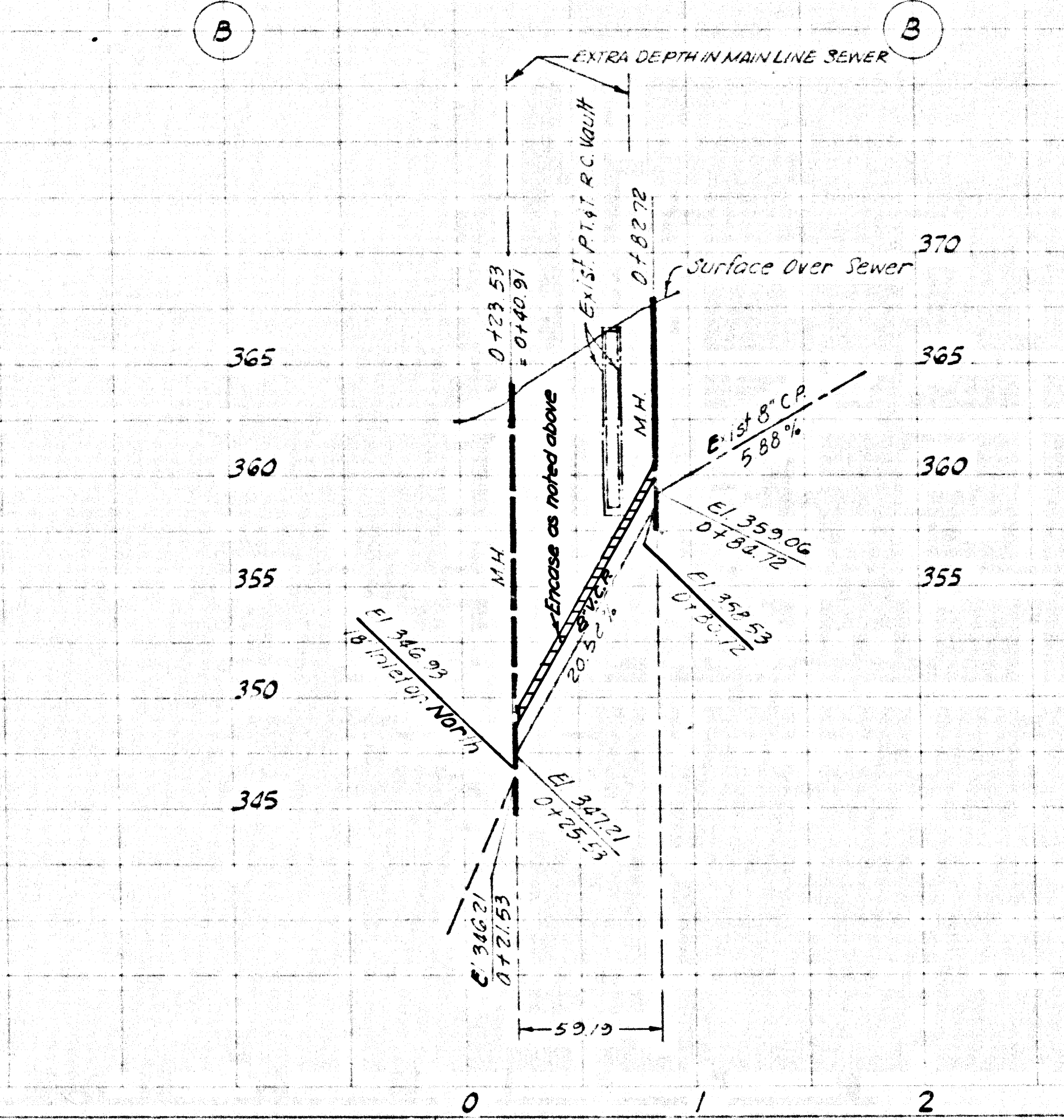
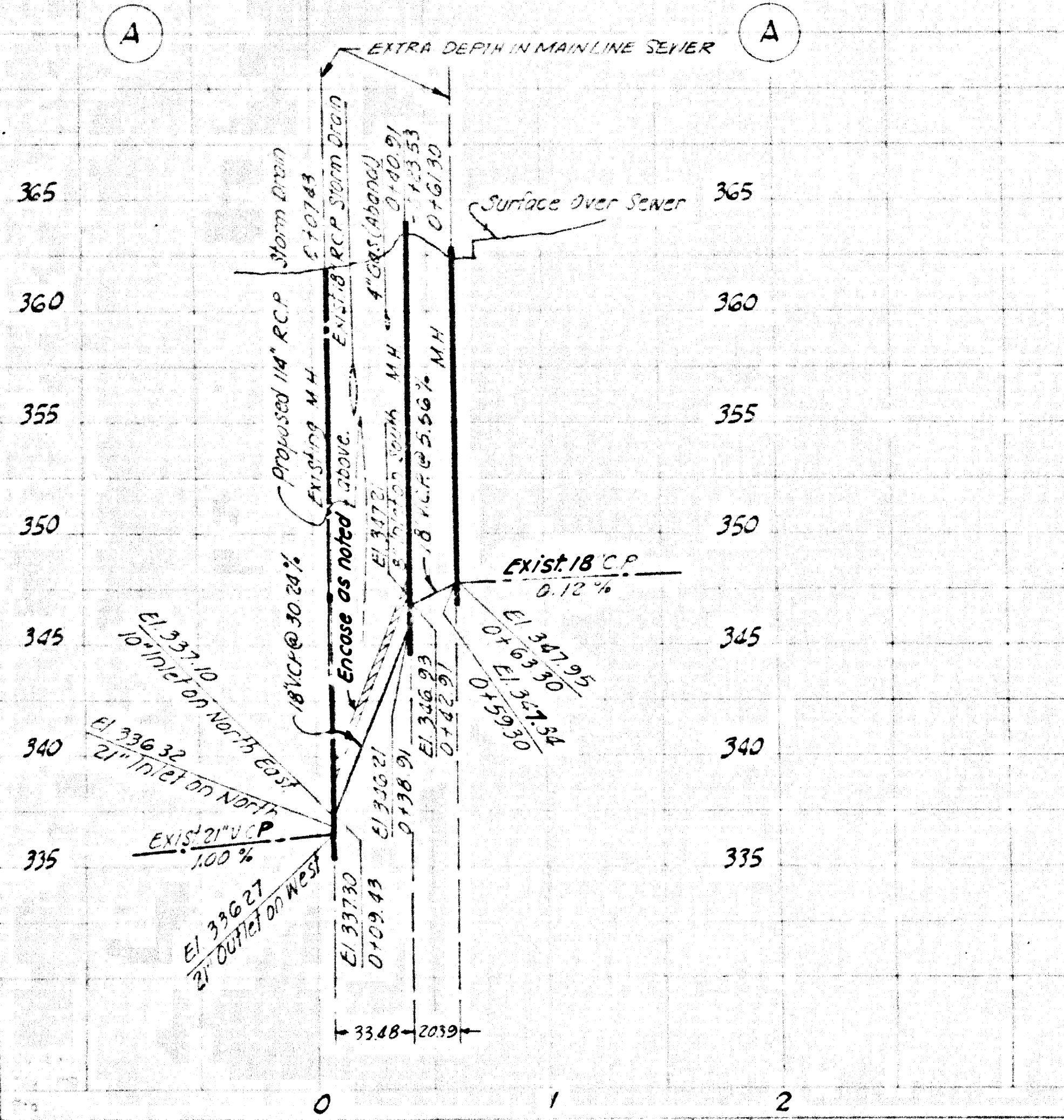

STATE OF CALIFORNIA
BUSINESS AND TRANSPORTATION AGENCY
DEPARTMENT OF PUBLIC WORKS
DIVISION OF HIGHWAYS

PROFILES

Scale: _____ Charge: _____ E.A. Sheet No: _____

REVISION DATES: _____ (PRELIMINARY STAGE ONLY)