

B.M. G.G. 2103 ELEV. 809.862
 BEGINNING AT BUTTERFLY ROAD AND
 DIAMOND BAR BOULEVARD THENCE 0.55
 MI NLY ALONG DIAMOND BAR BOULEVARD
 TO CONCRETE HEADWALL ROBIN TAB
 NEAR CENTER OF CONCRETE HEADWALL
 135FT SLY & 65FT ELY CENTER LINE
 INTERSECTION DIAMOND BAR BOULEVARD
 & KNOVA CREST DRIVE
 OTTERBEIN QUAD. 19 70

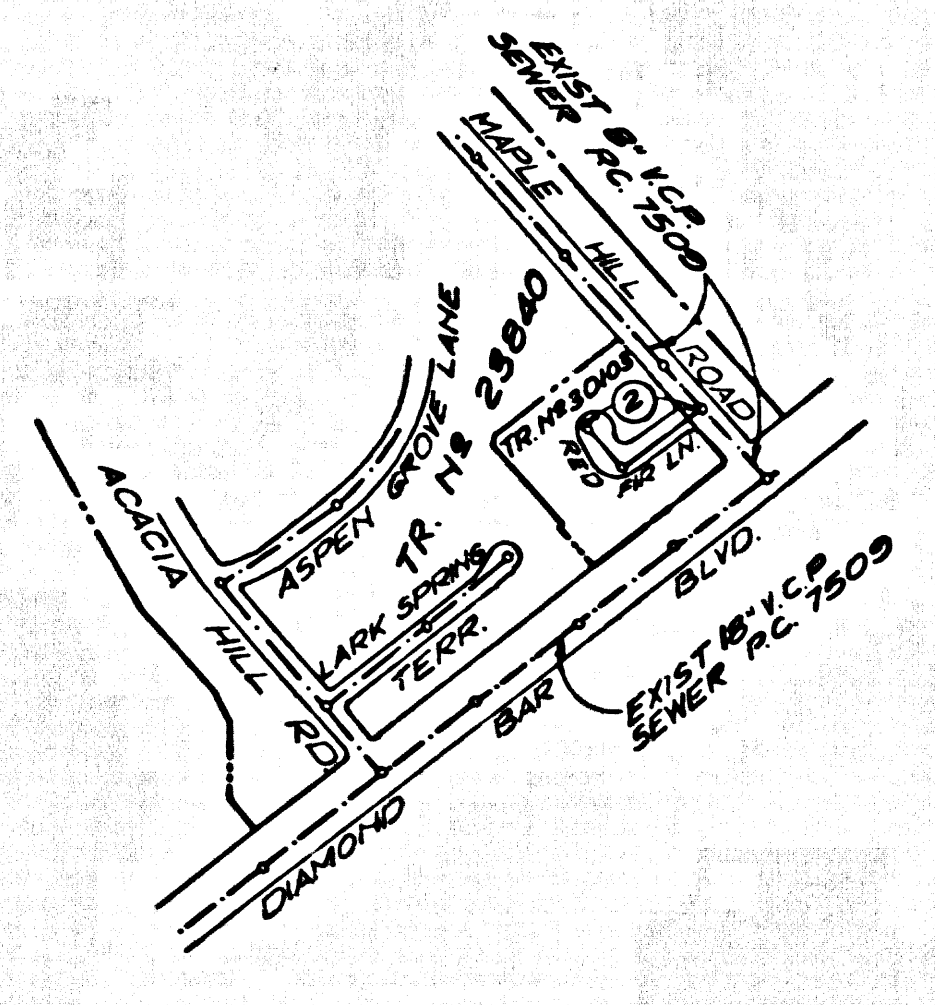

INDEX MAP
 TRACT NO 30103
 P.C. 8617
 SCALE: 1" = 600'

UTILITIES
 (1) SOU CALIF. GAS CO.
 (2) DIAMOND BAR WATER CO.
 (3) SOU CALIF. EDISON CO. &
 GENERAL TEL. CO. (IN JOINT TRENCH)

NOTE:
 CONTRACTOR SHALL CONTACT
 ALL UTILITY CO.'S FOR LOCATIONS
 OF EXISTING UNDERGROUND
 UTILITIES THROUGHOUT THIS TRACT.

County Sanitation Districts shall be
 notified prior to the following so
 that required inspection can be made
 (Phone 337-1025 & 638-1161)

Acceptance of the project.
 No connections for the disposal of
 industrial wastes shall be made to
 sewers shown on these drawings
 without written permission from the
 Chief Engineer and General Manager
 of the County Sanitation District.

SAN DIMAS BLDG. DIST. NO. 10

- NOTE:**
- HOUSE LATERALS TO BE CONSTRUCTED WITH INVERTS AT PROPERTY LINE 4 FEET BELOW CURB GRADE EXCEPT AS NOTED.
 - PROVIDE STAKES ON THE PROPERTY LINE OR PROPERTY LINES PRODUCED AT RIGHT ANGLES TO THE SEWER LINE AT THE CENTER LINE OF EACH MANHOLE.
 - NO REPRESENTATIVE OF THE COUNTY ENGINEER WILL SURVEY OR LAY OUT ANY PORTION OF THE WORK.
 - THE PRIVATE ENGINEER SHALL FURNISH THE COUNTY ENGINEER WITH GRADE SHEETS AND STATIONING FOR ALL HOUSE LATERALS AND "T" OR "T" BRANCHES AND SHALL PROVIDE STAKES FOR THEM AT THESE POINTS INDICATED WITH STATIONING PLAINLY MARKED. ALL HOUSE LATERALS SHALL BE CONSTRUCTED IN A STRAIGHT ALIGNMENT AT RIGHT ANGLES FROM THE MAIN LINE SEWER EXCEPT AS SHOWN ON THE PLANS. HOUSE LATERALS FROM CHIMNEYS SHALL NOT HAVE AN ANGLE OF LESS THAN 45° WITH THE MAIN LINE SEWER. ANY CHANGE IN ALIGNMENT SHALL BE REQUESTED IN WRITING BY THE PRIVATE ENGINEER.
 - THE PRIVATE ENGINEER SHALL FURNISH THE HOUSE LATERAL DEPTH AT THE PROPERTY LINE BELOW THE TOP OF CURB ELEVATION FOR EACH HOUSE LATERAL ON THE GRADE SHEET.
 - NO REVISIONS SHALL BE MADE IN THESE PLANS WITHOUT THE APPROVAL OF THE COUNTY ENGINEER.
 - THE CONTRACTOR SHALL NOTIFY THE CONSTRUCTION DIVISION BY TELEPHONE, MADISON 9-4747, EXT. 8158, AT LEAST TWENTY-FOUR HOURS BEFORE STARTING ANY WORK UNDER THIS CONTRACT.
 - ALL STRUCTURES SHALL BE EITHER BRICK MANHOLES PER 2-3 OR PRECAST CONCRETE MANHOLES PER 1-30 EXCEPT AS NOTED.
 - "T" OR "T" BRANCHES MAY BE USED FOR CONNECTIONS TO MAINLINE SEWERS EXCEPT AS NOTED.
 - MANHOLE TOPS IN UNIMPROVED RIGHTS OF WAY TO BE SIX INCHES ABOVE FINISHED GRADE.
 - USE EXTRA STRENGTH PIPE. ALL PIPE IS STANDARD DEPTH EXCEPT AS NOTED.
 - WITHER CLAY PIPE JOINTS SHALL BE TYPE "B", "T", OR "O" PER STANDARD SPECIFICATIONS SECTION 206-2.
 - IF A POWER POLE IS WITHIN THREE FEET OF THE SEWER, THE SEWER SHALL BE ENCASED, PER 2-23-22 2 FEET ON EACH SIDE FROM THE POINT OF INTERFERENCE.
 - IF DURING THE COURSE OF CONSTRUCTION IT IS DETERMINED THAT THERE IS LESS THAN FOUR FEET OF COVER OVER THE TOP OF A MAIN LINE OR HOUSE LATERAL V.C.P. SEWER WHICH IS NOT INDICATED ON THE PLANS, THE PIPE SHALL BE ENCASED PER 2-24-2 UNLESS OTHERWISE APPROVED BY THE COUNTY ENGINEER.
 - RESURFACE ALL TRENCHES WITHIN PAVED AREAS TO MEET L.A. COUNTY ROAD DEPT. OR CALIFORNIA STATE HIGHWAY REQUIREMENTS IN ACCORDANCE WITH PERMITS.
 - SEWERS TO BE TESTED FOR LEAKAGE PER SECTION 206-2.3.7 OF THE STANDARD SPECIFICATIONS.
 - REFER TO SECTION 14-6.1 OF THE STANDARD SPECIFICATIONS, REGARDING SAFETY CODES.
 - ALL JOINTS BETWEEN CLAY PIPE SHALL BE MADE WITH A RUBBER SLEEVE JOINT, TYPE "C" OR "D", WITH GUSHING IF NECESSARY PER STANDARD SPECIFICATIONS, SECTION 206-2.
- THE FOLLOWING LATEST REVISED STANDARD PLANS ON FILE IN THE OFFICE OF THE COUNTY ENGINEER SHALL APPLY IN THE CONSTRUCTION OF THE PROJECT:

MINIMUM PUBLIC SAFETY REQUIREMENTS	2-1
BRICK MANHOLE	2-2
NON-REINFORCED PRECAST CONCRETE MANHOLE	2-3
LOCKING MANHOLE FRAME AND COVER	2-35
STANDARD MANHOLE STEP	2-37
RODDING FOR SEWER PIPE	2-39
GRADING AND ENCASING	2-33
WYE OR TEE SUPPORT	2-34
ALLOWABLE TRENCH WIDTHS	2-38

"FULL COMPLIANCE WITH SECTION 306-1.9.3 OF THE SPECIAL PROVISIONS WILL BE REQUIRED FOR BACKFILL IN STREETS. CERTIFICATION OF BACKFILL COMPACTION AND SAND EQUIVALENTS BY A QUALIFIED, REGISTERED TESTING LABORATORY SHALL BE PROVIDED BY THE PERMITTEE PRIOR TO THE ISSUANCE OF A CERTIFICATE OF PARTIAL ACCEPTANCE."

COLLECT CHARGES AS INDICATED

PROFILE, ALIGNMENT AND GRADE OF
SANITARY SEWERS P.C. 8617
 CONSTRUCTED IN PAGE 1

TRACT NO 30103
 PRIVATE CONTRACT NO. 8617

W.S. 39 (C-4)
 1 SHEET OF 2 PAGES
 SCALE: VERT. 1" = 4' HORIZ. 1" = 40'
 MAY, 1971 42729
 PREPARED IN THE OFFICES OF
MCINTIRE & QUIROS INC.
 670 MONTEREY PASS RD. MONTEREY PARK CALIF.
 BY: *David R. Hoag*
 REG. C. E. NO. 17288

NOTE:
 GRADES TO WHICH THIS IMPROVEMENT IS TO BE CONSTRUCTED ARE SHOWN ON PLANS AND PROFILE. GRADE POINTS FOR TOP OF CURB, CENTER LINE OF STREETS, OR CENTER LINE OF ALLEYS ARE SHOWN BY CIRCLES ON PROFILES. AT ALL POINTS BETWEEN DESIGNATED POINTS THE GRADE SHALL BE ESTABLISHED SO AS TO CONFORM TO A STRAIGHT LINE DRAWN BETWEEN SAID DESIGNATED POINTS. ELEVATIONS ARE IN FEET ABOVE U.S.C. & G.S. SEA LEVEL DATUM OF 1929.
 WORK SHALL BE CONSTRUCTED ACCORDING TO THE STANDARD SPECIFICATIONS FOR PUBLIC WORKS CONSTRUCTION (1970 EDITION) DATED APRIL 9, 1970, AND SHALL BE PROSECUTED ONLY IN THE PRESENCE OF THE COUNTY ENGINEER, COUNTY ROAD DEPT., DISTRICT OFFICE NO. 10, AND PAY A FEE TO THE COUNTY ENGINEER, ROOM 118, COUNTY ADMINISTRATION OFFICE, 3850 E. IMPERIAL AVENUE, DOWNHILL OF ECHOLS AVENUE, SAN DIMAS REGIONAL OFFICE, SUFFICIENT TO COVER THE COST OF CONSTRUCTION INSPECTION AND RECORD PLANS.
 APPROVAL OF THIS PLAN BY THE COUNTY OF LOS ANGELES DOES NOT CONSTITUTE A REPRESENTATION AS TO THE ACCURACY OF THE LOCATION OF OR THE RESISTANCE OR NON-EXISTENCE OF ANY UNDERGROUND UTILITY PIPE, OR STRUCTURE WITHIN THE LIMITS OF THIS PROJECT. THIS NOTE APPLIES TO ALL PAGES.
 IF WORK IS TO BE DONE IN A STATE HIGHWAY, A PERMIT MUST BE OBTAINED FROM THE STATE OF CALIFORNIA, DIVISION OF HIGHWAYS, 130 SOUTH SPRING STREET, LOS ANGELES, CALIFORNIA.

COUNTY OF LOS ANGELES, CALIFORNIA
 HARVEY T. BRANDT, COUNTY ENGINEER
 J. D. PARKHURST, CHIEF ENGINEER
 CO. SANIT. NO. 7 24
 APPROVED BY: *David W. Hingel* APPROVED BY: *J. D. Parkhurst*
 REGIONAL ENGINEER OFFICE ENGINEER

CHECKED BY: *Thomas S. Howard* DATE: 5 May 71
 REG. C.E. NO. 12156

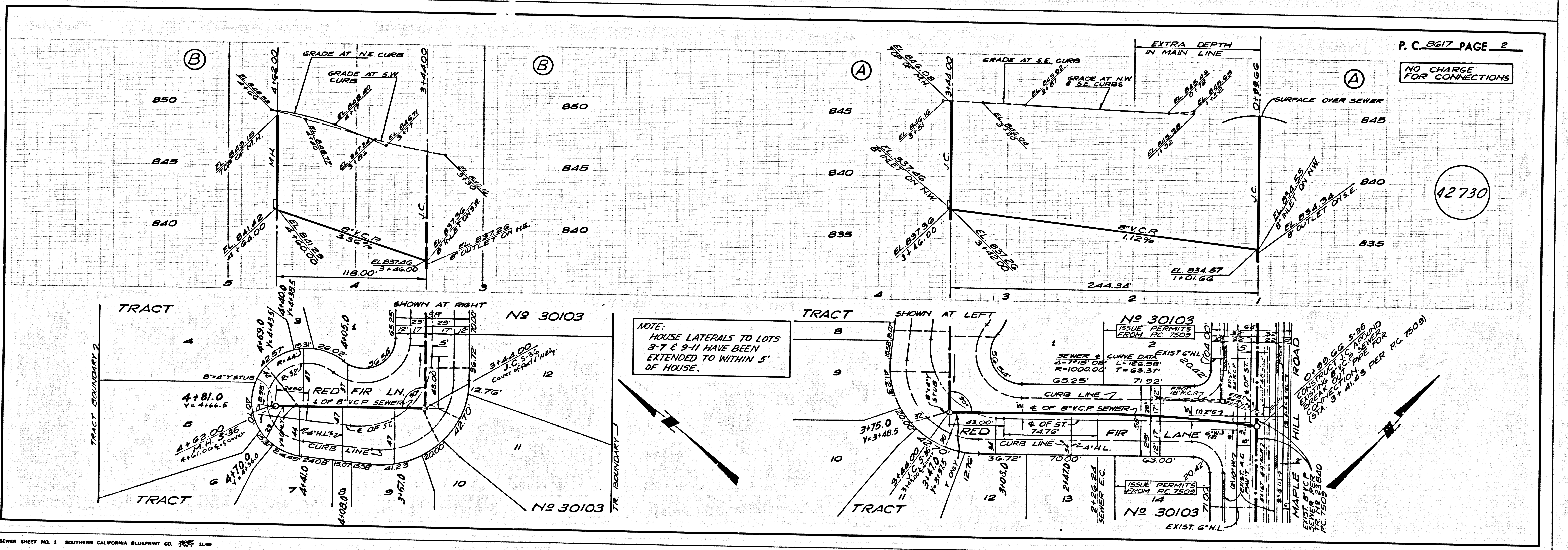

P.C. 8617 PAGE 2

NO CHARGE FOR CONNECTIONS

42730

NOTE:
 HOUSE LATERALS TO LOTS
 3-7 & 9-11 HAVE BEEN
 EXTENDED TO WITHIN 5'
 OF HOUSE.