

B.M. B.L. No. 65 ELEV. 2391.642  
 C.S. Mon. in well @ INT. OF  
 AVENUE J AND 5th STREET EAST  
 MKD. (T7N., R. 12 W. 1/4 COR. 14-23, E. EDGE  
 LANCASTER QUAD. 1905

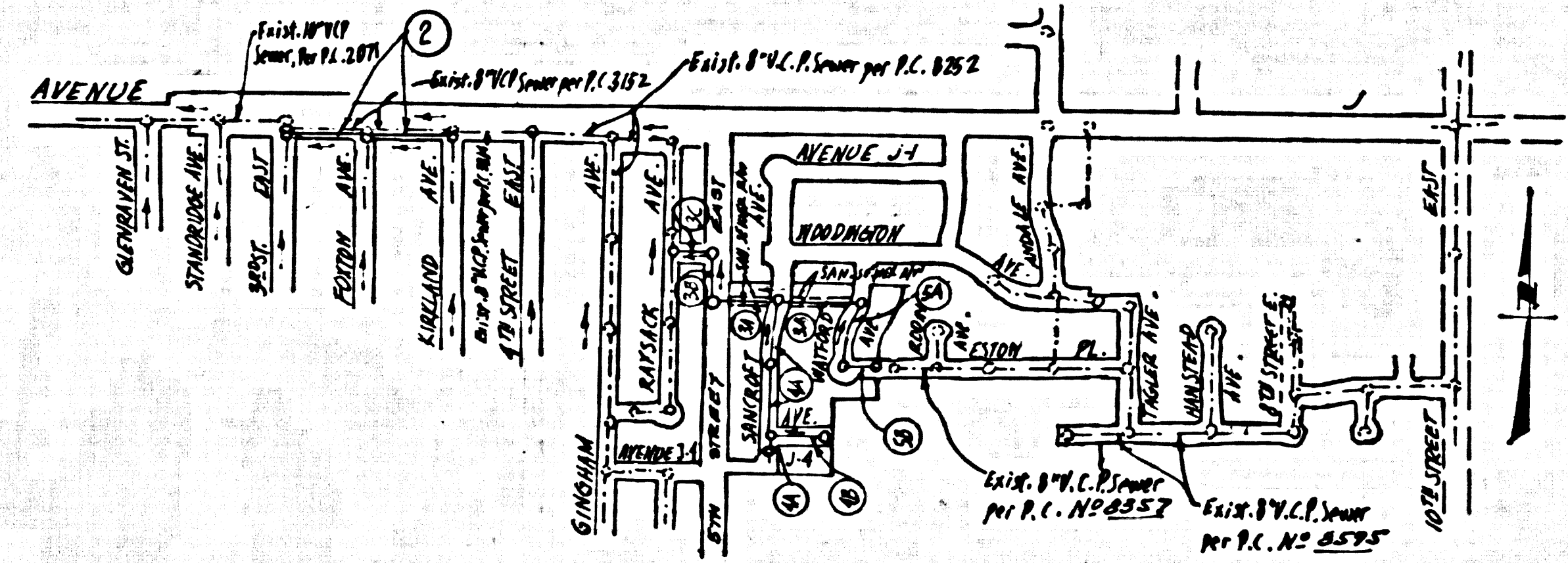

KEY MAP  
 SCALE: 1" = 800'  
 P.C. No. 8641  
 TRACT No. 29769

No connections for the disposal of industrial wastes shall be made to sewers shown on these drawings without written permission from the Chief Engineer and General Manager of the County Sanitation Districts.

County Sanitation Districts shall be notified prior to the following so that required inspection can be made (Phone 337-1025 - - 400-4404)

Acceptance of the project.

LANCASTER BLDG. DIST. NO. 8

PROFILE ALIGNMENT AND GRADE OF P.C. 8641  
 SANITARY SEWERS PAGE 1

TRACT No. 29769  
 PRIVATE CONTRACT NO. 8641

W.S. 79  
 3 SHEETS, 5 PAGES

SCALE: VERT. 1" = 4' HORIZ. 1" = 40' MAY, 1971

PREPARED IN THE OFFICES OF  
 CONSOLIDATED ENGINEERING CO.  
 8845 W. OLYMPIC BOULEVARD  
 BEVERLY HILLS, CALIF.  
 BY: *Ermine Arveds* 3/17/71  
 REG. C. E. NO. 10916

FOR LEGEND SEE PLAN NO. S-1

- NOTES:
- PROVIDE STAKES ON THE PROPERTY LINE OR PROPERTY LINES PRODUCED AT RIGHT ANGLES TO THE SEWER LINE AT THE CENTER LINE OF EACH MANHOLE.
  - NO REPRESENTATIVE OF THE COUNTY ENGINEER WILL SURVEY OR LAY OUT ANY PORTION OF THE WORK.
  - THE PRIVATE ENGINEER SHALL FURNISH THE COUNTY ENGINEER WITH GRADE SHEETS AND STATIONING FOR ALL HOUSE LATERALS V & T BRANCHES AND SHALL PROVIDE STAKES FOR THEM AT THEIR PROPER LOCATIONS WITH STATIONING PLAINLY MARKED. ALL HOUSE LATERALS SHALL BE CONSTRUCTED IN A STRAIGHT ALIGNMENT AT RIGHT ANGLES FROM THE MAIN LINE SEWER EXCEPT AS SHOWN ON THE PLANS. HOUSE LATERALS FROM CHIMNEYS SHALL HAVE AN ANGLE OF LESS THAN 45° WITH THE MAIN LINE SEWER. ANY CHANGE IN ALIGNMENT SHALL BE REQUESTED BY WRITING BY THE PRIVATE ENGINEER.
  - THE PRIVATE ENGINEER SHALL FURNISH THE HOUSE LATERAL DEPTH AT THE PROPERTY LINE BELOW THE TOP OF CURB ELEVATION FOR EACH HOUSE LATERAL ON THE GRADE SHEET.
  - NO REVISIONS SHALL BE MADE IN THESE PLANS WITHOUT THE APPROVAL OF THE COUNTY ENGINEER.
  - THE CONTRACTOR SHALL NOTIFY THE CONSTRUCTION DIVISION BY TELEPHONE, HANSON 9-570, EXT. 8151, AT LEAST TWENTY-FOUR HOURS BEFORE STARTING ANY WORK UNDER THIS CONTRACT.
  - ALL STRUCTURES SHALL BE WITHIN GENERAL PARALLELS PER S-3 OR PER AS NOTED CONCERNING MANHOLE SIZES PER S-30
  - 4" OR 6" RANGES MAY BE USED FOR CONNECTIONS TO MAINLINE SEWER, EXCEPT AS NOTED
  - USE EXTRA STRENGTH PIPE, ALL PIPE IS STANDARD DEPTH EXCEPT AS NOTED.
  - VITRIFIED CLAY PIPE JOINTS SHALL BE TYPE "D", 8" & 6" PER STD. SPECIFICATIONS SECTION 308-2.
  - IF A POWER POLE IS WITHIN THREE FEET OF THE SEWER, THE SEWER SHALL BE ENCASED, PER S-34, 10 FEET ON EACH SIDE FROM THE POINT OF INTERFERENCE.
  - IF DURING THE COURSE OF CONSTRUCTION IT IS DETERMINED THAT THERE IS LESS THAN FOUR FEET OF COVER OVER THE TOP OF A MAIN LINE OR HOUSE LATERAL V.C.P. SEWER WHICH IS NOT INDICATED ON THE PLANS, THE PIPE SHALL BE ENCASED PER S-35, UNLESS OTHERWISE APPROVED BY THE COUNTY ENGINEER.
  - HOUSE LATERALS TO BE CONSTRUCTED WITH INVERTS AT PROPERTY LINE 6 FEET BELOW CURB GRADE EXCEPT AS NOTED.
  - RESURFACE ALL TRENCHES WITHIN PAVED AREAS TO MEET L.A. COUNTY ROAD DEPT. OR CALIFORNIA STATE HIGHWAY REQUIREMENTS IN ACCORDANCE WITH PERMITS.
  - SHOWINGS TO BE TESTED FOR CHANGE PER S.D. S.P. 2, 3, 4 OF THE STANDARD SPECIFICATIONS.
  - ALL STATE AND LOCAL TRENCH SAFETY ORDERS SHALL BE STRICTLY ENFORCED AND SHALL COMPLY WITH SPECIFICATIONS SECTION 7-10.4.1
  - ALL CONTRACTORS SHALL BE REGISTERED WITH THE COUNTY OF LOS ANGELES AND SHALL COMPLY WITH THE SPECIAL PROVISIONS WILL BE REQUIRED FOR CONTRACTS IN THE COUNTY OF LOS ANGELES. CONTRACTORS SHALL BE REGISTERED WITH THE COUNTY OF LOS ANGELES AND SHALL COMPLY WITH THE SPECIAL PROVISIONS WILL BE REQUIRED FOR CONTRACTS IN THE COUNTY OF LOS ANGELES. CONTRACTORS SHALL BE REGISTERED WITH THE COUNTY OF LOS ANGELES AND SHALL COMPLY WITH THE SPECIAL PROVISIONS WILL BE REQUIRED FOR CONTRACTS IN THE COUNTY OF LOS ANGELES.

LEGEND:

MANHOLE ELEVATION SAFETY REQUIREMENTS	S-1
BACK MANHOLE	S-2
NON-REINFORCED PRECAST CONCRETE MANHOLE	S-3
LOOKING	S-4
MANHOLE FRAME AND COVER	S-5
REINFORCED MANHOLE STEP	S-6
BLENDING FOR SINKING PIPE	S-7
CHARMING AND ENCASEMENT	S-8
WIRE OR STEEL BURNING	S-9
ALLOWABLE TRENCH WIDTHS	S-10

**COLLECT CHARGES AS INDICATED**

**NOTICE TO CONTRACTOR**  
 The existence and location of any underground utility pipes or structures shown on these plans are obtained by a search of the available records to the best of my knowledge there are no existing utilities except as shown on these plans. The contractor is required to take due precautionary measures to protect the utility lines shown and any other lines not of record or not shown on these plans.

*Ermine Arveds*  
 REG. C.E. NO. 10916

NOTES:  
 GRADES TO WHICH THIS IMPROVEMENT IS TO BE CONSTRUCTED ARE SHOWN ON PLANS AND PROFILES. GRADE POINTS FOR TOP OF CURBS, CENTER LINE OF STREETS, OR CENTER LINE OF ALLEYS ARE SHOWN BY CIRCLES ON PROFILES. AT ALL POINTS BETWEEN DESIGNATED POINTS THE GRADE SHALL BE ESTABLISHED SO AS TO CONFORM TO A STRAIGHT LINE BETWEEN SAID DESIGNATED POINTS. ELEVATIONS ARE IN FEET ABOVE U.S.C. & G.S. SEA LEVEL DATUM OF 1929.  
 THE EXISTING GRADE SHALL BE ESTABLISHED BY THE STANDARD APPROVED METHOD FOR FIELD AND MANHOLE SURVEYING. THE EXISTING GRADE SHALL BE ESTABLISHED BY THE STANDARD APPROVED METHOD FOR FIELD AND MANHOLE SURVEYING. THE EXISTING GRADE SHALL BE ESTABLISHED BY THE STANDARD APPROVED METHOD FOR FIELD AND MANHOLE SURVEYING.  
 BEFORE WORK CAN BE STARTED, THE CONTRACTOR MUST OBTAIN A PERMIT TO EXCAVATE IN COUNTY STREETS FROM THE L.A. COUNTY ROAD DEPT., DISTRICT OFFICE NO. 5, AND PAY A FEE TO THE COUNTY ENGINEER, 3150 S. GARDEN ST., LOS ANGELES, CALIF. APPROVAL OF THIS PLAN BY THE COUNTY OF LOS ANGELES DOES NOT CONSTITUTE A REPRESENTATION AS TO THE ACCURACY OF THE LOCATION OF OR THE EXISTENCE OR NON-EXISTENCE OF ANY UNDERGROUND UTILITY PIPE, OR STRUCTURE WITHIN THE LIMITS OF THE PROJECT. THIS NOTE APPLIES TO ALL PAGES.  
 IF WORK IS TO BE DONE IN A STATE HIGHWAY, A PERMIT MUST BE OBTAINED FROM THE STATE OF CALIFORNIA, DIVISION OF HIGHWAYS, THE SOUTH SPRING STREET, LOS ANGELES, CALIFORNIA.  
 THE DRAWING AND THE CONTRACT AGREEMENT ARE HEREBY MADE A PART OF THE SPECIFICATIONS.  
 COUNTY OF LOS ANGELES, CALIFORNIA  
 HARVEY L. BRINDT, COUNTY ENGINEER J. D. PARKHURST, CHIEF ENGINEER  
 CO. SAN. DIST. NO. 8

APPROVED: *Harvey L. Brindt* 12/3/71 REGIONAL ENGINEER OFFICE  
 APPROVED BY: *J. D. Parkhurst* OFFICE ENGINEER

CHECKED: *R. L. Gagny* 12/3/71  
 REG. C.E. NO. 16762

13064

J.N. 0250.02

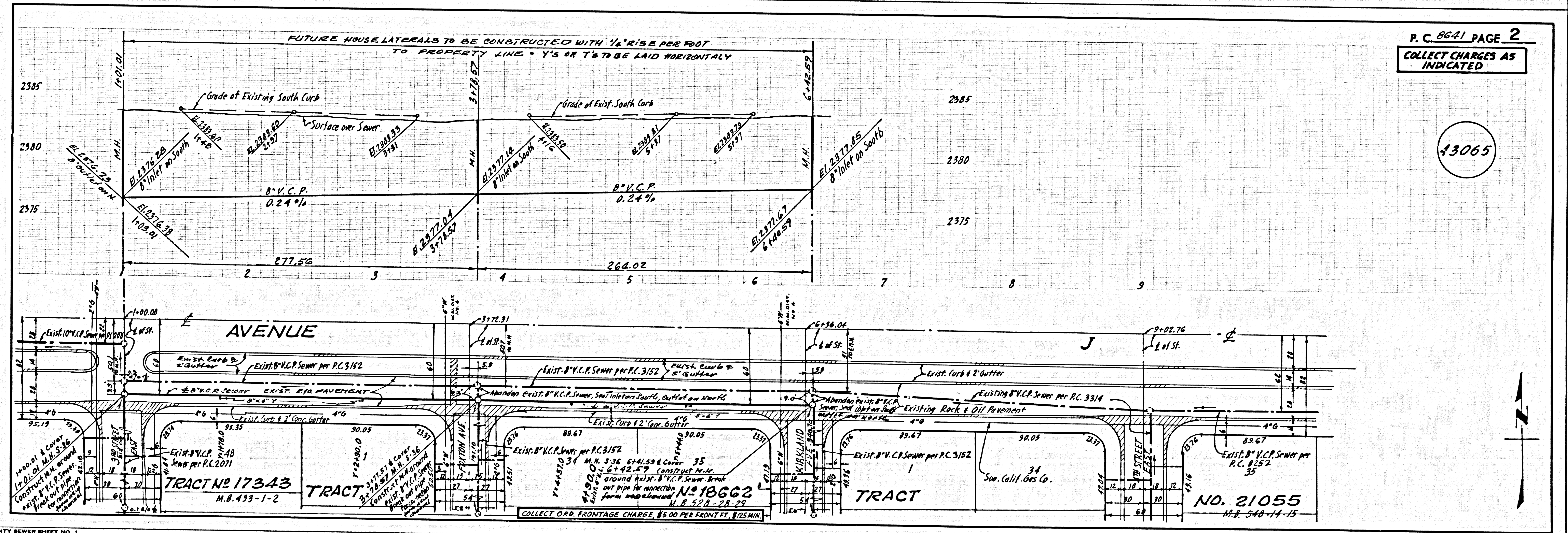

P. C. 8641 PAGE 2  
 COLLECT CHARGES AS INDICATED

13065

