

B.M. BY 2379 ELEV. 62.969  
 F.C. BR. CAPS 5' x 5' ANGLE POINT WING WALL S.W.  
 COR. BRIDGE NO. 774 ON ALAMEDA ST OVER  
 COMPTON CREEK 28' x W. E. 600' x S. ARTESIA  
 BLVD. GARDENA QUAD. 19 65ADJ.

- THE FOLLOWING LATEST REVISED STANDARD PLANS ON FILE IN THE OFFICE OF THE COUNTY ENGINEER SHALL APPLY IN THE CONSTRUCTION OF THIS PROJECT
- LEGEND
- MIM. EXCAVATION SAFETY REQUIREMENTS 5-2
  - BRICK MANNHOLE 5-3
  - NON REINFORCED PRECAST CONCRETE M.H. 5-36
  - M.H. FRAME & COVER 5-35
  - MANNHOLE STEP 5-17
  - BEDDING FOR SEWER PIPS 5-21
  - WYE OR TEE SUPPORT 5-26
  - ALLOWABLE TRENCH WIDTH 5-33
  - CORE DRILL (COUNTY SANITATION DIST.) 5-8-66

DOMINGUEZ BLDG. DIST. NO. 13

PROFILE ALIGNMENT AND GRADE OF P.C. 8643  
 SANITARY SEWERS PAGE 1

TO BE CONSTRUCTED IN  
 P.M. No. 1978

PRIVATE CONTRACT NO. 8643

W.S. 32  
 1 SHEET, 2 PAGES  
 SCALE: VERT. 1" = 4'  
 HORIZ. 1" = 40'  
 AUGUST, 1978  
 PREPARED IN THE OFFICES OF  
 E.L. PEARSON AND ASSOCIATES  
 1551 W. REDONDO BEACH BLVD.  
 By: Robert D. Hundell  
 REG. C. E. NO. 17062

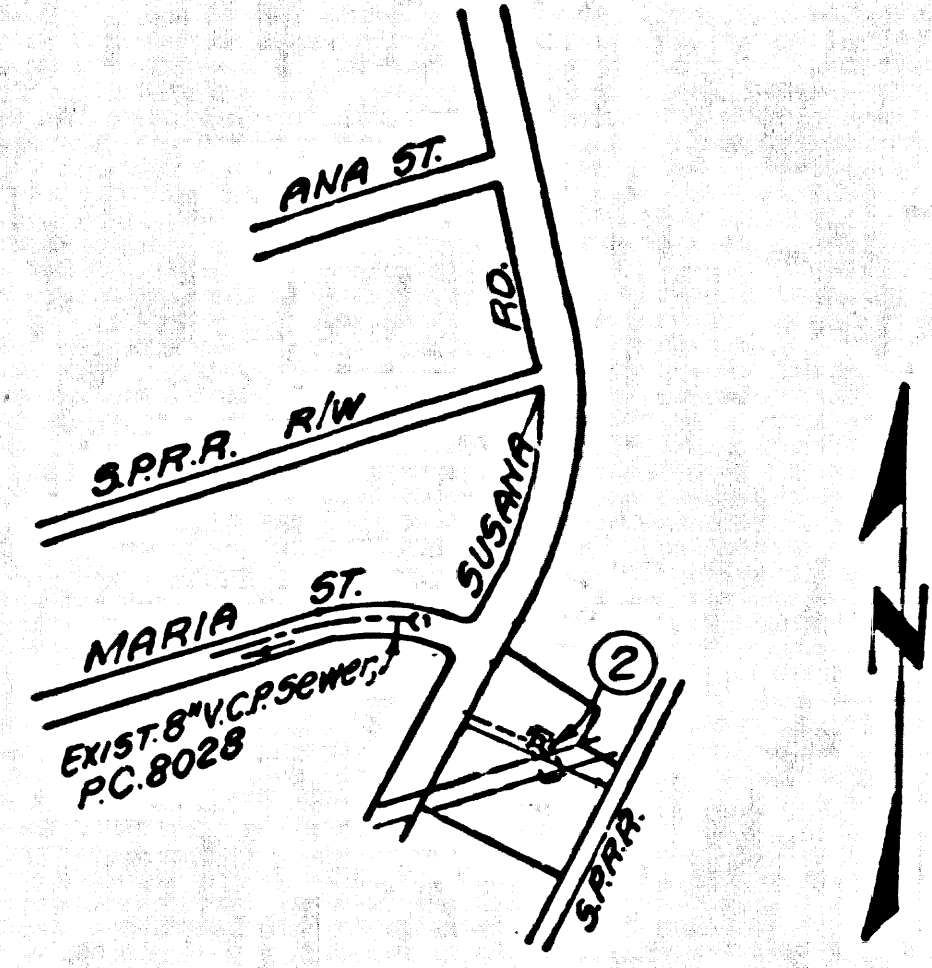

INDEX MAP  
 SCALE: 1" = 600'  
 P.M. 1978  
 P.C. 8643

1. PROVIDE STAKES ON THE PROPERTY LINE OR PROPERTY LINES PRODUCED AT RIGHT ANGLES TO THE SEWER LINE AT THE CENTER LINE OF EACH MANNHOLE.
2. NO REPRESENTATIVE OF THE COUNTY ENGINEER WILL SURVEY OR LAY OUT ANY PORTION OF THE WORK.
3. THE PRIVATE ENGINEER SHALL FURNISH THE COUNTY ENGINEER WITH GRADE SHEETS AND STATIONINGS FOR ALL HOUSE LATERALS AND "T" BRANCHES AND SHALL PROVIDE STAKES FOR THEM AT THEIR PROPER LOCATIONS WITH STATIONINGS PLAINLY MARKED. ALL HOUSE LATERALS SHALL BE CONSTRUCTED AT RIGHT ANGLES FROM THE MAIN LINE SEWER EXCEPT AS SHOWN ON THE PLANS. HOUSE LATERALS FROM CHIMNEYS SHALL NOT HAVE AN ANGLE OF LESS THAN 45° WITH THE MAIN LINE SEWER. ANY CHANGE IN ALIGNMENT SHALL BE REQUESTED IN WRITING BY THE PRIVATE ENGINEER.
4. THE PRIVATE ENGINEER SHALL FURNISH THE HOUSE LATERAL DEPTH AT THE PROPERTY LINE BELOW THE TOP OF CURB ELEVATION FOR EACH HOUSE LATERAL ON THE GRADE SHEET.
5. NO REVISIONS SHALL BE MADE IN THESE PLANS WITHOUT THE APPROVAL OF THE COUNTY ENGINEER.
6. THE CONTRACTOR SHALL NOTIFY THE CONSTRUCTION DIVISION BY TELEPHONE, MANDATORY 9-4-62, EXT. 81581, AT LEAST TWENTY-FOUR HOURS BEFORE STARTING ANY WORK UNDER THIS CONTRACT.
7. ALL STRUCTURES SHALL BE EITHER BRICK MANNHOLES PER 5-3 OR PRECAST CONCRETE MANNHOLES PER 5-36, EXCEPT AS NOTED.
8. USE STANDARD MANNHOLE FRAMES AND COVERS, 21 1/2" EXCEPT AS NOTED.
9. MANNHOLE TOPS IN UNIMPROVED RIGHTS-OF-WAY TO BE SIX INCHES ABOVE FINISHED GRADE.
10. USE EXTRA STRENGTH PIPE. ALL PIPE IS STANDARD DEPTH EXCEPT AS NOTED.
11. USE MECHANICAL-COMPRESSION JOINTS FOR ALL V.C.P. JOINTS PER SPEC. 5-26-66, 5-26-66, 5-26-66.
12. IF A POWER POLE IS WITHIN THREE FEET OF THE SEWER, THE SEWER SHALL BE ENCASED, PER 5-23, TWO FEET ON EACH SIDE FROM THE POINT OF INTERFERENCE.
13. IF DURING THE COURSE OF CONSTRUCTION IT IS DETERMINED THAT THERE IS LESS THAN FOUR FEET OF COVER OVER THE TOP OF A MAIN LINE OR HOUSE LATERAL V.C.P. SEWER WHICH IS NOT INDICATED ON THE PLANS, THE PIPE SHALL BE ENCASED PER 5-23, UNLESS OTHERWISE APPROVED BY THE COUNTY ENGINEER.
14. HOUSE LATERALS TO BE CONSTRUCTED WITH BIVENTS AT PROPERTY LINE 6 FEET BELOW CURB GRADE EXCEPT AS NOTED.
15. RESURFACE ALL TRENCHES WITHIN PAVED AREAS TO MEET L.A. COUNTY ROAD DEPT. OR CALIFORNIA STATE HIGHWAY REQUIREMENTS IN ACCORDANCE WITH PERMITS.
16. SEWERS TO BE TESTED FOR LEAKAGE PER SEC. 306-2.3.1 OF THE STD. SPEC'S & SPEC. 5-26-66.
17. REFER TO SEC. 7-10.4.1 OF THE STD. SPEC'S REGARDING SAFETY ORDERS.
18. ALL JOINTS BETWEEN CAST IRON AND WROUGHT IRON SHALL BE MADE WITH A RUBBER SLEEVE JOINT TYPE "C" OR "D" WITHIN BUSHINGS IF NECESSARY PER STD. SPEC. 5-26-66.

County Sanitation Districts shall be notified prior to the following so that required inspection can be made (Phone 337-1025 & 838-1181)

Core Drilling District trunk sewer.

Alignment of the project.

No connections for the disposal of industrial wastes shall be made to sewers shown on these drawings without written permission from the Chief Engineer and General Manager of the County Sanitation Districts.

NOTICE TO CONTRACTOR

The existence and location of any underground utility pipes or structures shown on these plans are obtained by a search of the available records. To the best of my knowledge there are no existing utilities except as shown on these plans. The contractor is required to take due precautionary measures to protect the utility lines shown and any other lines not of record or not shown on these plans.

Robert D. Hundell  
 REG. C.E. NO. 17062

COLLECT CHARGES AS INDICATED

NOTE:  
 GRADES TO WHICH THE IMPROVEMENT IS TO BE CONSTRUCTED ARE SHOWN ON PLANS AND PROFILES. GRADE POINTS FOR TOP OF CURBS, CENTER LINE OF STREETS, OR CENTER LINE OF ALLEYS ARE SHOWN BY CIRCLES ON PROFILES. AT ALL POINTS BETWEEN DESIGNATED POINTS THE GRADE SHALL BE ESTABLISHED SO AS TO CONFORM TO A STRAIGHT LINE DRAWN BETWEEN SAID DESIGNATED POINTS. ELEVATIONS ARE IN FEET ABOVE U.S.C. & G.S. SEA LEVEL UNLESS OTHERWISE NOTED.

BEFORE WORK CAN BE STARTED, THE CONTRACTOR MUST OBTAIN A PERMIT TO EXCAVATE IN COUNTY STREETS FROM THE L.A. COUNTY ROAD DEPT. DISTRICT OFFICE NO. 1 AND PAY A FEE TO THE COUNTY ENGINEER, ROOM 7, BOARD OF RECORDS OFFICE, LOCATION OF THE EXISTING OR NON-EXISTENCE OF ANY UNDERGROUND UTILITY PIPES, OR STRUCTURE WITHIN THE LIMITS OF THIS PROJECT. THIS NOTE APPLIES TO ALL PAGES.

IF WORK IS TO BE DONE IN A STATE HIGHWAY, A PERMIT MUST BE OBTAINED FROM THE STATE OF CALIFORNIA, DIVISION OF HIGHWAY, 120 SOUTH BRIDGE STREET, LOS ANGELES, CALIFORNIA.

COUNTY OF LOS ANGELES, CALIFORNIA  
 HARVEY T. BRANDT, COUNTY ENGINEER J. D. PARKHURST, CHIEF ENGINEER

APPROVED BY: Robert D. Hundell 9-16-78 REGIONAL ENGINEER APPROVED BY: J. D. Parkhurst OFFICE ENGINEER

CHECKED BY: Robert D. Hundell 9/16/78 REG. C.E. NO. 17062

42893

J.N. 025005

P.C. 8643 PAGE 2

NO CHARGE FOR CONNECTIONS

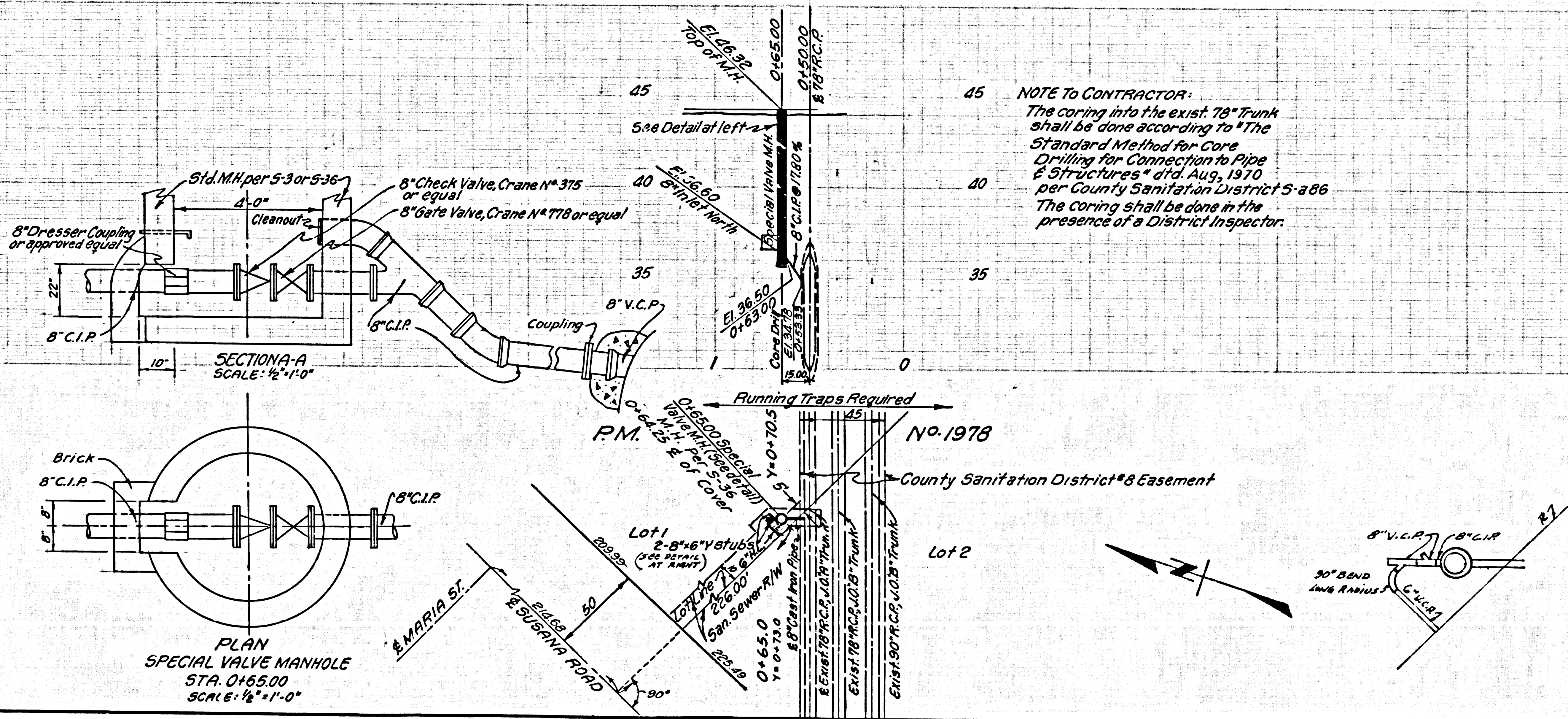

NOTE TO CONTRACTOR:  
 The coring into the exist. 18" Trunk Sewer shall be done according to the Standard Method for Core Drilling for Connection to Pipe & Structures of Dist. No. 1978 per County Sanitation District 5-a-86. The coring shall be done in the presence of a District Inspector.

42844