

B.M. BL 1741 ELEV. 1349.492  
 F.C. MON FLUSH 27 FT. E. C/L BOUQUET  
 CANYON RD. +175 FT. S. PLUM CANYON  
 RD. AFT. S TP 437093H MKDCBM144  
 00800 1963) 2 IN 10 MKR. 3 FT. UP 2 FT. S.  
 NEWHALL QUAD. 1965

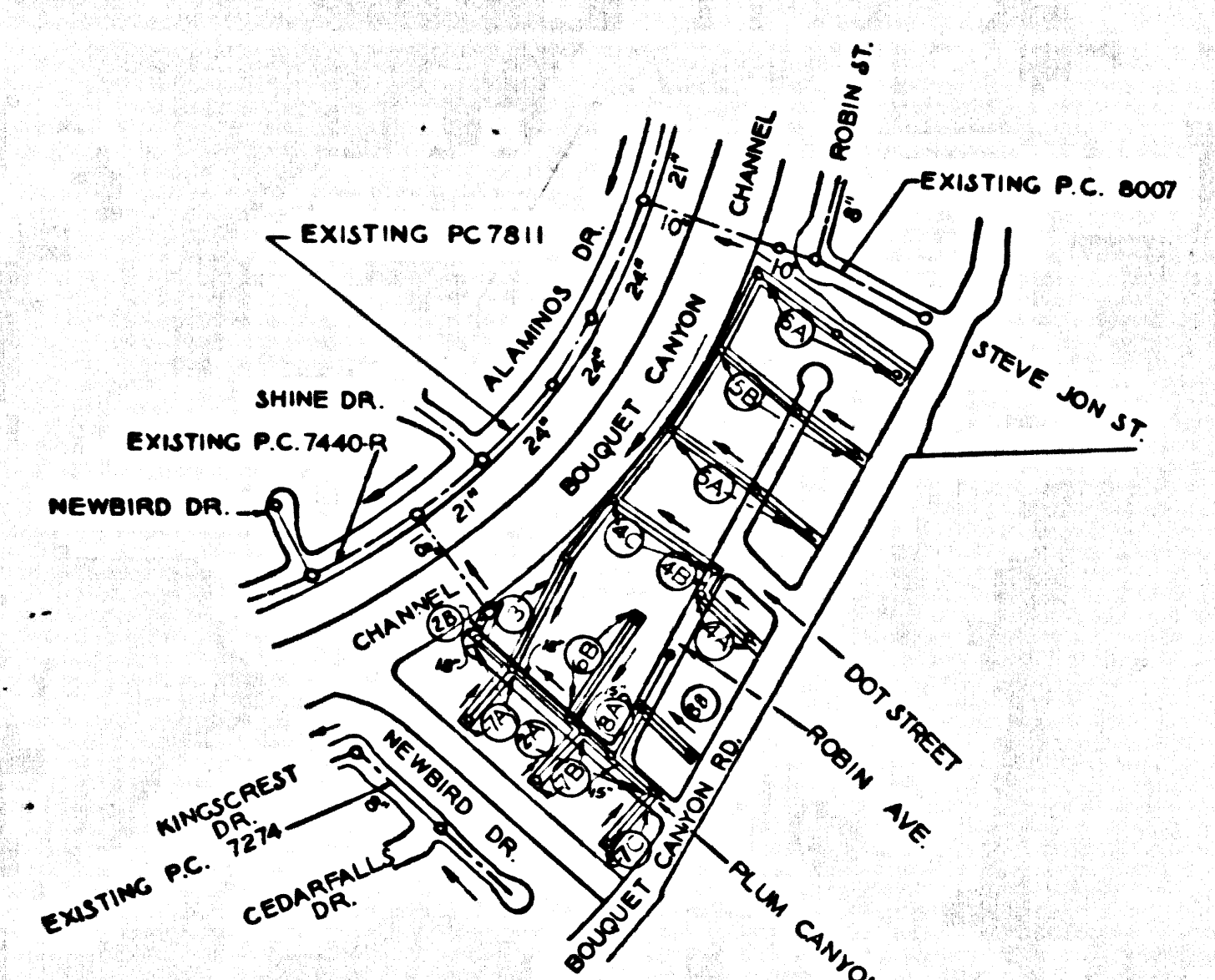

INDEX MAP  
 P.C. NO. 8666-R  
 TRACT NO. 27375  
 SCALE: 1" = 500'

FULL COMPLIANCE WITH SECTION 306-193 OF THE SPECIAL  
 ORDINANCES WILL BE REQUIRED FOR BACKFILL IN STREETS  
 CERTIFICATION OF BACKFILL CONACTION AND SAND  
 EQUIVALENTS BY A QUALIFIED REGISTERED TESTING  
 LABORATORY SHALL BE PROVIDED BY THE PERMITTEE  
 PRIOR TO THE ISSUANCE OF A CERTIFICATE OF  
 PARTIAL ACCEPTANCE.

20. SPECIAL BACKFILL IN DESIGNATED AREAS  
 (A) BACKFILL TRENCH AND REPLACE OTHER EARTH  
 REMOVED SO AS TO ACHIEVE THE NATURAL OR  
 FINISHED GRADES AND SLOPES SHOWN ON THE  
 GRADING PLAN APPROVED FOR THIS TRACT BY THE  
 BUILDING AND SAFETY DIVISION.  
 (B) ALL BACKFILL AND EARTH REPLACED SHALL BE  
 COMPACTED TO A MINIMUM OF 90% OF MAXIMUM  
 DENSITY PER A.S.T.M. STANDARD METHOD OF TEST  
 D698-57T AS MODIFIED. ACCEPTABLE CERTIFICATION  
 OF SUCH COMPACTION SHALL BE SUBMITTED TO  
 THE CONSTRUCTION DIVISION.

County Sanitation District shall be  
 notified prior to the following so  
 that required inspection can be made  
 (Phone 337-1023 or 638-1181)

As connections for the disposal of  
 industrial wastes shall be made to  
 sewers shown on these drawings  
 without written permission from the  
 Chief Engineer and General Manager  
 of the County Sanitation District.

Revision	Date 8-12-75
Sheet 8-A Sub 8-16-1-Sub 8-16-1	514200
5-A	514446
5-B	510600
5-C	510600
5-D	510600
5-E	510600
5-F	510600
5-G	510600
5-H	510600
5-I	510600
5-J	510600
5-K	510600
5-L	510600
5-M	510600
5-N	510600
5-O	510600
5-P	510600
5-Q	510600
5-R	510600
5-S	510600
5-T	510600
5-U	510600
5-V	510600
5-W	510600
5-X	510600
5-Y	510600
5-Z	510600
5-AA	510600
5-AB	510600
5-AC	510600
5-AD	510600
5-AE	510600
5-AF	510600
5-AG	510600
5-AH	510600
5-AI	510600
5-AJ	510600
5-AK	510600
5-AL	510600
5-AM	510600
5-AN	510600
5-AO	510600
5-AP	510600
5-AQ	510600
5-AR	510600
5-AS	510600
5-AT	510600
5-AU	510600
5-AV	510600
5-AW	510600
5-AX	510600
5-AY	510600
5-AZ	510600
5-BA	510600
5-BB	510600
5-BC	510600
5-BD	510600
5-BE	510600
5-BF	510600
5-BG	510600
5-BH	510600
5-BI	510600
5-BJ	510600
5-BK	510600
5-BL	510600
5-BM	510600
5-BN	510600
5-BO	510600
5-BP	510600
5-BQ	510600
5-BR	510600
5-BS	510600
5-BT	510600
5-BU	510600
5-BV	510600
5-BW	510600
5-BX	510600
5-BY	510600
5-BZ	510600
5-CA	510600
5-CB	510600
5-CC	510600
5-CD	510600
5-CE	510600
5-CE	510600

DOUBLE SCALE  
 NEWHALL BLDG. DIST. NO. 8.2

1. HOUSE SEWERS ON THE PROPERTY LINE OR PROPERTY LINES PRODUCED AT RIGHT ANGLES TO THE SEWER LINE AT THE CENTER LINE OF EACH MANHOLE.
2. NO REPRESENTATIVE OF THE COUNTY ENGINEER WILL SURVEY OR LAY OUT ANY PORTION OF THE WORK.
3. THE PRIVATE ENGINEER SHALL FURNISH THE COUNTY ENGINEER WITH GRADE SHEETS AND STATIONING FOR ALL HOUSE LATERALS TO "T" OR "Y" BRANCHES AND SHALL PROVIDE EASES FOR THEM AT THEIR PROPER LOCATIONS WITH STATIONING PLAINLY MARKED. ALL HOUSE LATERALS SHALL BE CONSTRUCTED IN A STRAIGHT ALIGNMENT AT RIGHT ANGLES FROM THE MAIN LINE SEWER EXCEPT AS SHOWN ON THE PLANS. HOUSE LATERALS FROM CHIMNEYS SHALL NOT HAVE AN ANGLE OF LESS THAN 45° WITH THE MAIN LINE SEWER. ANY CHANGE IN ALIGNMENT SHALL BE REQUESTED BY WRITING BY THE PRIVATE ENGINEER.
4. THE PRIVATE ENGINEER SHALL FURNISH THE HOUSE LATERAL DEPTH AT THE PROPERTY LINE BELOW THE TOP OF CURB ELEVATION OR 6" DRIVEWAY ELEVATION FOR EACH HOUSE LATERAL ON THE GRADE SHEET.
5. NO REVISIONS SHALL BE MADE IN THESE PLANS WITHOUT THE APPROVAL OF THE COUNTY ENGINEER.
6. THE CONTRACTOR SHALL NOTIFY THE CONSTRUCTION DIVISION BY TELEPHONE, MADISON 5-424, EXT. 81931, AT LEAST TWENTY-FOUR HOURS BEFORE STARTING ANY WORK UNDER THIS CONTRACT.
7. MANHOLES SHALL BE BRICK STRUCTURES PER 8.2.1. PRECAST CONCRETE MANHOLES PER 8.2.4 EXCEPT AS NOTED.
8. SEWERS TO BE TESTED FOR LEAKAGE PER SECTION 306-2.3.7 OF THE STANDARD SPECIFICATIONS.
9. MANHOLE TOPS IN UNIMPROVED HIGHWAYS TO BE LEVEL WITH FINISHED GRADE.
10. VITRIFIED CLAY PIPE JOINTS SHALL BE TYPE "D", "E", OR "G" PER STD. SPEC. 208-2.
11. USE EXTRA STRENGTH PIPE ALL PIPE IS STANDARD DEPTH EXCEPT AS NOTED.
12. IF A POWER POLE IS WITHIN THREE FEET OF THE SEWER, THE SEWER SHALL BE ENCASED, PER 8.2.5. TWO FEET ON EACH SIDE FROM THE POINT OF INTERFERENCE.
13. IF DURING THE COURSE OF CONSTRUCTION IT IS DETERMINED THAT THERE IS LESS THAN FOUR FEET OF COVER OVER THE TOP OF A MAIN LINE OR HOUSE LATERAL V.C.P. SEWER WHICH IS NOT INDICATED ON THE PLANS, THE PIPE SHALL BE ENCASED PER 8.2.5 UNLESS OTHERWISE APPROVED BY THE COUNTY ENGINEER.
14. HOUSE LATERALS TO BE CONSTRUCTED WITH INVERTS AT PROPERTY LINE 4 FEET BELOW CURB GRADE OR 6" OF DRIVEWAY ELEVATION EXCEPT AS NOTED.
15. RESURFACE ALL TRENCHES WITHIN PAVED AREAS TO MEET L.A. COUNTY ROAD DEPT. OR CALIFORNIA STATE HIGHWAY REQUIREMENTS IN ACCORDANCE WITH PERMITS.
16. REFER TO SEC. 70-4.1 OF STANDARD SPECS. REGARDING SAFETY ORDERS.
17. SEWER PIPE BEDDING TO CONFORM TO 5-2.1.
18. "T" OR "Y" BRANCHES MAY BE USED FOR CONNECTIONS TO MAINLINE SEWERS EXCEPT AS NOTED.
19. THE FOLLOWING COUNTY ENGINEER STANDARD PLANS APPLY TO THIS PROJECT:
  - STANDARD PUBLIC SAFETY REQUIREMENTS 5-7
  - STANDARD MANHOLE ELEVATION 5-8
  - STANDARD MANHOLE 5-9
  - STANDARD MANHOLE 5-10
  - STANDARD MANHOLE 5-11
  - STANDARD MANHOLE 5-12
  - STANDARD MANHOLE 5-13
  - STANDARD MANHOLE 5-14
  - STANDARD MANHOLE 5-15
  - STANDARD MANHOLE 5-16
  - STANDARD MANHOLE 5-17
  - STANDARD MANHOLE 5-18
  - STANDARD MANHOLE 5-19
  - STANDARD MANHOLE 5-20
  - STANDARD MANHOLE 5-21
  - STANDARD MANHOLE 5-22
  - STANDARD MANHOLE 5-23
  - STANDARD MANHOLE 5-24
  - STANDARD MANHOLE 5-25
  - STANDARD MANHOLE 5-26
  - STANDARD MANHOLE 5-27
  - STANDARD MANHOLE 5-28
  - STANDARD MANHOLE 5-29
  - STANDARD MANHOLE 5-30
  - STANDARD MANHOLE 5-31
  - STANDARD MANHOLE 5-32
  - STANDARD MANHOLE 5-33
  - STANDARD MANHOLE 5-34
  - STANDARD MANHOLE 5-35
  - STANDARD MANHOLE 5-36
  - STANDARD MANHOLE 5-37
  - STANDARD MANHOLE 5-38
  - STANDARD MANHOLE 5-39
  - STANDARD MANHOLE 5-40
  - STANDARD MANHOLE 5-41
  - STANDARD MANHOLE 5-42
  - STANDARD MANHOLE 5-43
  - STANDARD MANHOLE 5-44
  - STANDARD MANHOLE 5-45
  - STANDARD MANHOLE 5-46
  - STANDARD MANHOLE 5-47
  - STANDARD MANHOLE 5-48
  - STANDARD MANHOLE 5-49
  - STANDARD MANHOLE 5-50
  - STANDARD MANHOLE 5-51
  - STANDARD MANHOLE 5-52
  - STANDARD MANHOLE 5-53
  - STANDARD MANHOLE 5-54
  - STANDARD MANHOLE 5-55
  - STANDARD MANHOLE 5-56
  - STANDARD MANHOLE 5-57
  - STANDARD MANHOLE 5-58
  - STANDARD MANHOLE 5-59
  - STANDARD MANHOLE 5-60
  - STANDARD MANHOLE 5-61
  - STANDARD MANHOLE 5-62
  - STANDARD MANHOLE 5-63
  - STANDARD MANHOLE 5-64
  - STANDARD MANHOLE 5-65
  - STANDARD MANHOLE 5-66
  - STANDARD MANHOLE 5-67
  - STANDARD MANHOLE 5-68
  - STANDARD MANHOLE 5-69
  - STANDARD MANHOLE 5-70
  - STANDARD MANHOLE 5-71
  - STANDARD MANHOLE 5-72
  - STANDARD MANHOLE 5-73
  - STANDARD MANHOLE 5-74
  - STANDARD MANHOLE 5-75
  - STANDARD MANHOLE 5-76
  - STANDARD MANHOLE 5-77
  - STANDARD MANHOLE 5-78
  - STANDARD MANHOLE 5-79
  - STANDARD MANHOLE 5-80
  - STANDARD MANHOLE 5-81
  - STANDARD MANHOLE 5-82
  - STANDARD MANHOLE 5-83
  - STANDARD MANHOLE 5-84
  - STANDARD MANHOLE 5-85
  - STANDARD MANHOLE 5-86
  - STANDARD MANHOLE 5-87
  - STANDARD MANHOLE 5-88
  - STANDARD MANHOLE 5-89
  - STANDARD MANHOLE 5-90
  - STANDARD MANHOLE 5-91
  - STANDARD MANHOLE 5-92
  - STANDARD MANHOLE 5-93
  - STANDARD MANHOLE 5-94
  - STANDARD MANHOLE 5-95
  - STANDARD MANHOLE 5-96
  - STANDARD MANHOLE 5-97
  - STANDARD MANHOLE 5-98
  - STANDARD MANHOLE 5-99
  - STANDARD MANHOLE 5-100

COLLECT CHARGES  
 AS INDICATED

NOTICE TO CONTRACTOR  
 The existence and location of any underground utility pipes or structures shown on these plans are obtained by a search of the available records to the best of my knowledge there are no existing utilities except as shown on these plans. The contractor is required to take due precautionary measures to protect the utility lines shown and any other lines not of record or not shown on these plans.

PROFILE ALIGNMENT AND GRADE OF  
 SANITARY SEWERS PAGE 1

CONSTRUCTED IN  
 TRACT NO. 27375  
 PRIVATE CONTRACT NO. 8666-R

W.S. 62  
 4 SHEETS, 8 PAGES  
 SCALE: HORIZ. 1" = 40' VERT. OCT. 1971  
 PREPARED IN THE OFFICES OF  
 ANDEL ENGINEERING CO. 43321  
 BY: E.L. BOLDEN, JR. REG. C.E. NO. 10533  
 FOR LEGEND SEE PLAN NO. 5-1

NOTE: THIS DRAWING AND THE DATA HEREON ARE HEREBY MADE A PART OF THE SPECIFICATIONS. GRADE TO WHICH THE IMPROVEMENT IS TO BE CONSTRUCTED AS SHOWN ON PLANS AND PROFILES. GRADE POINTS FOR TOP OF CURBS, CENTER LINE OF STREETS, OR CENTER LINE OF ALLEYS ARE SHOWN BY CIRCLES ON PLANS AND PROFILES. AT ALL POINTS BETWEEN DESIGNATED POINTS THE GRADE SHALL BE ESTABLISHED SO AS TO CONFORM TO A STRAIGHT LINE DRAWN BETWEEN SAID DESIGNATED POINTS. ELEVATIONS ARE IN FEET ABOVE U.S.C. & G.S. MEAN SEA LEVEL DATUM OF 1929. WORK SHALL BE CONSTRUCTED ACCORDING TO STANDARD SPECIFICATIONS FOR PUBLIC WORKS CONSTRUCTION (1970 EDITION) WITH 1971 SUPPLEMENTS AND COUNTY ENGINEER SPECIAL PROVISIONS DATED APRIL 1, 1970 AND SHALL BE PROSECUTED ONLY IN THE PRESENCE OF THE COUNTY ENGINEER. BEFORE WORK CAN BE STARTED, THE CONTRACTOR MUST OBTAIN A PERMIT TO EXCAVATE IN COUNTY STREETS FROM THE L.A. COUNTY ROAD DEPT., DISTRICT OFFICE NO. 10 TO THE COUNTY ENGINEER, REGIONAL OFFICE, SUFFICIENT TO COVER THE COST OF DOWNY. APPROVAL OF THIS PLAN BY THE COUNTY OF LOS ANGELES DOES NOT CONSTITUTE A REPRESENTATION AS TO THE ACCURACY OF THE LOCATION OF OR THE EXISTENCE OR NON-EXISTENCE OF ANY UNDERGROUND UTILITY PIPE, OR STRUCTURE WITHIN THE LIMITS OF THE PROJECT. THIS NOTE APPLIES TO ALL PAGES.

COUNTY OF LOS ANGELES, CALIFORNIA  
 HARVEY T. BRANDT, COUNTY ENGINEER J. D. PARKHURST, CHIEF ENGINEER  
 APPROVED BY: [Signature] OFFICE ENGINEER

CHECKED BY: [Signature] 2/2/72  
 REG. C.E. NO. 14330

J.N.0250-02

