

B.M. W-2 R.D.L. WILSON ELEV. 978 (M.L.L.W.)  
 L.A. County Eng. Tag in NW 1/4 curb of  
 Washington St on approx. E Palawan Way  
 prod. 38' N.W. of E Washington St and 42'  
 SW of E Wilson Ave.  
**HAWTHORNE QUAD. 1960**

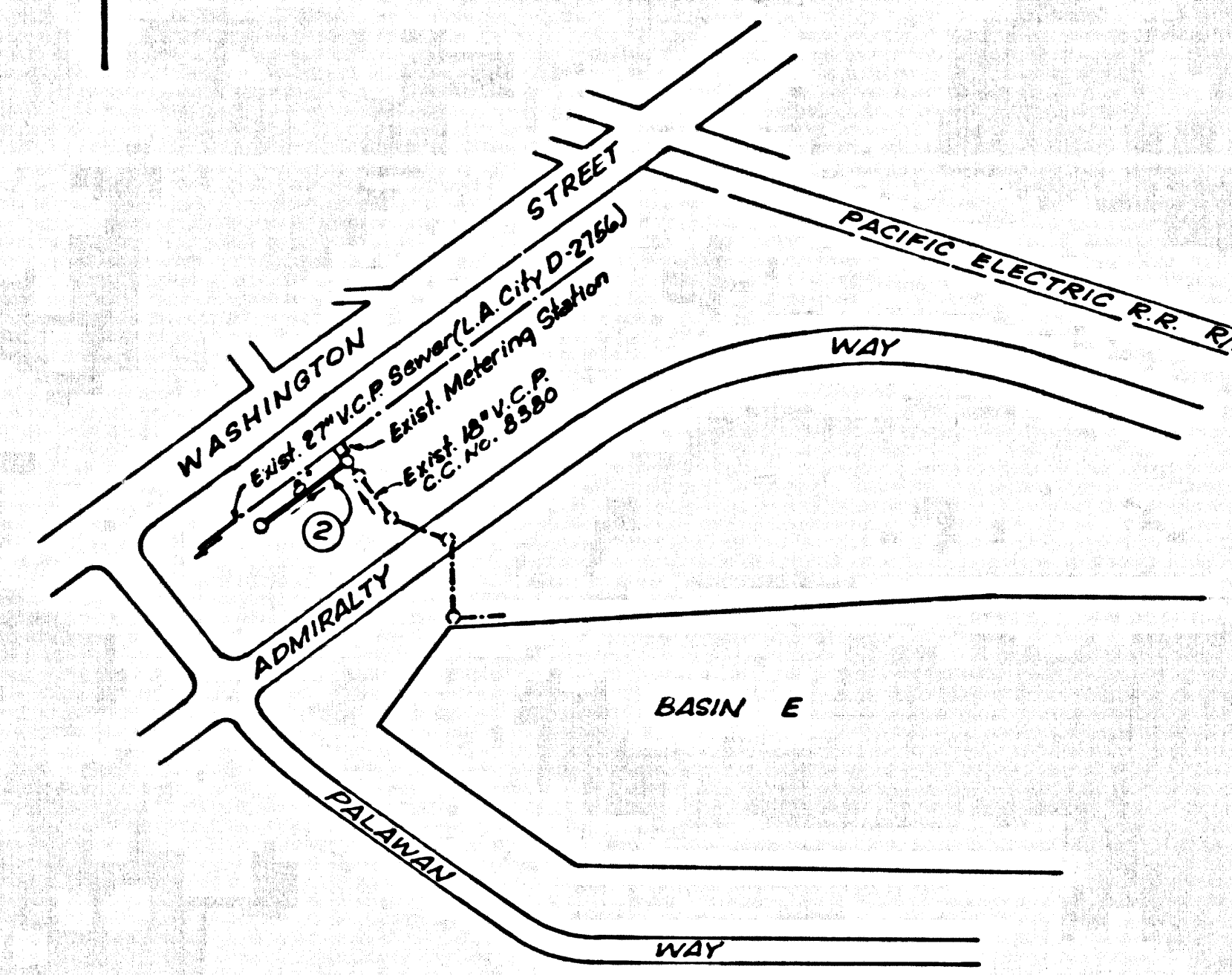

**INDEX MAP**  
 SCALE: 1" = 400'  
 P.C. 8683  
 NOTE: FIGURE IN CIRCLE INDICATES PAGE NUMBER

THE CONTRACTOR SHALL NOTIFY THE WATERWORKS AND UTILITIES DIVISION BY TELEPHONE, 756-1341 (MR. JOHN GARDNER), AT LEAST 24 HOURS BEFORE STARTING ANY WORK UNDER THIS PROJECT. THE CONTRACTOR SHALL COMPLY WITH ALL WATERWORKS STD'S FOR SUPPORT, PROTECTION AND BACKFILL OF EXISTING INTERFERING WATER MAINS UNDER THIS PROJECT.

**DOUBLE SCALE**  
**LENNOX BLDG. DIST. NO. 7**

- NOTES:
- HOUSE LATERALS TO BE CONSTRUCTED WITH INVERTS AT PROPERTY LINE 4 FEET BELOW CURB GRADE EXCEPT AS NOTED.
  - PROVIDE STAKES ON THE PROPERTY LINE OR PROPERTY LINES PRODUCED AT RIGHT ANGLES TO THE SEWER LINE AT THE CENTER LINE OF EACH MANHOLE.
  - NO REPRESENTATIVE OF THE COUNTY ENGINEER WILL SURVEY OR LAY OUT ANY PORTION OF THE WORK.
  - THE PRIVATE ENGINEER SHALL FURNISH THE COUNTY ENGINEER WITH GRADE SHEETS AND STATIONING FOR ALL HOUSE LATERALS AND "T" OR "Y" BRANCHES AND SHALL PROVIDE STAKES FOR THEM AT THESE PROPER LOCATIONS WITH STATIONING PLAINLY MARKED. ALL HOUSE LATERALS SHALL BE CONSTRUCTED IN A STRAIGHT ALIGNMENT AT RIGHT ANGLES FROM THE MAIN LINE SEWER EXCEPT AS SHOWN ON THE PLANS. HOUSE LATERALS FROM CHIMNEYS SHALL NOT HAVE AN ANGLE OF LESS THAN 45° WITH THE MAIN LINE SEWER. ANY CHANGE IN ALIGNMENT SHALL BE REQUESTED IN WRITING BY THE PRIVATE ENGINEER.
  - THE PRIVATE ENGINEER SHALL FURNISH THE HOUSE LATERAL DEPTH AT THE PROPERTY LINE BELOW THE TOP OF CURB ELEVATION FOR EACH HOUSE LATERAL ON THE GRADE SHEET.
  - NO REVISIONS SHALL BE MADE IN THESE PLANS WITHOUT THE APPROVAL OF THE COUNTY ENGINEER.
  - THE CONTRACTOR SHALL NOTIFY THE CONSTRUCTION DIVISION BY TELEPHONE, MADISON 6-4747, EXT. 81281, AT LEAST TWENTY-FOUR HOURS BEFORE STARTING ANY WORK UNDER THIS CONTRACT.
  - ALL STRUCTURES SHALL BE EITHER BRICK MANHOLES PER S-3 OR PRECAST CONCRETE MANHOLES PER S-3-G EXCEPT AS NOTED.
  - "T" OR "Y" BRANCHES MAY BE USED FOR CONNECTIONS TO MAINLINE SEWERS EXCEPT AS NOTED.
  - MANHOLE TOPS IN UNIMPROVED AREAS OR WHAT TO BE 24 INCHES ABOVE FINISHED GRADE, EXCEPT AS NOTED.
  - USE EXTRA STRENGTH PIPE. ALL PIPE IS STANDARD DEPTH EXCEPT AS NOTED.
  - VITRIFIED CLAY PIPE JOINTS SHALL BE TYPE "B", "C", OR "D" PER STANDARD SPECIFICATIONS SECTION 206.2.
  - IF A POWER POLE IS WITHIN THREE FEET OF THE SEWER, THE SEWER SHALL BE ENCASED, PER S-23, TWO FEET ON EACH SIDE FROM THE POINT OF INTERFERENCE.
  - IF DURING THE COURSE OF CONSTRUCTION IT IS DETERMINED THAT THERE IS LESS THAN FOUR FEET OF COVER OVER THE TOP OF A MAIN LINE OR HOUSE LATERAL V.C.P. SEWER WHICH IS NOT INDICATED ON THE PLANS, THE PIPE SHALL BE ENCASED PER S-23, UNLESS OTHERWISE APPROVED BY THE COUNTY ENGINEER.
  - PRIOR TO BEGINNING EXCAVATION, THE CONTRACTOR SHALL REQUEST THE UTILITY COMPANIES NOTED HEREBY AND THE CITY OF SMALL CRAFT HARBOURS TO MARK ALL UNDERGROUND OBSTRUCTIONS OR UTILITIES TO LINES.
  - REFER TO SECTION 7-18.41 OF THE STANDARD SPECIFICATIONS, REGARDING SAFETY DEVICES.
  - IF ANY JOINTS BETWEEN CAST IRON PIPE AND VITRIFIED CLAY PIPE SHALL BE MADE WITH A RUBBER SLEEVE JOINT, TYPE "C" OR "D", WITHIN BUSHING IF NECESSARY PER STANDARD SPECIFICATIONS, SECTION 206.2.
- THE FOLLOWING LATEST REVISED STANDARD PLANS ON FILE IN THE OFFICE OF THE COUNTY ENGINEER SHALL APPLY IN THE CONSTRUCTION OF THIS PROJECT:

MINIMUM PUBLIC SAFETY REQUIREMENTS	S-3
BRICK MANHOLE	S-3
PRECAST CONCRETE MANHOLE	S-3-G
SPECIAL SUPPORT AND PROTECTION	S-22
LOCKING MANHOLE FRAMES IF COVER	S-36
NON-REINFORCED PRECAST CONCRETE MANHOLES	S-36
STANDARD MANHOLE STEP	S-37
BEDDING FOR SEWER PIPE	S-31
CRACKING AND IMPELMENT	S-33
WIRE ON THE SUPPORT	S-34
ALLOWABLE TRENCH WIDTHS	S-35

PROFILE, ALIGNMENT AND GRADE OF  
**SANITARY SEWERS** P.C. 8683  
 TO BE CONSTRUCTED FOR PARCEL 145 R  
 MARINA DEL REY  
 PRIVATE CONTRACT NO. 8683  
 W.S. 23  
 1 SHEETS, 2 PAGES  
 SCALE: VERT. 1" = 8' HORIZ. 1" = 40'  
 DECEMBER, 1971  
 PREPARED IN THE OFFICES OF  
**PSOMAS AND ASSOCIATES**  
 Timothy G. Psomas  
 TIMOTHY G. PSOMAS REG. C. E. NO. 17643

GRADES TO WHICH THIS IMPROVEMENT IS TO BE CONSTRUCTED ARE SHOWN ON PLANS AND PROFILES. GRADE POINTS FOR TOP OF CURBS, CENTER LINE OF STREETS, OR CENTER LINE OF ALLEYS ARE SHOWN BY CIRCLES ON PROFILES. AT ALL POINTS BETWEEN DESIGNATED POINTS THE GRADE SHALL BE ESTABLISHED SO AS TO CONFORM TO A STRAIGHT LINE DRAWN BETWEEN SAID DESIGNATED POINTS. ELEVATIONS ARE IN FEET ABOVE DATUM BASED ON MEAN LOWER LOW WATER.

WORK SHALL BE CONSTRUCTED ACCORDING TO THE STANDARD SPECIFICATIONS FOR PUBLIC WORKS CONSTRUCTION (1970 EDITION) WITH CITY SUPERVISOR'S AND COUNTY ENGINEER'S SPECIAL PROVISIONS FROM THE CONSTRUCTION OF SANITARY SEWERS DATED APRIL 7, 1970 AND SHALL BE PROSECUTED ONLY IN THE PRESENCE OF THE COUNTY ENGINEER.

NO WORK CAN BE STARTED UNTIL THE CONTRACTOR OBTAINS A CONSTRUCTION PERMIT AND PAY A FEE TO THE COUNTY ENGINEER, SANITATION DIVISION, 3150 EAST IMPERIAL HIGHWAY, COMPTON, CALIFORNIA OR SENTINEL VALLEY REGIONAL OFFICE, 823 WEST LOMITA BLVD., COMPTON, CALIFORNIA. SURETY TO COVER THE COST OF CONSTRUCTION INSPECTION AND RECORDS PLANS.

APPROVAL OF THIS PLAN BY THE COUNTY OF LOS ANGELES DOES NOT CONSTITUTE A REPRESENTATION AS TO THE ACCURACY OF THE LOCATION OR OF THE EXISTENCE OR NON-EXISTENCE OF ANY UNDERGROUND UTILITY PIPE, OR STRUCTURE WITHIN THE LIMITS OF THE PROJECT. THIS NOTE APPLIES TO ALL PAGES.

IF WORK IS TO BE DONE IN A STATE HIGHWAY, A PERMIT MUST BE OBTAINED FROM THE STATE OF CALIFORNIA, DIVISION OF HIGHWAYS, 138 SOUTH SPRING STREET, LOS ANGELES, CALIFORNIA.

COUNTY OF LOS ANGELES, CALIFORNIA  
 HARVEY T. BRANDT, COUNTY ENGINEER  
 VICTOR ADORIAN, DIRECTOR  
 DEPT. OF SMALL CRAFT HARBOURS

APPROVED BY [Signature] 1-21-72 ASST. DIVISION ENGINEER DATE  
 APPROVED BY [Signature] DATE  
 CHECKED BY [Signature] 1-20-72 DATE  
 REG. C.E. NO. 10243

COLLECT CHARGES AS INDICATED

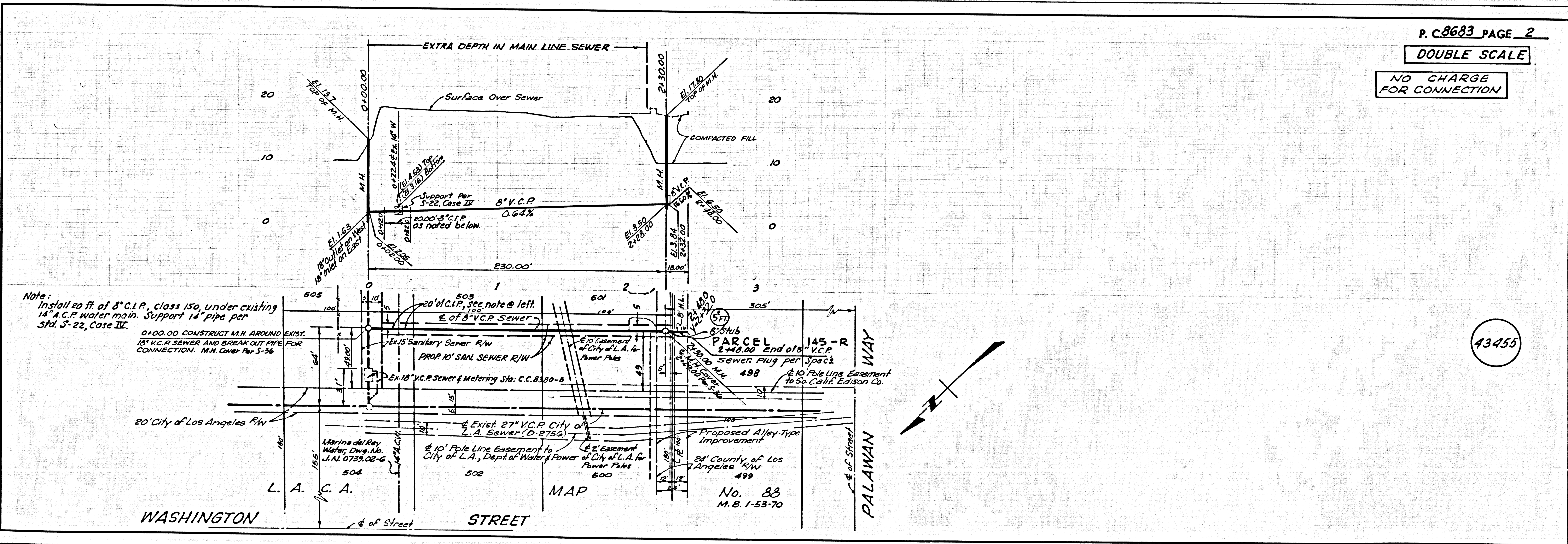

Note: Install 20 ft. of 8" C.I.P., class 150, under existing 14" C.P. water main. Support 14" pipe per Std. S-22, Code II.

0+00.00 CONSTRUCT M.H. AROUND EXIST. 18" V.C.P. SEWER AND BREAK OUT PIPE FOR CONNECTION. M.H. COVER PER S-36

20' City of Los Angeles R/W

20' of C.I.P., see note @ left  
 of 8" V.C.P. Sewer

Ex. 15" Sanitary Sewer R/W  
 PROP. 10' SAN. SEWER R/W

Ex. 18" V.C.P. Sewer & Metering Sta. C.C. 8380-B

Ex. 27" V.C.P. City of L.A. Sewer (D-2750)

10' Pole Line Easement to City of L.A., Dept. of Water & Power of L.A. & Power Poles 600

2' Easement to City of L.A. for Power Poles 600

Proposed Alley-Type Improvement

28' County of Los Angeles R/W 499

10' Pole Line Easement to So. Calif. Edison Co.

P.C. 8683 PAGE 2  
**DOUBLE SCALE**  
 NO CHARGE FOR CONNECTION

43455