

B.M. R-68 ELEV. 28.470 F.B. 2664-64
 Entrance drive (= Los Padrinos Dr.)
 North end of West side in curb over a
 drainage way.
 Bt. spk. in lead, pointed BMR-68

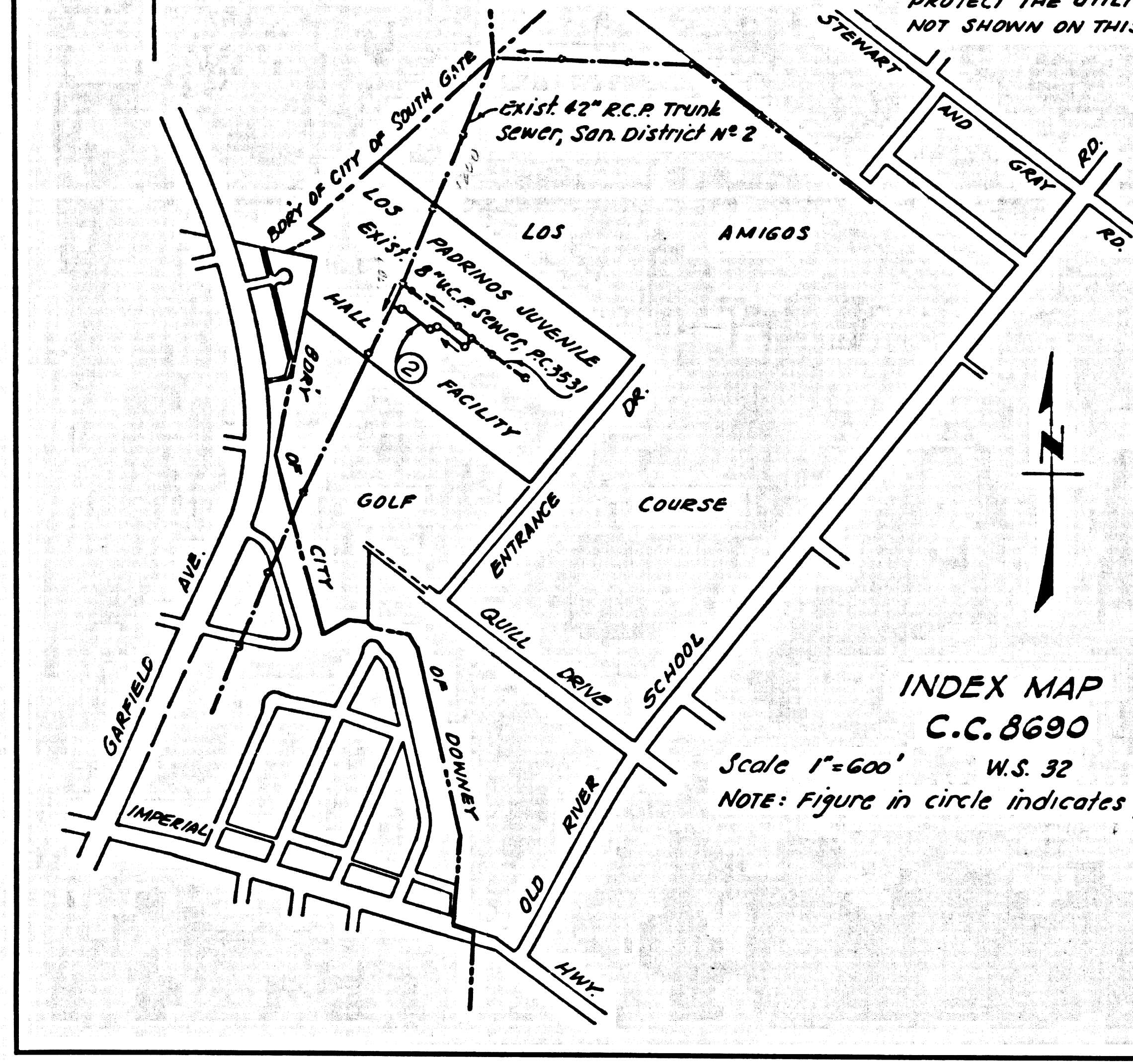

INDEX MAP
 C.C. 8690
 Scale 1"=600' W.S. 32 Th's 59, F-4
 Note: Figure in circle indicates page number. ②

NOTICE TO CONTRACTOR
 THE EXISTENCE AND LOCATION OF ANY UNDERGROUND UTILITY OR STRUCTURES SHOWN ON THESE PLANS ARE OBTAINED BY A SEARCH OF THE AVAILABLE RECORDS, TO THE BEST OF OUR KNOWLEDGE THERE ARE NO EXISTING UTILITIES EXCEPT AS NOTED ON THIS PLAN.

THE CONTRACTOR IS REQUIRED TO TAKE PRECAUTIONARY MEASURES TO PROTECT THE UTILITY LINES AND ANY OTHER LINES NOT OF RECORD OR NOT SHOWN ON THIS DRAWING.

1. PRIOR TO TRENCH EXCAVATION, THE CONTRACTOR SHALL SUBMIT TO AND OBTAIN APPROVAL FROM THE COUNTY ENGINEER OF A DETAILED PLAN SHOWING THE DESIGN OF SHORING, BRACING, SLOPING OR OTHER PROVISIONS FOR WORKER PROTECTION FROM THE HAZARD OF CAVING GROUND. IF SUCH PLAN VARIES FROM THE SHORING SYSTEM STANDARDS ESTABLISHED BY THE CONSTRUCTION SAFETY ORDERS, IT SHALL BE PREPARED BY A REGISTERED CIVIL OR STRUCTURAL ENGINEER.

County Sanitation Districts shall be notified prior to the following so that required inspection can be made (Phone 327-1025 or 838-1181)

Core Drilling District trunk sewer: Assistance of San project.

No connections for the disposal of industrial wastes shall be made to sewers shown on these drawings without written permission from the Chief Engineer and General Manager of the County Sanitation Districts.

GENERAL NOTES:

- REFER TO SECTION 7-10.4.1 OF STANDARD SPECIFICATIONS REGARDING SAFETY ORDERS.
 - ALL MANHOLES SHALL BE BUILT SINCE PER 8.4 OF PRECAST CONCRETE PER 8.10, EXCEPT AS NOTED.
 - "T" OR "Y" BRANCHES MAY BE USED FOR CONNECTIONS TO MAIN LINE SEWER, EXCEPT AS NOTED.
 - VERIFIED CLAY PIPE JOINTS SHALL BE TYPE "B", "C", OR "D" PER SECTION 306.2 OF STANDARD SPECIFICATIONS.
 - SEWERS TO BE TESTED FOR LEAKAGE PER SECTION 306.3.3.7 OF STANDARD SPECIFICATIONS AND SPECIAL PROVISIONS.
 - IF A POWER POLE IS WITHIN THREE FEET OF THE SEWER, THE SEWER SHALL BE ENCASED, PER 8.32 CASE II, TWO FEET ON EACH SIDE FROM THE POINT OF INTERFERENCE.
- STREET REPAIRS:**
- NO REVISIONS SHALL BE MADE IN THESE PLANS WITHOUT THE APPROVAL OF THE CO. ENGINEER.
- THE CONTRACTOR SHALL MAINTAIN SEWER SERVICE AT ALL TIMES DURING CONSTRUCTION OF MAIN LINE SEWER AND HOUSE LATERALS.
- ALL SEWER PIPES AND APPURTENANCES SHOWN WITH ***** SHALL BE ABANDONED IN ACCORDANCE WITH SECTION 306-3 OF STANDARD SPECIFICATIONS.
12. CONSTRUCT M.H.'S WITH TOPS SET 6 INCHES BELOW FINISHED SURFACE OVER SEWER.

THE FOLLOWING LATEST REVISED STANDARD PLANS ON FILE IN THE OFFICE OF COUNTY ENGINEER SHALL APPLY IN THE CONSTRUCTION OF THIS PROJECT:

LEGEND	5-1	CRADLING AND ENCASMENT	5-28
MINIMUM PUBLIC SAFETY REQUIREMENT	5-2	STANDARD WYE ON THE SUPPORT	5-26
ALLOWABLE TRENCH WIDTHS	5-3	ALLOWABLE TRENCH WIDTHS	5-33
MANHOLE STEP	5-17	LOCKING MANHOLE FRAME AND COVER	5-35
REINFORCED FOR SEWER PIPE	5-27	NON-REINFORCED RECYCLED CONCRETE MANHOLE	5-36
SPECIAL SUPPORT AND PROTECTION	5-29	TRAP MANHOLE BASE	5-39
		TRAP MANHOLE CASTING	5-48

13. THE CONTRACTOR SHALL NOTIFY THE MECHANICAL DEPARTMENT, MR. BOB JONES, BY TELEPHONE (213) 923-7721, EXT. 2033 AT LEAST 24 HOURS BEFORE STARTING ANY WORK ON THIS PROJECT TO ARRANGE FOR LOCATION OF ALL EXISTING UNDERGROUND SUBSTRUCTURES.

COUNTY CASH CONTRACT NO. 8690
 SANITARY SEWERS
 TO BE CONSTRUCTED BY
 LOS PADRINOS JUVENILE HALL
 EXPANSION PHASE II
 AND OTHER RIGHTS OF WAY

1 SHEET, 2 PAGES
 SCALE VERT. 1"=4'
 HORIZ. 1"=40'
 JANUARY 2, 1972

COUNTY OF LOS ANGELES, CALIFORNIA
 HARVEY T. BRANDT COUNTY ENGINEER

APPROVED *Richard W. Con* 2-2-72
 LAST DIVISION ENGINEER
 DESIGNED *John D. Parkhurst* 2-2-72
 B.C.E. NO. 18483

APPROVED *John D. Parkhurst*
 JOHN D. PARKHURST
 CHIEF ENGINEER OF COUNTY
 SANITATION DISTRICT NO. 22
 OFFICE ENGINEER

NOTES:
 WORK SHALL BE CONSTRUCTED ACCORDING TO THE STANDARD SPECIFICATIONS FOR PUBLIC WORKS CONSTRUCTION (1970 EDITION WITH 1971-72 SUPPLEMENTS) AND COUNTY ENGINEER SPECIAL PROVISIONS FOR THE CONSTRUCTION OF SANITARY SEWERS DATED APRIL 28, 1972 AND SHALL BE PROSECUTED ONLY IN THE PRESENCE OF THE COUNTY ENGINEER.
 THE CONTRACTOR SHALL NOTIFY THE CONSTRUCTION DIVISION BY TELEPHONE 497-6762, EXT. 8158 AT LEAST 24 HOURS BEFORE STARTING ANY WORK UNDER THIS CONTRACT.
 GRADES TO WHICH THIS IMPROVEMENT IS TO BE CONSTRUCTED ARE SHOWN ON PLANS AND PROFILES. GRADE POINTS FOR JOB GRADES TO WHICH THIS IMPROVEMENT IS TO BE CONSTRUCTED ARE SHOWN BY CIRCLES ON PROFILES. AT ALL POINTS BETWEEN DESIGNATED POINTS THE GRADE SHALL BE ESTABLISHED SO AS TO CONFORM TO A STRAIGHT LINE DRAWN BETWEEN SAID DESIGNATED POINTS.
 REVISIONS ARE IN PEE ABOVE U.S.C. & G.S., SEA LEVEL DATUM OF 1929.
 THIS DRAWING AND THE DATA HEREON ARE HEREBY MADE A PART OF THE SPECIFICATIONS.

LAYOUT	W. ESQUER	12-71	CHECKED	W. TEN	1-2-72
TRACED	W. ESQUER	12-71	MAINTENANCE		
P.T. 477-1-2			A.B.	W.S. 32	
			BUILDING DISTRICT NO.	407	

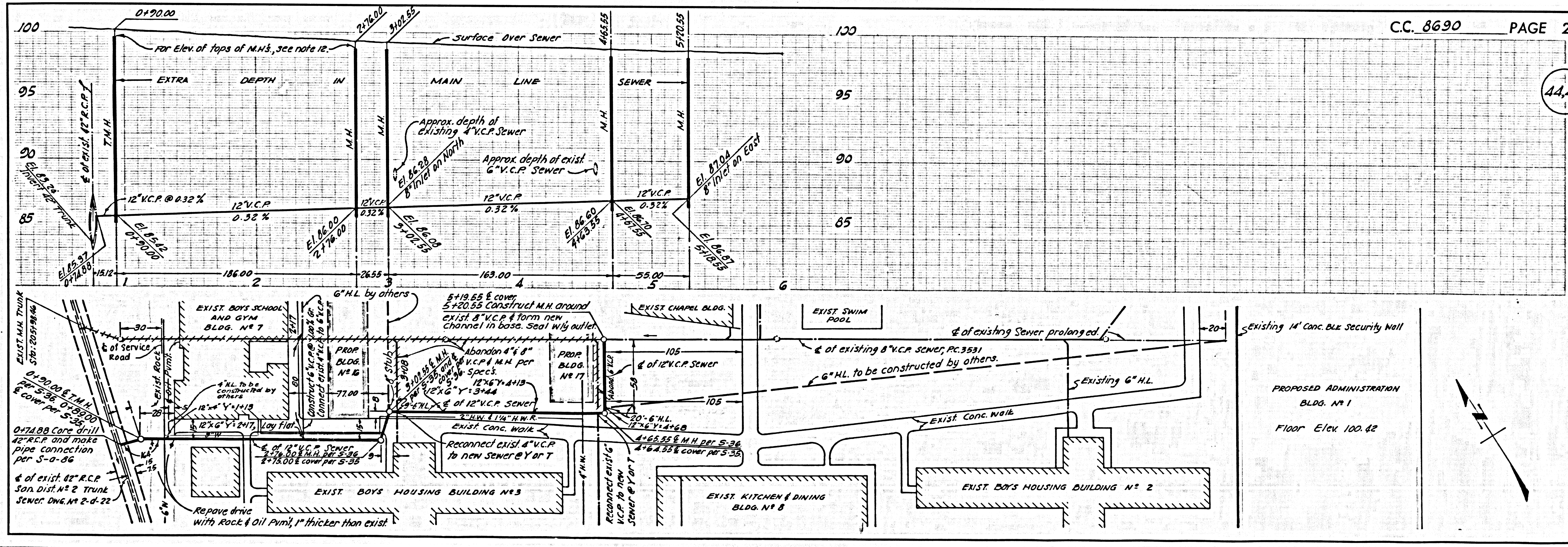

PROPOSED ADMINISTRATION
 BLDG. NO. 1
 Floor Elev. 100.82