

B.M. 81 3024 ELEV. 1247.577  
 L & T Conc. 1538 @ San Hills Savings  
 Bldg @ 28 W. Lyons Ave & Wheeler St  
 3074 E 8011 S & Mt.  
 MENHALL QUAD. 19 65

DOUBLE SCALE

NOTICE TO CONTRACTOR:  
 The existence and location of any underground pipes or structures shown on these plans were obtained by a search of available records. To the best of our knowledge, there are no existing utilities except as shown on these plans. The contractor is required to take precautionary measures to protect the existing utility lines and any lines not of record or not shown on these plans.

*E. L. Balaban Jr.*  
 E. L. Balaban Jr. P.C.E. 10533

Full compliance with Section 306-1.83 of the special provisions will be required for backfill in streets. Certification of backfill compaction and sand equivalents by a qualified, registered testing laboratory shall be provided by the permittee prior to the issuance of a certificate of partial acceptance.

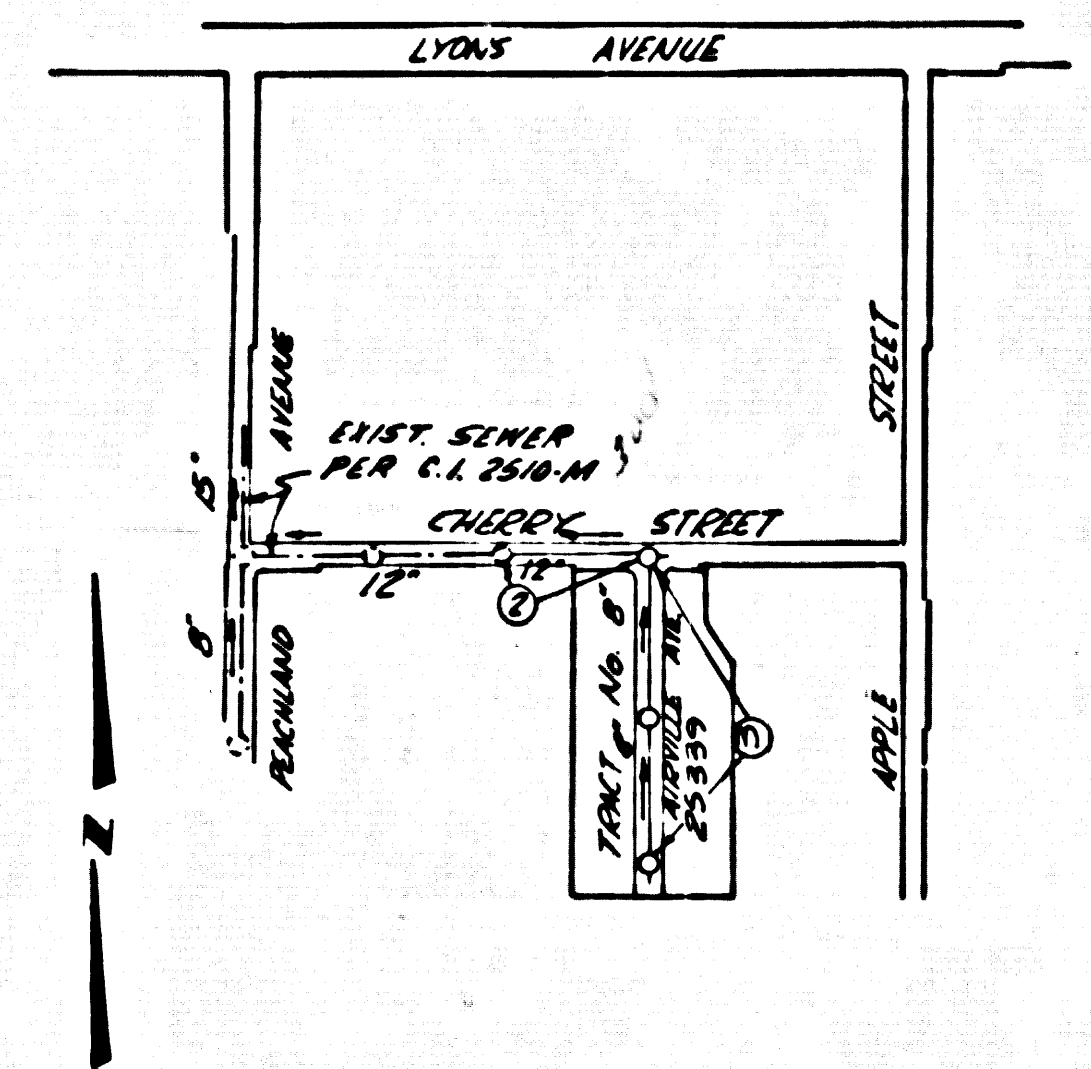

NUMBERS IN CIRCLES INDICATE PAGE NUMBER

INDEX MAP  
 P.C. 8713  
 TRACT NO. 25339  
 SCALE: 1"=50'

GENERAL NOTES:

- ELEVATIONS ARE IN FEET ABOVE U.S.C. & G.S. SEA LEVEL DATUM OF 1929.
  - NO REVISIONS SHALL BE MADE IN THESE PLANS WITHOUT THE APPROVAL OF THE COUNTY ENGINEER.
  - NO REPRESENTATIVE OF THE COUNTY ENGINEER WILL SURVEY OR LAY OUT ANY PORTION OF THE WORK.
  - GRADES TO WHICH THIS IMPROVEMENT IS TO BE CONSTRUCTED ARE SHOWN ON PLANS AND PROFILES. GRADE POINTS FOR TOP OF CURBS, CENTER LINE OF STREETS, OR CENTER LINE OF ALLEYS ARE SHOWN BY CIRCLES ON PROFILES AT ALL POINTS BETWEEN DESIGNATED POINTS. THE GRADE SHALL BE ESTABLISHED SO AS TO CONFORM TO A STRAIGHT LINE BETWEEN SAID DESIGNATED POINTS.
  - THE PRIVATE ENGINEER SHALL FURNISH THE COUNTY ENGINEER WITH GRADE SHEETS AND STATIONING FOR ALL HOUSE LATERALS AND "T" OR "Y" BRANCHES AND SHALL PROVIDE STAKES FOR THEM AT THEIR PROPER LOCATIONS WITH STATIONING. PRIVATE REPAIRS TO ALL HOUSE LATERALS SHALL BE CONSTRUCTED IN A STRAIGHT ALIGNMENT AT RIGHT ANGLES TO THE MAIN LINE SEWER MAIN LINE SEWER. ANY CHANGE IN ALIGNMENT SHALL BE REQUESTED IN WRITING BY THE PRIVATE ENGINEER.
  - THE PRIVATE ENGINEER SHALL FURNISH THE HOUSE LATERAL DEPTH AT THE PROPERTY LINE BELOW THE TOP OF CURB ELEVATION FOR EACH HOUSE LATERAL ON THE GRADE SHEET.
  - BEFORE WORK CAN BE STARTED, THE CONTRACTOR MUST OBTAIN A PERMIT TO EXCAVATE IN COUNTY STREETS FROM THE L.A. COUNTY ROAD DEPT., DISTRICT OFFICE NO. 5, AND PAY A FEE TO THE COUNTY ENGINEER, ROOM 19, BUREAU OF INDUSTRIAL, HIGHWAY & CONSTRUCTION INSPECTION AND RECORD PLANS.
  - IF WORK IS TO BE DONE IN A STATE HIGHWAY, A PERMIT MUST BE OBTAINED FROM THE STATE OF CALIFORNIA, DIVISION OF HIGHWAYS, 130 SOUTH SPRING STREET, LOS ANGELES, CALIFORNIA.
  - APPROVAL OF THIS PLAN BY THE COUNTY OF LOS ANGELES DOES NOT CONSTITUTE A REPRESENTATION AS TO THE ACCURACY OF THE LOCATION OR OF THE EXISTENCE OR NON-EXISTENCE OF ANY UNDERGROUND UTILITY PIPE, OR STRUCTURE WITHIN THE LIMITS OF THIS PROJECT. THIS NOTE APPLIES TO ALL PAGES.
  - REFER TO SECTION 7-18.41 OF THE STANDARD SPECIFICATIONS, REGARDING SAFETY ORDERS.
- County Sanitation Districts shall be notified prior to the following so that required inspections can be made (Phone 337-1025 - 838-1181)
- Acceptance of the project.

CONSTRUCTION NOTES:

- WORK SHALL BE CONSTRUCTED ACCORDING TO THE STANDARD SPECIFICATIONS FOR PUBLIC WORKS CONSTRUCTION 1979 EDITION WITH 1977 SUPPLEMENTS AND COUNTY ENGINEER SPECIAL PROVISIONS FOR THE CONSTRUCTION OF SANITARY SEWERS DATED APRIL 7, 1980 AND SHALL BE PROSECUTED ONLY IN THE PRESENCE OF THE COUNTY ENGINEER.
- THE CONTRACTOR SHALL NOTIFY THE CONSTRUCTION DIVISION BY TELEPHONE, IN UNION 9-4742, EXT. 8151, AT LEAST TWENTY-FOUR HOURS BEFORE STARTING ANY WORK UNDER THIS CONTRACT.
- HOUSE LATERALS TO BE CONSTRUCTED WITH INVERTS AT PROPERTY LINE 4 FEET BELOW CURB GRADE EXCEPT AS NOTED.
- WYE OR TEE BRANCHES MAY BE USED FOR CONNECTIONS TO MAINLINE SEWERS EXCEPT AS NOTED.
- ALL STRUCTURES SHALL BE EITHER BRICK MANHOLES PER S-3 OR PRECAST CONCRETE MANHOLES PER S-36, EXCEPT AS NOTED.
- PROVIDE STAKES ON THE PROPERTY LINE OR PROPERTY LINES PRODUCED AT RIGHT ANGLES TO THE SEWER LINE AT THE CENTER LINE OF EACH MANHOLE.
- MANHOLE TOPS IN UNIMPROVED RIGHTS OF WAY TO BE SIX INCHES ABOVE FINISHED GRADE.
- VERTIBIRD CLAY PIPE JOINTS SHALL BE TYPE "B", "P", OR "Q" PER STANDARD SPECIFICATIONS SECTION 306-3.
- IF A POWER POLE IS WITHIN THREE FEET OF THE SEWER, THE SEWER SHALL BE ENCASED, PER S-23, CASE II, TWO FEET ON EACH SIDE FROM THE POINT OF INTERFERENCE.
- IF DURING THE COURSE OF CONSTRUCTION IT IS DETERMINED THAT THERE IS LESS THAN FOUR FEET OF COVER OVER THE TOP OF A MAIN LINE OR HOUSE LATERAL V.C.P. SEWER WHICH IS NOT INDICATED ON THE PLANS, THE PIPE SHALL BE ENCASED PER S-23, CASE II UNLESS OTHERWISE APPROVED BY THE COUNTY ENGINEER.
- ALL JOINTS BETWEEN CAST IRON PIPE AND VERTIBIRD CLAY PIPE SHALL BE MADE WITH A RUBBER SLEEVE JOINT, TYPE "C" OR "D", WITH RUBBERING IF NECESSARY PER STANDARD SPECIFICATIONS, SECTION 306-2.
- SEWERS TO BE TESTED FOR LEAKAGE PER SECTION 306-2.2 OF THE STANDARD SPECIFICATIONS AND SPECIAL PROVISIONS.
- RESURFACE ALL TRENCHES WITHIN PAVED AREAS TO MEET L.A. COUNTY ROAD DEPT. OR CALIFORNIA STATE HIGHWAY REQUIREMENTS IN ACCORDANCE WITH PERMITS.

CONSTRUCTED IN  
**TRACT NO. 25339**  
**PRIVATE CONTRACT NO. 8713**

W.S. 62  
 2 SHEETS, 3 PAGES  
 SCALE: VERT. 1"=6'  
 HORIZ. 1"=40'  
 JANUARY, 1972  
 PREPARED IN THE OFFICES OF

**ANDEL ENGINEERING CO.** 43212  
 BY: *E. L. Balaban Jr.*  
 E. L. Balaban Jr. REG. C. E. NO. 10533

THE FOLLOWING LATEST REVISED STANDARD PLANS ON FILE IN THE OFFICE OF THE COUNTY ENGINEER SHALL APPLY IN THE CONSTRUCTION OF THIS PROJECT.

LEGEND	
MINIMUM PUBLIC SAFETY REQUIREMENTS	S-3
BRICK MANHOLES	S-3
STANDARD MANHOLE STEP	S-3
BEDDING FOR SEWER PIPE	S-17
CHAMBER AND INCAUSEMENT	S-20
WYE OR TEE SUPPORT	S-21
ALLOWABLE TRENCH WIDTHS	S-26
LOCKING MANHOLE FRAME AND COVER	S-28
NON-REINFORCED PRECAST CONCRETE MANHOLE	S-26
CHIMNEY PIPE AND BASE	S-27

COUNTY OF LOS ANGELES, CALIFORNIA  
 HARVEY T. BANDT, COUNTY ENGINEER  
 JOHN D. PARKHURST, CHIEF ENGINEER  
 APPROVED *John D. Parkhurst* 1/17/72  
 REGIONAL ENGINEER DATE APPROVED *Harvey T. Bandt*  
 OFFICE ENGINEER  
 CHECKED *Richard L. ...*  
 BLDG. C.E. NO. 14390  
 MENHALL BLDG. DIST. 8.2 J.N. 0250.02

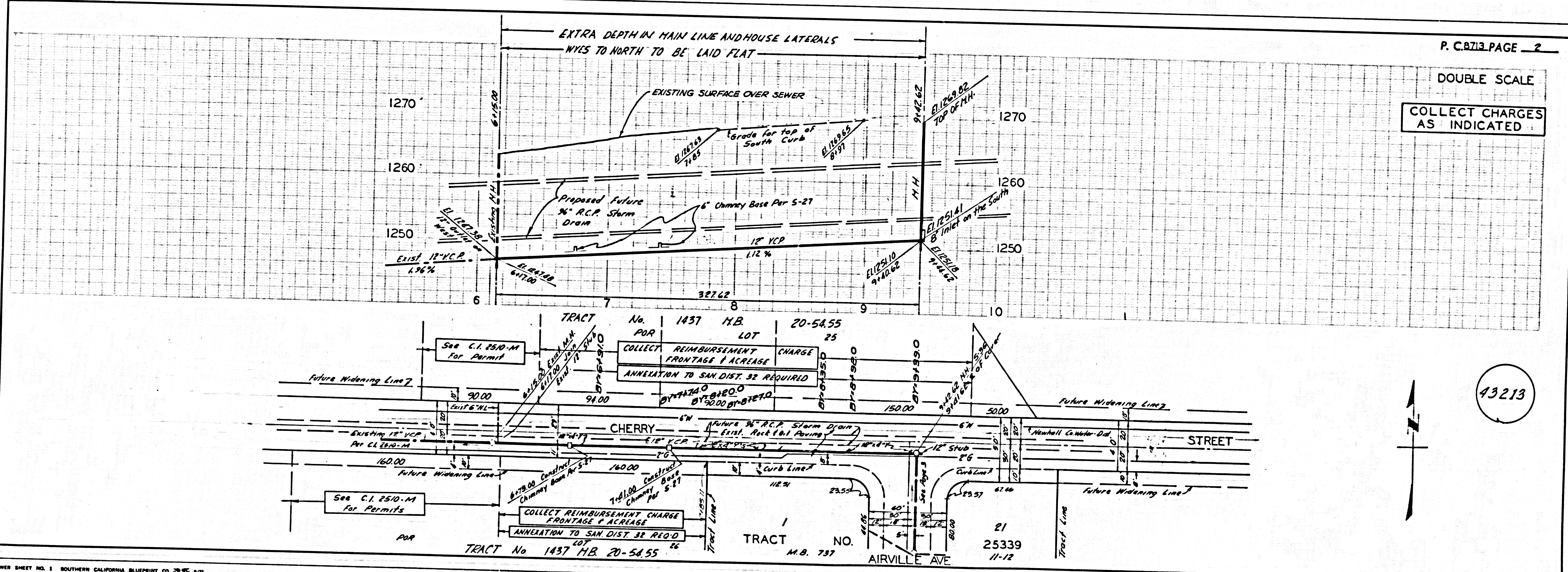

DOUBLE SCALE

COLLECT CHARGES AS INDICATED

43213

DOUBLE SCALE

NO CHARGE FOR CONNECTION

1270  
1260  
1250

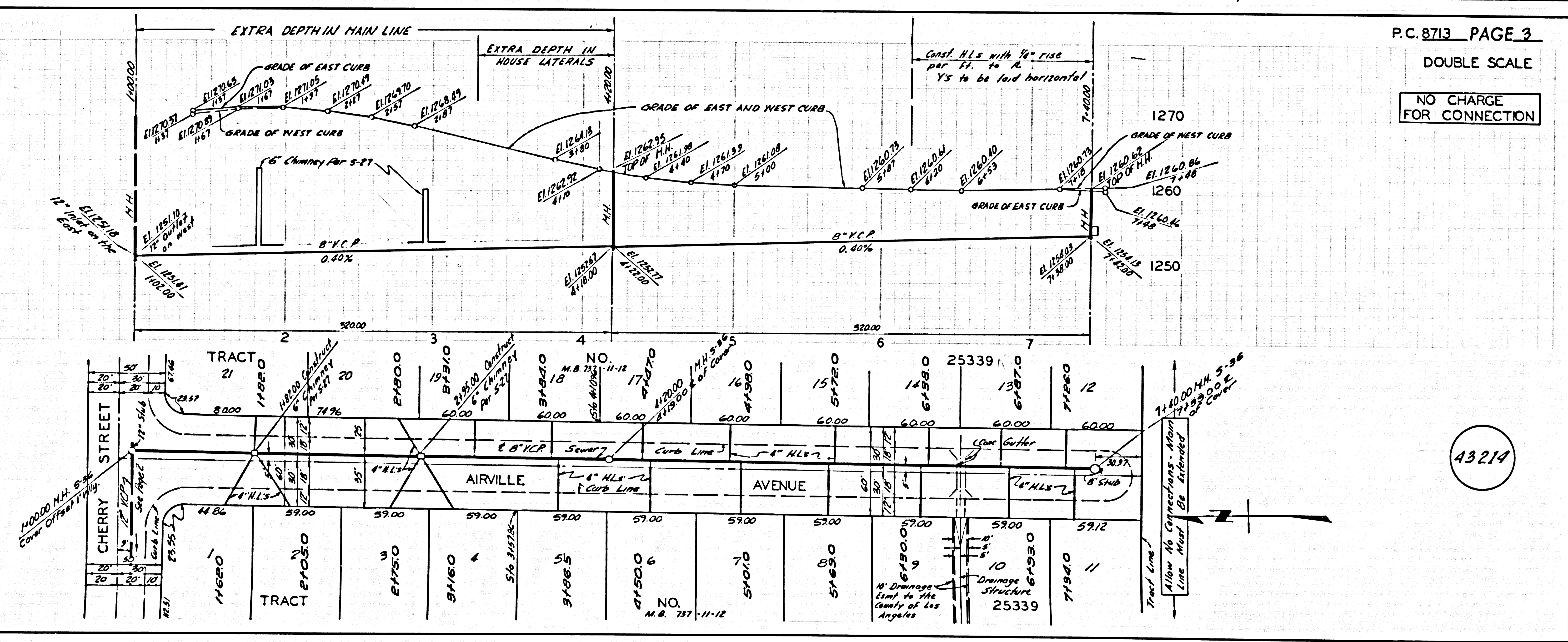

43214

Drainage Structure 25339  
10  
64330  
71940  
11

714000 MH 5-36  
Allow No Connections - Main Line Must Be Extended to Curb

140000 MH 5-36  
Curb Offset 1' 0"

NO. M.B. 737-11-12

NO. M.B. 737-11-12

NO. M.B. 737-11-12

NO. M.B. 737-11-12

NO. M.B. 737-11-12

NO. M.B. 737-11-12

TRACT 21

TRACT 20

TRACT 19

TRACT 18

TRACT 17

TRACT 16

TRACT 15

TRACT 14

TRACT 13

TRACT 12

CHERRY STREET

AIRVILLE AVENUE

714000 MH 5-36

Allow No Connections - Main Line Must Be Extended to Curb

714000 MH 5-36

Allow No Connections - Main Line Must Be Extended to Curb

714000 MH 5-36

Allow No Connections - Main Line Must Be Extended to Curb

714000 MH 5-36

Allow No Connections - Main Line Must Be Extended to Curb

140000 MH 5-36

Curb Offset 1' 0"

140000 MH 5-36

Curb Offset 1' 0"

140000 MH 5-36

Curb Offset 1' 0"

140000 MH 5-36

Curb Offset 1' 0"

140000 MH 5-36

Curb Offset 1' 0"

140000 MH 5-36

Curb Offset 1' 0"

140000 MH 5-36

Curb Offset 1' 0"

140000 MH 5-36

Curb Offset 1' 0"

140000 MH 5-36

Curb Offset 1' 0"

140000 MH 5-36

Curb Offset 1' 0"

140000 MH 5-36

Curb Offset 1' 0"

140000 MH 5-36

Curb Offset 1' 0"

140000 MH 5-36

Curb Offset 1' 0"

140000 MH 5-36

Curb Offset 1' 0"

140000 MH 5-36

Curb Offset 1' 0"

140000 MH 5-36

Curb Offset 1' 0"

140000 MH 5-36

Curb Offset 1' 0"

140000 MH 5-36

Curb Offset 1' 0"

140000 MH 5-36

Curb Offset 1' 0"

140000 MH 5-36

Curb Offset 1' 0"

140000 MH 5-36

Curb Offset 1' 0"

140000 MH 5-36

Curb Offset 1' 0"

140000 MH 5-36

Curb Offset 1' 0"

140000 MH 5-36

Curb Offset 1' 0"

140000 MH 5-36

Curb Offset 1' 0"

140000 MH 5-36

Curb Offset 1' 0"

140000 MH 5-36

Curb Offset 1' 0"

140000 MH 5-36

Curb Offset 1' 0"

140000 MH 5-36

Curb Offset 1' 0"

140000 MH 5-36

Curb Offset 1' 0"

140000 MH 5-36

Curb Offset 1' 0"

140000 MH 5-36

Curb Offset 1' 0"

140000 MH 5-36

Curb Offset 1' 0"

140000 MH 5-36

Curb Offset 1' 0"

140000 MH 5-36

Curb Offset 1' 0"

140000 MH 5-36

Curb Offset 1' 0"

140000 MH 5-36

Curb Offset 1' 0"

140000 MH 5-36

Curb Offset 1' 0"

140000 MH 5-36

Curb Offset 1' 0"

140000 MH 5-36

Curb Offset 1' 0"