

REVISION: July 12, 1973
 Changed Sewer Plan And Profile Elevations
 On Sheet No. 5, B. Sta. 0+00 To Sta. 3+25.73
 APPROVED *Sam H. Miller*
 Office of County Engineer

COLLECT CHARGES
 AS INDICATED

DOUBLE SCALE

- GENERAL NOTES:
1. ELEVATIONS ARE IN FEET ABOVE M.S.C. & U.S. SEA LEVEL DATUM OF 1929.
 2. NO IMPROVEMENTS SHALL BE MADE BY THIS PLAN WITHOUT THE APPROVAL OF THE COUNTY ENGINEER.
 3. NO REPRESENTATIVE OF THE COUNTY ENGINEER WILL SURVEY OR LAY OUT ANY PORTION OF THE WORK.
 4. GRADES TO WHICH THIS IMPROVEMENT IS TO BE CONSTRUCTED ARE SHOWN ON PLANS AND PROFILES. GRADE POINTS FOR TOP OF CURBS, CENTER LINE OF STREETS, OR CENTER LINE OF ALLEYS ARE SHOWN BY CIRCLES ON PROFILES. IF ALL POINTS BETWEEN DESIGNATED POINTS THE GRADE SHALL BE ESTABLISHED SO AS TO CONFORM TO A STRAIGHT LINE DRAWN BETWEEN SAID DESIGNATED POINTS.
 5. THE PRIVATE ENGINEER SHALL FURNISH THE COUNTY ENGINEER WITH GRADE SHEETS AND STATIONING FOR ALL HOUSE LATERALS AND "T" OR "Y" BRANCHES AND SHALL PROVIDE STAKES FOR THEM AT THEIR PROPER LOCATIONS WITH STATIONING PLAINLY DISPLAYED. ALL HOUSE LATERALS SHALL BE CONSTRUCTED IN A STRAIGHT ALIGNMENT AT RIGHT ANGLES FROM THE MAIN LINE SEWER EXCEPT AS SHOWN ON THE PLANS. HOUSE LATERALS FROM CHIMNEYS SHALL NOT HAVE AN ANGLE OF LESS THAN 45° WITH THE MAIN LINE SEWER. ANY CHANGE IN ALIGNMENT SHALL BE REQUESTED IN WRITING BY THE PRIVATE ENGINEER.
 6. THE PRIVATE ENGINEER SHALL FURNISH THE HOUSE LATERAL SEWER AT THE PROPERTY LINE SHOWING THE TOP OF CURB ELEVATION FOR EACH HOUSE LATERAL ON THE GRADE SHEET.
 7. BEFORE WORK CAN BE STARTED, THE CONTRACTOR MUST OBTAIN A PERMIT TO EXCAVATE IN COUNTY STREETS FROM THE L. & COUNTY ROAD DEPT., DISTRICT OFFICE NO. 2, AND PAY A FEE TO THE COUNTY ENGINEER, AT THE REGIONAL OFFICE, TO COVER THE COST OF CONSTRUCTION INSPECTION AND RECORD PLANS.
 8. NO WORK IS TO BE DONE ON A STATE HIGHWAY, A PERMIT MUST BE OBTAINED FROM THE STATE OF CALIFORNIA, DIVISION OF HIGHWAYS, THE SOBER SPRING STREET, LOS ANGELES, CALIFORNIA.
 9. APPROVAL OF THIS PLAN BY THE COUNTY OF LOS ANGELES DOES NOT CONSTITUTE A REPRESENTATION AS TO THE ACCURACY OF THE LOCATION OF OR THE EXISTENCE OR NON-EXISTENCE OF ANY UNDERGROUND UTILITY PIPE, OR STRUCTURE WITHIN THE LIMITS OF THIS PROJECT. THIS NOTE APPLIES TO ALL PAGES.
 10. REFER TO SECTION 18-6.1 OF THE STANDARD SPECIFICATIONS, REGARDING SAFETY CHARGES.

- CONSTRUCTION NOTES:
1. WORK SHALL BE CONSTRUCTED ACCORDING TO THE STANDARD SPECIFICATIONS FOR PUBLIC WORKS CONSTRUCTION (SPW) EDITION WITH 11-21-72 SUPPLEMENTS AND COUNTY ENGINEER SPECIAL PROVISIONS FOR THE CONSTRUCTION OF SANITARY SEWERS DATED 11-21-72. ALL SHALL BE PROSECUTED ONLY IN THE PRESENCE OF THE COUNTY ENGINEER.
 2. THE CONSTRUCTION SHALL BE UNDER THE SUPERVISION OF TELEPHONE, RAILROAD & AIR, ETC. 81881, AT LEAST TWENTY-FOUR HOURS BEFORE STARTING ANY WORK UNDER THIS CONTRACT.
 3. HOUSE LATERALS TO BE CONSTRUCTED WITH INVERTS AT PROPERTY LINE 4 FEET BELOW CURB GRADE EXCEPT AS NOTED.
 4. TYPE OF THE MANHOLES MAY BE USED FOR CONNECTIONS TO MANHOLES EXCEPT AS NOTED.
 5. ALL STRUCTURES SHALL BE EITHER BRICK MANHOLES PER 3-3 OR PRECAST CONCRETE MANHOLES PER 3-3.
 6. PROVIDE STAKES ON THE PROPERTY LINE OR PROPERTY LINE PRODUCE AT RIGHT ANGLES TO THE SEWER LINE AT THE CENTER LINE OF EACH MANHOLE.
 7. MANHOLES FOR IN MANHOLES POINTS OF WAY TO BE SIX INCHES ABOVE FINISHED GRADE.
 8. WITHIN CURB AND GUTTER SHALL BE TWO "12", "12", OR "18" PER STANDARD SPECIFICATIONS SECTION 308-2.
 9. IF A POWER POLE IS WITHIN THREE FEET OF THE SEWER, THE SEWER SHALL BE ENCASED, PER 3-3.3, CASE 2, TWO FEET ON EACH SIDE FROM THE POINT OF INTERFERENCE.
 10. IF DURING THE COURSE OF CONSTRUCTION IT IS DETERMINED THAT THERE IS LESS THAN FOUR FEET OF COVER OVER THE TOP OF A MAIN LINE OR HOUSE LATERAL V.C.P. SEWER WHICH IS NOT INDICATED ON THE PLANS, THE PIPE SHALL BE ENCASED PER 3-3.3, CASE 2, UNLESS OTHERWISE APPROVED BY THE COUNTY ENGINEER.
 11. ALL JOINTS BETWEEN CAST IRON PIPE AND VITRIFIED CLAY PIPE SHALL BE MADE WITH A RUBBER SLEEVE JOINT, TYPE "C" OR "D", WITH GASKETS AS NECESSARY PER STANDARD SPECIFICATIONS, SECTION 308-2.
 12. SEWERS TO BE AIR PRESSURE TESTED PER STANDARD SPECIFICATIONS PER SECTION 308-2.3.7.4 OF THE STANDARD SPECIFICATIONS & SPECIAL PROVISIONS.
 13. RESURFACE ALL TRENCHES WITHIN PAVED AREAS TO MEET L.A. COUNTY ROAD DEPT. OR CALIFORNIA STATE HIGHWAY REQUIREMENTS IN ACCORDANCE WITH PERMITS.
 14. ALL HOUSE LATERALS TO BE EXTENDING TO PROPERTY LINE 5 FEET OFF FROM LOT LINES EXCEPT AS NOTED.
 15. FULL COMPLIANCE WITH SECTION 304-1.2.3 OF THE SPECIAL PROVISIONS WILL BE REQUIRED FOR BACKFILL IN STREETS. CERTIFICATION OF BACKFILL COMPACTION AND SAND EQUIVALENTS BY A QUALIFIED, REGISTERED TESTING LABORATORY SHALL BE FURNISHED BY THE PERMITTEE FROM THE ISSUANCE OF A CERTIFICATE OF PARTIAL ACCEPTANCE.

PROFILE, ALIGNMENT AND GRADE OF
SANITARY SEWERS PAGE 1
 TO BE CONSTRUCTED IN

TRACT No 29258
PRIVATE CONTRACT NO. 8716

W.S. 60
 3 SHEETS, 6 PAGES

SCALE: VERT. 1"=4'
 HORIZ. 1"=40' JULY, 1972

PREPARED IN THE OFFICES OF
MOFFATT & NICHOL ENGINEERS
 350 WEST WASHINGTON ROAD, LOS ANGELES, CALIFORNIA
 213-774-3850
 BY: *Robert A. Nichol*
 REG. C. E. No. 2443

THE FOLLOWING LATEST REVISED STANDARD PLANS ON FILE IN THE OFFICE OF THE COUNTY ENGINEER SHALL APPLY IN THE CONSTRUCTION OF THIS PROJECT:

SECTION	NO.
MINIMUM PUBLIC SAFETY REQUIREMENTS	3-3
BRICK MANHOLES	3-3
STANDARD MANHOLE TOP	3-3
SEWERING FOR SEWER PIPE	3-3
CALLING AND INCLINATION	3-3
TYPE OF THE SUPPORT	3-3
ALLOWABLE TRENCH WIDTH	3-3
JOINTING MANHOLE FRAMES AND COVER	3-3
NON-REINFORCED PRECAST CONCRETE MANHOLES	3-3

COUNTY OF LOS ANGELES, CALIFORNIA
 HARVEY T. BRANDT, COUNTY ENGINEER LAS VIRGENES MUNICIPAL WATER DISTRICT

APPROVED *Sam H. Miller* 1/18/73 APPROVED *W. H. ...*
 REGIONAL ENGINEER SEWER, SANITARY & WATER DIVISION

CHECKED *John ...* 1/18/73
 REG. C. E. No. 1722

CALABASAS BLDG. DIST. 9.1 J.N. 0250.02

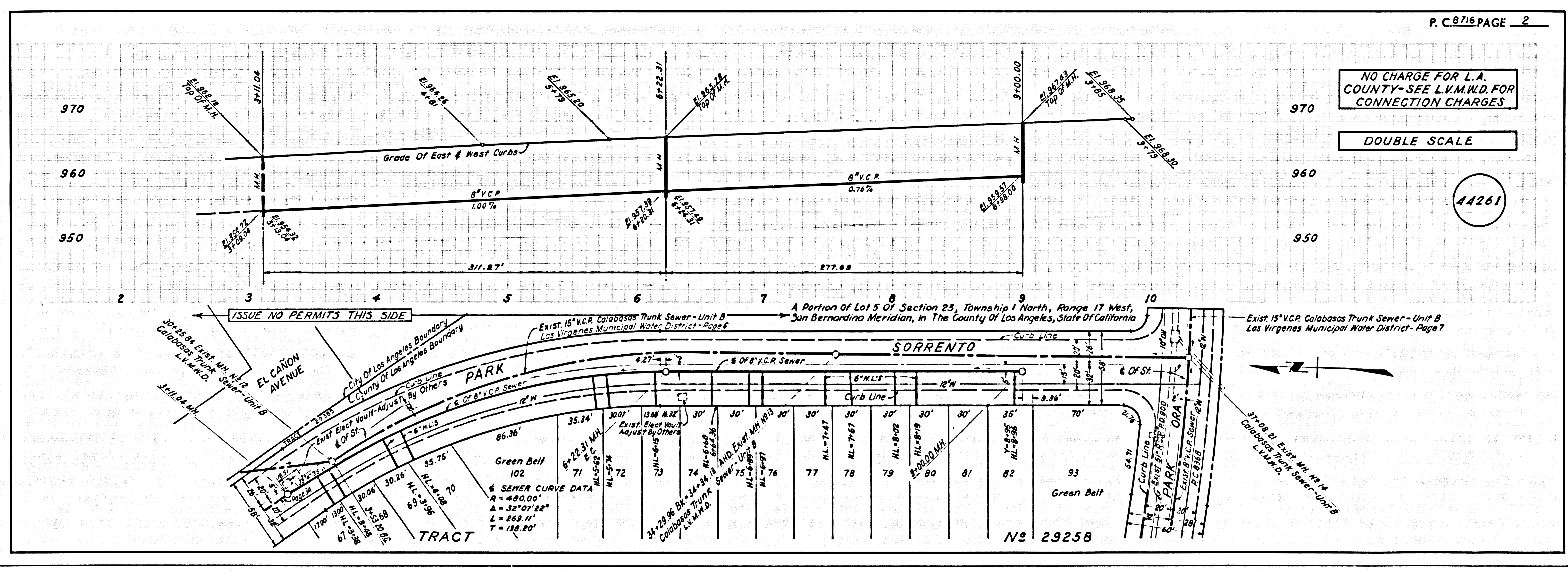

NO CHARGE FOR L.A. COUNTY-SEE L.V.M.W.D. FOR CONNECTION CHARGES

DOUBLE SCALE

44261

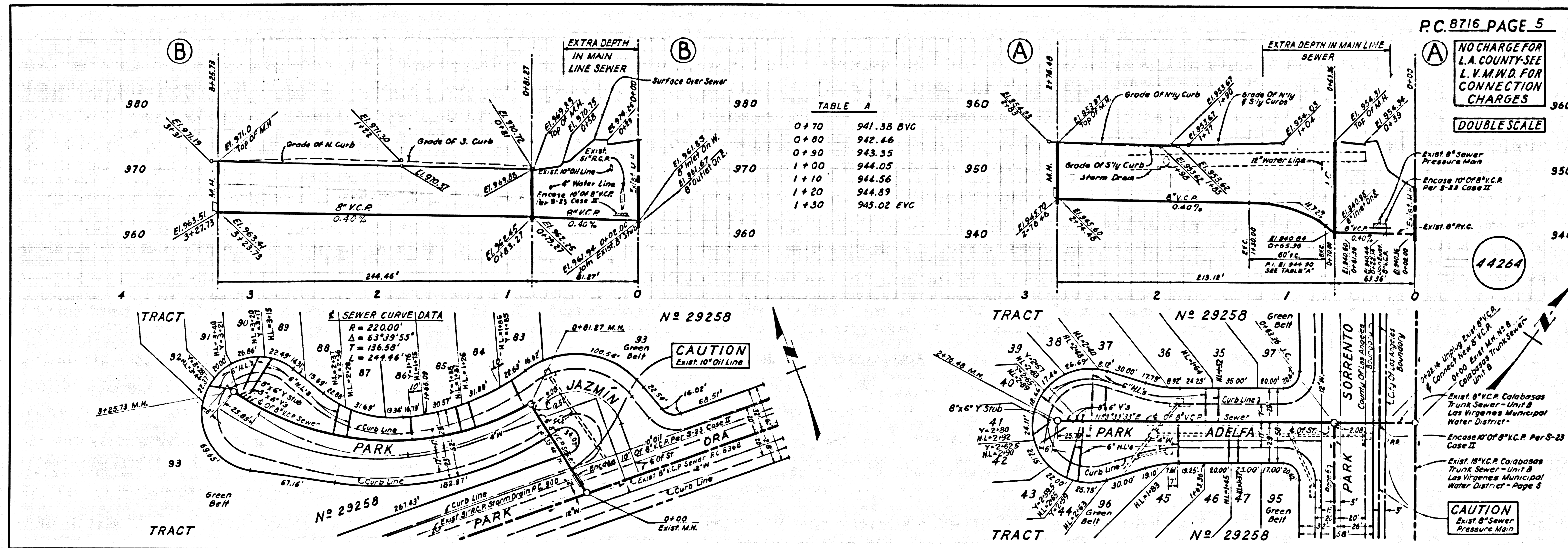

TABLE A

0+70	941.38 BVC
0+80	942.46
0+90	943.35
1+00	944.05
1+10	944.56
1+20	944.89
1+30	945.02 EVC

P.C. 8716 PAGE 5
 NO CHARGE FOR L.A. COUNTY-SEE L.V.M.W.D. FOR CONNECTION CHARGES
 DOUBLE SCALE
 44264

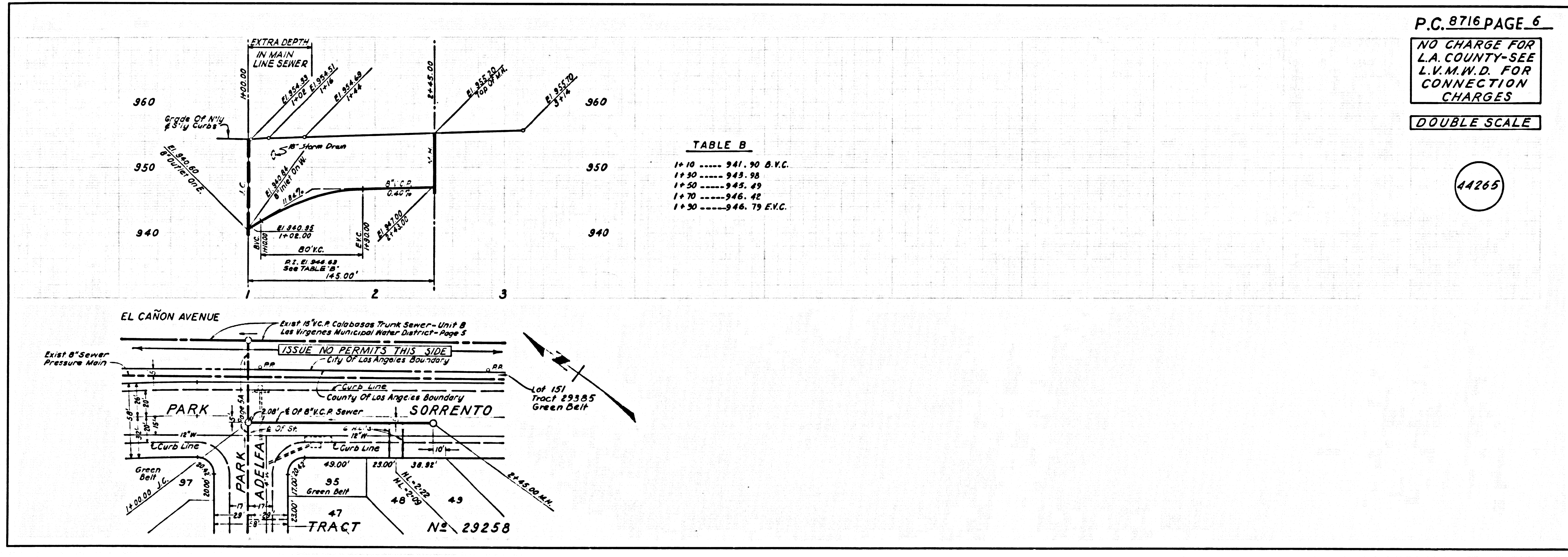

TABLE B

1+10	941.90 B.V.C.
1+30	943.98
1+50	945.49
1+70	946.42
1+90	946.79 E.V.C.

P.C. 8716 PAGE 6
 NO CHARGE FOR L.A. COUNTY-SEE L.V.M.W.D. FOR CONNECTION CHARGES
 DOUBLE SCALE
 44265