

B.M. BG. 3874 ELEV. 607.212

R.D.B.M. TAG IN C.B. 146 FT. N + 23 FT. W 4 INT. LA CUERVA DR. + PATHFINDER RD.

OTTERBEIN QUAD. 1970

PRIVATE ENGINEERS NOTICE TO CONTRACTOR

THE EXISTENCE AND APPROXIMATE LOCATION OF UNDERGROUND UTILITIES OR STRUCTURES SHOWN ON THESE PLANS WERE DETERMINED BY A SEARCH OF THE AVAILABLE PUBLIC RECORDS...

Robert R. Flores R.C.E. 11849 DATE.

GENERAL NOTES:

- 1. ELEVATIONS ARE IN FEET ABOVE U.S.C. & G.S. SEA LEVEL DATUM OF 1929.
2. NO REVISIONS SHALL BE MADE IN THESE PLANS WITHOUT THE APPROVAL OF THE COUNTY ENGINEER.
3. NO REPRESENTATIVE OF THE COUNTY ENGINEER WILL SURVEY OR LAY OUT ANY PORTION OF THE WORK.

TRACT No. 30179 PRIVATE CONTRACT NO. 8729

W.S. 38-05 SHEET 1 OF 2 PAGES MARCH, 1972 KEMMERER ENG. CO. INC. 6705 S. PAINTER AVE. WHITTIER, CAL. 43589

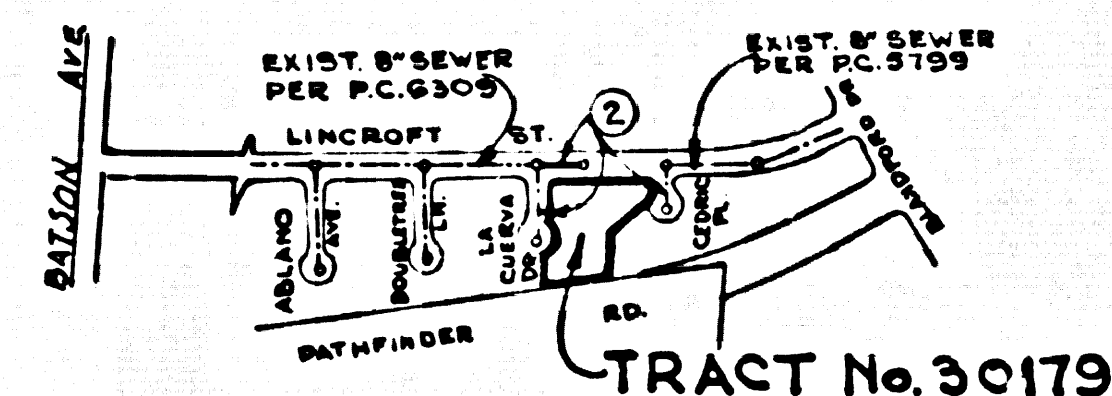

PC 8729 INDEX MAP SCALE: 1"=600'

CONSTRUCTION NOTES:

- 1. WORK SHALL BE CONSTRUCTED ACCORDING TO THE STANDARD SPECIFICATIONS FOR PUBLIC WORKS CONSTRUCTION 1970 EDITION WITH 1972 SUPPLEMENTS AND COUNTY ENGINEER SPECIAL PROVISIONS FOR THE CONSTRUCTION OF SANITARY SEWERS DATED APRIL 10, 1974.
2. THE CONTRACTOR SHALL NOTIFY THE CONSTRUCTION DIVISION BY TELEPHONE, MADISON 9-6700, EXT. 81581, AT LEAST TWENTY-FOUR HOURS BEFORE STARTING ANY WORK UNDER THE CONTRACT.

Table listing standard specifications for sanitary sewers, including items like Manhole, Standard Manhole Step, and Curb and Encasement, with corresponding page numbers.

COUNTY OF LOS ANGELES, CALIFORNIA HARVEY T. BRANDT COUNTY ENGINEER JOHN D. PARKHURST, CHIEF ENGINEER APPROVED: [Signatures] CHECKED: [Signature] DATE: 12/16/72 REG. C.E. NO. 19156

