

B.M. BL 3024 ELEV. 1241.577
 L.V. CONC. RISER @ FOX HILLS SWINGS
 BLDG @ S.E. CORNER LYONS AVE. &
 WHEELER RD 30 FT. E. # 80177.5 & INT.
 NEWHALL QUAD. 19 65

NOTICE TO CONTRACTOR
 THE EXISTENCE AND LOCATION OF
 ANY UNDERGROUND UTILITY PIPES
 SHOWN ON THESE PLANS ARE OBTAINED
 BY A SEARCH OF THE AVAILABLE RECORDS.
 TO THE BEST OF MY KNOWLEDGE, THERE
 ARE NO EXISTING UTILITIES EXCEPT AS
 SHOWN ON THESE PLANS.
 THE CONTRACTOR IS REQUIRED TO
 TAKE ALL PRECAUTIONARY MEASURES
 TO PROTECT THE UTILITY LINES SHOWN
 AND ANY OTHER LINES NOT OF RECORD
 OR NOT SHOWN ON THESE PLANS.
E. J. Bolden
 E.L. BOLDEN JR. R.C.E. 10533

GENERAL NOTES:

1. REVISIONS ARE IN PART ABOVE U.S.C. & G.S. SEA LEVEL DATUM OF 1929.
2. NO REVISIONS SHALL BE MADE IN THESE PLANS WITHOUT THE APPROVAL OF THE COUNTY ENGINEER.
3. NO IMPROVEMENTS OF THE COUNTY ENGINEER WILL BE MADE OR LAY OUT ANY PORTION OF THE WORK.
4. GRADES TO WHICH THE IMPROVEMENT IS TO BE CONSTRUCTED ARE SHOWN ON THESE PLANS. GRADE POINTS FOR TOP OF CURB, CENTER LINE OF STREET, OR CENTER LINE OF ALLEY ARE SHOWN BY CIRCLES ON PROFILES. AT ALL POINTS BETWEEN DESIGNATED POINTS THE GRADE SHALL BE ESTABLISHED SO AS TO CONFORM TO A STRAIGHT LINE DRAWN BETWEEN SAID DESIGNATED POINTS.
5. THE PRIVATE ENGINEER SHALL FURNISH THE COUNTY ENGINEER WITH GRADE SHEETS AND STATIONING FOR ALL HOUSE LATERALS AND "T" OR "Y" BRANCHES AND SHALL PROVIDE STAKES FOR THEM AT THEIR PROPER LOCATIONS WITH STATIONING PLAINLY MARKED. ALL HOUSE LATERALS SHALL BE CONSTRUCTED IN A STRAIGHT ALIGNMENT AT RIGHT ANGLES FROM THE MAIN LINE SEWER EXCEPT AS SHOWN ON THE PLANS. HOUSE LATERALS FROM CHIMNEYS SHALL NOT HAVE AN ANGLE OF LESS THAN 45° WITH THE MAIN LINE SEWER. ANY CHANGE IN ALIGNMENT SHALL BE REQUESTED IN WRITING BY THE PRIVATE ENGINEER.
6. THE PRIVATE ENGINEER SHALL NUMBER THE HOUSE LATERAL BOWNS AT THE PROPERTY LINE BELOW THE TOP OF CURB ELEVATION FOR EACH HOUSE LATERAL ON THE GRADE SHEET.
7. BEFORE WORK CAN BE STARTED, THE CONTRACTOR MUST OBTAIN A PERMIT TO EXCAVATE IN COUNTY STREETS FROM THE L. & COUNTY ROAD DEPT., DISTRICT OFFICE NO. _____ AND PAY A FEE TO THE COUNTY ENGINEER, ROOM # _____ COUNTY ENGINEERING BLDG., 300 S. NEWHALL ST., LOS ANGELES, CALIFORNIA.
8. IF WORK IS TO BE DONE IN A STATE HIGHWAY, A PERMIT MUST BE OBTAINED FROM THE STATE OF CALIFORNIA, DIVISION OF HIGHWAYS, 120 SOUTH SPRING STREET, LOS ANGELES, CALIFORNIA.
9. APPROVAL OF THIS PLAN BY THE COUNTY OF LOS ANGELES DOES NOT CONSTITUTE A REPRESENTATION AS TO THE ACCURACY OF THE LOCATION OF OR THE EXISTENCE OR NON-EXISTENCE OF ANY UNDERGROUND UTILITY PIPE, OR STRUCTURE WITHIN THE LIMITS OF THIS PROJECT. THIS NOTE APPLIES TO ALL PAGES.
10. REFER TO SECTION 7-38.41 OF THE STANDARD SPECIFICATIONS REGARDING SAFETY ORDERS.

County Sanitation District shall be notified prior to the following work that required inspection can be made (Phone 337-1023 or 638-1181)

No objections for the disposal of industrial waste shall be made to sewers shown on these drawings without written permission from the Chief Engineer and District Manager of the County Sanitation Districts.

Acceptance of the project.

PROFILE, ALIGNMENT AND GRADE OF
SANITARY SEWERS PAGE 1

CONSTRUCTED IN
VERMONT DRIVE (PVT. ST.)
 PRIVATE CONTRACT NO. 8767

INDEX ENG 5181
 W.S. 62
 1 SHEET, 2 PAGES
 SCALE: VERT. 1" = 4'
 HORIZ. 1" = 40'
 JUNE, 1972
 PREPARED IN THE OFFICES OF
ANDEL ENGINEERING CO.
 BY: *E. J. Bolden*
 REG. C. E. No. 10333

43370

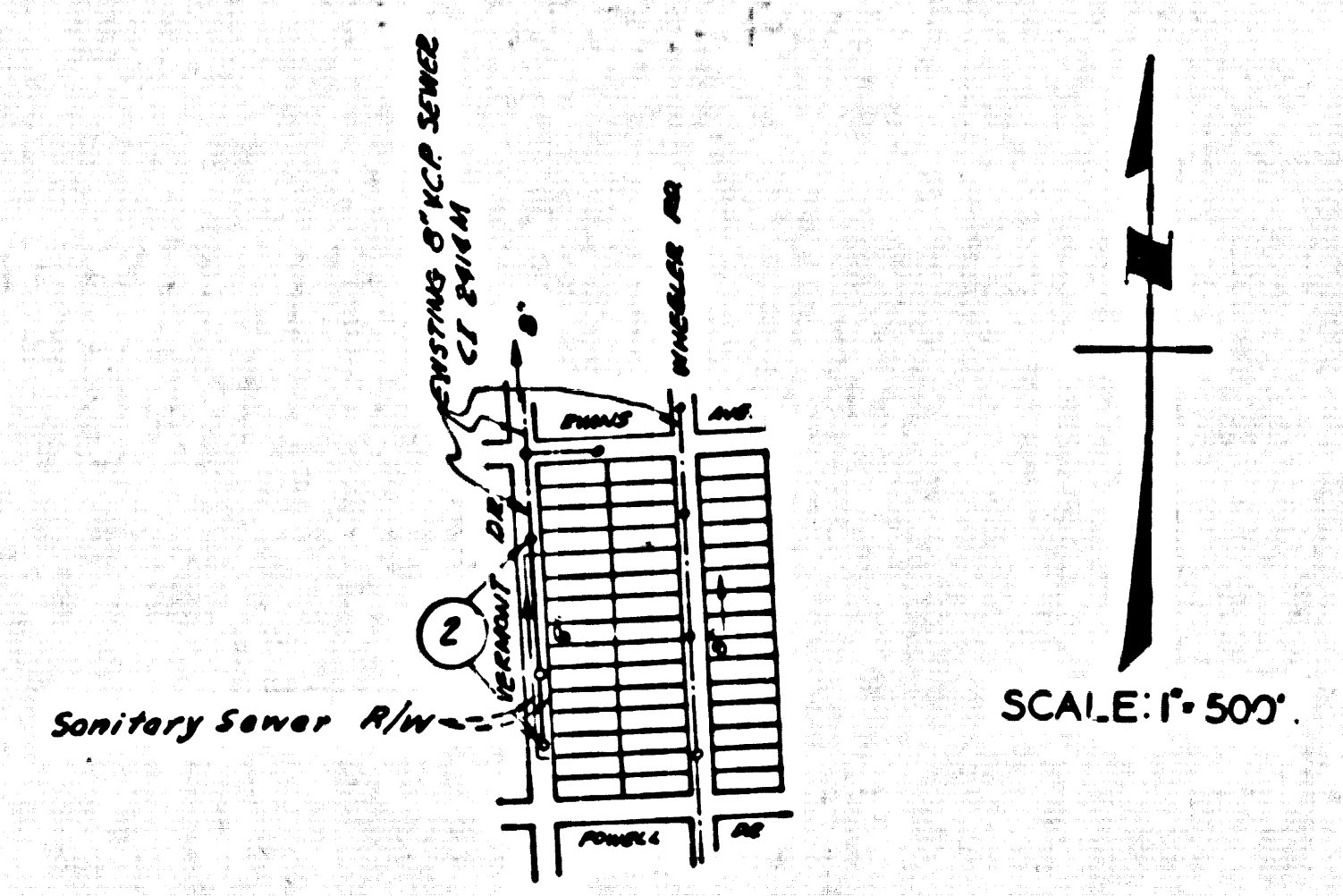

NUMBERS IN CIRCLES INDICATE PAGE NUMBER
INDEX MAP
 P.C. 8767

THE FOLLOWING LATEST REVISED STANDARD PLANS ON FILE IN THE OFFICE OF THE COUNTY ENGINEER SHALL APPLY IN THE CONSTRUCTION OF THIS PROJECT.

LOGSHP	6-1
MINIMUM PUBLIC SAFETY REQUIREMENTS	6-2
BRICK MANHOLE	6-3
STANDARD MANHOLE SET	6-4
BEDDING FOR SEWER PIPE	6-5
CRACKING AND ENCASEMENT	6-6
WYE OR T SUPPORT	6-7
ALLOWABLE TRENCH WIDTH	6-8
EDGEING MANHOLE FRAMES AND COVERS	6-9
NON-BROWNS PRECAST CONCRETE MANHOLE	6-10

COUNTY OF LOS ANGELES, CALIFORNIA
 HARVEY T. BRANDT COUNTY ENGINEER
 JOHN D. PARKURST, CHIEF ENGINEER
 APPROVED: *Edy Williams* REGIONAL ENGINEER
 APPROVED: *J. Parkurst* OFFICE ENGINEER
 CHECKED: *Mike Duke* 7-17-71
 REG. C.E. NO. 9906
 NEWHALL BLDG. DIST. 6.2
 J N 0371.51

CONSTRUCTION NOTES:

1. WORK SHALL BE CONSTRUCTED ACCORDING TO THE STANDARD SPECIFICATIONS FOR PUBLIC WORKS CONSTRUCTION 1970 EDITION WITH THE SUPPLEMENTS AND COUNTY ENGINEER SPECIAL PROVISIONS FOR THE CONSTRUCTION OF SANITARY SEWERS DATED APRIL 14, 1971.
2. THE CONTRACTOR SHALL NOTIFY THE CONSTRUCTION DIVISION BY TELEPHONE, HADISON 9-4747, EXT. 81581, AT LEAST TWENTY-FOUR HOURS BEFORE STARTING ANY WORK UNDER THIS CONTRACT.
3. HOUSE LATERALS TO BE CONSTRUCTED WITH INVERTS AT PROPERTY LINE 4 FEET BELOW 1/8" FINISH GRADE EXCEPT AS NOTED.
4. WYE OR T BRANCHES MAY BE USED FOR CONNECTIONS TO MAINLINE SEWERS EXCEPT AS NOTED.
5. ALL STRUCTURES SHALL BE EITHER BRICK MANHOLES PER 6-3 OR PRECAST CONCRETE MANHOLES PER 6-3, EXCEPT AS NOTED.
6. PROVIDE STAKES ON THE PROPERTY LINE OR PROPERTY LINES PRODUCED AT RIGHT ANGLES TO THE SEWER LINE AT THE CENTER LINE OF EACH MANHOLE.
7. MANHOLE TOPS IN UNIMPROVED RIGHTS OF WAY TO BE LEVEL WITH FINISHED GRADE.
8. VITRIFIED CLAY PIPE JOINTS SHALL BE TYPE "B", "F", OR "G" PER STANDARD SPECIFICATIONS SECTION 308-3.
9. IF A SEWER POLE IS WITHIN THREE FEET OF THE SEWER, THE SEWER SHALL BE ENCASED, PER S-23, CASE 2, TWO FEET ON EACH SIDE FROM THE POINT OF INTERFERENCE.
10. IF DURING THE COURSE OF CONSTRUCTION IT IS DETERMINED THAT THERE IS LESS THAN FOUR FEET OF COVER OVER THE TOP OF A MAIN LINE OR HOUSE LATERAL C.P. SEWER WHICH IS NOT INDICATED ON THE PLANS, THE PIPE SHALL BE ENCASED PER S-23, CASE 2, UNLESS OTHERWISE APPROVED BY THE COUNTY ENGINEER.
11. ALL JOINTS BETWEEN CAST IRON PIPE AND VITRIFIED CLAY PIPE SHALL BE MADE WITH A RUBBER SLEEVE JOINT, TYPE "C" OR "D", WITH BURNING IF NECESSARY PER STANDARD SPECIFICATIONS, SECTION 308-3.
12. SEWERS TO BE TESTED FOR LEAKAGE PER SECTION 206.237 OF THE STANDARD SPECIFICATIONS AND SPECIAL PROVISIONS.
13. RESURFACE ALL TRENCHES WITHIN PAVED AREAS TO MEET L.A. COUNTY ROAD DEPT. OR CALIFORNIA STATE HIGHWAY REQUIREMENTS IN ACCORDANCE WITH PERMITS.
14. SPECIAL BACKFILL IN DESAMATED AREA:
 (A) BACKFILL TRENCH AND REPLACE OTHER EARTH REMOVED SO AS TO ACHIEVE THE ORIGINAL OR FINISHED GRADES AND SLOPE SHOWN ON THE SEWER PLAN.
 (B) ALL BACKFILL AND EARTH REPLACED SHALL BE COMPACTED TO A MINIMUM OF 90% MAXIMUM DENSITY PER ASTM STANDARD METHOD OF TEST D-1557-71 AS INDICATED.
 ACCEPTABLE CERTIFICATION OF SUCH COMPACTON SHALL BE SUBMITTED TO THE DISTRICT DIVISION.

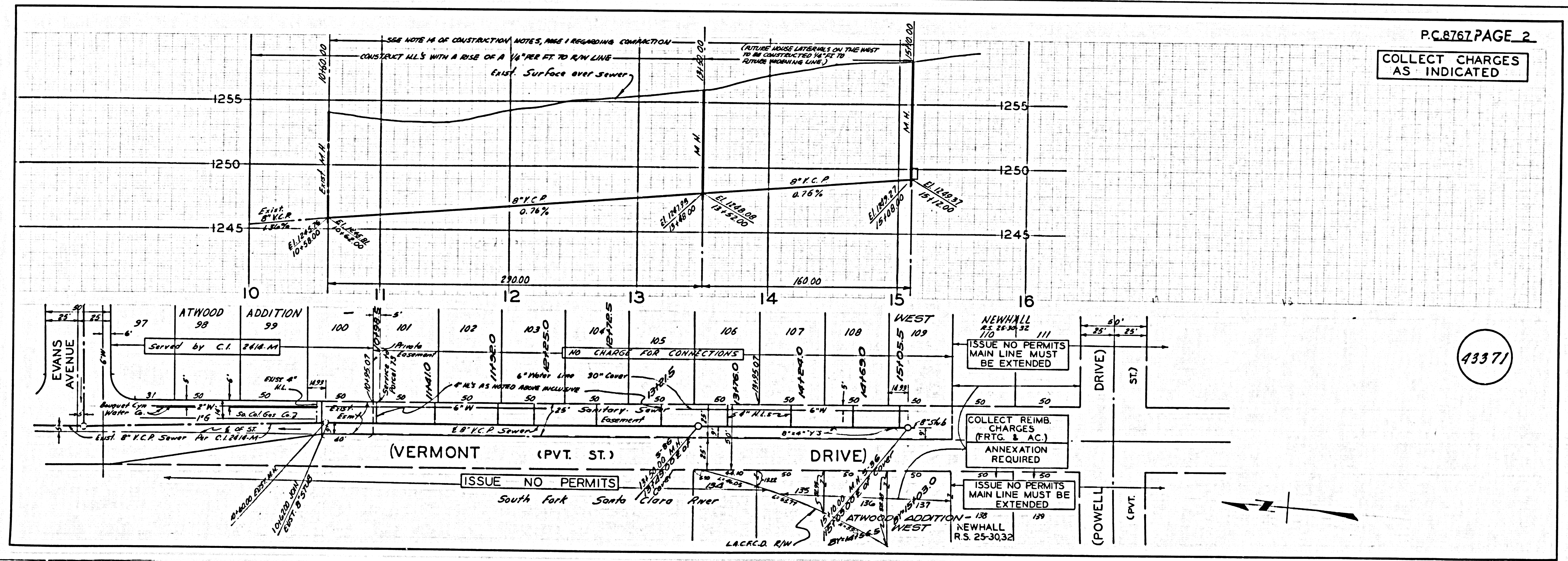

P.C. 8767 PAGE 2
 COLLECT CHARGES
 AS INDICATED

43371