

B.M. B.L. NO. 65 ELEV. 2391.642  
 U.S. MON. IN WALL @ INT. OF  
 AVENUE "J" AND 5<sup>TH</sup> STREET EAST  
 MKD. (T.M. 12.12 W. 1/4 COR. 14-23  
 EAST EDGE  
 LANCASTER QUAD. 19 62

# LANCASTER BLDG. DIST. NO. 8

PROFILE ALIGNMENT AND GRADE OF **P.C. 8782**  
**SANITARY SEWERS PAGE 1**

CONSTRUCTED IN  
**WOODINGTON AVENUE**  
**PRIVATE CONTRACT NO. 8782**

W.S. 70  
 1 SHEETS, 2 PAGES  
 SCALE: VERT. 1" = 4' HORIZ. 1" = 40'  
 JUN 1972  
 PREPARED IN THE OFFICES OF  
**CONSOLIDATED ENGINEERING CO.**  
 8895 W. OLYMPIC BLVD., BEVERLY HILLS, CALIFORNIA  
 REG. C. E. NO. 1223

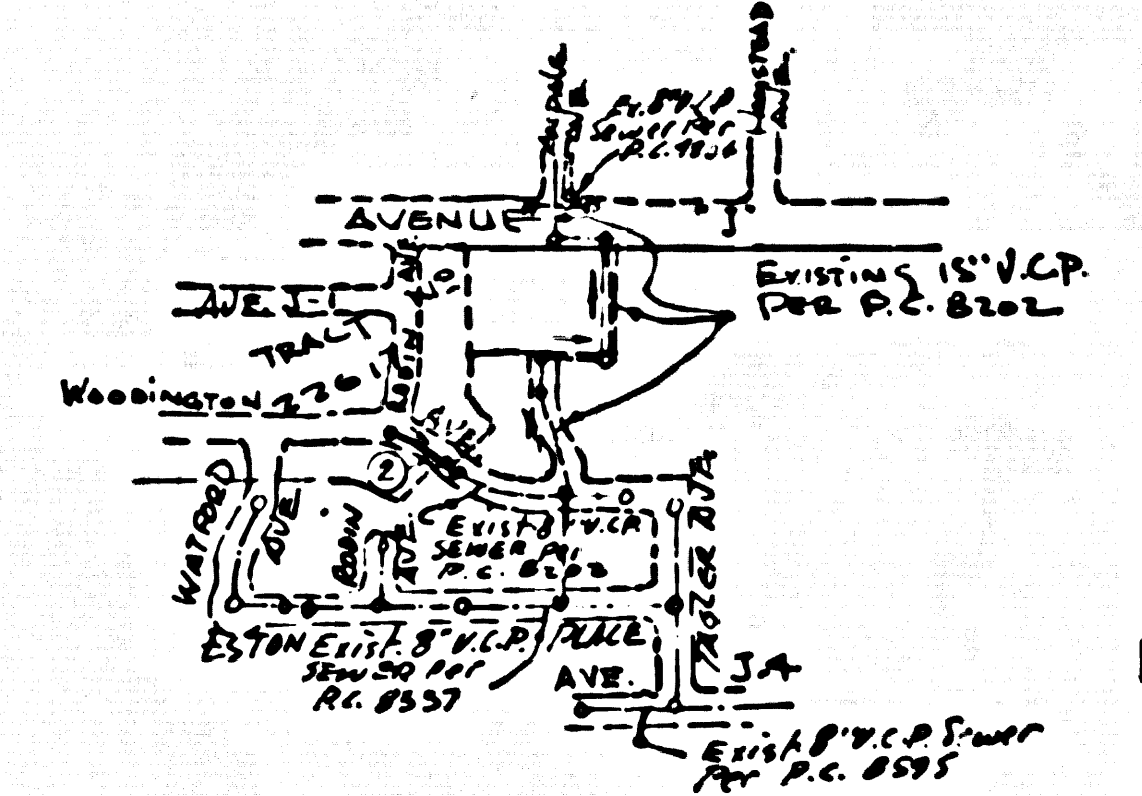

INDEX MAP  
 SCALE: 1" = 600'  
 P.C. 8782

REVISION: OCTOBER 13, 1971  
 MOVED UPPER M.H. FROM STATION  
 4+27.52 TO STA. 4+34.05.  
 SHOWED LATERAL SERVING LOT 29  
 APPROVED *R.L. Kopchy 10/14/71*  
 CHIEF OF DIVISION OF SANITATION

County Sanitation District shall be notified prior to the following so that required inspection can be made (Phone 337-1025 or 638-1101)

Acceptance of the project.  
 No connections for the disposal of industrial wastes shall be made to sewers shown on these drawings without written permission from the Chief Engineer and General Manager of the County Sanitation Districts.

- NOTES:
- PROVIDE STAKES ON THE PROPERTY LINE OR PROPERTY LINES PRODUCED AT RIGHT ANGLES TO THE SEWER LINE AT THE CENTER LINE OF EACH MANHOLE.
  - NO REPRESENTATIVE OF THE COUNTY ENGINEER WILL SURVEY OR LAY OUT ANY PORTION OF THE WORK.
  - THE PRIVATE ENGINEER SHALL FURNISH THE COUNTY ENGINEER WITH GRADE SHEETS AND STATIONING FOR ALL HOUSE LATERALS AND "Y" BRANCHES AND SHALL PROVIDE STAKES FOR THEM AT THEIR PROPER LOCATIONS WITH STATIONING PLAINLY MARKED. ALL HOUSE LATERALS SHALL BE CONSTRUCTED IN A STRAIGHT ALIGNMENT AT RIGHT ANGLES FROM THE MAIN LINE SEWER EXCEPT AS SHOWN ON THE PLANS. HOUSE LATERALS FROM CHIMNEYS SHALL NOT HAVE AN ANGLE OF LESS THAN 45° WITH THE MAIN LINE SEWER. ANY CHANGE IN ALIGNMENT SHALL BE ACQUIRED BY WRITING BY THE PRIVATE ENGINEER.
  - THE PRIVATE ENGINEER SHALL FURNISH THE HOUSE LATERAL DEPTH AT THE PROPERTY LINE SHOW THE TOP OF CURB ELEVATION FOR EACH HOUSE LATERAL ON THE GRADE SHEET.
  - NO REVISIONS SHALL BE MADE IN THESE PLANS WITHOUT THE APPROVAL OF THE COUNTY ENGINEER.
  - THE CONTRACTOR SHALL NOTIFY THE CONSTRUCTION DIVISION BY TELEPHONE, MADISON 5-07, EXT. 8158, AT LEAST TWENTY-FOUR HOURS BEFORE STARTING ANY WORK UNDER THIS CONTRACT.
  - ALL STRUCTURES SHALL BE EITHER BRICK MANHOLES PER 3 OR PRECAST CONCRETE MANHOLES PER 3-26 EXCEPT AS NOTED.
  - EXCEPT AS NOTED, "Y" BRANCHES MAY BE USED FOR CONNECTIONS TO MAINLINE SEWER.
  - MANHOLE TOPS IN UNIMPROVED RIGHTS-OF-WAY TO BE 36 INCHES ABOVE FINISHED GRADE.
  - VITRIFIED CLAY PIPE UNITS SHALL BE TYPE D, 15" DIA. PER S.D. SPECIFICATIONS, SECTION 208-2.
  - IF A POWER POLE IS WITHIN THREE FEET OF THE SEWER, THE SEWER SHALL BE ENCASED, PER 3-29, TWO FEET ON EACH SIDE FROM THE POINT OF INTERFERENCE.
  - IF DURING THE COURSE OF CONSTRUCTION IT IS DETERMINED THAT THERE IS LESS THAN FOUR FEET OF COVER OVER THE TOP OF A MAIN LINE OR HOUSE LATERAL V.C.P. SEWER WHICH IS NOT INDICATED ON THE PLANS, THE PIPE SHALL BE ENCASED PER 3-23, UNLESS OTHERWISE APPROVED BY THE COUNTY ENGINEER.
  - HOUSE LATERALS TO BE CONSTRUCTED WITH INVERTS AT PROPERTY LINE 6 FEET BELOW CURB GRADE EXCEPT AS NOTED.
  - RESURFACE ALL TRENCHES WITHIN PAVED AREAS TO MEET L.A. COUNTY ROAD DEPT. OR CALIFORNIA STATE HIGHWAY REQUIREMENTS IN ACCORDANCE WITH PERMITS.
  - SEWERS TO BE TRIPPED FOR LEAKAGE PER SEC. 306.8, 3.7 OF THE S.D. SPECIFICATIONS.
  - ALL STATE AND LOCAL TRENCH SAFETY ORDERS WILL BE STRICTLY ENFORCED, AND SHALL BE FULLY COMPLIED WITHIN SPECIFICATION SECTION 7-10.8.1.
  - ALL UNITS BETWEEN CAST IRON PIPE AND VITRIFIED CLAY PIPE SHALL BE MADE WITH A RUBBER SLEEVE JOINT, TYPE "O" OR "O" (WITH GASKETING IF NECESSARY) PER STANDARD SPECIFICATIONS, SECTION 208-2.

THE FOLLOWING COUNTY ENGINEER STD. PLANS APPLY TO THIS PROJECT:

1. ROAD	2-1
2. SIDEWALK	2-1
3. DRIVE	2-1
4. DRIVE	2-1
5. DRIVE	2-1
6. DRIVE	2-1
7. DRIVE	2-1
8. DRIVE	2-1
9. DRIVE	2-1
10. DRIVE	2-1
11. DRIVE	2-1
12. DRIVE	2-1
13. DRIVE	2-1
14. DRIVE	2-1
15. DRIVE	2-1
16. DRIVE	2-1
17. DRIVE	2-1
18. DRIVE	2-1
19. DRIVE	2-1
20. DRIVE	2-1
21. DRIVE	2-1
22. DRIVE	2-1
23. DRIVE	2-1
24. DRIVE	2-1
25. DRIVE	2-1
26. DRIVE	2-1
27. DRIVE	2-1
28. DRIVE	2-1
29. DRIVE	2-1
30. DRIVE	2-1
31. DRIVE	2-1
32. DRIVE	2-1
33. DRIVE	2-1
34. DRIVE	2-1
35. DRIVE	2-1
36. DRIVE	2-1
37. DRIVE	2-1
38. DRIVE	2-1
39. DRIVE	2-1
40. DRIVE	2-1
41. DRIVE	2-1
42. DRIVE	2-1
43. DRIVE	2-1
44. DRIVE	2-1
45. DRIVE	2-1
46. DRIVE	2-1
47. DRIVE	2-1
48. DRIVE	2-1
49. DRIVE	2-1
50. DRIVE	2-1
51. DRIVE	2-1
52. DRIVE	2-1
53. DRIVE	2-1
54. DRIVE	2-1
55. DRIVE	2-1
56. DRIVE	2-1
57. DRIVE	2-1
58. DRIVE	2-1
59. DRIVE	2-1
60. DRIVE	2-1
61. DRIVE	2-1
62. DRIVE	2-1
63. DRIVE	2-1
64. DRIVE	2-1
65. DRIVE	2-1
66. DRIVE	2-1
67. DRIVE	2-1
68. DRIVE	2-1
69. DRIVE	2-1
70. DRIVE	2-1
71. DRIVE	2-1
72. DRIVE	2-1
73. DRIVE	2-1
74. DRIVE	2-1
75. DRIVE	2-1
76. DRIVE	2-1
77. DRIVE	2-1
78. DRIVE	2-1
79. DRIVE	2-1
80. DRIVE	2-1
81. DRIVE	2-1
82. DRIVE	2-1
83. DRIVE	2-1
84. DRIVE	2-1
85. DRIVE	2-1
86. DRIVE	2-1
87. DRIVE	2-1
88. DRIVE	2-1
89. DRIVE	2-1
90. DRIVE	2-1
91. DRIVE	2-1
92. DRIVE	2-1
93. DRIVE	2-1
94. DRIVE	2-1
95. DRIVE	2-1
96. DRIVE	2-1
97. DRIVE	2-1
98. DRIVE	2-1
99. DRIVE	2-1
100. DRIVE	2-1

NOTICE TO CONTRACTOR  
 The existence and location of any underground utility pipes or structures shown on these plans are obtained by a search of the available records to the best of my knowledge there are no existing utilities except as shown on these plans. The contractor is required to take due precautionary measures to protect the utility lines shown and any other lines not of record or not shown on these plans.  
*Enrique Devedo*  
 C.E. 12012

GRADES TO WHICH THE IMPROVEMENT IS TO BE CONSTRUCTED ARE SHOWN ON PLANS AND PROFILE GRADE POINTS FOR TOP OF CURB, CENTER LINE OF STREETS, OR CENTER LINE OF ALLEYS ARE SHOWN BY CIRCLES ON PROFILES AT ALL POINTS BETWEEN DESIGNATED POINTS. THE GRADE SHALL BE ESTABLISHED SO AS TO CONFORM TO A STRAIGHT LINE DRAWN BETWEEN SAID DESIGNATED POINTS. ELEVATIONS ARE IN FEET ABOVE U.S.C. & G.S. SEA LEVEL DATUM OF 1929.  
 IF WORK IS TO BE DONE ON A STATE HIGHWAY, A PERMIT MUST BE OBTAINED FROM THE STATE OF CALIFORNIA, DIVISION OF HIGHWAYS, 126 SOUTH BRINK STREET, LOS ANGELES, CALIFORNIA.  
 THE BOARDING AND THE 20' x 10' BOARD AND HOIST SHALL BE A PART OF THE CONTRACTOR'S EQUIPMENT.  
**COUNTY OF LOS ANGELES, CALIFORNIA**  
 HARVEY T. BRANDT, COUNTY ENGINEER  
 J. D. PARKHURST, CHIEF ENGINEER  
 APPROVED BY *R.L. Kopchy 10/14/71*  
 CHIEF ENGINEER

J.N. 0271.53

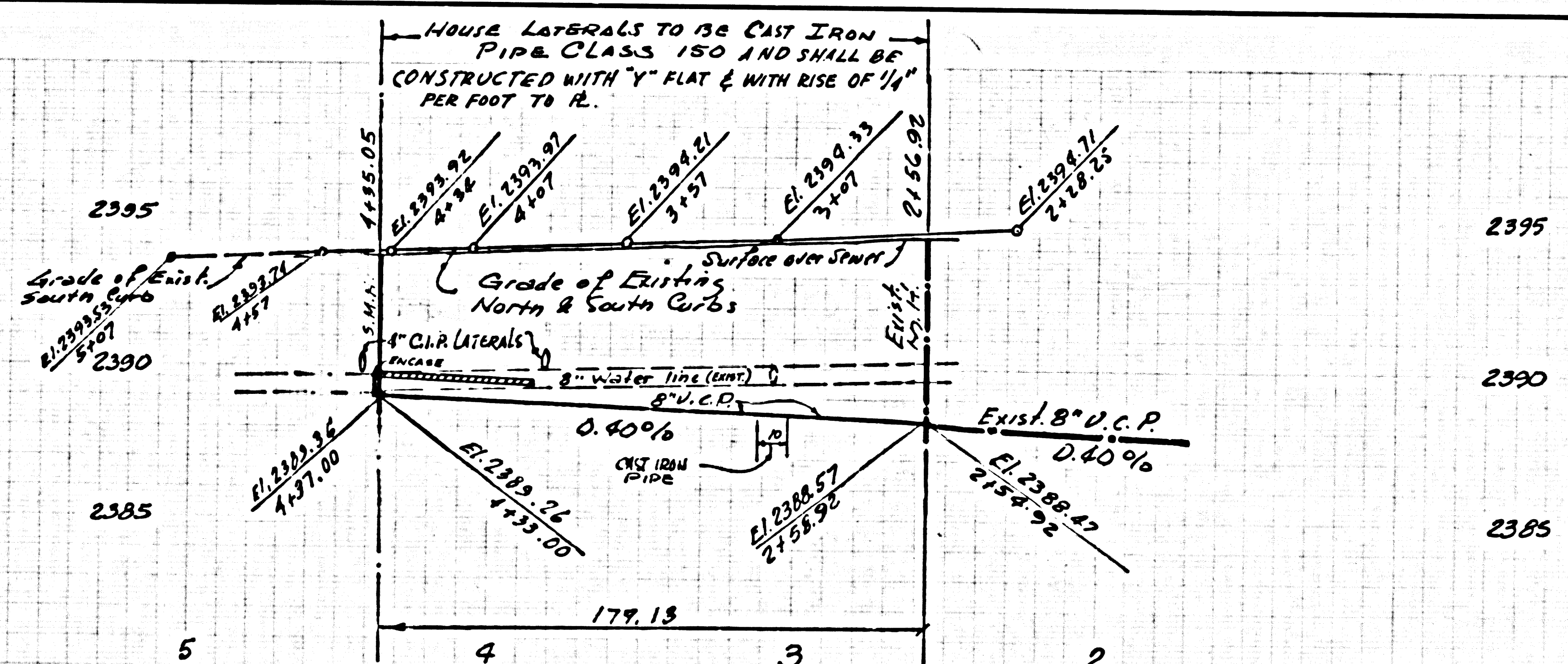

P.C. 8782 PAGE 2  
**NO CHARGE FOR CONNECTION**

43534

