

B.M. 8639/2 ELEV. 895.862  
 1.47 IN EAST END OF C.B. 43 FT. NORTH  
 4.96 FT. WEST E. NT. GRAV. AVE. AND  
 DIAMOND BAR BLVD. MKD. B.M.C. - 11"  
 OTTERBEIN QUAD. 1970

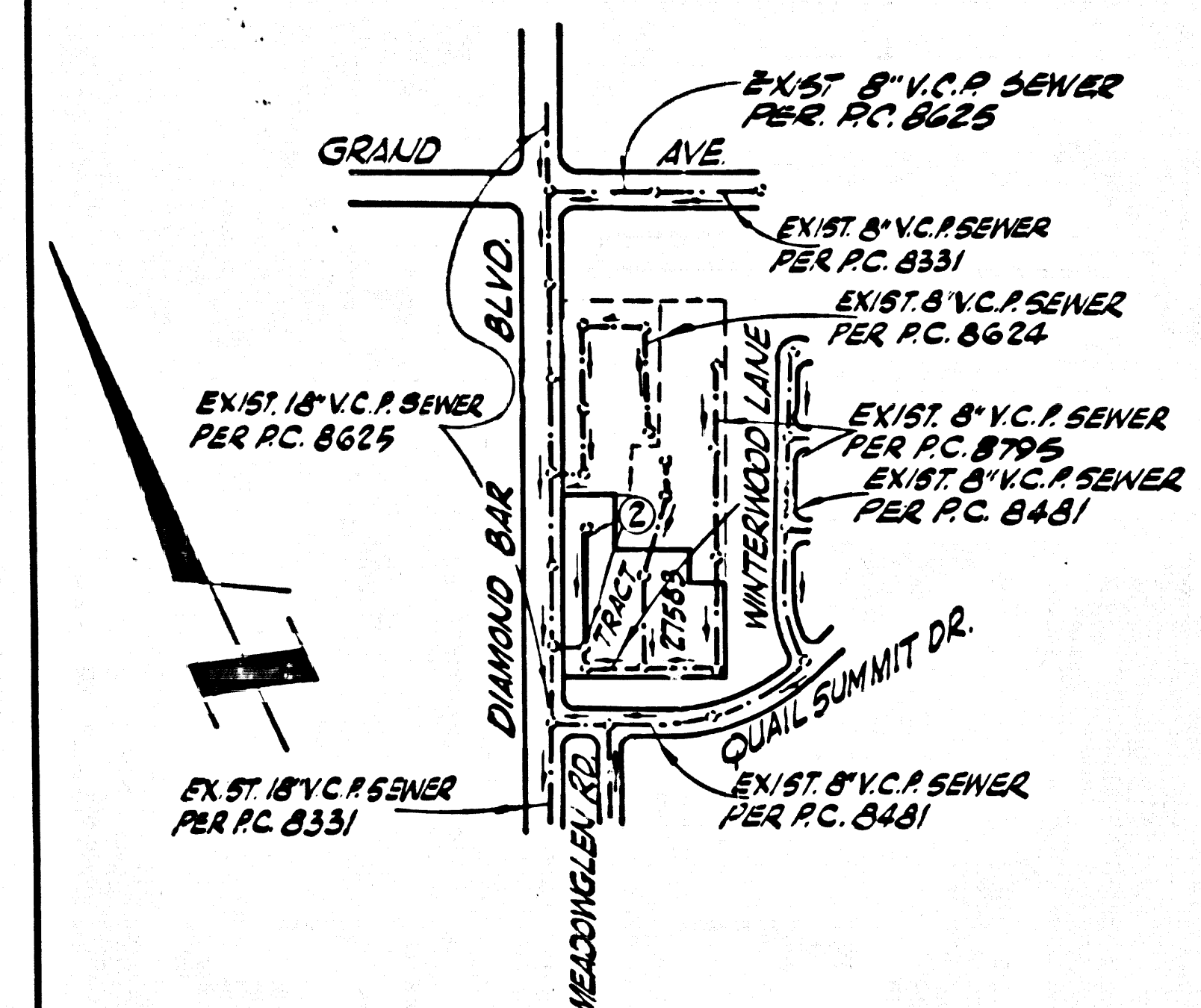

INDEX MAP  
 TRACT NO. 27583  
 P.C. 8806  
 SCALE: 1" = 600'

THE FOLLOWING LATEST REVISED STANDARD PLANS ON FILE  
 IN THE OFFICE OF THE COUNTY ENGINEER SHALL APPLY IN  
 THE CONSTRUCTION OF THIS PROJECT.

LEGEND	
MIN. PUBLIC SAFETY REQUIREMENTS	8-1
BRICK MANHOLE	8-3
NON-REINFORCED PRECAST CONC. MANHOLE	8-5
LOCKING MANHOLE FRAME & COVER	8-17
STANDARD MANHOLE STEP	8-21
BEDDING FOR SEWER PIPE	8-23
CRADLING AND ENCASUREMENTS	8-26
WYE OR TEE SUPPORT	8-33
ALLOWABLE TRENCH WIDTH	8-33

NOTE: ADDITIONAL PERMITTED BUILDING SITES FOR TRACT NO. 27583  
 NOT SHOWN HEREON ARE SERVED BY P.C. 8795

ISSUE NO PERMITS UNTIL PRIVATE CONTRACT  
 NO'S 8331, 8625 & 8795 HAVE BEEN  
 ACCEPTED

### SAN DIMAS BLDG. DIST. NO. 10

- GENERAL AND CONSTRUCTION
- PROVIDE EASEMENTS ON THE PROPERTY LINE OR PROPERTY LINES PRODUCED AT RIGHT ANGLES TO THE SEWER LINE AT THE CENTER LINE OF EACH MANHOLE.
  - NO REPRESENTATIVE OF THE COUNTY ENGINEER WILL SURVEY OR LAY OUT ANY PORTION OF THE WORK.
  - THE PRIVATE ENGINEER SHALL FURNISH THE COUNTY ENGINEER WITH GRADE SHEETS AND STATIONING FOR ALL HOUSE LATERALS AND "T" BRANCHES AND SHALL PROVIDE STAKES FOR THEM AT THEIR PROPER LOCATIONS WITH STATIONING BRACKET MARKERS. ALL HOUSE LATERALS SHALL BE CONSTRUCTED IN A STRAIGHT ALIGNMENT AT RIGHT ANGLES TO THE MAIN LINE SEWER EXCEPT AS SHOWN ON THE PLANS. HOUSE LATERALS FROM CHIMNEYS SHALL NOT HAVE AN ANGLE OF LESS THAN 45° WITH THE MAIN LINE SEWER. ANY CHANGE IN ALIGNMENT SHALL BE REQUESTED BY WRITING BY THE PRIVATE ENGINEER.
  - THE PRIVATE ENGINEER SHALL FURNISH THE HOUSE LATERAL DEPTH AT THE PROPERTY LINE BELOW THE TOP OF CURB ELEVATION FOR EACH HOUSE LATERAL ON THE GRADE SHEET.
  - NO REVISIONS SHALL BE MADE IN THESE PLANS WITHOUT THE APPROVAL OF THE COUNTY ENGINEER.
  - THE CONTRACTOR SHALL NOTIFY THE CONSTRUCTION DIVISION BY TELEPHONE, MADISON 9-67, EXT. 81331, AT LEAST TWENTY-FOUR HOURS BEFORE STARTING ANY WORK UNDER THIS CONTRACT.
  - ALL STRUCTURES SHALL BE BUILT PER BRICK MANHOLES PER 8-3 OR PRECAST CONC. MANHOLES PER 8-5 EXCEPT AS NOTED.
  - WYE OR TEE BRANCHES MAY BE USED FOR CONNECTIONS TO MAINLINE SEWERS EXCEPT AS NOTED.
  - MANHOLE TOPS IN UNIMPROVED RIGHTS-OF-WAY TO BE SIX INCHES ABOVE FINISHED GRADE.
  - VITRIFIED CLAY PIPE JOINTS SHALL BE TYPE "D," 7" OR 8" PER STD. S.P.S. 208-2.
  - REFER TO SEC. 7-10.4-1 OF THE STD. S.P.S. REGARDING SAFETY CROSSERS.
  - IF A POWER POLE IS WITHIN THREE FEET OF THE SEWER, THE SEWER SHALL BE ENCASED, PER 8-23, TWO FEET ON EACH SIDE FROM THE POINT OF INTERFERENCE.
  - IF DURING THE COURSE OF CONSTRUCTION IT IS DETERMINED THAT THERE IS LESS THAN FOUR FEET OF COVER OVER THE TOP OF A MAIN LINE OR HOUSE LATERAL V.C.P. SEWER WHICH IS NOT INDICATED ON THE PLANS, THE PIPE SHALL BE ENCASED PER 8-23, UNLESS OTHERWISE APPROVED BY THE COUNTY ENGINEER.
  - HOUSE LATERALS TO BE CONSTRUCTED WITH INVERTS AT 1/4" LINE 6 FEET BELOW FINISHED SURFACE OVER SEWER EXCEPT AS NOTED. GRADES TO WHICH THIS IMPROVEMENT IS TO BE CONSTRUCTED ARE SHOWN ON PLANS AND PROFILES. GRADE POINTS FOR TOP OF CURB, CENTER LINE OF STREETS, OR CENTER LINE OF ALLEYS ARE SHOWN BY CIRCLES ON PROFILES AT ALL POINTS BETWEEN DESIGNATED POINTS. THE GRADE SHALL BE ESTABLISHED SO AS TO CONFORM TO A STRAIGHT LINE DRAWN BETWEEN SAID DESIGNATED POINTS. ELEVATIONS ARE IN FEET ABOVE U.S.C. & G.S. MEAN SEA LEVEL DATUM OF 1929.
  - RESURFACE ALL TRENCHES WITHIN PAVED AREAS TO MEET L.A. COUNTY ROAD DEPT. OR CALIFORNIA STATE HIGHWAY REQUIREMENTS IN ACCORDANCE WITH PERMITS.
  - SEWERS TO BE TESTED FOR LEAKAGE PER SECTION 806-2, 9, 10 OF STD. S.P.S. & SPECIAL PROVISIONS.
  - ALL JOINTS BETWEEN CAST IRON PIPE AND VITRIFIED CLAY PIPE SHALL BE MADE WITH A RUBBER GLEBE JOINT, TYPE "C" OR "D," WITH RUBBER (IF NECESSARY) PER STD. S.P.S. 204-5.
  - ALL COMPLIANCE WITH SECTION 806-10.8 OF THE SPECIAL PROVISIONS WILL BE REQUIRED FOR BACKFILL, IN STRAIGHTS, DISTRIBUTION OF BACKFILL, CONNECTION AND SAID EQUIVALENTS BY QUALIFIED REGISTERED TESTING LABORATORY SHALL BE PROVIDED BY THE PERMITTEE PRIOR TO THE ISSUANCE OF A CERTIFICATION OF PARTIAL ACCEPTANCE.
- County Sanitation Districts shall be notified prior to the following so that required inspection can be made (Phone 337-1025 - 838-1181)
- Acceptance of this project.

NOTICE TO CONTRACTOR

The existence and location of any underground utility pipes or structures shown on these plans are obtained by a search of the available records to the best of my knowledge there are no existing utilities except as shown on these plans. The contractor is required to take due precautionary measures to protect the utility lines shown and any other lines not of record or not shown on these plans.

*Richard J. Youngfall*  
 P.E. 11532

PROFILE ALIGNMENT AND GRADE OF  
 SANITARY SEWERS PAGE 1

TRACT NO. 27583  
 PRIVATE CONTRACT NO. 8806

W.S. 39-C-3  
 1 SHEETS, 2 PAGES  
 SCALE: VERT. 1" = 4'  
 HORIZ. 1" = 40'  
 JULY, 1972

PREPARED IN THE OFFICES OF  
 E. L. PEARSON AND ASSOCIATES  
 1851 W. REBOUDO BEACH BLVD. GARDENA, CALIF.  
 BY: *Richard J. Youngfall*  
 P.E. C. E. NO. 11532

FOR LEGEND SEE PLAN NO. S-1

NOTE: GRADES TO WHICH THIS IMPROVEMENT IS TO BE CONSTRUCTED ARE SHOWN ON PLANS AND PROFILES. GRADE POINTS FOR TOP OF CURB, CENTER LINE OF STREETS, OR CENTER LINE OF ALLEYS ARE SHOWN BY CIRCLES ON PROFILES AT ALL POINTS BETWEEN DESIGNATED POINTS. THE GRADE SHALL BE ESTABLISHED SO AS TO CONFORM TO A STRAIGHT LINE DRAWN BETWEEN SAID DESIGNATED POINTS. ELEVATIONS ARE IN FEET ABOVE U.S.C. & G.S. MEAN SEA LEVEL DATUM OF 1929.

APPROVAL OF THIS PLAN BY THE COUNTY OF LOS ANGELES DOES NOT CONSTITUTE A REPRESENTATION AS TO THE ACCURACY OF THE LOCATION OF OR THE EXISTENCE OR NON-EXISTENCE OF ANY UNDERGROUND UTILITY PIPE, OR STRUCTURE WITHIN THE LIMITS OF THIS PROJECT. THIS NOTE APPLIES TO ALL PAGES.

IF WORK IS TO BE DONE IN A STATE HIGHWAY, A PERMIT MUST BE OBTAINED FROM THE STATE OF CALIFORNIA, DIVISION OF HIGHWAYS, 130 SOUTH SPRING STREET, LOS ANGELES, CALIFORNIA.

COUNTY OF LOS ANGELES, CALIFORNIA  
 HARVEY T. BRANDT, COUNTY ENGINEER  
 APPROVED BY: *H. T. Brandt*  
 SAN DIMAS REGIONAL ENGINEER

J. D. PARKHURST, CHIEF ENGINEER  
 CO. SAN. DIST. NO. 10  
 APPROVED BY: *J. D. Parkhurst*  
 OFFICE ENGINEER

CHECKED BY: *W. D. Wade*  
 REG. CE. NO. 2404

44212

J. N. 0250.06

