

B.M. 57-0776 ELEV. 782.725
 L & B N. CURB VIA COLINITA
 10 FT. N. & 60 FT. E. PALOS
 VERDES DRIVE EAST.
 PALOS VERDES QUAD. 1910.

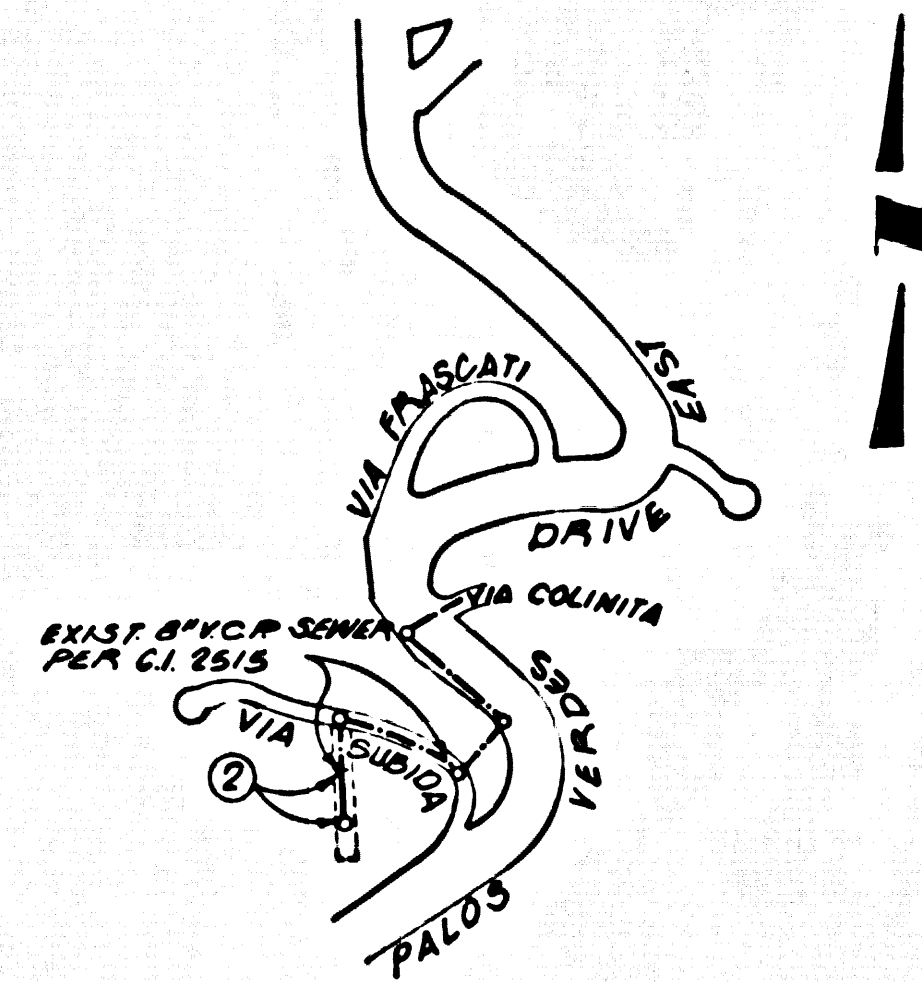

INDEX MAP
 SCALE: 1" = 600'

REVISION NO. 2

REVISED GRADE OF SEWER DUE TO
 REVISED FINISH SURFACE OVER SEWER
 MICHAEL A. RICHARDS R.C.E. 22504
 MICHAEL A. RICHARDS R.C.E. 22504
 MICHAEL A. RICHARDS R.C.E. 22504
 MICHAEL A. RICHARDS R.C.E. 22504

No connections for the disposal of industrial wastes shall be made to sewerage shown on these drawings without written permission from the Chief Engineer and General Manager of the County Sanitation Districts.

County Sanitation Districts shall be notified prior to the following so that required inspection can be made (Public Ordinance - 638-101)

ACCEPTANCE OF THE PROJECT

GENERAL NOTES:

1. SEPARATIONS ARE IN PINK AND V.E.C. & S.S. ARE IN BLUE.
2. NO REVISIONS SHALL BE MADE BY THESE PLANS WITHOUT THE APPROVAL OF THE COUNTY ENGINEER.
3. NO REPRESENTATIVE OF THE COUNTY ENGINEER WILL SURVEY OR LAY OUT ANY PORTION OF THE WORK.
4. GRADES TO WHICH THIS IMPROVEMENT IS TO BE CONSTRUCTED ARE SHOWN ON PLANS AND PROFILES. GRADE POINTS FOR TOP OF CURBS, CENTER LINE OF STREETS, OR CENTER LINE OF ALLEYS ARE SHOWN BY CIRCLES IN PROFILES. AT ALL POINTS BETWEEN DESIGNATED POINTS THE GRADE SHALL BE ESTABLISHED SO AS TO CONFORM TO A STRAIGHT LINE DRAWN BETWEEN SAID DESIGNATED POINTS.
5. THE PRIVATE ENGINEER SHALL FURNISH THE COUNTY ENGINEER WITH GRADE SHEETS AND STATIONINGS FOR ALL HOUSE LATERALS AND 12" OR 16" BRANCHES AND SHALL PROVIDE STAGES FOR THEM AT THEIR PROPER LOCATIONS WITH SEASONING ALREADY BURNED. ALL HOUSE LATERALS SHALL BE CONSTRUCTED IN A STRAIGHT ALIGNMENT AT RIGHT ANGLES FROM THE MAIN LINE SEWER EXCEPT AS SHOWN ON THE PLANS. HOUSE LATERALS FROM CHIMNEYS SHALL NOT HAVE AN ANGLE OF LESS THAN 45° WITH THE MAIN LINE SEWER. ANY CHANGE IN ALIGNMENT SHALL BE REQUESTED BY WRITING BY THE PRIVATE ENGINEER.
6. THE PRIVATE ENGINEER SHALL FURNISH THE HOUSE LATERAL SLOPE AT THE PROPERTY LINE SHOW THE TOP OF CURB ELEVATION FOR EACH HOUSE LATERAL ON THE GRADE SHEET.
7. BEFORE WORK CAN BE STARTED, THE CONTRACTOR MUST OBTAIN A PERMIT TO EXCAVATE IN COUNTY STREETS FROM THE L. A. COUNTY ROAD DEPT., DISTRICT OFFICE NO. 1 AND PAY A FEE TO THE COUNTY ENGINEER, ROOM 178, 410 S. GARDEN, IMPERIAL BUILDING, JOHANNESBURG, CALIF. BEFORE COMMENCING WORK. A PERMIT SHALL BE OBTAINED FROM THE STATE OF CALIFORNIA, DIVISION OF HIGHWAYS, 138 SOUTH SPRING STREET, LOS ANGELES, CALIFORNIA.
8. IF WORK IS TO BE DONE IN A STATE HIGHWAY, A PERMIT MUST BE OBTAINED FROM THE STATE OF CALIFORNIA, DIVISION OF HIGHWAYS, 138 SOUTH SPRING STREET, LOS ANGELES, CALIFORNIA.
9. APPROVAL OF THIS PLAN BY THE COUNTY OF LOS ANGELES DOES NOT CONSTITUTE A REPRESENTATION AS TO THE ACCURACY OF THE LOCATION OR OF THE EXISTENCE OR NON-EXISTENCE OF ANY UNDERGROUND UTILITY PIPE, OR STRUCTURE WITHIN THE LIMITS OF THIS PROJECT. THIS NOTE APPLIES TO ALL PAGES.
10. REFER TO SECTION 7-16.1 OF THE STANDARD SPECIFICATIONS, REGARDING SAFETY SIGNALS.

CONSTRUCTION NOTES:

1. WORK SHALL BE CONSTRUCTED ACCORDING TO THE STANDARD SPECIFICATIONS FOR PUBLIC WORKS CONSTRUCTION TYPE SECTION 7-7.2. SUPPLEMENTED AND COUNTY ENGINEER SPECIAL PROVISIONS FOR THE CONSTRUCTION OF SANITARY SEWERS DATED APRIL 18, 1972 AND SHALL BE PROSECUTED ONLY IN THE PRESENCE OF THE COUNTY ENGINEER.
2. THE CONTRACTOR SHALL NOTIFY THE CONSTRUCTION DIVISION BY TELEPHONE, TELEVISION 8-4700, EXT. 8158, AT LEAST TWENTY-FOUR HOURS BEFORE STARTING ANY WORK UNDER THIS CONTRACT.
3. HOUSE LATERALS TO BE CONSTRUCTED WITH INVERTS AT PROPERTY LINE A FEET BELOW CURB GRADE EXCEPT AS NOTED.
4. VITE OR THE BRANCHES MAY BE USED FOR CONNECTIONS TO MANHOLE SEWERS EXCEPT AS NOTED.
5. ALL STRUCTURES SHALL BE WITHIN BRICK MANHOLES PER 84 OR PRECAST CONCRETE MANHOLES PER 86, EXCEPT AS NOTED.
6. PROPOSED STAKES ON THE PROPERTY LINE OR PROPERTY LINE PROJECTIONS AT RIGHT ANGLES TO THE SEWER LINE AT THE CENTER LINE OF EACH MANHOLE.
7. MANHOLES FOR AN UNCOVERED HEIGHT OF FEET TO BE IN EXCESS ABOVE FINISHED GRADE.
8. VITRIFIED CLAY PIPE JOINTS SHALL BE THE "B", "C", OR "D" PER STANDARD SPECIFICATIONS SECTION 800-2.
9. IF A POWER POLE IS WITHIN THIRTY FEET OF THE SEWER, THE SEWER SHALL BE BROADCAST PER 1.23, CASE II, TWO FEET ON EACH SIDE FROM THE POINT OF INTERFERENCE.
10. IF DURING THE COURSE OF CONSTRUCTION IT IS DETERMINED THAT THERE IS LESS THAN FOUR FEET OF COVER OVER THE TOP OF A MAIN LINE OR HOUSE LATERAL V.C.P. SEWER WHICH IS NOT INDICATED ON THE PLANS, THE PIPE SHALL BE BROADCAST PER 1.23, CASE II UNLESS OTHERWISE APPROVED BY THE COUNTY ENGINEER.
11. ALL JOINTS BETWEEN CAST IRON PIPE AND VITRIFIED CLAY PIPE SHALL BE MADE WITH A RUBBER SLURRY JOINT, TYPE "C" OR "D", WITH REINFORCING AS NECESSARY PER STANDARD SPECIFICATIONS, SECTION 800-2.
12. SEWERS TO BE REPEATED WITHIN NAYEN AREAS TO MEET L.A. COUNTY ROAD DEPT. OF CALIFORNIA SPECIAL PROVISIONS IN ACCORDANCE WITH PERMITS.
13. REINFORCE ALL TRENCHES WITHIN NAYEN AREAS TO MEET L.A. COUNTY ROAD DEPT. OF CALIFORNIA SPECIAL PROVISIONS IN ACCORDANCE WITH PERMITS.

PROFILE, ALIGNMENT AND GRADE OF
SANITARY SEWERS PAGE 1
 TO BE CONSTRUCTED IN
**SANITARY SEWER R/W
 SOUTHERLY OF VIA SUBIDA**
 PRIVATE CONTRACT NO. 8850

W.S. 27
 1 SHEET, 3 PAGES
 SCALE: HORIZ. 1" = 80' VERT. 1" = 8'
 OCTOBER, 1972
 PREPARED IN THE OFFICES OF
LANCO ENGINEERING
 BY: C. M. K. [Signature]
 REG. C. E. No. 13167

THE FOLLOWING LATEST REVISED STANDARD PLANS ON FILE IN THE OFFICE OF THE COUNTY ENGINEER SHALL APPLY IN THE CONSTRUCTION OF THIS PROJECT:

SMOKE	84
BRICKWORK	84
BRICK MANHOLE	84
STANDARD MANHOLE TOP	84
BRICKWORK FOR SEWER PIPE	84
CLAYWORK AND BRICKLAYER	84
PIPE ON THE SUPPORT	84
ALUMINUM TRENCH SHIELD	84
LOCKING MANHOLE FRAME AND COVER	84
NON-IMPLODED PRECAST CONCRETE MANHOLE	84

COUNTY OF LOS ANGELES, CALIFORNIA
 HARVEY E. BRANDT, COUNTY ENGINEER
 JOHN D. PARKER, DIST. CHIEF ENGINEER
 APPROVED: [Signature] REGIONAL ENGINEER
 APPROVED: [Signature] OFFICE ENGINEER
 CHECKED: [Signature] 8-15-73
 REG. C.E. NO. 18,574
 LOWITA RIDG. DIST. 12 J.N. 0971 76

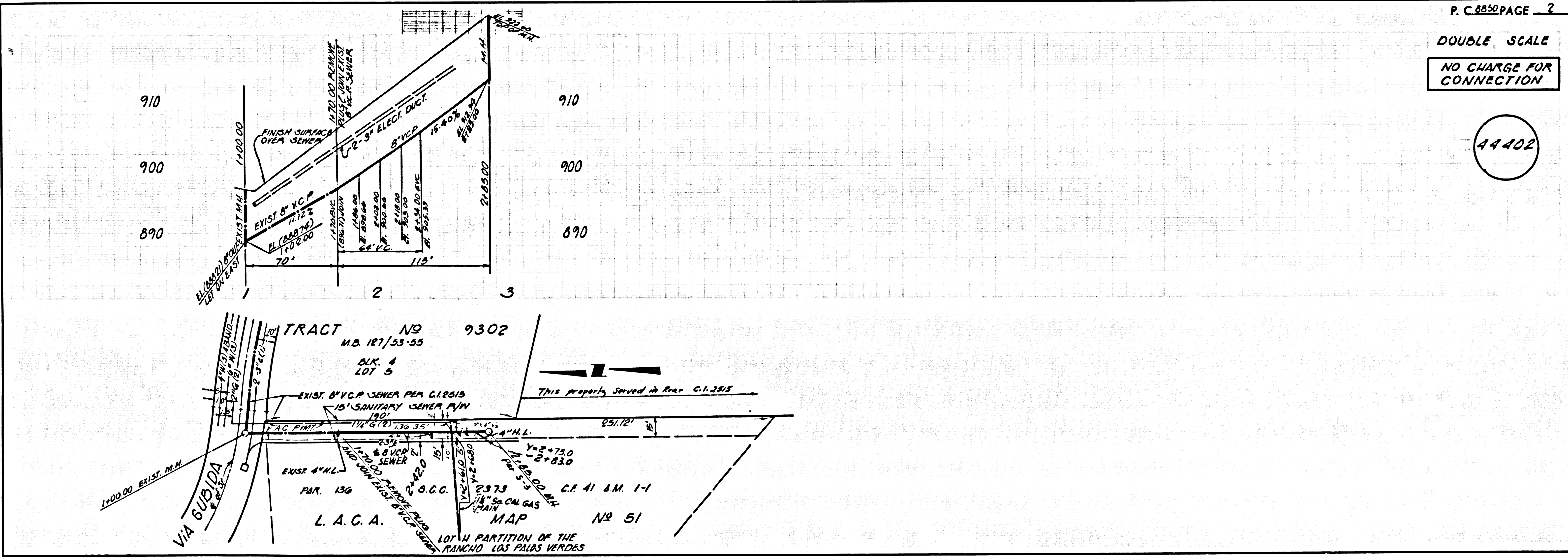

P. C. 8850 PAGE 2
 DOUBLE SCALE
 NO CHARGE FOR CONNECTION