

B.M. 69 2975 ELEV. 617.000  
 CS MON FLUSH IN WK ON  
 SW COR ALOSTA AVE + CITRUS  
 AVE 23 FT 3" + 43 FT W C/L INT  
 (M.S. 44-118)  
 Covina QUAD. 1962

TRAFFIC NOTES FOR CITRUS AVE.

1. Between the hours of 5:30 A.M. and 5:30 P.M. a minimum of one 12 foot traffic lane in each direction must be maintained. At all other times no restrictions in the existing facilities for traffic will be permitted. In other words, branches in the pavement must be backfilled and temporary pavement placed before 5:30 P.M.
2. In addition to the above indicated lane widths, a minimum clearance of 5 feet in any excavation and 2 feet from any curb or other obstruction must be maintained. Any traffic markings obliterated or removed by the operations of the permittee will be replaced at the permittee's expense.

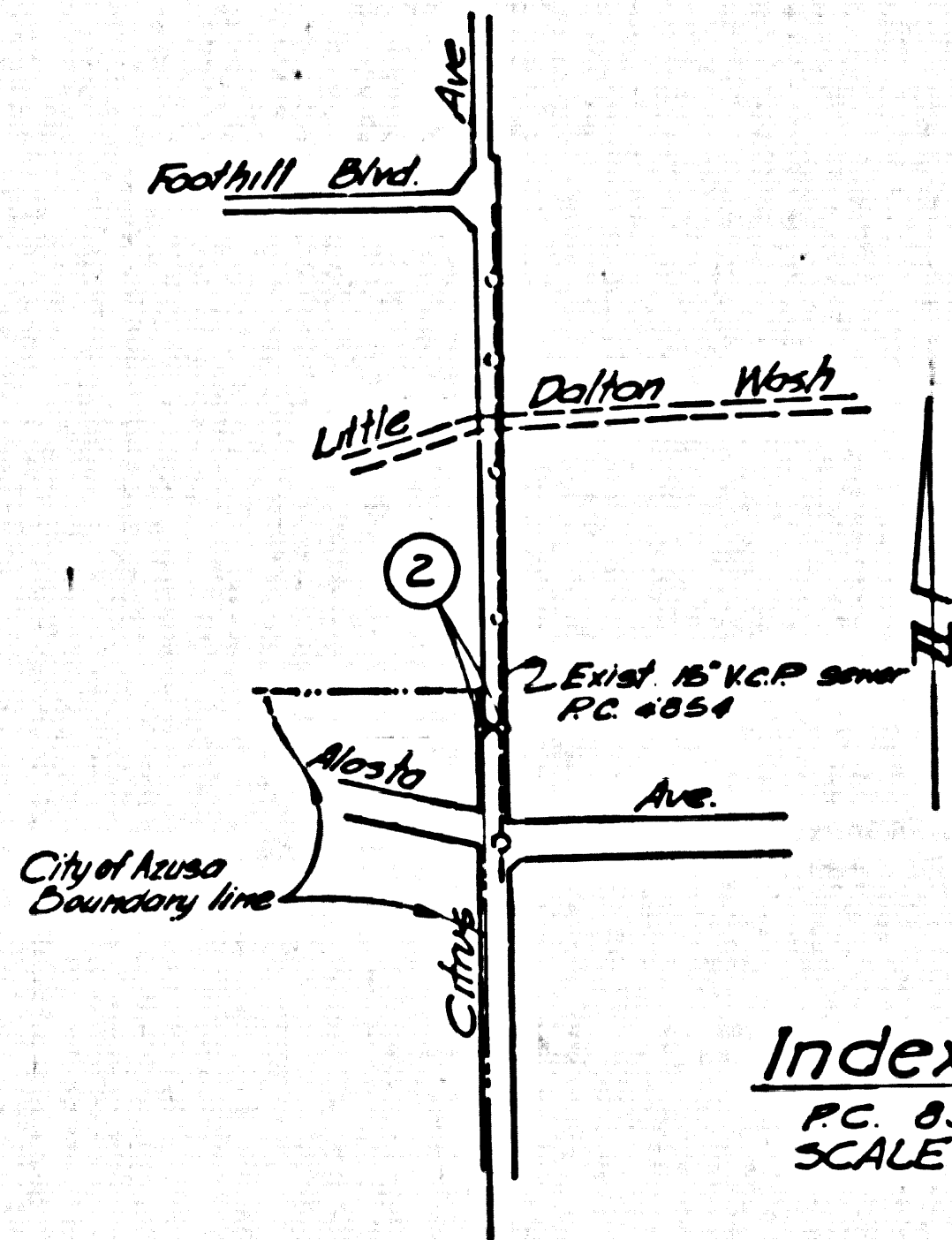

Index Map  
 P.C. 8362  
 SCALE 1" = 600'

SAN DIMAS BLDG. DIST. NO. 10

PROFILE, ALIGNMENT AND GRADE OF  
 SANITARY SEWERS P.C. 8362  
 PAGE 1  
 CONSTRUCTED IN

CITRUS AVENUE  
 PRIVATE CONTRACT NO. 8362

W.S. 47 D-8  
 1 SHEETS; 2 PAGES  
 SCALE: HORIZ. 1" = 40' VERT. 1" = 4'  
 SEPTEMBER, 1969  
 PREPARED IN THE OFFICES OF  
 MOLINA engineering consultants, inc.

By *[Signature]*  
 REG. C. E. NO. 14968

41462

- NOTES:
1. HOUSE LATERALS TO BE CONSTRUCTED WITH INVERT AT PROPERTY LINE 8 FEET BELOW CURB GRADE EXCEPT AS NOTED.
  2. PROVIDE STAKES ON THE PROPERTY LINE OR PROPERTY LINE-8 FEET BELOW CURB GRADE AT THE CENTER LINE OF EACH MANHOLE.
  3. NO HOUSE LATERALS OF THE COUNTY ENGINEER WILL SURVEY OR LAY OUT ANY PORTION OF THE WORK.
  4. THE PRIVATE ENGINEER SHALL FURNISH THE COUNTY ENGINEER WITH GRADE SHEETS AND STATIONING FOR ALL HOUSE LATERALS AND "T" OR "Y" BRANCHES AND SHALL PROVIDE STAKES FOR THEM AT THEIR PROPER LOCATIONS WITH STATIONING PLAINLY MARKED. ALL HOUSE LATERALS SHALL BE CONSTRUCTED IN A STRAIGHT ALIGNMENT AT RIGHT ANGLES FROM THE MAIN LINE SEWER EXCEPT AS SHOWN ON THE PLANS. HOUSE LATERALS FROM CHIMNEYS SHALL NOT HAVE AN ANGLE OF LESS THAN 45° WITH THE MAIN LINE SEWER. ANY CHANGE IN ALIGNMENT SHALL BE REQUESTED IN WRITING BY THE PRIVATE ENGINEER.
  5. THE PRIVATE ENGINEER SHALL FURNISH THE HOUSE LATERAL DEPTH AT THE PROPERTY LINE BELOW THE TOP OF CURB ELEVATION FOR EACH HOUSE LATERAL ON THE GRADE SHEET.
  6. NO INTERFERENCE SHALL BE MADE BY THESE PLANS WITHOUT THE APPROVAL OF THE COUNTY ENGINEER.
  7. THE CONTRACTOR SHALL NOTIFY THE CONSTRUCTION DIVISION BY TELEPHONE, MAIL OR PERSONAL VISIT, AT LEAST TWENTY-FOUR HOURS BEFORE STARTING ANY WORK UNDER THIS CONTRACT.
  8. ALL STRUCTURES SHALL BE 8 INCH BRICK MANHOLES PER 8-3 OR PRECAST CONCRETE MANHOLES PER 8-3 OR 8-4, EXCEPT AS NOTED.
  9. "T" OR "Y" BRANCHES MAY BE USED FOR CONNECTIONS TO MAINLINE SEWERS EXCEPT AS NOTED.
  10. MANHOLE TOPS IN UNIMPROVED RIGHTS OF WAY TO BE 8 INCHES ABOVE FINISHED GRADE.
  11. USE EXTRA STRENGTH PIPE. ALL PIPE IS STANDARD DEPTH EXCEPT AS NOTED.
  12. VITRIFIED CLAY PIPE JOINTS SHALL BE TYPE "B", "C", OR "D" PER STANDARD SPECIFICATIONS SECTION 206-2.
  13. IF A POWER POLE IS WITHIN THREE FEET OF THE SEWER, THE SEWER SHALL BE ENCASED, PER 8-32, TWO FEET ON EACH SIDE FROM THE POINT OF INTERFERENCE.
  14. IF DURING THE COURSE OF CONSTRUCTION IT IS DETERMINED THAT THERE IS LESS THAN FOUR FEET OF COVER OVER THE TOP OF A MAIN LINE OR HOUSE LATERAL V.C.P. SEWER WHICH IS NOT INDICATED ON THE PLANS, THE PIPE SHALL BE ENCASED PER 8-32, UNLESS OTHERWISE APPROVED BY THE COUNTY ENGINEER.
  15. RESURFACE ALL TRENCHES WITHIN PAVED AREAS TO MEET L.A. COUNTY ROAD DEPT. OR CALIFORNIA STATE HIGHWAY REQUIREMENTS IN ACCORDANCE WITH PERMITS.
  16. SEWERS TO BE TESTED FOR LEAKAGE PER SECTION 206-2.3.7 OF THE STANDARD SPECIFICATIONS.
  17. REFER TO SECTION 7-18.4.1 OF THE STANDARD SPECIFICATIONS, REGARDING SAFETY ORDERS.
  18. ALL JOINTS BETWEEN CAST IRON PIPE AND VITRIFIED CLAY PIPE SHALL BE MADE WITH A RUBBER SLAVE JOINT, TYPE "C" OR "D", WITHIN BUILDINGS IF NECESSARY PER STANDARD SPECIFICATIONS, SECTION 206-2.
- THE FOLLOWING LATEST REVISED STANDARD PLANS ON FILE IN THE OFFICE OF THE COUNTY ENGINEER SHALL APPLY IN THE CONSTRUCTION OF THIS PROJECT:

EXCISE	8-1
MINIMUM PUBLIC SAFETY REQUIREMENTS	8-2
BRICK MANHOLE	8-3
NON-REINFORCED PRECAST CONCRETE MANHOLE	8-4
REINFORCED PRECAST CONCRETE MANHOLE	8-5
MANHOLE FRAME AND COVER	8-6
STANDARD MANHOLE STEP	8-7
RECORDING FOR SEWER PIPE	8-8
CRACKING AND ENCASEMENT	8-9
WYE OR TEE SUPPORT	8-10
ALONGSIDE TRENCH WRITING	8-11

Sanitation Districts shall be notified by the contractor on the following or other locations as so made: (SEE 8-122) (SEE 8-123)

COLLECT CHARGES AS INDICATED

NOTE:  
 A PERMIT MUST BE OBTAINED FROM THE CITY OF AZUSA PRIOR TO EXCAVATION IN CITY STREETS.

No connections for the disposal of industrial wastes shall be made to sewers shown on these drawings without written permission from the Chief Engineer and General Manager of the County Sanitation Districts.

NOTE:  
 GRADES TO WHICH THIS IMPROVEMENT IS TO BE CONSTRUCTED ARE SHOWN ON PLANS AND PROFILES. BENCHMARK POINTS FOR TOP OF CURB, CENTER LINE OF STREETS, OR CENTER LINE OF ALLEYS ARE SHOWN BY CIRCLES ON PROFILES. AT ALL POINTS BETWEEN BENCHMARK POINTS THE GRADE SHALL BE DETERMINED SO AS TO CONFORM TO A STRAIGHT LINE BENEATH BENCHMARK POINTS. ELEVATIONS ARE IN FEET ABOVE U.S.C. & G.S. MEAN LEVEL UNLESS OTHERWISE NOTED.  
 WORK SHALL BE CONSTRUCTED ACCORDING TO THE STANDARD SPECIFICATIONS FOR PUBLIC WORKS CONSTRUCTION AND SPECIAL PROVISIONS FOR THE CONSTRUCTION OF SANITARY SEWERS PART 8-1, 8-2 AND 8-3, AS REVISED, AND SHALL BE PROSECUTED ONLY IN THE PRESENCE OF THE COUNTY ENGINEER.  
 BEFORE WORK CAN BE STARTED, THE CONTRACTOR MUST OBTAIN A PERMIT TO EXCAVATE IN COUNTY STREETS FROM THE S. & COUNTY ROAD DEPT., DISTRICT OFFICE NO. 1, AND PAY A FEE TO THE COUNTY ENGINEER, ROOM 508, COUNTY BUILDING, 100 WEST SECOND STREET OR... *[Signature]* SAN DIMAS REGIONAL OFFICE, SUPERVISOR TO COVER THE COST OF CONSTRUCTION INSPECTION AND RECORDING PLANS.  
 APPROVAL OF THIS PLAN BY THE COUNTY OF LOS ANGELES DOES NOT CONSTITUTE AN APPROPRIATION AS TO THE ACCURACY OF THE LOCATION OF OR THE EXISTENCE OR NON-EXISTENCE OF ANY UNDERGROUND UTILITY PIPE, OR STRUCTURE WITHIN THE LIMITS OF THIS PROJECT. THIS NOTE APPLIES TO ALL PLANS.  
 IF WORK IS TO BE DONE IN A STATE HIGHWAY, A PERMIT MUST BE OBTAINED FROM THE STATE OF CALIFORNIA, DIVISION OF HIGHWAYS, 138 SOUTH SPRING STREET, LOS ANGELES, CALIFORNIA.

COUNTY OF LOS ANGELES, CALIFORNIA  
 JOHN A. LAMBIE, COUNTY ENGINEER J. D. PARKHURST, CHIEF ENGINEER  
 CO. SANITARY DISTRICT NO. 10  
 APPROVED BY *[Signature]* APPROVED BY *[Signature]*  
 SAN DIMAS REGIONAL ENGINEER OFFICE ENGINEER  
 CHECKED BY *[Signature]* DATE 10/13/69 APPROVED BY *[Signature]*  
 DIST. C. E. NO. 13906 CITY ENGINEER CITY OF AZUSA (LOCAL)

P.C. 8362 PAGE 2  
 NO CHARGE FOR CONNECTIONS

41463

