

B.M. B.G. 2883 ELEV. 732.005
R.D.B.A. TAG 3. CB. 1 FT. E. BCR @
S.E. CORNER ARROW HWY. & BONNIE
COVE AVE. 42 FT. S. & 96 FT. E. C.
INT.
SAN DIMAS QUAD. 19 65

PRIVATE ENGINEERS NOTICE TO CONTRACTORS

THE EXISTENCE AND APPROXIMATE LOCATION OF UNDERGROUND UTILITIES OR STRUCTURES SHOWN ON THESE PLANS WERE DETERMINED BY A SEARCH OF AVAILABLE PUBLIC RECORDS. TO THE BEST OF OUR KNOWLEDGE THERE ARE NO EXISTING UNDERGROUND UTILITIES OR STRUCTURES EXCEPT AS SHOWN ON THESE PLANS.

THE CONTRACTOR IS REQUIRED TO TAKE DUE PRECAUTIONARY MEASURES TO PROTECT THE UTILITIES OR STRUCTURES SHOWN AND ANY OTHER UTILITIES OR STRUCTURES AT THE SITE.

IT SHALL BE THE CONTRACTOR'S RESPONSIBILITY TO NOTIFY THE OWNERS OF THE UTILITIES OR STRUCTURES CONCERNED BEFORE STARTING WORK.

SAN DIMAS BLDG. DIST. NO. 10

- NOTES:
1. PROVIDE STAKES ON THE PROPERTY LINE OR PROPERTY LINES PRODUCED AT RIGHT ANGLES TO THE SEWER LINE AT THE CENTER LINE OF EACH MANHOLE.
2. NO REPRESENTATIVE OF THE COUNTY ENGINEER WILL SURVEY OR LAY OUT ANY PORTION OF THE WORK.
3. THE PRIVATE ENGINEER SHALL FURNISH THE COUNTY ENGINEER WITH GRADE SHEETS AND STATIONINGS FOR ALL HOUSE LATERALS AND "T" OR "Y" BRANCHES AND SHALL PROVIDE STAKES FOR THEM AT THEIR PROPER LOCATIONS WITH STATIONING PLAINLY MARKED. ALL HOUSE LATERALS SHALL BE CONSTRUCTED AT A STRAIGHT ALIGNMENT AT RIGHT ANGLES FROM THE MAIN LINE SEWER EXCEPT AS SHOWN ON THE PLANS. HOUSE LATERALS FROM CHIMNEYS SHALL NOT HAVE AN ANGLE OF LESS THAN 45° WITH THE MAIN LINE SEWER. ANY CHANGE IN ALIGNMENT SHALL BE REQUESTED IN WRITING BY THE PRIVATE ENGINEER.
4. THE PRIVATE ENGINEER SHALL FURNISH THE HOUSE LATERAL DEPTH AT THE PROPERTY LINE BELOW THE GRADE OF R.W. FOR EACH HOUSE LATERAL ON THE GRADE SHEET.
5. NO REVISIONS SHALL BE MADE IN THESE PLANS WITHOUT THE APPROVAL OF THE COUNTY ENGINEER.
6. THE CONTRACTOR SHALL NOTIFY THE CONSTRUCTION DIVISION BY TELEPHONE, MADISON 4-47, EXT. 8183, AT LEAST TWENTY-FOUR HOURS BEFORE STARTING ANY WORK UNDER THIS CONTRACT.
7. ALL STRUCTURES SHALL BE BUILT MANHOLE PER 5-2.
8. "T" OR "Y" BRANCHES HAVE BEEN USED FOR CONNECTIONS TO MAIN LINE SEWER EXCEPT AS NOTED.
9. MANHOLE TOPS IN UNIMPROVED RIGHTS-OF-WAY TO BE FINISH WITH FINISHED GRADE.
10. USE EXTRA STRENGTH PIPE. ALL PIPE IS STANDARD DEPTH EXCEPT AS NOTED.
11. VITRIFIED CLAY PIPE JOINTS SHALL BE TYPE "D", "Y", OR "B" PER STD. SPEC. SEC. 504-8.
12. IF A POWER POLE IS WITHIN THREE FEET OF THE SEWER, THE SEWER SHALL BE ENCASED PER 5-23, TWO FEET ON EACH SIDE FROM THE POINT OF INTERFERENCE.
13. IF DURING THE COURSE OF CONSTRUCTION IT IS DETERMINED THAT THERE IS LESS THAN FOUR FEET OF COVER OVER THE TOP OF A MAIN LINE OR HOUSE LATERAL V.C.P. SEWER WHICH IS NOT INDICATED ON THE PLANS, THE PIPE SHALL BE ENCASED PER 5-23, UNLESS OTHERWISE APPROVED BY THE COUNTY ENGINEER.
14. HOUSE LATERALS TO BE CONSTRUCTED AT 1/4" RISE PER FOOT TO PROPERTY LINE.
15. RESURFACE ALL TRENCHES WITHIN PAVED AREAS TO MEET L.A. COUNTY ROAD DEPT. OR CALIFORNIA STATE HIGHWAY REQUIREMENTS BY ACCORDANCE WITH PERMITS.
16. SEWERS TO BE TESTED FOR LEAKAGE PER SECTION 306-317 UNIFORM STANDARD SPECIFICATIONS.
17. REFER TO SPEC. 7-10, 4-1, 1-17 STANDARD SPEC. REGARDING SAFETY ORDERS.
18. SPECIAL BACKFILL IN DESIGNATED AREAS.
19. BACKFILL TRENCH AND REPLACE OTHER EARTH REMOVED SO AS TO ACHIEVE THE NATURAL OR FINISHED GRADES AND SLOPES SHOWN ON THE GRADING PLAN APPROVED FOR THIS TRACT BY THE BUILDING AND SANITY DIVISION.
20. ALL BACKFILL AND EARTH REPLACED SHALL BE COMPACTED TO A MINIMUM OF 90% OF MAXIMUM DENSITY PER A.S.T.M. STAND. AND METHOD OF TEST D99-57T AS MODIFIED. ACCEPTABLE CERTIFICATION OF SUCH COMPACTION SHALL BE SUBMITTED TO THE CONSTRUCTION DIVISION.
21. ALL JOINTS STEEL CAST IRON AND VITRIFIED CLAY PIPE SHALL BE MADE WITH RUBBER B-S-EW JOINT, TYPE "D" (W/ BUSHING IF NECESSARY) PER STD. SPEC., SECTION 503-8.

PROFILE ALIGNMENT AND GRADE OF P.C. 8374
SANITARY SEWERS PAGE 1
CONSTRUCTED IN
R/W 6/8 BONNIE COVE AVENUE
PRIVATE CONTRACT NO. 8374

W.S. 48 6-3
SHEET 2 PAGES
SCALE: VERT. 1"=4' HORIZ. 1"=40'
SEPT. 1969
PREPARED IN THE OFFICES OF
KEAMERER ENGR CO., INC.
6705 SO. PAINTER AVE. WHITTIER, CALIF.
By Robert R. Flores
REG. C. E. NO. 11349
FOR LEGEND SEE PLAN NO. 5-1

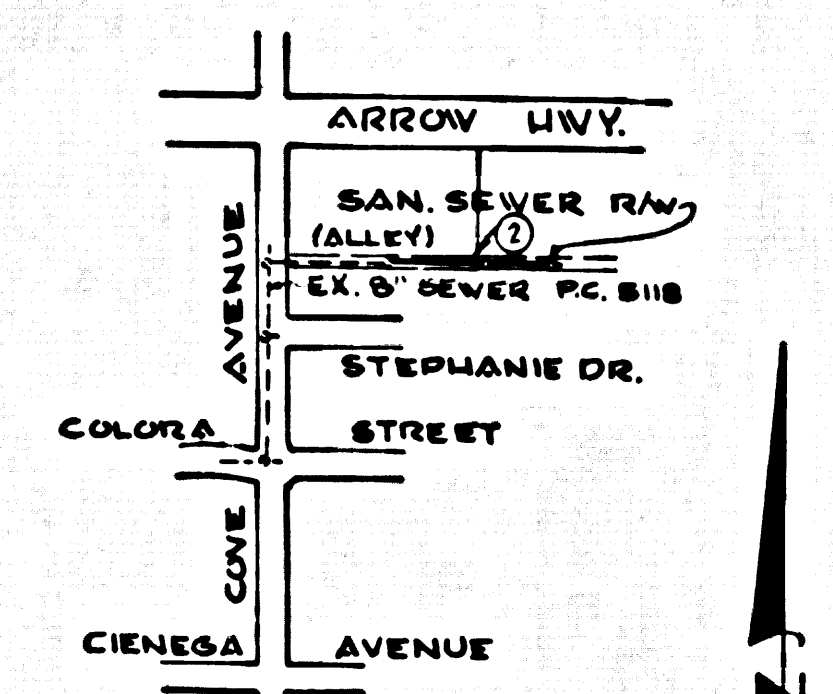

INDEX MAP SCALE: 1"=600'
P.C. No 8374

County Sanitation Districts shall be notified prior to the following so that required inspection can be made (Phone 337-1025 - 400-0077)
Acceptance of the project.

No connections for the disposal of industrial waste shall be made to sewers shown on these drawings without written permission from the Chief Engineer and General Manager of the County Sanitation Districts.

THE FOLLOWING LATEST REVISED STD. PLANSON FILE IN THE OFFICE OF THE COUNTY ENGINEER SHALL APPLY IN THE CONST. OF THIS PROJECT.

LEGEND table listing specifications for Public Safety, Manhole, Precast Concrete, etc.

COLLECT CHARGES AS INDICATED

NOTES: GRADES TO WHICH THIS IMPROVEMENT IS TO BE CONSTRUCTED ARE SHOWN ON PLANS AND PROFILES. GRADE POINTS FOR TOP OF CURBS, CENTER LINE OF STREETS, OR CENTER LINE OF ALLEYS ARE SHOWN BY CIRCLES ON PROFILES. AT ALL POINTS BETWEEN DESIGNATED POINTS THE GRADE SHALL BE ESTABLISHED SO AS TO CONFORM TO A STRAIGHT LINE DRAWN BETWEEN SAID DESIGNATED POINTS. ELEVATIONS ARE IN FEET ABOVE U.S.C. & G.S. SEA LEVEL DATUM OF 1929.

WORK SHALL BE CONSTRUCTED ACCORDING TO THE UNIFORM STANDARD SPECIFICATIONS FOR PUBLIC WORKS CONSTRUCTION 1967 EDITION WITH 1968 AND 1969 SUPPLEMENTS AND COUNTY ENGINEER SPECIAL PROVISIONS DATED JAN. 8, 1969 AND SHALL BE PROSECUTED ONLY IN THE PRESENCE OF THE COUNTY ENGINEER.

APPROVED BY: J.D. Parkhurst, Chief Engineer
APPROVED BY: J.D. Parkhurst, Chief Engineer
CHECKED BY: Ralph Schaefer 3/20/70
REG. C.E. NO. 13496
41698
J.N. 0370.12

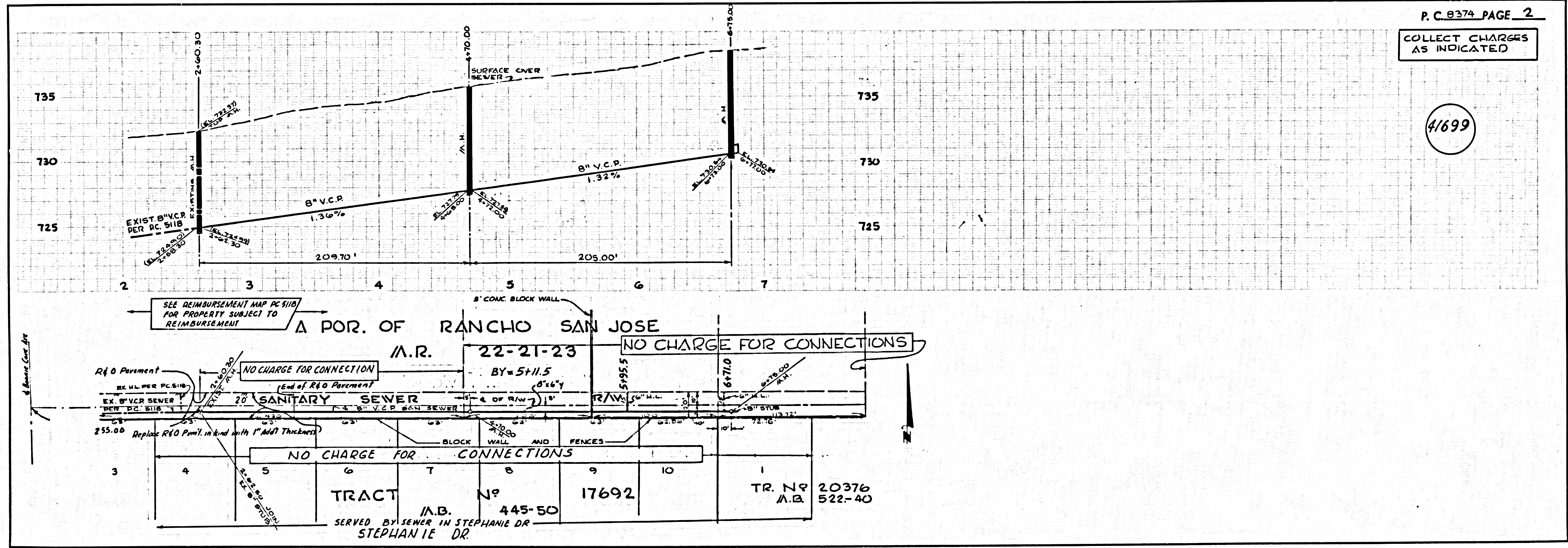

P.C. 8374 PAGE 2
COLLECT CHARGES AS INDICATED

41698