

THE FOLLOWING LATEST REVISED STANDARD PLANS OF FILED IN THE OFFICE OF THE COUNTY ENGINEER SHALL APPLY IN THE CONSTRUCTION OF THIS PROJECT

County Engineer, District 23 is notified prior to the following so that required inspection can be made (Phone 337-1023 - 408-1161)

No connections for the placement of industrial wastes shall be made to sewers shown on these drawings without written permission from the Chief Engineer and General Manager of the County Reclamation District.

REVISION NO. 1 (Date) 4-17-12

1. DELETED LOT NUMBERS
2. RELOCATED HOUSE TEES AND CHIMNEYS

APPROVED Thomas C. Clarke
Office of County Engineer/RE.NO. 19156

LA FUENTE BLDG. DIST. NO. 20

PROFILE ALIGNMENT AND GRADE OF
SANITARY SEWERS PAGE 1
TO BE CONSTRUCTED IN

TRACT NO 31220

PRIVATE CONTRACT NO. 8896

W.S. 38-C2
2 SHEETS, 4 PAGES
SCALE: HORIZ. 1" = 40', VERT. 1" = 4'

PREPARED BY THE OFFICE OF
EL PEARSON AND ASSOCIATES
3825 WEST WASHINGTON AVE., SANTA ANITA, CALIF. 91761
PHONE (714) 503-2003
REG. C.E. NO. 9757

FOR LEGEND SEE PLAN NO. S-1

COUNTY OF LOS ANGELES, CALIFORNIA
HARVEY T. SWANSON COUNTY ENGINEER
APPROVED BY: Thomas C. Clarke
REG. C.E. NO. 9757

J.N. 0230.01

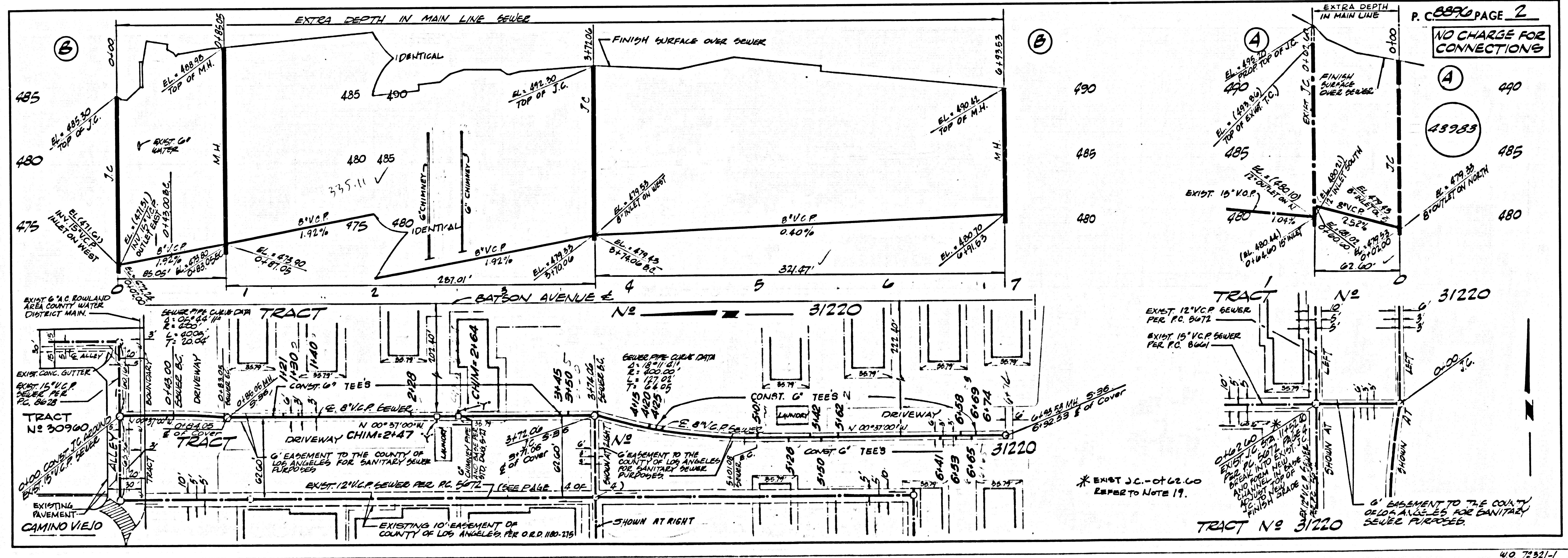

LA COUNTY ENGINEER SHEET NO. 1

410 7521-1

