

B.M. B.G. 202 - ELEV. 393.271
 LEAD STACK IN CENTER OF CURB
 RETURN OF MAYDEE ST. &
 CALIFORNIA AVE.
 CCVINA QUAD. 19.70

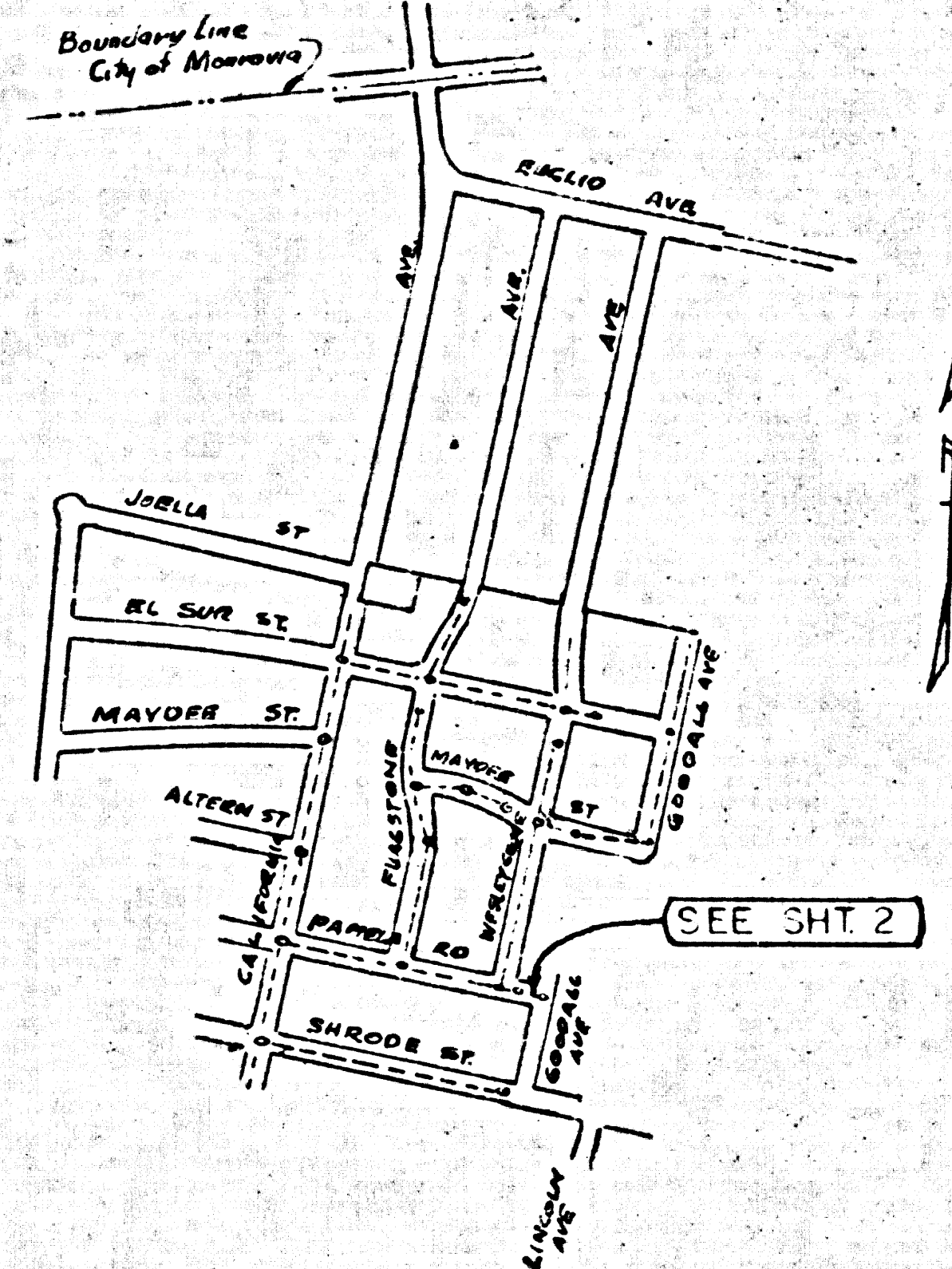

VICINITY MAP
 C.C. 8999
 SCALE: 1" = 600'

No connections for the proposed
 industrial wastes shall be made to
 the sewer system to be shown on
 this plan without written permission
 of the County Sanitation District
 Engineer and District Engineer
 at the County Sanitation District
 742-6602
 ACCEPTANCE OF THE PLAN

GENERAL NOTES:

1. REVISIONS ARE IN RED UNLESS INDICATED OTHERWISE.
2. NO REVISIONS SHALL BE MADE IN THESE PLANS WITHOUT THE APPROVAL OF THE COUNTY ENGINEER.
3. NO REPRESENTATIVE OF THE COUNTY ENGINEER WILL SURVEY OR LAY OUT ANY PORTION OF THE WORK.
4. GRADES TO WHICH THIS IMPROVEMENT IS TO BE CONSTRUCTED ARE SHOWN ON PLANS AND PROFILES. GRADE POINTS FOR TOP OF CURB, CENTER LINE OF STREET, OR CENTER LINE OF ALLEY ARE SHOWN BY CIRCLES ON PROFILES. AT ALL POINTS BETWEEN DESIGNATED POINTS THE GRADE SHALL BE ESTABLISHED SO AS TO CONFORM TO A STRAIGHT LINE DRAWN BETWEEN SAID DESIGNATED POINTS.
5. THE PRIVATE ENGINEER SHALL FURNISH THE COUNTY ENGINEER WITH GRADE SHEETS AND STATIONING FOR ALL HOUSE LATERALS AND "T" OR "T" BRANCHES AND SHALL PROVIDE STAKES FOR THEM AT THEIR PROPER LOCATIONS WITH STATIONING PLAINLY MARKED. ALL HOUSE LATERALS SHALL BE CONSTRUCTED IN A STRAIGHT ALIGNMENT AT RIGHT ANGLES FROM THE MAIN LINE SEWER EXCEPT AS SHOWN ON THE PLANS. HOUSE LATERALS FROM CHIMNEYS SHALL NOT HAVE AN ANGLE OF LESS THAN 45° WITH THE MAIN LINE SEWER. ANY CHANGE IN ALIGNMENT SHALL BE REQUESTED IN WRITING BY THE PRIVATE ENGINEER.
6. THE PRIVATE ENGINEER SHALL FURNISH THE HOUSE LATERAL DEPTH AT THE PROPERTY LINE BELOW THE TOP OF CURB ELEVATION FOR EACH HOUSE LATERAL ON THE GRADE SHEET.
7. BEFORE WORK CAN BE STARTED, THE CONTRACTOR MUST OBTAIN A PERMIT TO EXCAVATE FROM THE L. A. COUNTY ROAD DIST., DISTRICT OFFICE NO. 1.
8. IF WORK IS TO BE DONE IN A STATE HIGHWAY, A PERMIT MUST BE OBTAINED FROM THE STATE OF CALIFORNIA, DIVISION OF HIGHWAYS, 300 SOUTH SPRING STREET, LOS ANGELES, CALIFORNIA.
9. APPROVAL OF THIS PLAN BY THE COUNTY OF LOS ANGELES DOES NOT CONSTITUTE A REPRESENTATION AS TO THE ACCURACY OF THE LOCATION OF OR THE EXISTENCE OR NON-EXISTENCE OF ANY UNDERGROUND UTILITY PIPE, OR STRUCTURE WITHIN THE LIMITS OF THIS PROJECT. THIS NOTE APPLIES TO ALL PAGES.
10. REFER TO SECTION 2-1.4.1 OF THE STANDARD SPECIFICATIONS, REGARDING SAFETY CORDS.
11. PRIOR TO TRENCH EXCAVATION, THE CONTRACTOR SHALL SUBMIT TO AND OBTAIN APPROVAL FROM THE COUNTY ENGINEER OF A DETAILED PLAN SHOWING THE DESIGN OF SHORING, BRACING, SLOPING OR OTHER PROVISIONS FOR WORKER PROTECTION FROM CAVING GROUND. IF SUCH PLAN VARIES FROM THE SHORING SYSTEM STANDARDS ESTABLISHED BY THE CONSTRUCTION SAFETY ORDERS, IT SHALL BE PREPARED BY A REGISTERED CIVIL OR STRUCTURAL ENGINEER.

CONSTRUCTION NOTES:

1. WORK SHALL BE CONSTRUCTED ACCORDING TO THE STANDARD SPECIFICATIONS FOR PUBLIC WORKS CONSTRUCTION (1970 EDITION) WITH THE SUPPLEMENTS AND COUNTY ENGINEER SPECIAL PROVISIONS FOR THE CONSTRUCTION OF SANITARY SEWERS DATED APRIL, 1972. THIS NOTE APPLIES TO ALL PAGES.
2. THE CONTRACTOR SHALL NOTIFY THE CONSTRUCTION DIVISION BY TELEPHONE, 974-7285, AT LEAST TWENTY-FOUR HOURS BEFORE STARTING ANY WORK UNDER THIS CONTRACT.
3. HOUSE LATERALS TO BE CONSTRUCTED WITH INVERTS AT PROPERTY LINE 4 FEET BELOW CURB GRADE EXCEPT AS NOTED.
4. "T" OR "T" BRANCHES MAY BE USED FOR CONNECTIONS TO MAINLINE SEWERS EXCEPT AS NOTED.
5. ALL STRUCTURES SHALL BE EITHER BRICK MANHOLES PER S-24 OR PRECAST CONCRETE MANHOLES PER S-24, EXCEPT AS NOTED.
6. PROVIDE STAKES ON THE PROPERTY LINE OR PROPERTY LINES PRODUCED AT RIGHT ANGLES TO THE SEWER LINE AT THE CENTER LINE OF EACH MANHOLE.
7. MANHOLE TOPS IN UNIMPROVED RIGHTS-OF-WAY TO BE SIX INCHES ABOVE FINISHED GRADE.
8. VITRIFIED CLAY PIPE JOINTS SHALL BE TYPE "B", "F", OR "G" PER STANDARD SPECIFICATIONS SECTION 308.3.
9. IF A POWER POLE IS WITHIN THREE FEET OF THE SEWER, THE SEWER SHALL BE ENCASED, PER S-23, CASE II, TWO FEET ON EACH SIDE FROM THE POINT OF INTERFERENCE.
10. IF DURING THE COURSE OF CONSTRUCTION IT IS DETERMINED THAT THERE IS LESS THAN FOUR FEET OF COVER OVER THE TOP OF A MAIN LINE OR HOUSE LATERAL V.C.P. SEWER WHICH IS NOT INDICATED ON THE PLANS, THE PIPE SHALL BE ENCASED PER S-23, CASE II UNLESS OTHERWISE APPROVED BY THE COUNTY ENGINEER.
11. ALL JOINTS BETWEEN CAST IRON PIPE AND VITRIFIED CLAY PIPE SHALL BE MADE WITH A RUBBER SLEEVE JOINT, TYPE "C" OR "D", WITH RUSHING IF NECESSARY PER STANDARD SPECIFICATIONS, SECTION 308.2.
12. SEWERS TO BE TESTED FOR LEAKAGE PER SECTION 306.1.3.2 OF THE STANDARD SPECIFICATIONS AND SPECIAL PROVISIONS.
13. RESURFACE ALL TRENCHES WITHIN PAVED AREAS TO MEET L.A. COUNTY ROAD DIST. OR CALIFORNIA STATE HIGHWAY REQUIREMENTS IN ACCORDANCE WITH SECTION 306.1.1.1 OF THE SPECIAL PROVISIONS. FINAL STREET RESURFACING IN ANY LOCATION SHALL BE COMPLETED WITHIN 10 DAYS AFTER COMPLETION OF TRENCH BACKFILL. THE RESURFACED AREA SHALL BE SEALED WITH 6% EMULSION AND 1/2" CRUSHED ROCK. RESURFACING SCHEDULE: RESURFACE TRENCH WITHIN PAVED AREA WITH TYPE II ASPHALTIC CONCRETE 4 INCHES THICKNESS ON 9" OF AGGREGATE BASE. BASE MATERIALS

PROFILE, ALIGNMENT AND GRADE OF
SANITARY SEWERS PAGE 1

TO BE CONSTRUCTED IN
 PAMELA ROAD
 CAPITOL PROJECT 8289.02

REFERENCE
 CASH CONTRACT NO. 8999

W.S. 46
 1 SHEETS, 2 PAGES

SCALE: VERT. 1" = 4'
 HORIZ. 1" = 20' AUG. 13, 1973

PREPARED IN THE OFFICES OF
PULVER-SCHWEICKERT, INC.
 BY *James Schweickert*
 REG. C.E. No. 10453

THE FOLLOWING LATEST REVISED STANDARD PLANS ON FILE IN THE OFFICE OF THE COUNTY ENGINEER SHALL APPLY IN THE CONSTRUCTION OF THIS PROJECT.

LEGEND	51
MINIMUM PUBLIC SAFETY REQUIREMENTS	52
BRICK MANHOLE	53
STANDARD MANHOLE STEP	517
BEDDING FOR SEWER PIPE	521
CHASING AND BACKFILL	522
WYE OR TEE SUPPORT	526
ALLOWABLE TRENCH WIDTHS	528
LOCKING MANHOLE FRAME AND COVER	530
NON-REINFORCED PRECAST CONCRETE MANHOLE	536

44466

COUNTY OF LOS ANGELES, CALIFORNIA
 HARVEY T. BRANDT, COUNTY ENGINEER
 JOHN D. PARKHURST, CHIEF ENGINEER

APPROVED *Richard W. Con* ASST. DIVISION ENGINEER
 APPROVED *R. D. Parkhurst* OFFICE ENGINEER

CHECKED *Kay*
 REG. C.E. NO. 17416

TEMPLE CITY BLDG. DIST. 5 J.N. 8289.02

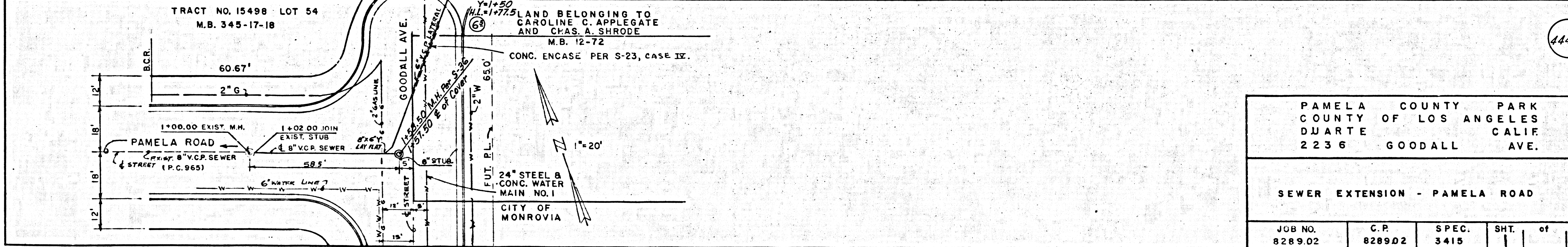
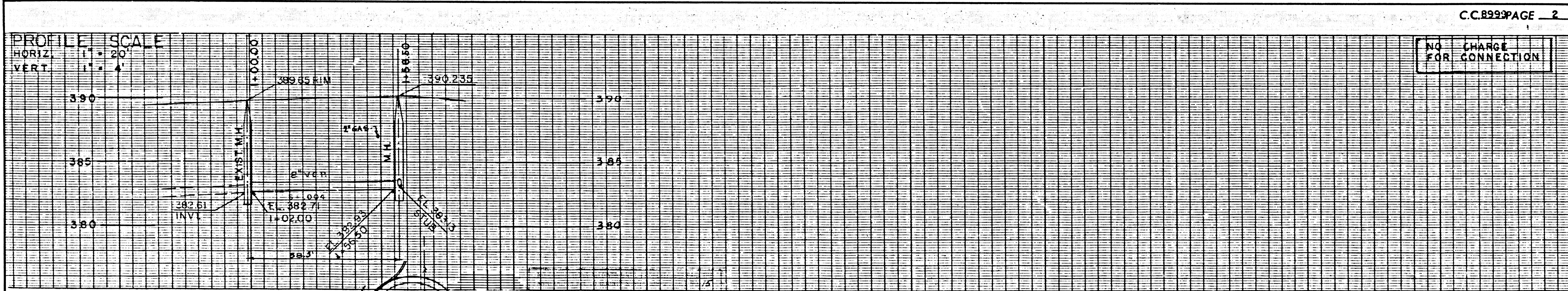

PAMELA COUNTY PARK
 COUNTY OF LOS ANGELES
 DUARTE CALIF.
 2236 GOODALL AVE.

SEWER EXTENSION - PAMELA ROAD

JOB NO.	C.P.	SPEC.	SHT.	of	SHTS.
8289.02	8289.02	3415	1		1