

PROFILE  
 SCALES: HORIZ. 1" = 40'  
 VERT. 1" = 4'

U.S.S.A. 2030 - E.C. 134.040 - F.B. 3171.4  
 VAN WICK ST. 5' 5" 500'  
 VAN WICK ST. 5' 5" 500'

**NOTICE TO CONTRACTOR**

THE EXISTENCE AND LOCATION OF ANY UNDERGROUND UTILITY PIPES OR STRUCTURES SHOWN ON THESE PLANS ARE DEEMED TO BE CORRECT BY THE AVAILABLE RECORDS. FOR THE LACK OF SUCH KNOWLEDGE THERE ARE NO ASSUMED UTILITIES EXCEPT AS NOTED ON THIS MAP. THE CONTRACTOR IS REQUIRED TO TAKE PRECAUTIONARY MEASURES TO PROTECT THE UTILITY LINES SHOWN AND ANY OTHER LINES NOT OF RECORD OR NOT SHOWN ON THIS DRAWING.

**GENERAL SEWER NOTES**

1. REFER TO SECTION 7-10.1.1 OF STANDARD SPECIFICATIONS REGARDING SAFETY SIGNALS.
2. "D" OR "E" BRANCHES MAY BE USED FOR CONNECTIONS TO MAIN LINE SEWERS, EXCEPT AS NOTED.
3. VITRIFIED CLAY PIPE JOINTS SHALL BE TYPE "D" OR "E" PER SECTION 7-10.1.1 OF STANDARD SPECIFICATIONS.
4. SEWERS TO BE TESTED TO A LEAKAGE PER SECTION 7-10.1.1 OF STANDARD SPECIFICATIONS AND SPECIAL PROVISIONS.
5. ALL TRENCHES SHALL BE 18" WIDER THAN THE SEWER PIPE UNLESS OTHERWISE SPECIFIED FOR 1/2" CASE. IN THIS CASE, 18" FEET IN EACH SIDE FROM THE POINT OF INTERFERENCE.
6. ALL PIPES OF STANDARD DEPTH EXCEPT VITRIFIED CLAY PIPE, EXCEPT AS NOTED.
7. NO INVESTIGATIONS SHALL BE MADE TO THESE PLANS WITHOUT THE APPROVAL OF THE COUNTY ENGINEER.
8. ALL SEWER PIPES AND APPROPRIATE MANHOLES SHALL BE ADJUSTED TO BE BELOW THE FINISHED GRADE WITH SECTIONS BELOW THE FINISHED GRADE.
9. THE CONTRACTOR SHALL MAINTAIN SEWER SERVICE AT ALL TIMES DURING CONSTRUCTION OF MAINLINE SEWER.
10. WORK SHALL BE CONSIDERED COMPLETE WHEN THE STANDARD SPECIFICATIONS FOR PUBLIC WORKS CONSTRUCTION 1974 EDITION HAVE BEEN MET.
11. THE CONTRACTOR SHALL MAINTAIN ALL EXISTING MANHOLES AND SHALL BE RESPONSIBLE FOR THE PROTECTION OF ALL EXISTING MANHOLES.
12. ALL MANHOLES SHALL BE EITHER 18" OR 24" IN DIAMETER UNLESS OTHERWISE SPECIFIED AS NOTED.
13. ALL MANHOLES SHALL BE EITHER 18" OR 24" IN DIAMETER UNLESS OTHERWISE SPECIFIED AS NOTED.
14. USE LEAKING MANHOLE FRAME AND COVER PER 7-10.1.1 EXCEPT AS NOTED.

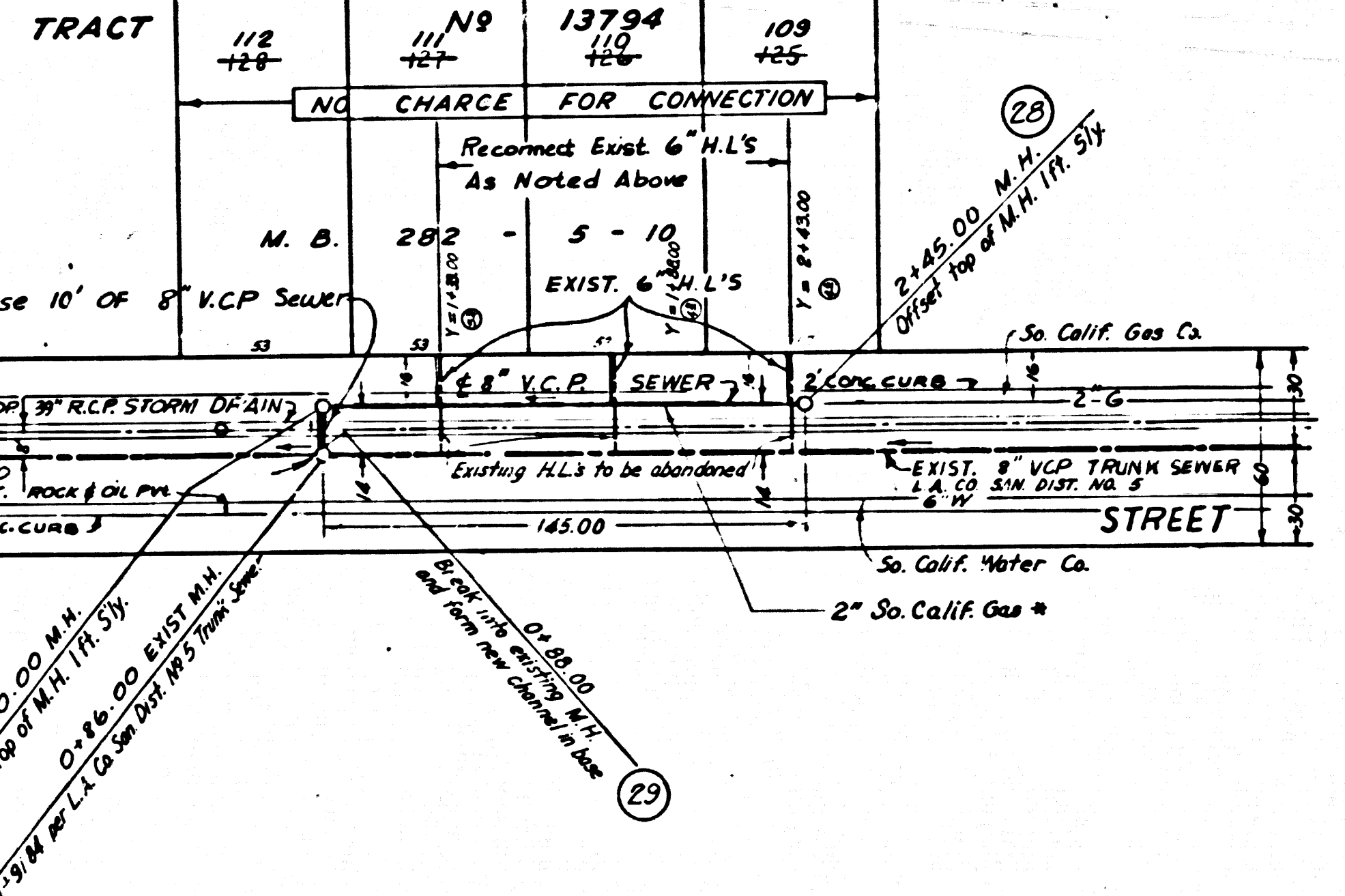
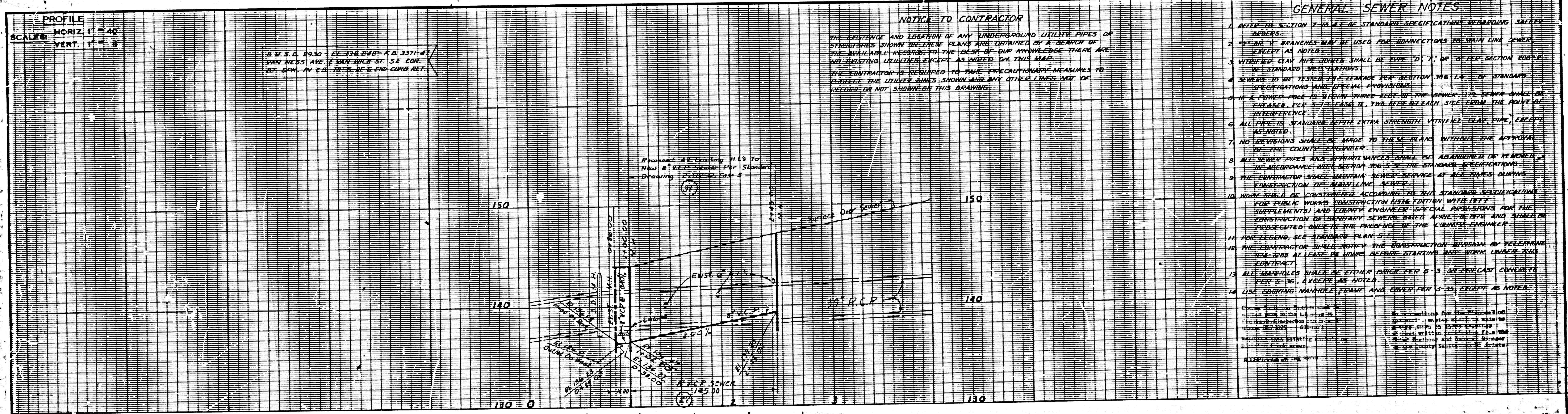

- THE FOLLOWING LATEST REVISED STANDARD PLANS ON FILE IN THE OFFICE OF THE COUNTY ENGINEER SHALL APPLY IN THE CONSTRUCTION OF THIS PROJECT.
- LEGEND:
- 3-1 MINIMUM PUBLIC SAFETY REQUIREMENTS
  - 3-2 BRICK MANHOLE
  - 3-3 STANDARD MANHOLE STEP
  - 3-17 BEDDING FOR SEWER PIPE
  - 3-23 CRDING AND ENCASMENT
  - 3-26 WYE OR TEE SUPPORT
  - 3-33 ALLOWABLE TRENCH WIDTHS
  - 3-35 LOCKING MANHOLE FRAME AND COVER
  - 3-36 NON-REINFORCED PRECAST CONCRETE MANHOLE

REVISIONS

NO.	DATE	DESCRIPTION

PLAN SCALE: 1" = 40'

APPROVED  
 JOHN D. PARKHURST  
 COUNTY ENGINEER

PREPARED BY  
 HARVEY T. BRANDT  
 COUNTY ENGINEER  
 RECOMMENDED BY  
 CC 9001

1970 STORM DRAIN BOND ISSUE  
 LOS ANGELES COUNTY FLOOD CONTROL DISTRICT  
 ATHENS  
 PROJECT NO. 1254  
 UNIT 3 LINE A  
 SANITARY SEWER RECONSTRUCTION

45,269