

MAP SCALE: 1" = 40'

MAP SCALE: 1" = 40'

B.M. K.M.-56 Elev. 24.122 F.B. 1975-20  
Maplewood Ave. & Ardis Ave. NW Corner  
Bt. Spk. in Curb 60' W. of W. end of C.R.

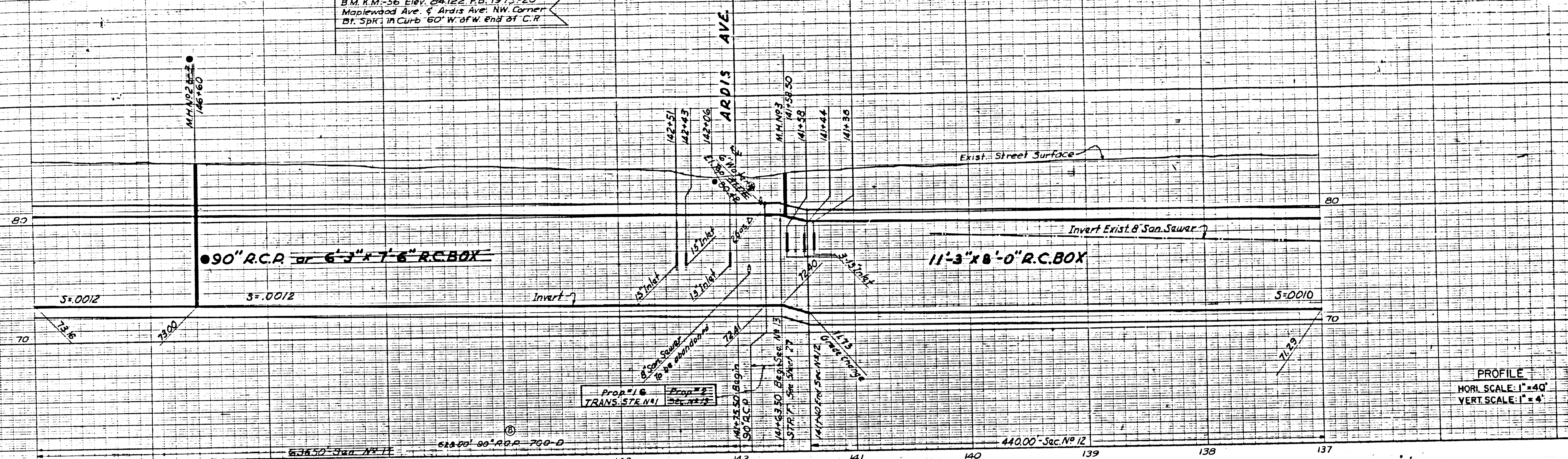

PROFILE  
HORI. SCALE: 1" = 40'  
VERT. SCALE: 1" = 4'

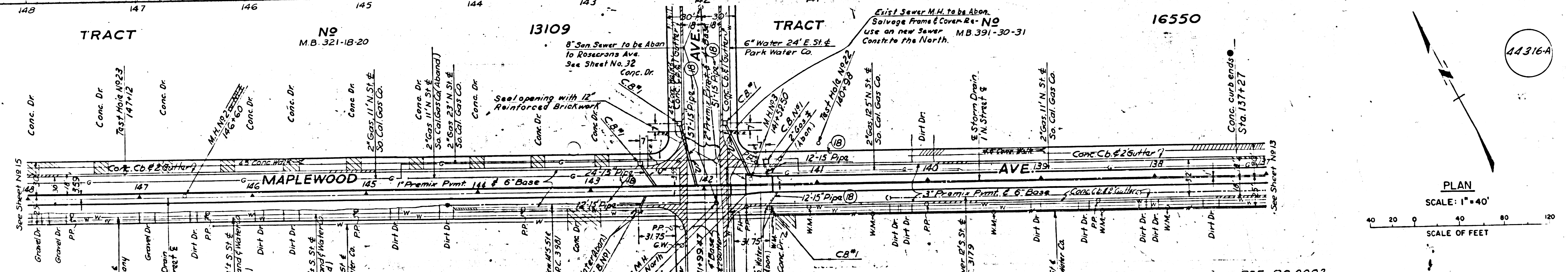

PLAN  
SCALE: 1" = 40'  
SCALE OF FEET

TRACT NO 13109 M.B. 321-18-20  
TRACT NO 16550  
TRACT NO 5084 M.B. 54-71-12

8" Sewer to be Abon. to Rosemont Ave See Sheet No. 32  
8" Water 24' E St. & Park Water Co.  
Exist. Sewer M.H. to be Abon. Salvage Frame & Cover. Re-Use as new Sewer M.B. 391-30-31 Constr. to the North.141+75.50 Begin 90" R.C.P. TRANS. STR. NO. 1  
141+63.50 Beg. Sec. No. 13  
141+40 End Sec. No. 12  
141+83.50  
141+75.50 Begin 90" R.C.P. TRANS. STR. NO. 1  
141+63.50 Beg. Sec. No. 13  
141+40 End Sec. No. 12  
141+83.50

NOTE  
Resurface trenches within the paved area of MAPLEWOOD AVE. from station 127+00 to station 142+00 with 6 inches of aggregate base material, Type A, 4 inches of premix pavement.  
Resurface trenches within the paved area of MAPLEWOOD AVE. from station 142+00 to station 154+08 with 6 inches of aggregate base material, Type A, 2 inches of premix pavement.

REF. PC. 9002

PREPARED BY <b>JOHN A. LAMBIET</b> COUNTY ENGINEER  RECOMMENDED BY <i>C.H. Green</i> COUNTY ENGINEER CHECKED BY <i>P. Augustine</i> DRAWN BY <i>H. Zaharson</i> DATE <i>Nov. 9, 1956</i>	COUNTY STORM DRAIN BOND ISSUE REVISIONS MARK DATE DESCRIPTION ● 5-28-59 As Built		LOS ANGELES COUNTY FLOOD CONTROL DISTRICT  PROJECT NO. 16 - LINE A <b>CERRITOS-MAPLEWOOD</b> CONCRETE CONDUIT STA. 137+00 TO STA. 148+00 PLAN AND PROFILE  APPROVED BY <i>John A. Lambiet</i> COUNTY ENGINEER SCALE DATE NO. 181-16-D4.14 AS SHOWN OCT. 1956 SHEET 14 OF 36
	REF. PC. 9002		

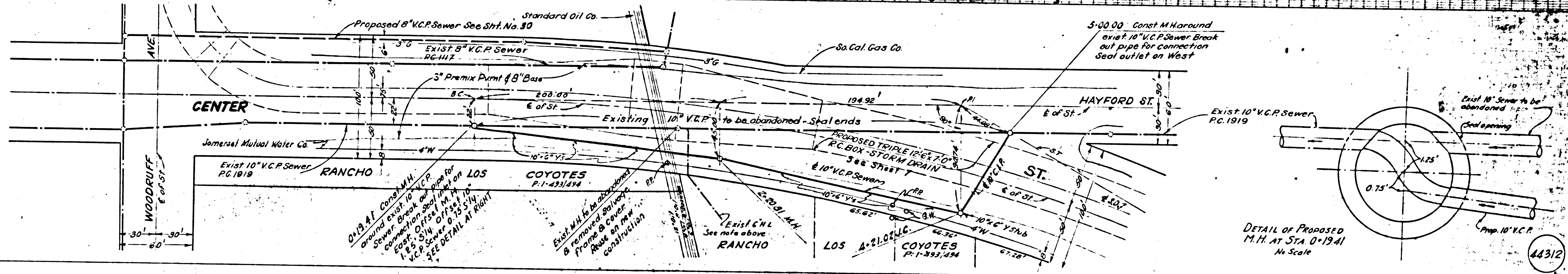
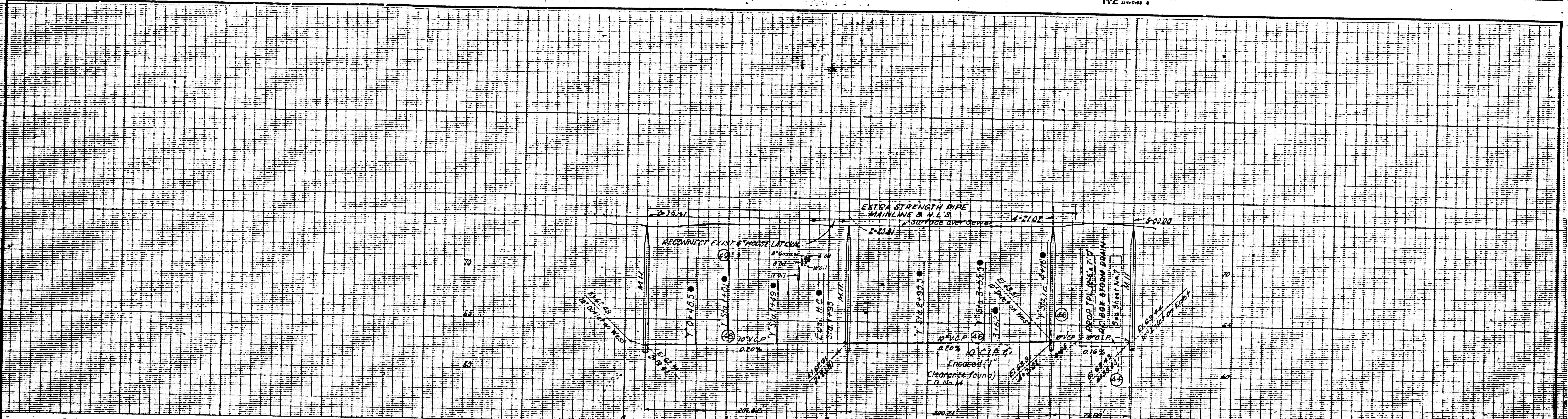

**GENERAL NOTES**  
(To apply to sheets 29 thru 33)

1. For Legend see Std. Plan S-a-64.
2. Use Std. Strength vitrified clay pipe except as noted.
3. Use Cement mortar for all vitrified clay pipe joints.
4. All structures shall be brick sewer structures as per Std. Plan S-a-104.
5. Use Std. M.H. frame and cover as per Std. Plan S-a-117.
6. Abandoned sewers shall be sealed with brick and cement mortar.
7. Use Formula No. 1, Sec. 54, of Std. Specifications to compute allowable leakage.
8. Resurface trenches within the paved areas of streets as noted on the Storm Drain Plans, unless otherwise shown.

**P.C. 9002 REF. ONLY**

PREPARED BY  
**JOHN A. LAMBIE**  
COUNTY ENGINEER

RECOMMENDED BY  
*[Signature]*  
SANITATION ENGINEER

DESIGNED BY: T.A. WOOD  
CHECKED BY: J.A. WOOD  
DRAWN BY: L.S. FINEGAN  
APPROVED BY: H.E. BROWN

REVISIONS	
MARK	DESCRIPTION
●	5-25-59 As Built

W 5 33  
**LOS ANGELES COUNTY  
FLOOD CONTROL DISTRICT**

PROJECT NO. 16 - LINE A  
**CERRITOS-MAPLEWOOD  
SANITARY SEWER  
RECONSTRUCTION  
PLAN AND PROFILE**

APPROVED BY: *[Signature]*  
DATE: **NOV 18 1959**  
SHEET 29 OF 36

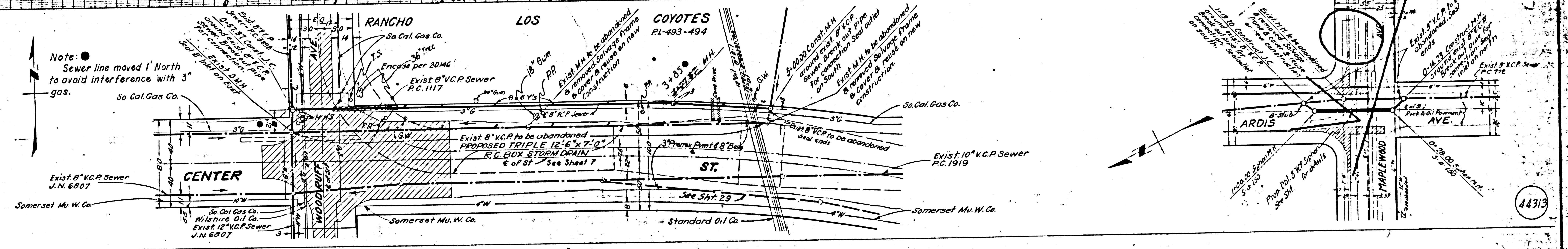
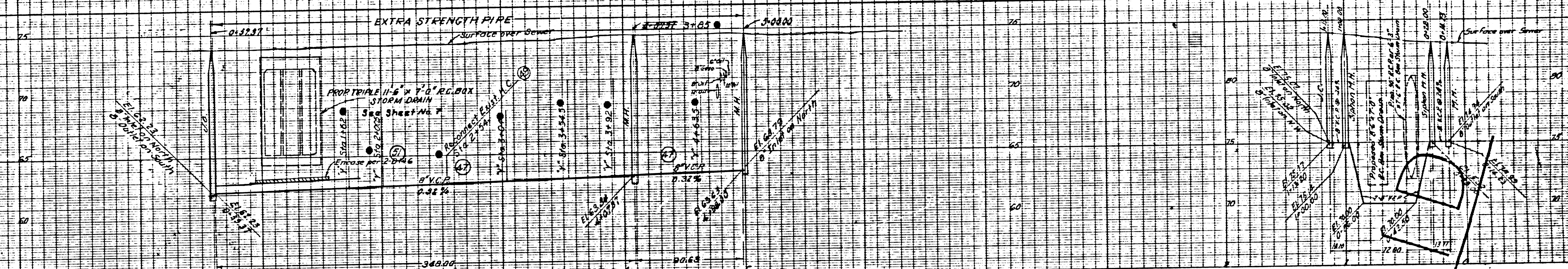

**P.C. 9002 REF ONLY**

PREPARED BY  
**JOHN A. LAMBIE**  
COUNTY ENGINEER

RECOMMENDED BY  
*[Signature]*  
SANITATION ENGINEER

REVISIONS		
MARK	DATE	DESCRIPTION
●	5-25-59	As Built

PROJECT NO. 16 - LINE A  
**CERRITOS-MAPLEWOOD**  
SANITARY SEWER  
RECONSTRUCTION  
PLAN AND PROFILE

APPROVED BY  
*[Signature]*  
CHIEF ENGINEER

SCALE: HORIZONTAL 1" = 40.00' VERTICAL 1" = 4.00'

DATE: **NOV 16 1959**

NO. 181-16-D4.50

1959 JAN 30 OP. 36

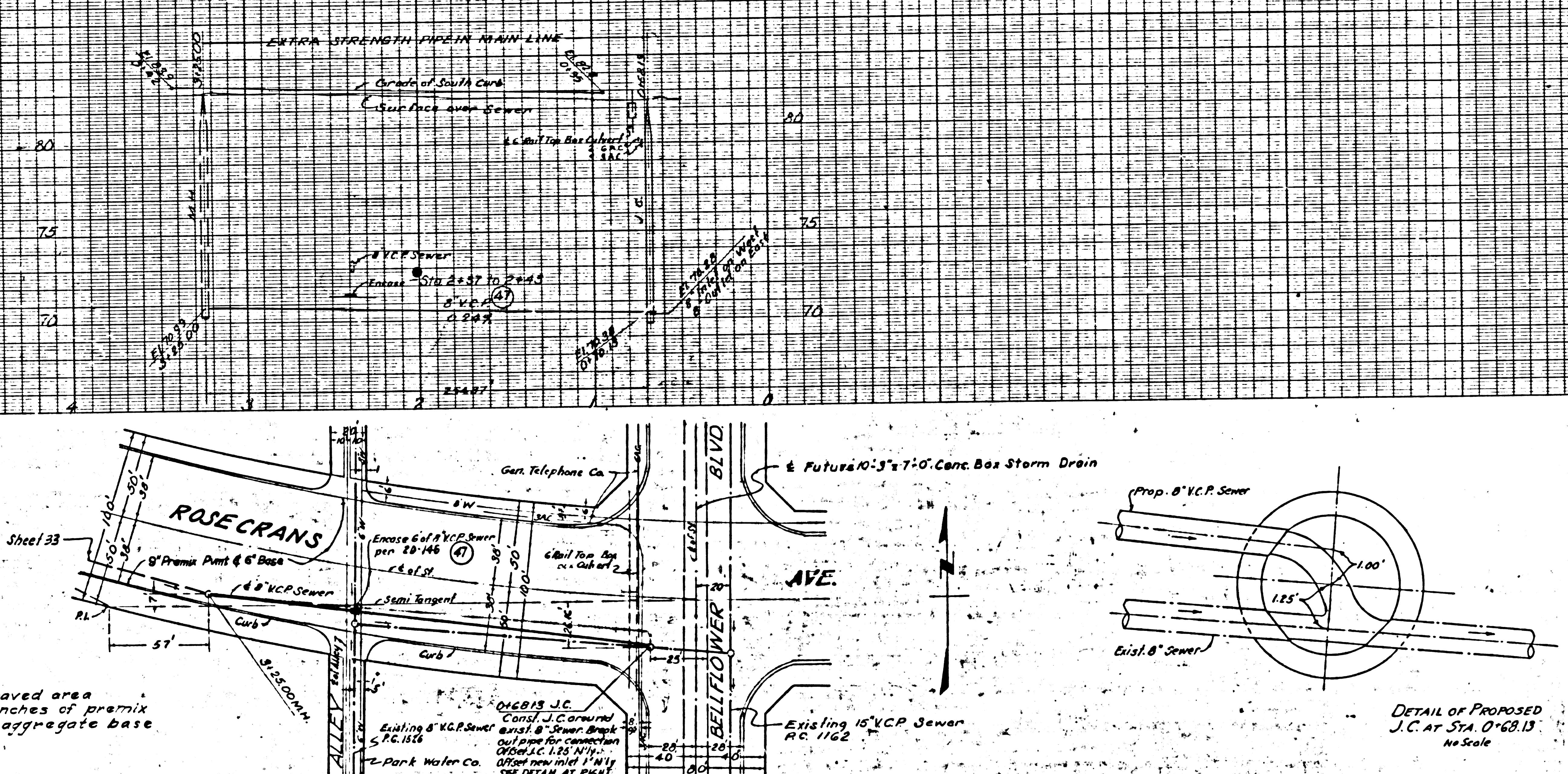

Note: Resurface trenches within paved area of Rosecrans Ave. with 10 inches of premix pavement and 6 inches of aggregate base material, Type A.

DETAIL OF PROPOSED J.C. AT STA. 0+68.13  
No Scale

44314

<b>PC.9002 REF. ONLY</b>		COUNTY STORM DRAIN BOND ISSUE		W 5 33	
PREPARED BY <b>JOHN A. LAMBIE</b> COUNTY ENGINEER		REVISIONS MARK DATE DESCRIPTION ● 5-23-59 As Built		LOS ANGELES COUNTY FLOOD CONTROL DISTRICT	
RECOMMENDED BY <i>[Signature]</i> COUNTY ENGINEER'S ASSISTANT		DRAWN BY CHECKED BY APPROVED BY <i>[Signature]</i>		PROJECT NO: 16 - LINE A <b>CERRITOS MAPLEWOOD          SANITARY SEWER          RECONSTRUCTION          PLAN AND PROFILE</b>	
DRAWN BY B. VALASKY CHECKED BY W. H. B. J. APPROVED BY J. S. BROWN		DRAWN BY B. VALASKY CHECKED BY W. H. B. J. APPROVED BY J. S. BROWN		DATE: NOV 16 1951 SHEET 31 OF 36	

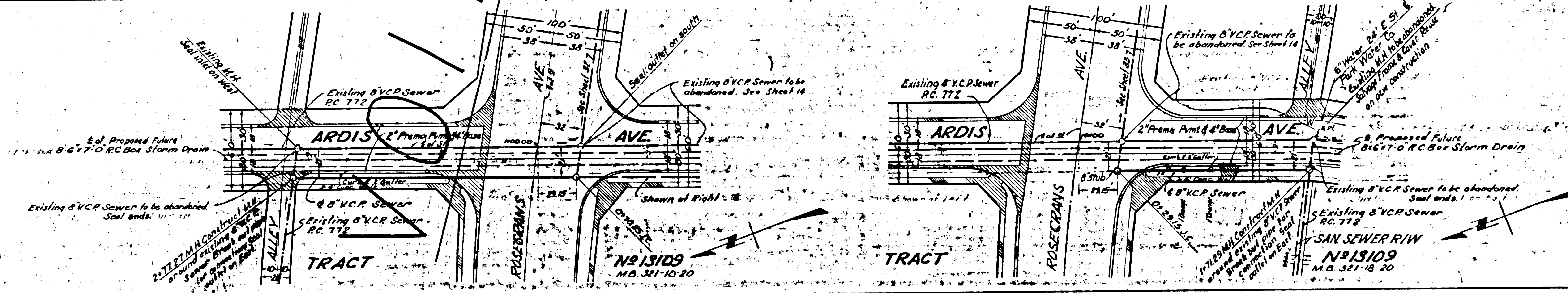
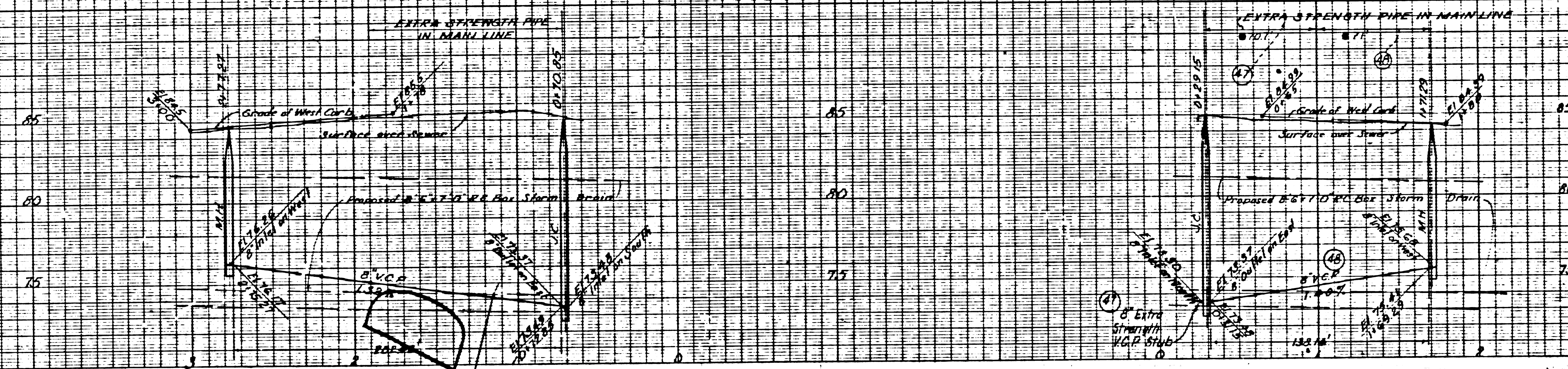

NOTE  
Grade of Proposed Future Storm Drain  
as per conference with Construction  
and Storm Drain Division Aug 8, 1956

<b>PG. 9002 REF. ONLY</b>		COUNTY STORM DRAIN BOND ISSUE		W.S. 33
PREPARED BY <b>JOHN A. LAMBIE</b> COUNTY ENGINEER	REVISIONS MARK DATE DESCRIPTION 5-25-59 As Built	LOS ANGELES COUNTY FLOOD CONTROL DISTRICT PROJECT NO. 16 - LINE A CERRITOS-MAPLEWOOD SANITARY SEWER RECONSTRUCTION PLAN AND PROFILE		
RECOMMENDED BY <i>A.P. [Signature]</i>	CHECKED BY <i>[Signature]</i>	APPROVED BY <i>[Signature]</i>	DATE NO. 187-16-D-32	SHEET NO. 187-16-D-32 OF 32

44315

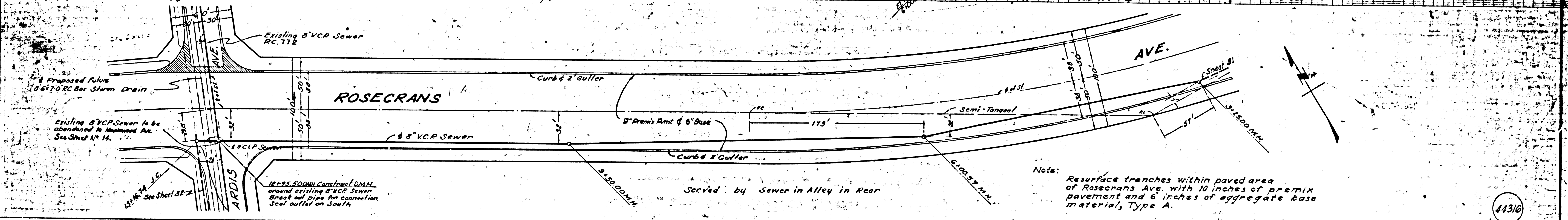
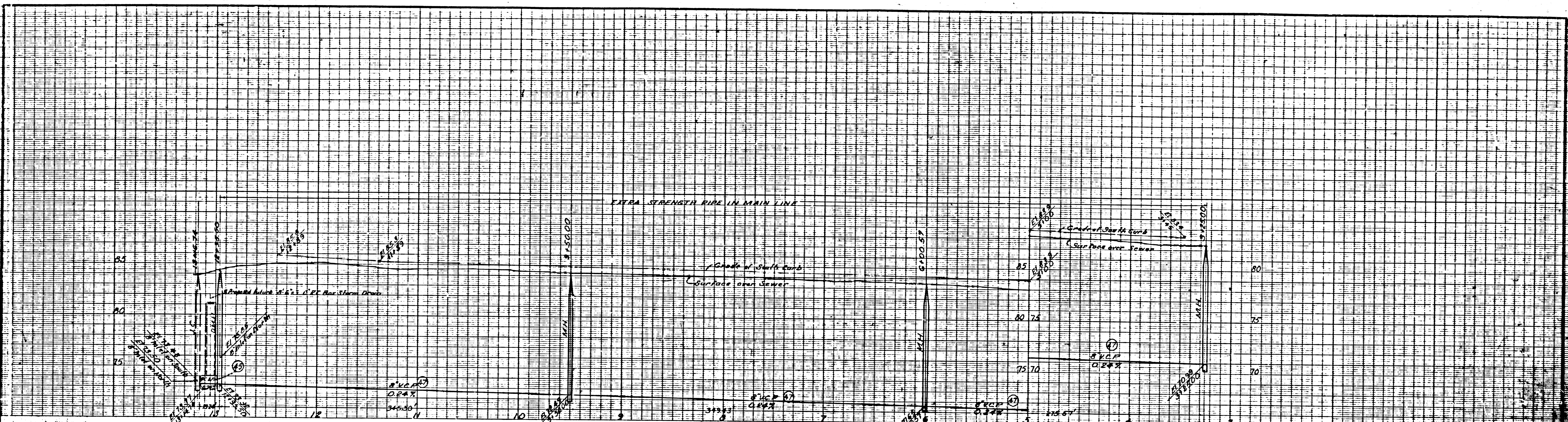

Note: Resurface trenches within paved area of Rosecrans Ave. with 10 inches of premix pavement and 6 inches of aggregate base material, Type A.

44316

<b>P.C. 9002 REF. ONLY.</b>		COUNTY STORM DRAIN BOND ISSUE		W.S. 33
PREPARED BY <b>JOHN A. LAMBIE</b> COUNTY ENGINEER	REVISIONS MARK DATE DESCRIPTION		LOS ANGELES COUNTY FLOOD CONTROL DISTRICT	
RECOMMENDED BY <i>[Signature]</i> CHECKED BY DRAWN BY APPROVED BY	PROJECT NO. 16 - LINE A <b>CERRITOS-MAPLEWOOD</b> SANITARY SEWER RECONSTRUCTION PLAN AND PROFILE		APPROVED <i>[Signature]</i>	