

B.M. 3501 ELEV. 205.423
 80 S.W. 1/4 SEC. 17 T. 4 S. R. 12 E.
 TEMPLE CITY BLVD.
 AREADIA QUAD. 19 10

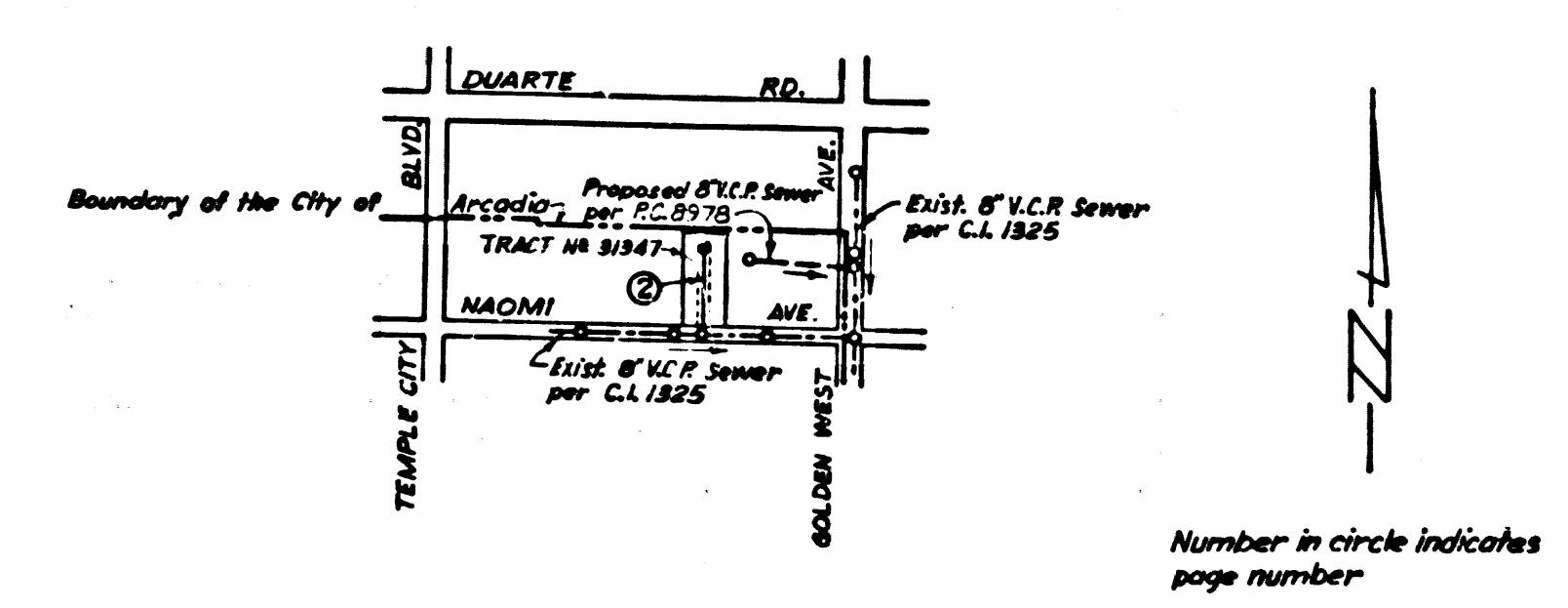

INDEX MAP
 SCALE: 1"=600'
 P.C. 9010

GENERAL NOTES:

1. DEVIATIONS ARE IN FEET ABOVE U.S.C. & G.S. MEAN LEVEL DATUM OF 1929.
2. NO DEVIATIONS SHALL BE MADE IN THESE PLANS WITHOUT THE APPROVAL OF THE COUNTY ENGINEER.
3. THE CONTRACTOR SHALL BE RESPONSIBLE FOR OBTAINING ALL NECESSARY PERMITS FROM THE CITY OF TEMPLE CITY AND THE COUNTY OF LOS ANGELES.
4. GRADES 1" BELOW THE FINISHED GRADE SHALL BE ESTABLISHED AS TO CONFORM TO A STRAIGHT LINE BETWEEN SAID SPECIFIED POINTS.
5. THE PRIVATE ENGINEER SHALL FURNISH THE COUNTY ENGINEER WITH GRADE SHEETS AND STATIONING FOR ALL HOUSE LATERALS AND 75' ON 75' INTERVALS AND SHALL PROVIDE STAKES FOR THEM AT THESE PROPER LOCATIONS WITH STATIONING PLAINLY MARKED. ALL HOUSE LATERALS SHALL BE CONSTRUCTED IN A STRAIGHT ALIGNMENT AT RIGHT ANGLES FROM THE MAIN LINE LINES EXCEPT AS SHOWN ON THE PLANS. HOUSE LATERALS FROM CHIMNEYS SHALL NOT HAVE AN ANGLE OF LESS THAN 45° WITH THE MAIN LINE LINES. ANY OTHER ALIGNMENT SHALL BE SECURED BY WRITING BY THE PRIVATE ENGINEER.
6. THE PRIVATE ENGINEER SHALL FURNISH THE HOUSE LATERAL BOTH AT THE 4" V.P. AND BELOW SURFACE UNDER JACOBS FOR EACH HOUSE LATERAL ON THE GRADE SHEET.
7. BEFORE WORK CAN BE STARTED, THE CONTRACTOR MUST OBTAIN A PERMIT TO EXCAVATE IN COUNTY STREETS FROM THE L.A. COUNTY PUBLIC WORKS DEPARTMENT OFFICE TO BE OBTAINED BY THE CONTRACTOR.

CONSTRUCTION INSPECTION AND RECORD PLANS
 BY: *GABRIEL SALLEY* REGIONAL OFFICE TO COVER THE COST OF THE PROJECT.

CONSTRUCTION NOTES:
 1. WORK SHALL BE CONSTRUCTED ACCORDING TO THE STANDARD SPECIFICATIONS FOR PUBLIC WORKS CONSTRUCTION IN THE COUNTY OF LOS ANGELES AND THE STANDARD SPECIFICATIONS FOR THE CONSTRUCTION OF SANITARY SEWER SYSTEMS, 1974 EDITION, AS AMENDED, AND SHALL BE PROSECUTED ONLY IN THE PRESENCE OF THE COUNTY ENGINEER.

PROFILE, ALIGNMENT AND GRADE OF
SANITARY SEWERS PAGE 1
 TO BE CONSTRUCTED IN
TRACT No. 31347

PRIVATE CONTRACT NO. 9010
 W.S. 44 pg 22
 1 SHEETS, 1 PAGES
 SCALE: HORIZ. 1"=40' VERT. 1"=4'
 JANUARY, 1976
 PREPARED IN THE OFFICES OF
 LORENZ PHILLIPS & ASSOCIATES
 2100 S. GARDEN ST., PASADENA, CALIF. 91107
 BY: *Lorenz Phillips*
 REG. C.E. No. 6004

THE FOLLOWING LATEST REVISED STANDARD PLANS ON FILE IN THE OFFICE OF THE COUNTY ENGINEER SHALL APPLY IN THE CONSTRUCTION OF THIS PROJECT.

| | |
|--|------|
| SEWER | 2.1 |
| MINIMUM PUBLIC SAFETY REQUIREMENTS | 2.2 |
| SEWER MANHOLE | 2.3 |
| STANDARD MANHOLE RING | 2.4 |
| STANDARD FOR SPREAD PIPE | 2.5 |
| CLAMP RING AND ENCLOSURE | 2.6 |
| PIPE OF THE SUPPORT | 2.7 |
| ALUMINUM TRUSS SYSTEM | 2.8 |
| ROCKING MANHOLE FRAMES AND COVERS | 2.9 |
| NON-ANTICORROSION PRECAST CONCRETE MANHOLE | 2.10 |

COUNTY OF LOS ANGELES, CALIFORNIA
 HARVEY T. BERANDELY, COUNTY ENGINEER
 JOHN D. PARKHURST, CHIEF ENGINEER
 APPROVED: *Lorenz Phillips* 1-14-76 REGIONAL ENGINEER
 APPROVED: *James D. ...* ASST. CHIEF ENGINEER
 CHECKED: *Baron ...* 1/10/76
 REG. C.E. No. 10653
 TEMPLE CITY - BLDG. DIST. - 5
 J.N. 0250.02

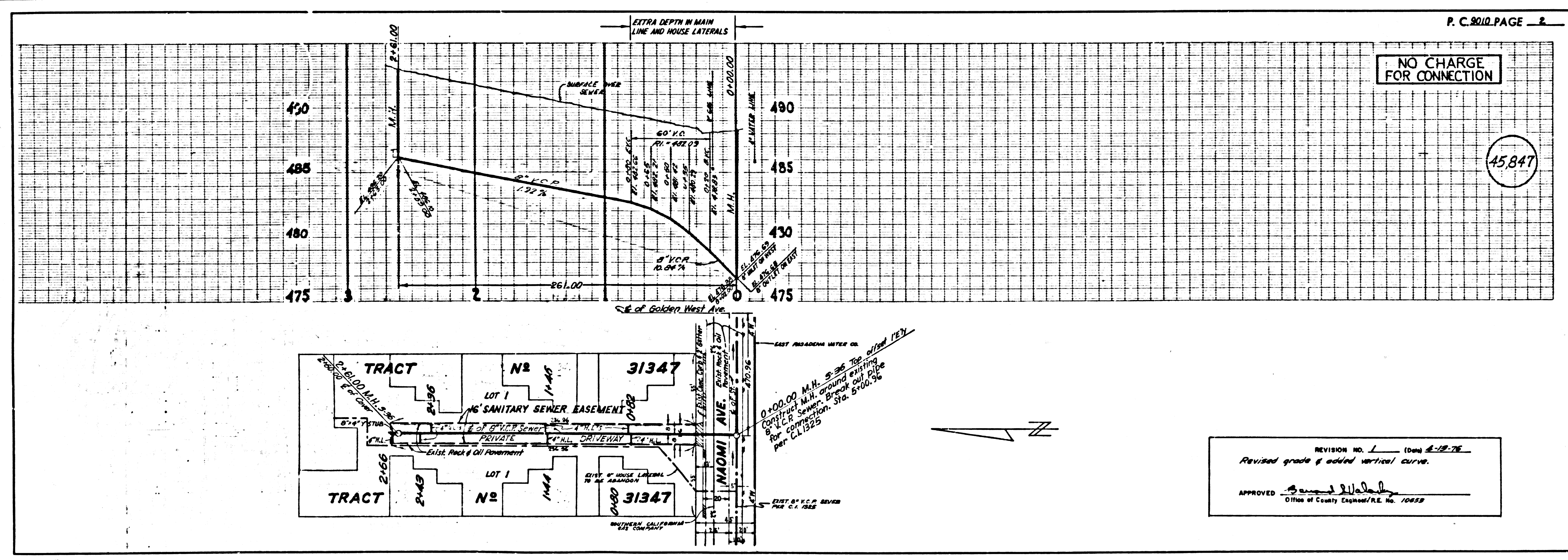

REVISION NO. 1
 Revised grade & added vertical curve.
 APPROVED: *Baron ...*
 Office of County Engineer/FILE NO. 10653

L.A. COUNTY SEWER SHEET NO. 1 SOUTHERN CALIFORNIA BLUEPRINT CO. 7035 212