

THE FOLLOWING LATEST REVISED STANDARD PLANS FILE IN THE OFFICE OF THE COUNTY ENGINEER SHALL APPLY IN THE CONSTRUCTION OF THIS PROJECT.

**LEGEND**

MINIMUM PUBLIC SAFETY REQUIREMENTS	5-1
BRICK MANHOLE	5-2
STANDARD MANHOLE STEP	5-3
SEWER PIPE	5-17
BEDDING FOR SEWER PIPE	5-21
GRADING AND ENCASUREMENT	5-23
WYS OR TEE SUPPORT	5-26
ALLOWABLE TRENCH WIDTHS	5-33
LOCKING MANHOLE FRAMES AND COVERS	5-35
NON-REINFORCED PRECAST CONCRETE MANHOLE	5-36
SADDLES FOR HOUSE LATERALS	5-28

**INDEX MAP**  
SCALE 1"=600'  
TR. NO. 25238  
P.C. 9012

**NOTICE TO CONTRACTOR**  
The existence and location of any underground utility pipes or structures shown on these plans are obtained by a search of the available records. To the best of my knowledge there are no existing utilities except as shown on these plans. The contractor is required to take due precautionary measures to protect the utility lines shown and other lines not of record or not shown on these plans.

**WHITTIER BLDG. DIST. NO. 11**

- NOTES:**
1. PROVIDE STAKES ON THE PROPERTY LINE OR PROPERTY LINES PRODUCED AT RIGHT ANGLES TO THE SEWER LINE AT THE CENTER LINE OF EACH MANHOLE.
  2. NO REPRESENTATIVE OF THE COUNTY ENGINEER WILL SURVEY OR LAY OUT ANY PORTION OF THE WORK.
  3. THE PRIVATE ENGINEER SHALL FURNISH THE COUNTY ENGINEER WITH GRAD SHEETS AND STATIONING FOR ALL HOUSE LATERALS AND "T" BRANCHES AND SHALL PROVIDE STAKES FOR THEM AT THEIR PROPER LOCATIONS WITH STATIONING PLAINLY MARKED. ALL HOUSE LATERALS SHALL BE CONSTRUCTED IN A STRAIGHT ALIGNMENT AT RIGHT ANGLES FROM THE MAIN LINE SEWER EXCEPT AS SHOWN ON THE PLANS. HOUSE LATERALS FROM CHIMNEYS SHALL NOT HAVE AN ANGLE OF LESS THAN 45° WITH THE MAIN LINE SEWER. ANY CHANGE IN ALIGNMENT SHALL BE REQUESTED IN WRITING BY THE PRIVATE ENGINEER.
  4. THE PRIVATE ENGINEER SHALL FURNISH THE HOUSE LATERAL DEPTH AT THE PROPERTY LINE BELOW THE TOP OF CURB ELEVATION FOR EACH HOUSE LATERAL ON THE GRADE SHEET.
  5. NO REVISIONS SHALL BE MADE IN THESE PLANS WITHOUT THE APPROVAL OF THE COUNTY ENGINEER.
  6. THE CONTRACTOR SHALL NOTIFY THE DESIGN DIVISION BY TELEPHONE, 866-7011 EXT. 250 AT LEAST TWENTY-FOUR HOURS BEFORE STARTING ANY WORK UNDER THIS CONTRACT.
  7. ALL STRUCTURES SHALL BE EITHER BRICK MANHOLES PER 5-3 OR PRECAST CONCRETE MANHOLES PER 5-36, EXCEPT AS NOTED.
  8. USE STANDARD MANHOLE FRAMES AND COVERS, 155.
  9. MANHOLE TOPS IN IMPROVED RIGHTS-OF-WAY TO BE AT FINISH GRADE.
  10. USE EXTRA STRENGTH PIPE ALL PIPE IS STANDARD UNLESS SPECIFIED AS NOTED.
  11. USE MECHANICAL COMPRESSION JOINTS FOR ALL V.C.P. JOINTS PER SPCS. SECS. 20B-2, TYPE "D", "F" OR "G".
  12. IF A POWER POLE IS WITHIN THREE FEET OF THE SEWER, THE SEWER SHALL BE ENCASED, PER 2-27 TWO FEET ON EACH SIDE FROM THE POINT OF INTERFERENCE.
  13. IF DURING THE COURSE OF CONSTRUCTION IT IS DETERMINED THAT THERE IS LESS THAN FOUR FEET OF COVER OVER THE TOP OF A MAIN LINE OR HOUSE LATERAL V.C.P. SEWER WHICH IS NOT INDICATED ON THE PLANS, THE PIPE SHALL BE ENCASED PER 2-25, CASE II, UNLESS OTHERWISE APPROVED BY THE COUNTY ENGINEER.
  14. HOUSE LATERALS TO BE CONSTRUCTED WITH 1/2" INCH PER FOOT RISE TO PROPERTY LINE.
  15. RESURFACE ALL TRENCHES WITHIN PAVED AREAS TO MEET L.A. COUNTY ROAD DEPT. OR CALIFORNIA STATE HIGHWAY REQUIREMENTS IN ACCORDANCE WITH PERMITS.
  16. REPAIRS TO BE PERFORMED PER SECTION 306-14 OF THE STANDARD SPECIFICATIONS AND SPECIAL PROVISIONS.
  17. REFER TO SECTION 7-10(A.1) OF THE STANDARD SPECIFICATIONS, REGARDING SAFETY ORDERS.
  18. ALL JOINTS BETWEEN CAST IRON PIPE AND VITRIFIED CLAY PIPE SHALL BE MADE WITH A RUBBER SLEEVE JOINT, TYPE "C" OR "D" (WITH BUSHING IF NECESSARY) PER STANDARD SPECIFICATIONS SECTION 308-5.
  19. FULL COMPLIANCE WITH SECTION 305-13.5 OF THE SPECIAL PROVISIONS WILL BE REQUIRED FOR BACKFILL IN STREETS, CRISTIFICATION OF BACKFILL COMPOSITION AND SAND EQUIVALENTS BY A QUALIFIED, REGISTERED TESTING LABORATORY, SHALL BE PROVIDED BY THE PERMITTEE PRIOR TO ISSUANCE OF A CERTIFICATE OF PARTIAL ACCEPTANCE.

**COLLECT CHARGES AS INDICATED**

PROFILE, ALIGNMENT AND GRADE OF **P.C. 9012**  
**SANITARY SEWERS PAGE 1**  
TO BE CONSTRUCTED FOR

**TRACT NO. 25238**  
**(HOUSE LATERALS ONLY)**  
**PRIVATE CONTRACT NO. 9012**

W.S. 36  
1 SHEET 2 PAGES  
SCALE: VERT. 1"=4' HORIZ. 1"=40'  
OCTOBER, 1973  
PREPARED IN THE OFFICES OF  
**TECHNOLOGICAL ENGINEERING CORP.**  
4921 DUFFER AVE., P.O. BOX 587  
PICO RIVERA, CALIFORNIA, 90660  
BY: *J.A. Patterson*  
REG. C.E. NO. 10410

44998

FOR LEGEND SEE PLAN NO. S-1

**NOTE:**  
GRADES TO WHICH THIS IMPROVEMENT IS TO BE CONSTRUCTED ARE SHOWN ON PLANS AND PROFILES. GRADE POINTS FOR TOP OF CURBS, CENTER LINE OF STREETS, OR CENTER LINE OF ALLEYS ARE SHOWN BY CIRCLES ON PROFILES. AT ALL POINTS BETWEEN DESIGNATED POINTS THE GRADE SHALL BE ESTABLISHED TO BE TO CONFORM TO A STRAIGHT LINE DRAWN BETWEEN SAID DESIGNATED POINTS. ELEVATIONS ARE IN FEET ABOVE U.S.C. & G.S. SEA LEVEL DATUM OF 1929.  
THIS DRAWING AND THE DATA HEREON ARE HEREBY MADE A PART OF THE SPECIFICATIONS.  
THE CONTRACTOR SHALL BE RESPONSIBLE FOR OBTAINING ALL NECESSARY PERMITS FROM THE L.A. COUNTY ROAD DEPT., DISTRICT OFFICE NO. 10, AND PAY A FEE TO THE COUNTY ENGINEER.  
APPROVAL OF THIS PLAN BY THE COUNTY OF LOS ANGELES DOES NOT CONSTITUTE A REPRESENTATION AS TO THE ACCURACY OF THE LOCATION OF OR THE EXISTENCE OR NON-EXISTENCE OF ANY UNDERGROUND UTILITY PIPE, OR STRUCTURE WITHIN THE LIMITS OF THIS PROJECT. THIS NOTE APPLIES TO ALL PAGES.  
IF WORK IS TO BE DONE IN A STATE HIGHWAY, A PERMIT MUST BE OBTAINED FROM THE STATE OF CALIFORNIA, DIVISION OF HIGHWAYS, 120 SOUTH SPRING STREET, LOS ANGELES, CALIFORNIA.

**COUNTY OF LOS ANGELES, CALIFORNIA**  
HARVEY T. BRANDT, COUNTY ENGINEER

APPROVED BY: *K.P. Murphy*  
Supt., LOS ANGELES EQUIPMENT ENGINEER

CHECKED BY: *R. J. [Signature]*  
REG. C.E. NO. 10410  
4-10-75

J.N. 0250.02

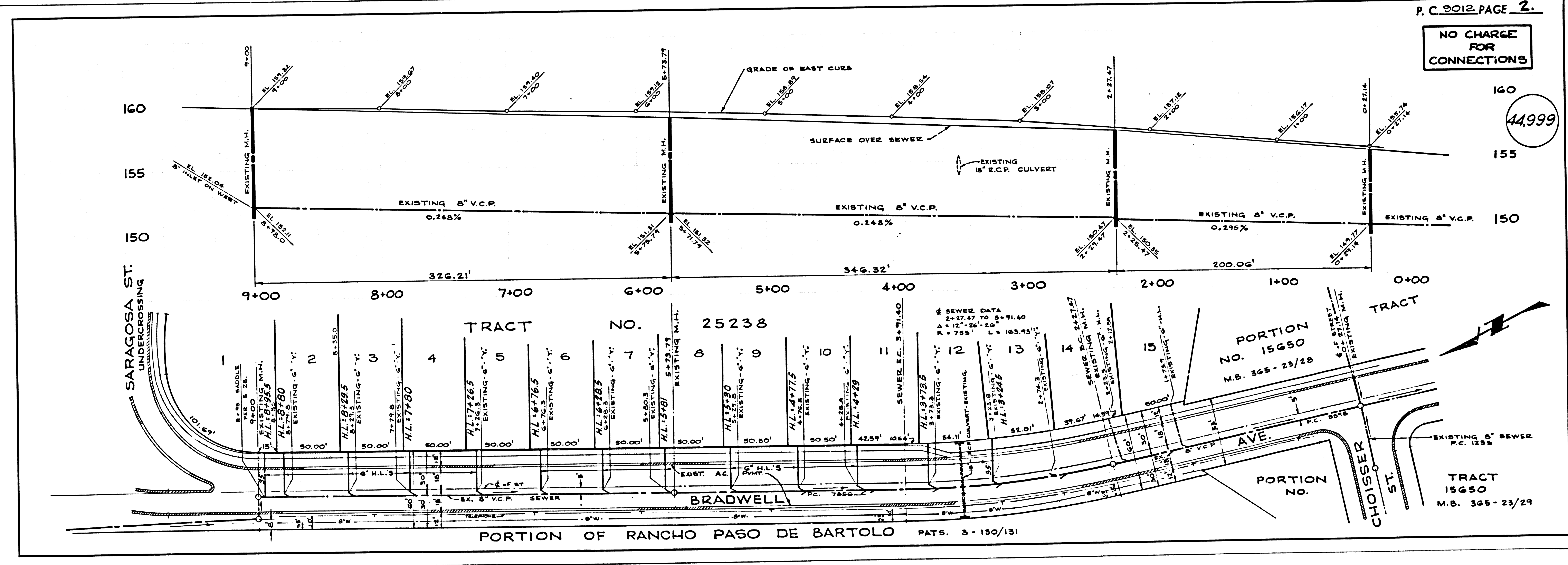

P.C. 9012 PAGE 2.

**NO CHARGE FOR CONNECTIONS**

44999