

TO BE CONSTRUCTED IN
TRACT NO. 30111
PRIVATE CONTRACT NO. 9034

W.S.
 2 SHEETS, 4 PAGES
 SCALE: VERT. 1"=4'
 HORIZ. 1"=40'
 MARCH 5, 1974
 PREPARED IN THE OFFICES OF
VALCON, INC.
 1427 THOUSAND OAKS BLVD.
 THOUSAND OAKS, CALIF. 91320
 BY: *[Signature]*
 REG. E. No. 13650

44877

B.M. BY 7548 ELEV. 815.832
 ST HWY MGN IN WELL 10IN DN ON &
 LIBERTY CYN RD UNDERCROSSING 30FTS.
 EASTBOUND ON-OFF RAMP VENTURA FWY,
 MALIBU QUAD. 19.22.

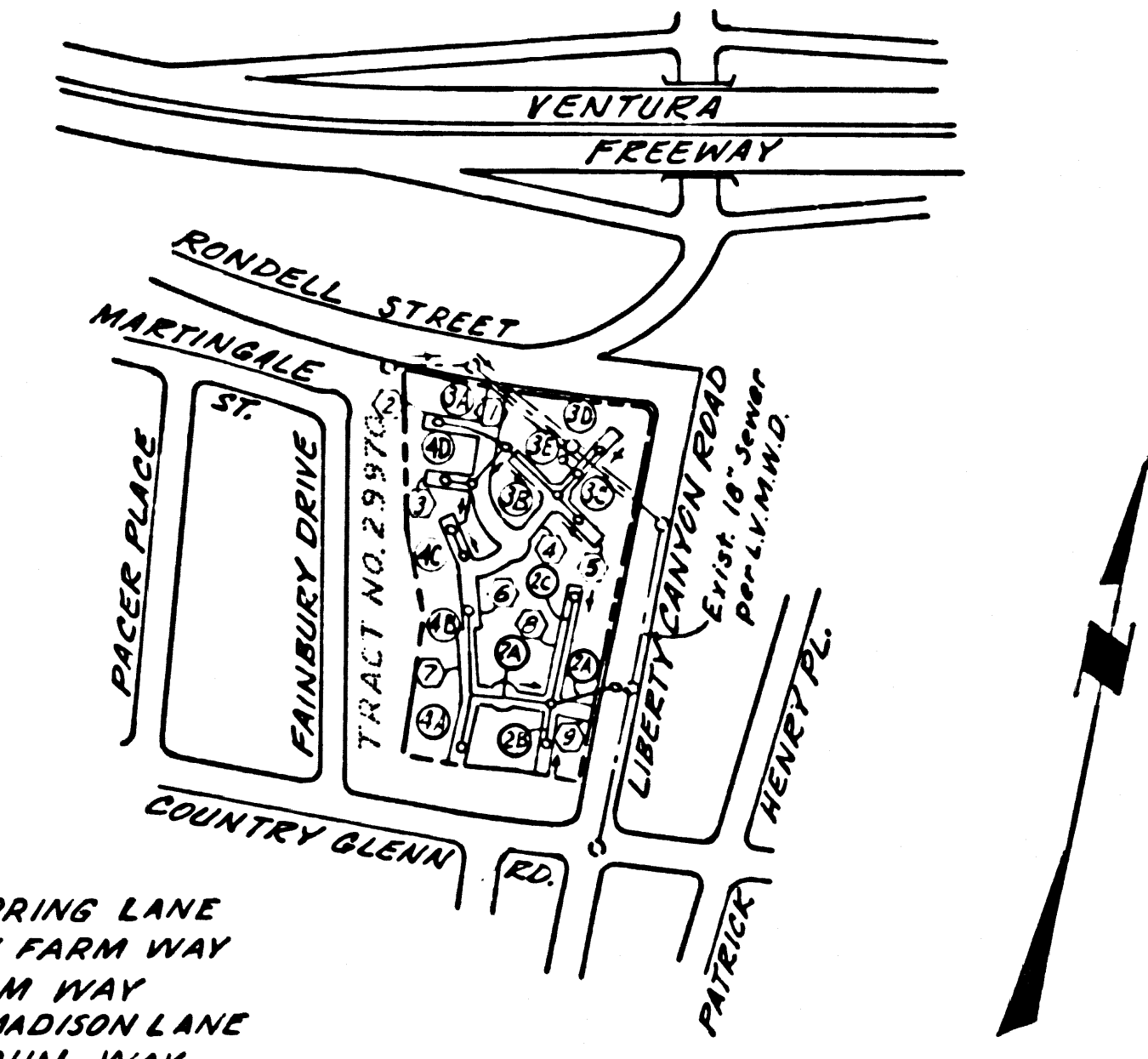

- ① INDIAN SPRING LANE
- ② BURGUNDY FARM WAY
- ③ WHITE ELM WAY
- ④ DOLLEY MADISON LANE
- ⑤ WILLOW RUN WAY
- ⑥ OAK BURL LANE
- ⑦ SEABROOK LANE
- ⑧ CHESTERBROOK WAY
- ⑨ GREEN CIRCLE LANE

P.C. 9034
INDEX MAP
 SCALE: 1"=500'

NOTE: FIGURES IN CIRCLES INDICATE PAGE NUMBERS
 NOTE: FIGURES IN HEXAGONS INDICATE STREET NAMES

Revision No. 1 Date Nov 22, 1974
 Description: Page 4B, alignment changed in Seabrook Lane and Oak Burl Lane from Sta. 0+64.12 to 2+52.45.
 APPROVED *[Signature]* 19/66
 Office of County Engineer R.E. No.

Revision No. 2 Date Sep 25, 1974
 Description: Page 3A, moved M.H. in Willow Run Way from Sta. 1+15.00 to Sta. 1+19.00.
 APPROVED *[Signature]* 19/66
 Office of County Engineer R.E. No.

Revision No. 3 Date Oct 24, 1974
 Description: Page 2C added easement to 8" V.C.P. and plotted storm drain pipe per P.D. 1242, Page 4B plotted storm drain.
 APPROVED *[Signature]* 19/66
 Office of County Engineer R.E. No.

- GENERAL NOTES:**
- ELEVATIONS ARE IN FEET ABOVE U.S.C. & G.S. SEA LEVEL DATUM OF 1929.
 - NO REVISIONS SHALL BE MADE IN THESE PLANS WITHOUT THE APPROVAL OF THE COUNTY ENGINEER.
 - NO REPRESENTATIVE OF THE COUNTY ENGINEER WILL SURVEY OR LAY OUT ANY PORTION OF THE WORK.
 - GRADES TO WHICH THIS IMPROVEMENT IS TO BE CONSTRUCTED ARE SHOWN ON PLANS AND PROFILES. GRADE POINTS FOR TOP OF CURBS, CENTER LINE OF STREETS, OR CENTER LINE OF ALLEYS ARE SHOWN BY CIRCLES ON PROFILES AT ALL POINTS BETWEEN DESIGNATED POINTS. THE GRADE SHALL BE ESTABLISHED SO AS TO CONFORM TO A STRAIGHT LINE DRAWN BETWEEN SAID DESIGNATED POINTS.
 - THE PRIVATE ENGINEER SHALL FURNISH THE COUNTY ENGINEER WITH GRADE SHEETS AND STATIONING FOR ALL HOUSE LATERALS AND "T" OR "Y" BRANCHES AND SHALL PROVIDE STAKES FOR THEM AT THEIR PROPER LOCATIONS WITH STATIONING PLAINLY MARKED. ALL HOUSE LATERALS SHALL BE CONSTRUCTED IN A STRAIGHT ALIGNMENT AT RIGHT ANGLES FROM THE MAIN LINE SEWER EXCEPT AS SHOWN ON THE PLANS. HOUSE LATERALS FROM CHIMNEYS SHALL NOT HAVE AN ANGLE OF LESS THAN 45° WITH THE MAIN LINE SEWER. ANY CHANGE IN ALIGNMENT SHALL BE REQUESTED IN WRITING BY THE PRIVATE ENGINEER.
 - THE PRIVATE ENGINEER SHALL FURNISH THE HOUSE LATERAL DEPTH AT THE PROPERTY LINE BELOW THE TOP OF CURB ELEVATION FOR EACH HOUSE LATERAL ON THE GRADE SHEET.
 - BEFORE WORK CAN BE STARTED, THE CONTRACTOR MUST OBTAIN A PERMIT TO EXCAVATE IN THE I.A. COUNTY ROAD DISTRICT DISTRICT NO. 222 AND PAY A FEE TO THE COUNTY ENGINEER, 5102 EAST WILLOW RUN WAY, THOUSAND OAKS, CALIF. 91320. THE PERMIT MUST BE OBTAINED FROM THE COUNTY ENGINEER'S OFFICE, 5102 EAST WILLOW RUN WAY, THOUSAND OAKS, CALIF. 91320.
 - IF WORK IS TO BE DONE IN A STATE HIGHWAY, A PERMIT MUST BE OBTAINED FROM THE STATE OF CALIFORNIA, DIVISION OF HIGHWAYS, 130 SOUTH SPRING STREET, LOS ANGELES, CALIFORNIA.
 - APPROVAL OF THIS PLAN BY THE COUNTY OF LOS ANGELES DOES NOT CONSTITUTE A REPRESENTATION AS TO THE ACCURACY OF THE LOCATION OF OR THE EXISTENCE OR NON-EXISTENCE OF ANY UNDERGROUND UTILITY PIPE, OR STRUCTURE WITHIN THE LIMITS OF THIS PROJECT. THIS NOTE APPLIES TO ALL PAGES.
 - REFER TO SECTION 7-18.4.1 OF THE STANDARD SPECIFICATIONS, REGARDING SAFETY ORDERS.

- CONSTRUCTION NOTES:**
- WORK SHALL BE CONSTRUCTED ACCORDING TO THE STANDARD SPECIFICATIONS FOR PUBLIC WORKS CONSTRUCTION (1974 EDITION) WITH LATEST SUPPLEMENTS AND COUNTY ENGINEER SPECIAL PROVISIONS FOR THE CONSTRUCTION OF SANITARY SEWER DATES APRIL 16, 1972 AND SHALL BE PROSECUTED ONLY IN THE PRESENCE OF THE COUNTY ENGINEER.
 - THE CONTRACTOR SHALL NOTIFY THE CONSTRUCTION DIVISION BY TELEPHONE, WILSON 9-472, EXT. 8133, AT LEAST TWENTY-FOUR HOURS BEFORE STARTING ANY WORK UNDER THIS CONTRACT.
 - HOUSE LATERALS TO BE CONSTRUCTED WITH INVERTS AT PROPERTY LINE & FEET BELOW CURB GRADE EXCEPT AS NOTED.
 - WYE OR TEE BRANCHES MAY BE USED FOR CONNECTIONS TO MAINLINE SEWERS EXCEPT AS NOTED.
 - ALL STRUCTURES SHALL BE EITHER BRICK MANHOLES PER S-3 OR PRECAST CONCRETE MANHOLES PER S-26, EXCEPT AS NOTED.
 - PROVIDE STAKES ON THE PROPERTY LINE OR PROPERTY LINES PRODUCED AT RIGHT ANGLES TO THE SEWER LINE AT THE CENTER LINE OF EACH MANHOLE.
 - MANHOLE TOPS IN IMPASSIBLE RIGHTS OF WAY TO BE LEVISED WITH FINISHED GRADE.
 - VITRIFIED CLAY PIPE JOINTS SHALL BE TYPE "B", "P", OR "D" PER STANDARD SPECIFICATIONS SECTION 308-2.
 - IF A POWER POLE IS WITHIN THREE FEET OF THE SEWER, THE SEWER SHALL BE ENCASED, PER S-23, CASE 2, TWO FEET ON EACH SIDE FROM THE POINT OF INTERFERENCE.
 - IF DURING THE COURSE OF CONSTRUCTION IT IS DETERMINED THAT THERE IS LESS THAN FOUR FEET OF COVER OVER THE TOP OF A MAIN LINE OR HOUSE LATERAL V.C.P. SEWER WHICH IS NOT INDICATED ON THE PLANS, THE PIPE SHALL BE ENCASED PER S-23, CASE 2 UNLESS OTHERWISE APPROVED BY THE COUNTY ENGINEER.
 - ALL JOINTS BETWEEN CAST IRON PIPE AND VITRIFIED CLAY PIPE SHALL BE MADE WITH A RUBBER SLEEVE JOINT, TYPE "C" OR "D", WITH BUSHINGS, IF NECESSARY PER STANDARD SPECIFICATIONS, SECTION 308-2.
 - SEWERS TO BE LIT FOR LEAKAGE PER SECTION 306-2.3.7 OF THE STANDARD SPECIFICATIONS AND SPECIAL PROVISIONS.
 - RESURFACE ALL TRENCHES WITHIN PAVED AREAS TO MEET L.A. COUNTY ROAD DEPT. OR CALIFORNIA STATE HIGHWAY REQUIREMENTS IN ACCORDANCE WITH PERMITS.
 - FULL COMPLIANCE WITH SECTION 306-1.3 OF THE SPECIAL PROVISIONS WILL BE REQUIRED FOR BACKFILL IN STREETS. CERTIFICATION OF BACKFILL COMPACTION AND SAND EQUIVALENTS BY A QUALIFIED, REGISTERED TESTING LABORATORY SHALL BE PROVIDED BY THE PERMITTEE PRIOR TO THE ISSUANCE OF A CERTIFICATE OF PARTIAL ACCEPTANCE.
 - ALL BACKFILL SHALL BE COMPACTED TO AT LEAST 90% OF MAXIMUM DENSITY PER ASTM STD. D 1557-57T AS MODIFIED. ACCEPTABLE CERTIFICATION OF SUCH COMPACTION SHALL BE SUBMITTED TO THE CONSTRUCTION DIVISION.
 - REPAIR EXISTING PAVEMENT, BASE, SUB-BASE, CURBS, UTILITY SINKHOLES AND OTHER FACILITIES WHICH ARE DESTROYED OR DAMAGED DURING CONSTRUCTION PER 7-9 OF THE STANDARD SPECIFICATIONS FOR PUBLIC WORKS CONSTRUCTION.

THE FOLLOWING LATEST REVISED STANDARD PLANS ON FILE IN THE OFFICE OF THE COUNTY ENGINEER SHALL APPLY IN THE CONSTRUCTION OF THIS PROJECT.

| | |
|---|------|
| LEGEND | S-1 |
| MINIMUM PUBLIC SAFETY REQUIREMENTS | S-2 |
| BRICK MANHOLE | S-3 |
| STANDARD MANHOLE STEP | S-17 |
| REDDING FOR SEWER PIPE | S-21 |
| CRACKING AND INCASMENT | S-22 |
| WYE OR TEE SUPPORT | S-26 |
| ALLOWABLE TRENCH WIDTHS | S-28 |
| LOCKING MANHOLE FRAME AND COVER | S-29 |
| NON-REINFORCED PRECAST CONCRETE MANHOLE | S-30 |
| SPECIAL HOUSE LATERALS | S-25 |
| RECONSTRUCTION OF HOUSE LATERALS | S-29 |
| Special Support and Protection | S-22 |

COUNTY OF LOS ANGELES, CALIFORNIA
 HARVEY T. BRANDT, COUNTY ENGINEER
 APPROVED *[Signature]* 4-5-74
 REGIONAL ENGINEER (DATE)
 CHECKED *[Signature]* 4-4-74
 REGIONAL ENGINEER (DATE)
 NO. CE NO. 19166
 CALABASAS BLDG. DIST. 9-1 J.N. 0250.02

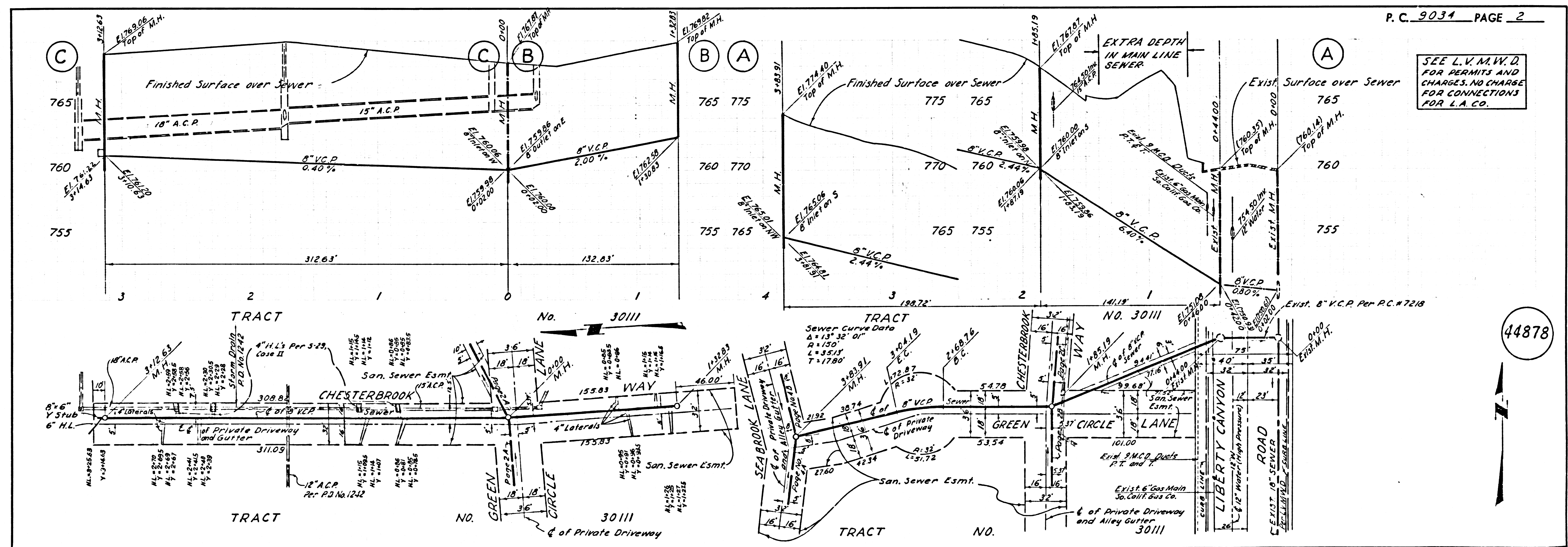

SEE L.V.M.V.D.
 FOR PERMITS AND
 CHARGES. NO CHARGE
 FOR CONNECTIONS
 FOR L.A. CO.

44878

