

B.M. BG 3185 ELEV. 593.364
 R.D. B.M. TAG IN C.B. 5' NLY &
 COLIMA RD. + 90' WLY &
 VIEWFIELD AVE. @ STA. 111+15
 WHITTIER QUAD. 1970 ADT.

REVISION NO. 4 8-22-74 PAGE 2-C
 Added manhole at sta. 1+34.50 and revised
 vertical alignment from sta. 1+32.50 to sta.
 1+08.00, revised alignment.
 Approved: *Thomas J. Howard*
 Office of County Engineer / R.E. NO. 17156

REVISION NO. 1 6-28-74 Page 8A
 Revised sewer alignment Sta. 1+02 to 1+70, re-
 located sewer manhole from Sta. 1+70.00 to 1+18.74
 and revised sewer grade Sta. 0+57.15 to 1+18.74
 and Sta. 1+55 to 1+65. All on page 8A.
 Approved: *W.F. Worling*
 Office of County Engineer / R.E. NO. 17156

REVISION NO. 2 7-23-74
 Page 8A - Revid sewer grades, Sta. 26+28.58 to Sta. 24+16.25
 Page 7A - Deleted
 Page 7B - Added house connections @ Sta. 82+40,
 Sta. 82+54 and Sta. 83+10
 Page 1 - Revised index map & lot 15
 Page 1A - Deleted M.L. from within lot 119 and moved M.L.
 back from Sta. 8+03.00 to Sta. 3+42.00 into St. in Rainbow Ridge
 Approved: *Thomas J. Howard*
 Office of County Engineer / R.E. NO. 17156

REVISION NO. 3 8-9-74
 Page 8A - Relocated M.H. @ Sta. 27+73.30
 Revised grade Sta. 26+28.58 to 26+31.10
 Sta. 27+71.30
 Approved: *Thomas J. Howard*
 Office of County Engineer / R.E. NO. 17156

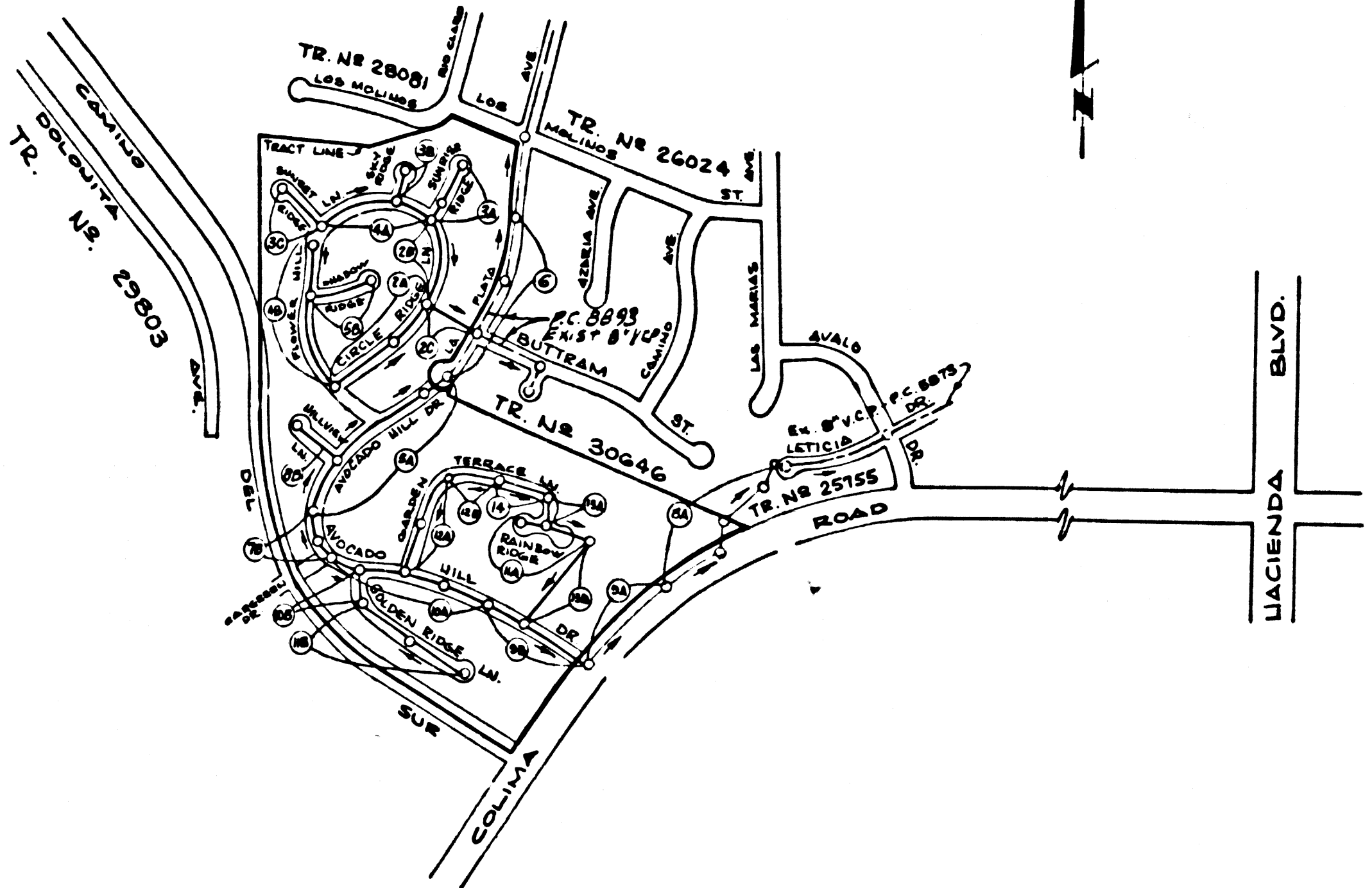

INDEX MAP
 TRACT NO. 32019
 P.C. 9044
 SCALE = 1"=600'

COUNTY SANITATION DISTRICTS SHALL BE NOTIFIED 24 HOURS PRIOR
 TO THE FOLLOWING SO THAT REQUIRED INSPECTION CAN BE MADE
 (PHONE: 967-8605 - FSR-1153)
 ACCEPTANCE OF THE PROJECT:
 NO CONNECTION FOR THE DISPOSAL OF INDUSTRIAL WASTES
 SHALL BE MADE TO SEWERS SHOWN ON THIS PLAN UNLESS UNIT
 IS DESIGNED FOR INDUSTRIAL WASTE WATER DISCHARGE HAS BEEN
 ISSUED BY THE SANITATION DISTRICTS FOR SAID CONNECTION

ISSUE NO HOUSE CONNECTION PERMITS
 UNTIL P.C. 8893 IS ACCEPTED.

DOUBLE SCALE
 GENERAL NOTES:

1. ELEVATIONS ARE IN FEET ABOVE U.S.C. & G.S. SEA LEVEL DATUM OF 1929.
2. NO REPRESENTATIONS SHALL BE MADE IN THESE PLANS WITHOUT THE APPROVAL OF THE COUNTY ENGINEER.
3. NO REPRESENTATIVE OF THE COUNTY ENGINEER WILL SURVEY OR LAY OUT ANY PORTION OF THE WORK.
4. GRADES TO WHICH THIS IMPROVEMENT IS TO BE CONSTRUCTED ARE SHOWN ON PLANS AND PROFILE GRADE POINTS FOR TOP OF CURB, CENTER LINE OF DRIVE, OR CENTER LINE OF ALLEY ARE SHOWN BY CIRCLES ON PROFILES. ALL POINTS BETWEEN DESIGNATED POINTS THE GRADE SHALL BE ESTABLISHED SO AS TO CONFORM TO A STRAIGHT LINE DRAWN BETWEEN SAID DESIGNATED POINTS.
5. THE PRIVATE ENGINEER SHALL FURNISH THE COUNTY ENGINEER WITH GRADE SHEETS AND STATIONING FOR ALL HOUSE LATERALS AND "Y" OR "T" BRANCHES AND SHALL PROVIDE STAKES FOR THEM AT THEIR PROPER LOCATIONS WITH STATIONING MARKS. ALL HOUSE LATERALS SHALL BE CONSTRUCTED IN A STRAIGHT ALIGNMENT AT RIGHT ANGLES FROM THE MAIN LINE SEWER EXCEPT AS SHOWN ON THE PLANS. HOUSE LATERALS FROM CHIMNEYS SHALL NOT HAVE AN ANGLE OF LESS THAN 45° WITH THE MAIN LINE SEWER. ANY CHANGE IN ALIGNMENT SHALL BE REQUESTED IN WRITING BY THE PRIVATE ENGINEER.
6. THE PRIVATE ENGINEER SHALL FURNISH THE COUNTY ENGINEER WITH A PERMIT TO EXCAVATE IN BELOW THE TOP OF CURB ELEVATION FOR EACH HOUSE LATERAL ON THE GRAD SHEET.
7. BEFORE WORK CAN BE STARTED, THE CONTRACTOR MUST OBTAIN A PERMIT TO EXCAVATE IN BELOW THE TOP OF CURB ELEVATION FOR EACH HOUSE LATERAL ON THE GRAD SHEET. AND PAY A FEE TO THE COUNTY ENGINEER.
8. APPROVAL OF THIS PLAN BY THE COUNTY OF LOS ANGELES DOES NOT CONSTITUTE A REPRESENTATION AS TO THE ACCURACY OF THE LOCATION OF OR THE EXISTENCE OR NON-EXISTENCE OF ANY UNDERGROUND UTILITY PIPE, OR STRUCTURE WITHIN THE LIMITS OF THIS PROJECT. THIS NOTE APPLIES TO ALL PAGES.
9. REFER TO SECTION 7-18.4.1 OF THE STANDARD SPECIFICATIONS, REGARDING SAFETY ORDERS.
10. PRIOR TO ISSUANCE OF THE REQUIRED SEWER CONSTRUCTION PERMIT BY THE COUNTY ENGINEER, THE CONTRACTOR SHALL OBTAIN A PERMIT TO EXCAVATE FROM THE STATE OF CALIFORNIA, DIVISION OF INDUSTRIAL SAFETY.
11. (473) ELEVATION OF INVERT OF LATERAL AT PROPERTY LINE.

CONSTRUCTION NOTES:

1. WORK SHALL BE CONSTRUCTED ACCORDING TO THE STANDARD SPECIFICATIONS FOR PUBLIC WORKS CONSTRUCTION (1972 EDITION) WITH 1974 AMENDMENTS AND COUNTY ENGINEER SPECIAL PROVISIONS FOR THE CONSTRUCTION OF SANITARY SEWERS DATED 1-28-74, AND SHALL BE PROSECUTED ONLY IN THE PRESENCE OF THE COUNTY ENGINEER.
2. THE CONTRACTOR SHALL NOTIFY THE DISTRICT DIVISION BY TELEPHONE, (213) 974-7888 AT LEAST TWENTY-FOUR HOURS BEFORE STARTING ANY WORK UNDER THIS CONTRACT.
3. HOUSE LATERALS TO BE CONSTRUCTED WITH INVERTS AT PROPERTY LINE & FEET BELOW CURB GRADE EXCEPT AS SHOWN IN NOTE 12 ABOVE.
4. WYE OR T BRANCHES MAY BE USED FOR CONNECTIONS TO MAINLINE SEWERS EXCEPT AS NOTED.
5. ALL STRUCTURES SHALL BE EITHER BRICK MANHOLES PER S-3 OR PRECAST CONCRETE MANHOLES PER S-3A, EXCEPT AS NOTED.
6. PROVIDE STAKES ON THE PROPERTY LINE OR PROPERTY LINES PRODUCED AT RIGHT ANGLES TO THE SEWER LINE AT THE CENTER LINE OF EACH MANHOLE.
7. MANHOLE TOPS IN UNIMPROVED RIGHTS OF WAY TO BE SIX INCHES ABOVE FINISHED GRADE.
8. VITRIFIED CLAY PIPE JOINTS SHALL BE TYPE "D", "F", OR "G" PER STANDARD SPECIFICATIONS SECTION 206-2.
9. IF A POWER POLE IS WITHIN THREE FEET OF THE SEWER, THE SEWER SHALL BE ENCASED, PER S-23, CASE II, TWO FEET ON EACH SIDE FROM THE POINT OF INTERFERENCE.
10. IF DURING THE COURSE OF CONSTRUCTION IT IS DETERMINED THAT THERE IS LESS THAN FOUR FEET OF COVER OVER THE TOP OF A MAIN LINE OR HOUSE LATERAL V.C.P. SEWER WHICH IS NOT INDICATED ON THE PLANS, THE PIPE SHALL BE ENCASED PER S-23, CASE II UNLESS OTHERWISE APPROVED BY THE COUNTY ENGINEER.
11. ALL JOINTS BETWEEN CAST IRON PIPE AND VITRIFIED CLAY PIPE SHALL BE MADE WITH A RUBBER SLEEVE JOINT, TYPE "C" OR "D", (WITH BUSHING IF NECESSARY) PER STANDARD SPECIFICATIONS, SECTION 206-2.
12. SEWERS TO BE TESTED FOR LEAKAGE PER SECTION 206-1.6 OF THE STANDARD SPECIFICATIONS AND SPECIAL PROVISIONS.
13. RESURFACE ALL TRENCHES WITHIN PAVED AREAS TO MEET L.A. COUNTY ROAD DEPT. OR CALIFORNIA STATE HIGHWAY REQUIREMENTS IN ACCORDANCE WITH PERMITS.
14. FULL COMPLIANCE WITH SECTION 206-1.8 OF THE SPECIAL PROVISIONS WILL BE REQUIRED FOR ALL TRENCHES EXCEPT THOSE WHICH ARE EXEMPTED BY SAID SPECIAL PROVISIONS BY A QUALIFIED REGISTERED TESTING LABORATORY SHALL BE PROVIDED BY THE PERMITTEE PRIOR TO THE ISSUANCE OF A CERTIFICATE OF TRENCH ACCEPTANCE.
15. SPECIAL BACKFILL IN DESIGNATED AREAS (CONCRETE, ASPHALT, OR OTHER) SHALL BE REMOVED UP AS TO ACHIEVE THE NATURAL OF FINISHED GRADE (SLOPE) OR AS SHOWN ON THE PLANS. ALL BACKFILL SHALL BE COMPACTED TO A MINIMUM OF 95% RELATIVE COMPACTION PER SECTION 206-1.10 OF THE STANDARD SPECIFICATIONS FOR PUBLIC WORKS CONSTRUCTION (1972 EDITION) WITH 1974 AMENDMENTS AND COUNTY ENGINEER SPECIAL PROVISIONS FOR THE CONSTRUCTION OF SANITARY SEWERS DATED 1-28-74, AND SHALL BE PROSECUTED ONLY IN THE PRESENCE OF THE COUNTY ENGINEER.

PROFILE, ALIGNMENT AND GRADE OF
SANITARY SEWERS PAGE 1
 TO BE CONSTRUCTED IN
TRACT NO. 32019
 PRIVATE CONTRACT NO. 9044
 W.S. 37-E5
 7 SHEETS, 14 PAGES 44759
 SCALE: VERT. 1"=5'
 HORIZ. 1"=40' 197
 PREPARED IN THE OFFICES OF
KEMMERER ENGINEERING CO. INC.
 6705 So. PAINTER, WHITTIER, CA.
 BY: *Robert K. Flores*
 REG. C. E. No. 11349

THE FOLLOWING LATEST REVISED STANDARD PLANS ON FILE IN THE OFFICE OF THE COUNTY ENGINEER SHALL APPLY IN THE CONSTRUCTION OF THIS PROJECT:

LEGEND	SECTION
MINIMUM PUBLIC SAFETY REQUIREMENTS	S-1
BRICK MANHOLE	S-2
STANDARD MANHOLE STEP	S-3
BEDDING FOR SEWER PIPE	S-4
CRADLING AND ENCASMENT	S-5
WYE OR TEE SUPPORT	S-6
ALLOWABLE TRENCH WIDTHS	S-7
LOCKING MANHOLE FRAME AND COVER	S-8
NON-REINFORCED PRECAST CONCRETE MANHOLE	S-9
RECTANGULAR SHALLOW MANHOLE	S-10
RECTANGULAR MANHOLE FRAME COVER	S-11

COUNTY OF LOS ANGELES, CALIFORNIA
 JOHN A. LAMBIE, COUNTY ENGINEER JOHN D. PARKHURST, CHIEF ENGINEER
 CO. SAN DIST. NO. 21
 APPROVED *W.F. Worling* APPROVED *Thomas J. Howard*
 SAN DIEGO REGIONAL ENGINEER OFFICE ENGINEER
 CHECKED *W.F. Worling* DATE 6/19/79
 REG. C. E. NO. 17723
 LA PUENTE BLDG. DIST. 2.0 I.N. 0250.02

