

B.M. ELEV. 1217.47
 Ld. & Bt. spk. in curb, Intersection of Newhall Ave. & Dalbey Dr.
 5' W. cor. 5' W. of curb return.
 F.B. 2698 page 58

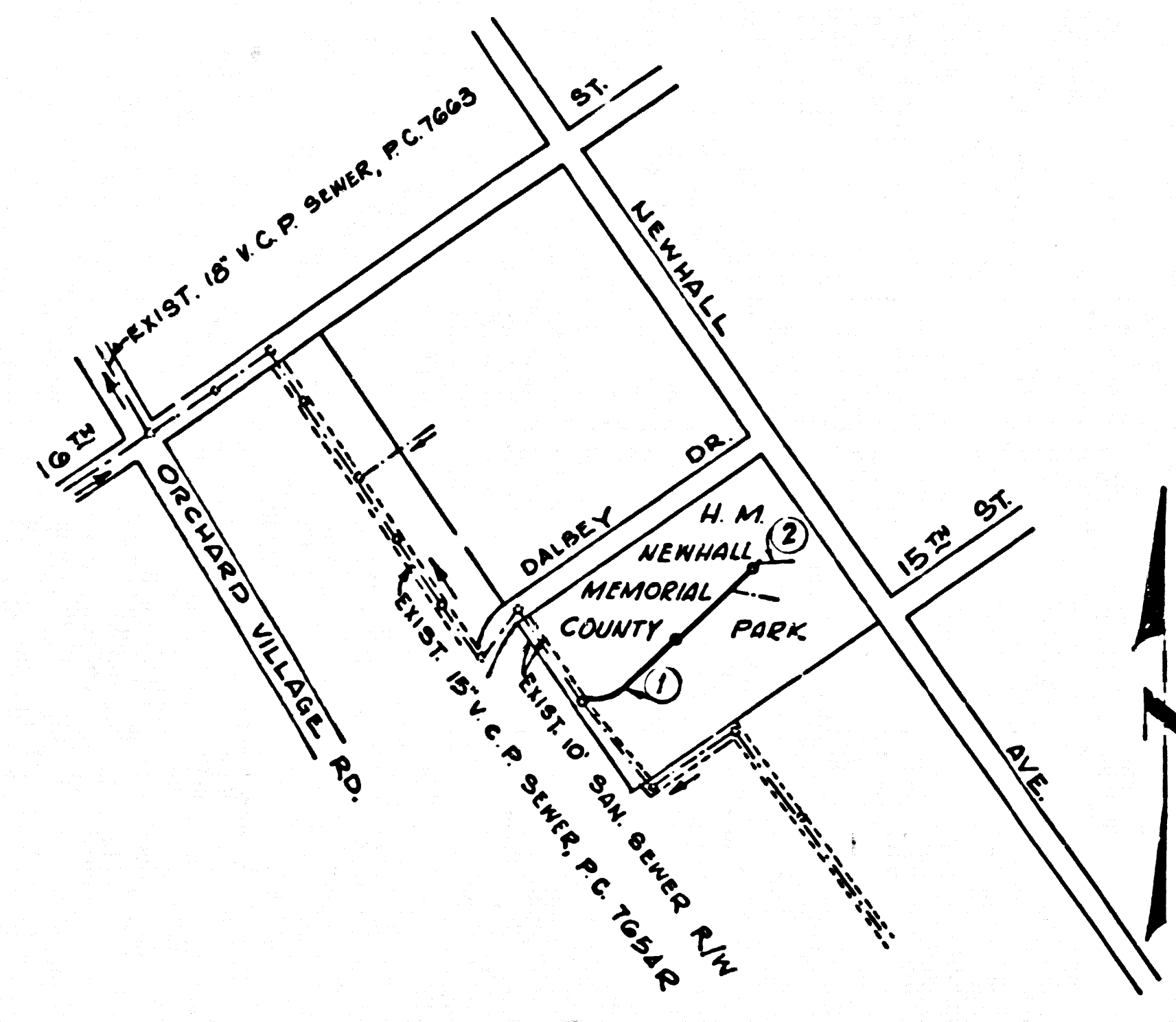

INDEX MAP
 C.C. 9074
 SCALE 1"=60'

NOTICE TO CONTRACTOR

THE EXISTENCE AND LOCATION OF ANY UNDERGROUND UTILITY PIPES OR STRUCTURES SHOWN ON THESE PLANS ARE OBTAINED BY A SEARCH OF THE AVAILABLE RECORDS. TO THE BEST OF OUR KNOWLEDGE THERE ARE NO EXISTING UTILITIES EXCEPT AS NOTED ON THIS MAP

THE CONTRACTOR IS REQUIRED TO TAKE PRECAUTIONARY MEASURES TO PROTECT THE UTILITY LINES SHOWN AND ANY NOT OF RECORD OR NOT SHOWN ON THIS PROJECT.

PRIOR TO TRENCH EXCAVATION, THE CONTRACTOR SHALL SUBMIT TO AND OBTAIN APPROVAL FROM THE COUNTY ENGINEER OF A DETAILED PLAN SHOWING THE DESIGN OF SHORING, BRACING, SLOPING, OR OTHER PROVISIONS FOR WORKER PROTECTION FROM THE HAZARD OF CAVING GROUND. IF SUCH PLAN VARIES FROM THE SYSTEM STANDARDS ESTABLISHED BY THE CONSTRUCTION SAFETY ORDERS IT SHALL BE PREPARED BY A REGISTERED CIVIL OR STRUCTURAL ENGINEER.

ALL LANDSCAPING THAT IS REMOVED OR DAMAGED DURING SEWER CONSTRUCTION, SHALL BE REPLACED AT CONTRACTOR'S EXPENSE IN KIND AND SIZE.

NO TREES SHALL BE REMOVED DURING CONSTRUCTION.

COUNTY SANITATION DISTRICTS SHALL BE NOTIFIED 24 HOURS PRIOR TO THE FOLLOWING SO THAT REQUIRED INSPECTION CAN BE MADE (PHONE: 962-8625 - 633-1161)

NO CONNECTION FOR THE DISPOSAL OF INDUSTRIAL WASTES SHALL BE MADE TO SEWERS SHOWN ON THESE DRAWINGS UNTIL A PERMIT FOR INDUSTRIAL WASTE WATER DISCHARGE HAS BEEN OBTAINED BY THE SANITATION DISTRICTS FOR SAID CONNECTION.

REVISION: 3-10-75
 Revised Alignment Between 1000.00 & 8150.00' Due To Interference With Flood Light Standard.
 Approved: *Rudolph D. Hlinek*
 R.C.E. #14390
 OFFICE OF THE COUNTY ENGINEER

GENERAL NOTES:

REFER TO SECTION 7-10-41 OF STANDARD SPECIFICATIONS REGARDING SAFETY ORDERS.
 ALL MANHOLES SHALL BE EITHER BRICK PER 5-3 OR PRECAST CONCRETE PER 5-36, EXCEPT AS NOTED.
 "T" OR "T" BRANCHES MAY BE USED FOR CONNECTIONS TO MAIN LINE SEWER, EXCEPT AS NOTED.
 VITRIFIED CLAY PIPE JOINTS SHALL BE TYPE "D", "T", OR "C" PER SECTION 306-2 OF STANDARD SPECIFICATIONS.
 ALL JOINTS BETWEEN CAST IRON PIPE AND VITRIFIED CLAY PIPE SHALL BE MADE WITH A RUBBER SLEEVE JOINT, TYPE "C" OR "D" (WITH BUSHING IF NECESSARY) PER SECTION 306-3 OF STANDARD SPECIFICATIONS.
 SEWERS TO BE TESTED FOR LEAKAGE PER SECTION 304.4 OF STANDARD SPECIFICATIONS AND SPECIAL PROVISIONS.
 IF A POWER POLE IS WITHIN THREE FEET OF THE SEWER, THE SEWER SHALL BE ENCASED, PER 5-22 CASE II, TWO FEET ON EACH SIDE FROM THE POINT OF INTERFERENCE.
 CONSTRUCT HOUSE LATERALS WITH INVERT AT PROPERTY LINE & FEET BELOW CURB GRADE, OR GRADE OF CENTER LINE OF STREET, EXCEPT AS NOTED.
 INDICATES DEPTH BELOW CURB GRADE, OR GRADE OF CENTER LINE OF STREET.
 INDICATES HOUSE LATERAL SHALL BE CONSTRUCTED WITH 12" DIA. PER FOOT TO PROPERTY LINE.
 INDICATES: "C" OR "T" SHALL BE SAID HORIZONTAL AND HOUSE LATERAL SHALL BE CONSTRUCTED WITH 12" DIA. PER FOOT TO PROPERTY LINE.
 ALL HOUSE LATERALS SHALL BE CONSTRUCTED IN A STRAIGHT ALIGNMENT AT RIGHT ANGLES FROM THE MAIN LINE SEWER EXCEPT AS SHOWN ON THE PLANS. HOUSE LATERALS FROM CHIMNEYS SHALL NOT HAVE AN ANGLE OF LESS THAN 45 DEGREES WITH THE MAIN LINE SEWER.
 ALL CONCRETE CROSS GUTTERS, CURBS, GUTTERS, PAVEMENT, AND DRIVEWAYS SHALL BE TUNNELED OR JACKED PER LOS ANGELES COUNTY ROAD DEPARTMENT REQUIREMENTS.

STREET RESURFACING:

STREET RESURFACING METHODS SHALL BE IN ACCORDANCE WITH SECTION 306-7.12 OF THE SPECIAL PROVISIONS.
 FINAL STREET RESURFACING IN ANY LOCATION SHALL BE COMPLETED WITHIN _____ DAYS AFTER COMPLETION OF TRENCH BACKFILL.
 THE RESURFACED AREA SHALL BE SETBACK WITHIN 25.1' MINIMUM AND 1/4" INCH CRUSHED ROCK.
 RESURFACING SCHEDULE: RESURFACE TRENCH WITHIN PAVED AREA WITH TYPE _____ ASPHALTIC CONCRETE _____ INCHES IN THICKNESS ON _____ INCHES OF AGGREGATE BASE MATERIALS, EXCEPT AS NOTED BELOW.

PAGE NO.	STREET	STATION LIMITS FROM TO	TYPE OF RESURFACING

THE FOLLOWING LATEST REVISED STANDARD PLANS ON FILE IN THE OFFICE OF COUNTY ENGINEER SHALL APPLY IN THE CONSTRUCTION OF THIS PROJECT:

LEGEND	5-1	CRADLING AND ENCASEMENT	5-22
MINIMUM PUBLIC SAFETY REQUIREMENT	5-2	STANDARD WYE OR TEE SUPPORT	5-26
BRICK MANHOLE	5-3	ALLOWABLE TRENCH WIDTHS	5-25
MANHOLE STE	5-17	LOCKING MANHOLE FRAME AND COVER	5-23
BEDDING FOR SEWER PIPE	5-21	NON-REINFORCED PRECAST CONCRETE MANHOLE	5-24
SPECIAL SUPPORT AND PROTECTION	5-22		

CAP. PROJ. NO. 8801.22 SHEET 1
CASH CONTRACT NO. 9074
 SANITARY SEWERS
 CONSTRUCTED IN
NEWHALL MEMORIAL COUNTY PARK

PHASE II

46,055

AUG., 1974

SCALE: VERT. 1"=4'
 HORIZ. 1"=40'

COUNTY OF LOS ANGELES, CALIFORNIA
 HARVEY T. BRANDT COUNTY ENGINEER

APPROVED: *[Signature]* 8/21/74
 COUNTY ENGINEER
 DESIGNED: *[Signature]* 8-21-74
 REG. C.E. NO. 174-16

APPROVED: *[Signature]*
 JOHN D. PARKHURST
 CHIEF ENGINEER OF COUNTY SANITATION DISTRICT NO. 22
 OFFICE ENGINEER

NOTES:
 WORK SHALL BE CONSTRUCTED ACCORDING TO THE STANDARD SPECIFICATIONS FOR PUBLIC WORKS CONSTRUCTION 1973 EDITION WITH 1974 SUPPLEMENTS AND COUNTY ENGINEER SPECIAL PROVISIONS FOR THE CONSTRUCTION OF SANITARY SEWERS DATED MARCH 4, 1974 AND SHALL BE PROSECUTED ONLY IN THE PRESENCE OF THE COUNTY ENGINEER.
 THE CONTRACTOR SHALL NOTIFY THE CONSTRUCTION DIVISION BY TELEPHONE 974-7828 AT LEAST 24 HOURS BEFORE STARTING ANY WORK UNDER THIS CONTRACT.
 GRADES TO WHICH THE IMPROVEMENT IS TO BE CONSTRUCTED ARE SHOWN ON PLANS AND PROFILES. GRADE POINTS FOR TOP OF CURB, CENTER LINE OF STREET OR CENTER LINE OF ALLEY ARE SHOWN BY CIRCLES ON PROFILES AT ALL POINTS BETWEEN DESIGNATED POINTS THE GRADE SHALL BE ESTABLISHED SO AS TO CONFORM TO A STRAIGHT LINE DRAWN BETWEEN SAID DESIGNATED POINTS.
 ELEVATIONS ARE IN FEET ABOVE U.S.C. & G.S. SEA LEVEL DATUM OF 1929.
 THIS DRAWING AND THE DATA HEREON ARE HEREBY MADE A PART OF THE SPECIFICATIONS.

LAYOUT	DATE	CHECKED	DATE
TRACED	8/21/74	MAINTENANCE	8/21/74
F.B.	A.B.	W.S. 02	

NEWHALL BUILDING DISTRICT NO. 8.2

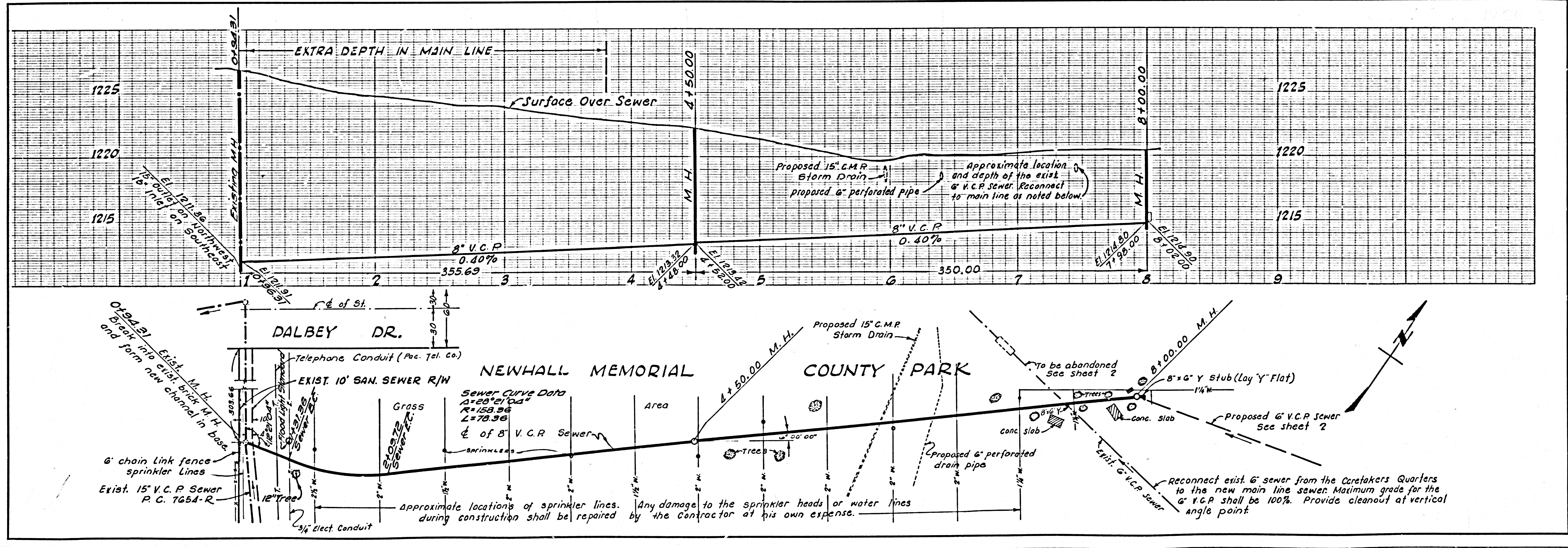

46,056

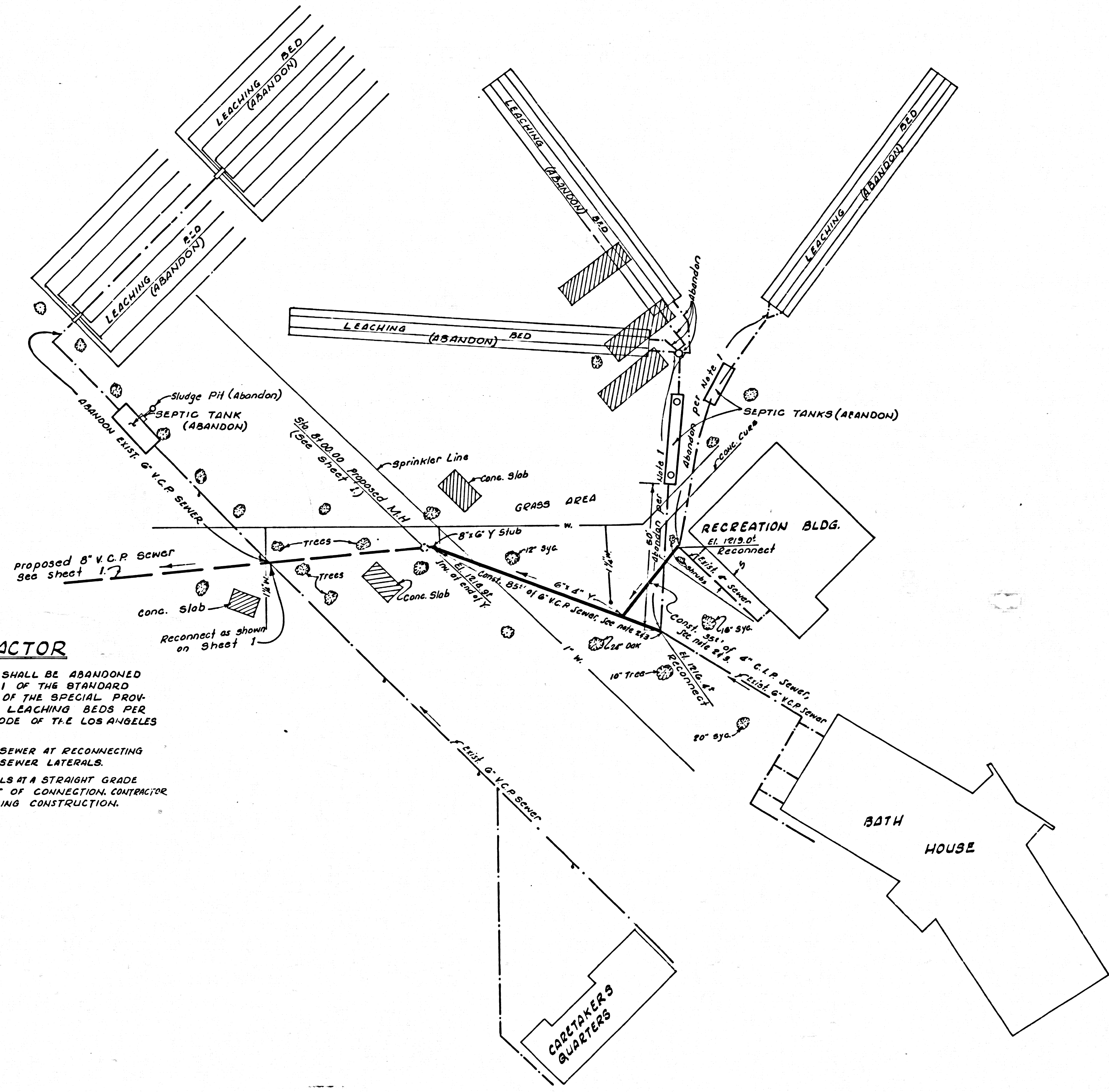

NOTICE TO CONTRACTOR

1. ALL SEWER PIPES AND APPURTENANCES SHALL BE ABANDONED IN ACCORDANCE WITH SECTION 306-5.1 OF THE STANDARD SPECIFICATIONS AND SECTION 306-5.11 OF THE SPECIAL PROVISIONS. ABANDON SEPTIC TANKS AND LEACHING BEDS PER SECTION 119, UNIFORM PLUMBING CODE OF THE LOS ANGELES COUNTY BUILDING LAWS.
2. CONTRACTOR SHALL EXPOSE THE EXISTING SEWER AT RECONNECTING POINTS BEFORE THE CONSTRUCTION OF THE SEWER LATERALS.
3. CONSTRUCT THE PROPOSED SEWER LATERALS AT A STRAIGHT GRADE FROM THE EXISTING SEWER TO THE POINT OF CONNECTION. CONTRACTOR TO MAINTAIN SERVICE AT ALL TIMES DURING CONSTRUCTION.

