

SANITARY SEWERS TO BE CONSTRUCTED IN GIANO AVENUE SEWER RECONSTRUCTION PRIVATE CONTRACT NO. 9158

1 SHEET 2 PAGES SCALE: VERT. 1"=4' DATE APRIL, 1975 HORIZ. 1"=40'

PREPARED IN THE OFFICES OF VTN CONSOLIDATED, INC. 2301 CAMPUS DRIVE, IRVINE, CA. 92663 BY: *Bushaw Associates* 4/17/75 REG. C. E. No. 17061

NOTE: GRADES TO WHICH THIS IMPROVEMENT IS TO BE CONSTRUCTED ARE SHOWN ON PLANS AND PROFILE. ELEVATIONS ARE IN FEET ABOVE U.S.C. & G.S. SEA LEVEL DATUM OF 1929

BEFORE WORK CAN BE STARTED, THE CONTRACTOR MUST OBTAIN A PERMIT TO EXCAVATE IN C.O. STREETS FROM THE L.A. CO. ROAD DEPT. DISTRICT OFFICE NO. 20 AND PAY A FEE TO THE CO. ENGINEER. THE COST OF CONSTRUCTION SHALL BE PAID BY THE CONTRACTOR. APPROVAL OF THIS PLAN BY THE CO. ENGINEER DOES NOT CONSTITUTE A REPRESENTATION AS TO THE ACCURACY OF THE LOCATION OR OF THE EXISTENCE OR NON-EXISTENCE OF ANY UNDERGROUND UTILITY PIPE OR STRUCTURE WITHIN THE LIMITS OF THIS PROJECT. THIS NOTE APPLIES TO ALL PAGES.

COUNTY OF LOS ANGELES, CALIFORNIA HARVEY T. BRANDT, COUNTY ENGR.

APPROVED BY: *R.T. Norling* J.D. PARKHURST, CHIEF ENGINEER SAN DIMAS REGIONAL ENGINEER

CHECKED BY: *Ruff* RCE 177 22

45154

LA PUENTE BLDG. DIST. NO 20 J.N. 0358.01

C.O. ENGR. PRELIM. LEVEL LINE B.M. 11-109A ELEV. 403.504 VALLEY BLVD., ABOUT 637 FT. EAST OF THE PROJECTED CENTERLINE OF GIANO AVENUE, SOUTH OF VALLEY BLVD. ON THE SOUTHERN PACIFIC RAILROAD RIGHT OF WAY, 8.6 FT. SOUTH OF THE SOUTH RAILROAD RAIL, 38.8 FEET NORTH-WESTERLY OF A NAIL AND TIN IN A POWER POLE AND ABOUT 28 FT. WEST OF A LINE OF POWER POLES TO THE NORTH, SET ABOUT 3 INCHES BELOW THE SURFACE. (STAMPED PUENTE L-12 1958 R.E. 3869) R.B. 1376 PG. 92-B 1971 ADJ.

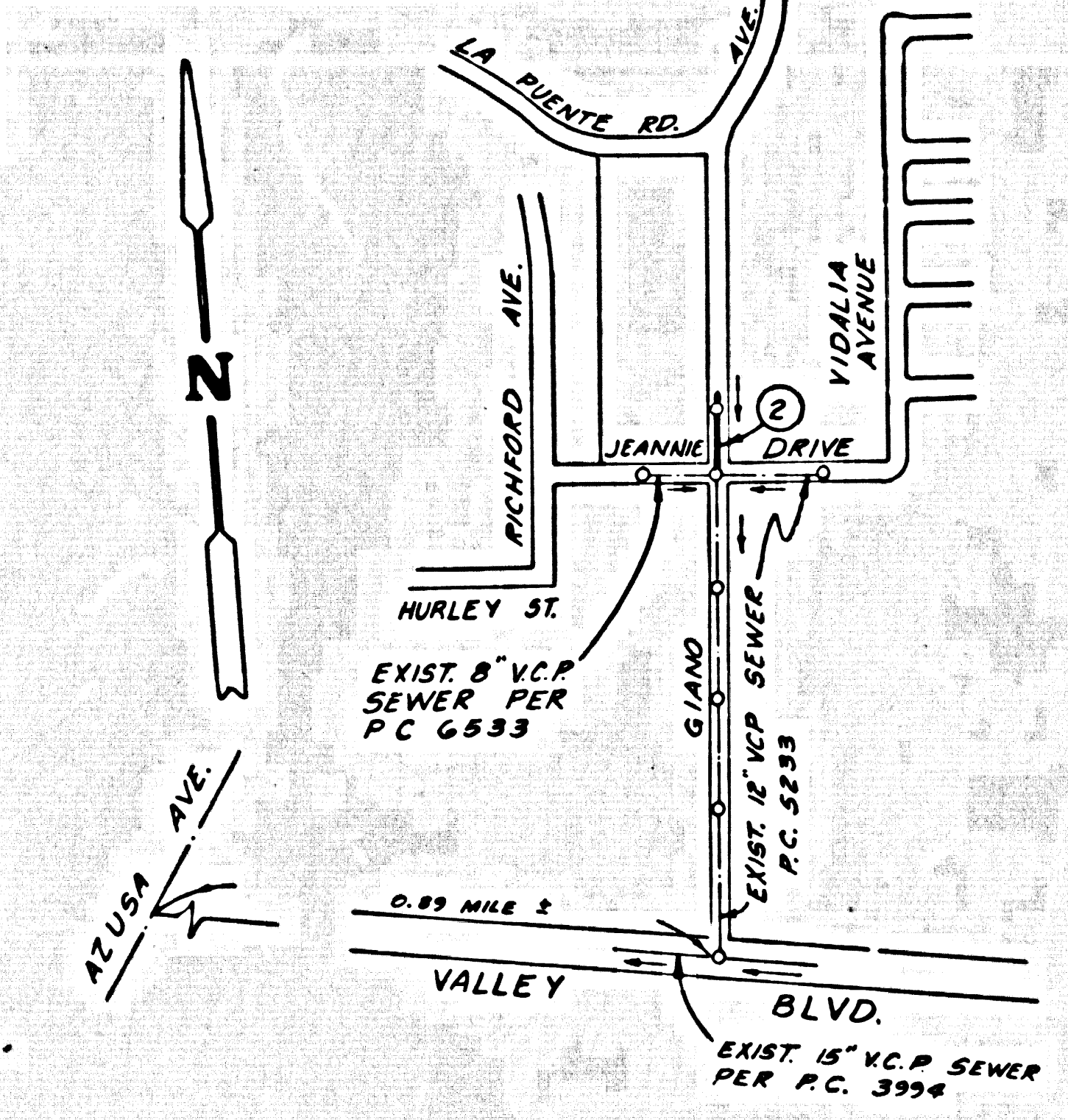

INDEX MAP SCALE: 1"=600' P.C. 9158

BE FULL COMPLIANCE WITH SECTION 306-1.5 OF THE SPECIAL PROVISIONS WILL BE REQUIRED FOR BACKFILL IN STREETS. CERTIFICATION OF BACKFILL COMPACTION AND SAND EQUIVALENTS BY A QUALIFIED REGISTERED TESTING LABORATORY SHALL BE PROVIDED BY THE PERMITTEE PRIOR TO THE ISSUANCE OF A CERTIFICATE OF PARTIAL ACCEPTANCE.

GENERAL NOTES:

- 1. WORK SHALL BE CONSTRUCTED ACCORDING TO THE STANDARD SPECIFICATIONS FOR PUBLIC WORKS CONSTRUCTION (1973 EDITION) WITH 1974 SUPPLEMENTS AND CO. ENGR'S SPECIAL ORDINANCES... 2. NO REPRESENTATIVE OF THE CO. ENGINEER WILL SURVEY OR LAY OUT ANY PORTION OF THE WORK... 3. THE PRIVATE ENGINEER SHALL FURNISH THE CO. ENGINEER WITH GRADE SHEETS AND STATIONING FOR ALL HOUSE LATERALS AND "T" OR "Y" BRANCHES... 4. ALL HOUSE LATERALS SHALL BE CONSTRUCTED IN A STRAIGHT ALIGNMENT AT RIGHT ANGLES FROM THE MAIN LINE SEWER EXCEPT AS SHOWN ON THE PLANS... 5. THE PRIVATE ENGINEER SHALL FURNISH THE HOUSE LATERAL DEPTH AT THE PROPERTY LINE BELOW THE TOP OF CURB ELEVATION FOR EACH HOUSE LATERAL ON THE GRADE SHEET... 6. NO NOTICES SHALL BE MADE IN THESE PLANS WITHOUT THE APPROVAL OF THE CO. ENGINEER... 7. THE CONTRACTOR SHALL NOTIFY THE CO. ENGINEER'S OFFICE DESIGN DIV. (212) 974-7283, AT LEAST TWENTY-FOUR HOURS BEFORE STARTING ANY WORK UNDER THIS CONTRACT... 8. ALL STRUCTURES SHALL BE EITHER BRICK MANHOLES PER S-3 OR PRECAST CONCRETE MANHOLES PER S-30 EXCEPT AS NOTED... 9. MANHOLE TOPS IN UNIMPROVED RIGHTS OF WAY TO BE SIX INCHES ABOVE FINISHED GRADE... 10. REFER TO SECTION 7-10.4.1 OF THE STANDARD SPECIFICATIONS, REGARDING SAFETY ORDERS... 11. WYE OR TEE BRANCHES MAY BE USED FOR CONNECTIONS TO MAINLINE SEWERS EXCEPT AS NOTED... 12. IF A POWER POLE IS WITHIN THREE FEET OF THE SEWER, THE SEWER SHALL BE ENCASED, TWO FEET ON EACH SIDE FROM THE POINT OF INTERFERENCE, PER S-29, C-55E.2... 13. IF DURING THE COURSE OF CONSTRUCTION IT IS DETERMINED THAT THERE IS LESS THAN FOUR FEET OF COVER OVER THE TOP OF A MAIN LINE OR HOUSE LATERAL V.C.P. SEWER WHICH IS NOT INDICATED ON THE PLANS, THE PIPE SHALL BE ENCASED UNLESS OTHERWISE APPROVED BY THE CO. ENGINEER. ENCASEMENT SHALL BE PER S-29, C-55E.3... 14. HOUSE LATERALS TO BE CONSTRUCTED WITH INVERTS AT PROPERTY LINE SIX (6) INCH BELOW CURB GRADE, EXCEPT AS NOTED AND BE 4" MINIMUM DIAMETER... 15. RESURFACE ALL TRENCHES WITHIN PAVED AREAS TO MEET L.A. CO. ROAD DEPT. OR CALIFORNIA STATE HIGHWAY REQUIREMENTS IN ACCORDANCE WITH PERMITS... 16. VITRIFIED CLAY PIPE JOINTS SHALL BE TYPE "D", "E" OR "G" PER STD. SPECS. SEC. 208-2... 17. ALL JOINTS BETWEEN CAST IRON PIPE AND VITRIFIED CLAY PIPE SHALL BE MADE WITH A RUBBER SLIPSE JOINT, TYPE "C" OR "D" (WITH BUSHING IF NECESSARY) PER STANDARD SPECIFICATIONS, SECTION 208-2... 18. SEWERS TO BE TESTED FOR LEAKAGE PER SECTION 306-1.6 OF THE STD. SPECS. AND SPECIAL PROVISIONS... 19. RESURFACE ALL TRENCHES WITHIN PAVED AREAS TO MEET L.A. COUNTY ROAD DEPT. OR CALIF. STATE HIGHWAY REQUIREMENTS IN ACCORDANCE WITH PERMITS... 20. GRADE POINTS FOR TOP OF CURBS, CENTERLINE OF STREETS, OR CENTERLINE OF ALLEYS ARE SHOWN BY CIRCLES ON PROFILES. AT ALL POINTS BETWEEN DESIGNATED POINTS THE GRADE SHALL BE ESTABLISHED SO AS TO CONFORM TO A STRAIGHT LINE DRAWN BETWEEN SAID DESIGNATED POINTS... 21. PRIOR TO ISSUANCE OF THE REQUIRED SEWER CONSTRUCTION PERMIT TO EXCAVATE FROM THE STATE OF CALIFORNIA, DIVISION OF INDUSTRIAL SAFETY, THE CONTRACTOR SHALL OBTAIN A PERMIT TO EXCAVATE FROM THE STATE OF CALIFORNIA, DIVISION OF INDUSTRIAL SAFETY.

THE FOLLOWING LATEST REVISED STANDARD PLANS ON FILE IN THE OFFICE OF THE COUNTY ENGINEER SHALL APPLY IN THE CONSTRUCTION OF THIS PROJECT:

LEGEND: MINIMUM PUBLIC SAFETY REQUIREMENTS S-1; BRICK MANHOLE S-3; STANDARD MANHOLE STEP S-3-7; BEDDING FOR SEWER PIPE S-3-21; CRADLING ENCASMENT S-3-24; WYLLS OR TEE SUPPORT S-3-25; ALLOWABLE TRENCH WIDTHS S-3-35; LOCKING MANHOLE FRAME & COVER S-3-36; NON-REINFORCED PRECAST CONCRETE MANHOLE S-36

COLLECT CHARGES! AS INDICATED!

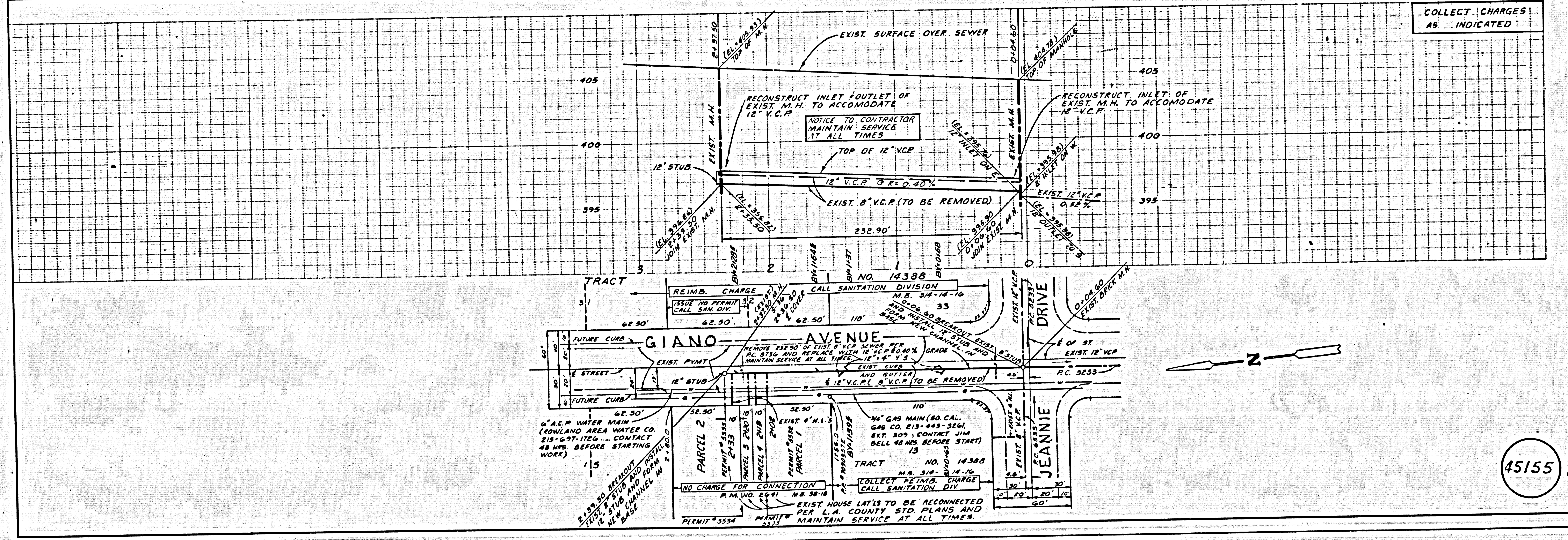

45155