

B.M. BY 3548 ELEV. 44.650

1/4 T. AT W. END OF A.C.B. AT S.W. COR. ROSECRANS AVE. & GRAMERCY PL., 18' W. & 60' S. OF & INT.

GARDENA QUAD. 1972

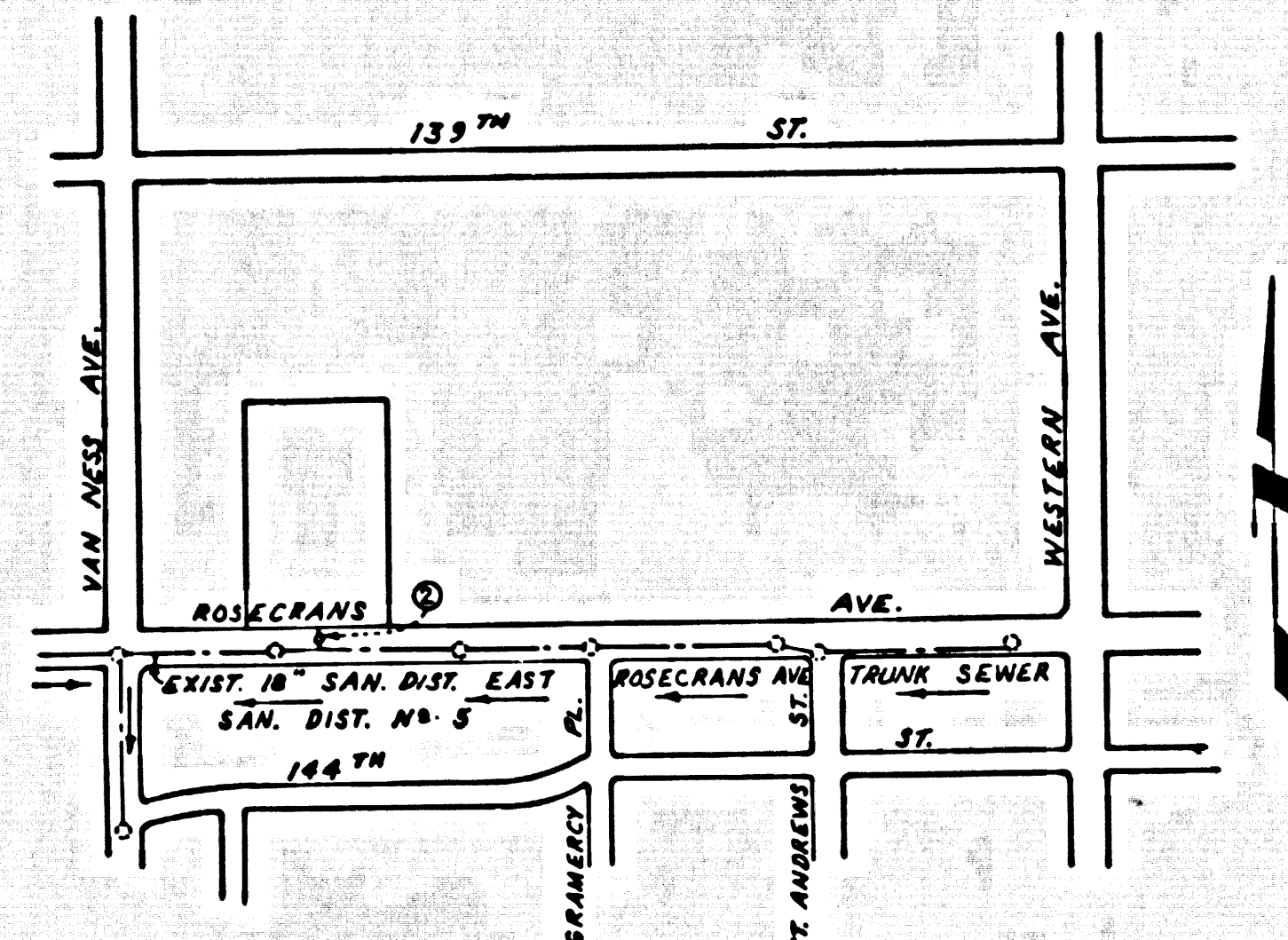

INDEX MAP
P.C. 9197
SCALE: 1" = 600'

19. ALL JOINTS BETWEEN CAST IRON AND VITRIFIED CLAY PIPE SHALL BE MADE WITH A RUBBER SLEEVE JOINT, TYPE "C" OR "D", (WITH BUSHING IF NECESSARY) PER STANDARD SPECIFICATIONS, SECTION 208-5.
20. FULL COMPLIANCE WITH SECTION 304.13.5 OF THE SPECIAL PROVISIONS WILL BE REQUIRED FOR BACKFILL IN STREETS. CERTIFICATION OF BACKFILL COMPACTION AND SAID EQUIVALENTS BY A QUALIFIED REGISTERED TESTING LABORATORY SHALL BE PROVIDED BY THE PERMITTEE PRIOR TO THE ISSUANCE OF A CERTIFICATE OF PARTIAL ACCEPTANCE.

COUNTY SANITATION DISTRICTS SHALL BE NOTIFIED 74 HOURS PRIOR TO THE FOLLOWING SO THAT REQUIRED INSPECTION CAN BE MADE. (PHONE: 962-8035 - 6381151).

COMMENCEMENT OF CONSTRUCTION OF MAINLINE ON DISTRICT TRUNK SEWER.

ACCEPTANCE OF THE PROJECT.

NO CONNECTION FOR THE DISPOSAL OF INDUSTRIAL WASTES SHALL BE MADE TO SEWERS SHOWN ON THESE PLANS UNTIL A PERMIT FOR INDUSTRIAL WASTE WATER DISCHARGE HAS BEEN ISSUED BY THE SANITATION DISTRICTS FOR SAID CONNECTION.

REVISION NO. 2 DATE: 3-16-76
 RELOCATE M.H. TO STA. 1+82.00 FROM STA. 1+00.00 DUE TO WATER LINE PROXIMITY.
 APPROVED BY: *Mark L. Murphy* 3-16-76
 CO. SAN. DIST. NO. 5
 APPROVED BY: *J. D. Parkhurst* 3/17/76

LENNOX BLDG. DIST. NO. 7

PROFILE ALIGNMENT AND GRADE OF P.C. 9197

SANITARY SEWERS PAGE 1

TO BE CONSTRUCTED IN

ROSECRANS AVENUE CROSSING

PRIVATE CONTRACT NO. 9197

W.S. 26

1 SHEET 2 PAGES

SCALE: VERT. 1" = 4' HORIZ. 1" = 40' AUGUST, 1975

PREPARED IN THE OFFICES OF

J.H. EDWARDS CO., INC.

18811 CAENSHAW PLACE

TORRANCE, CALIF. 90504

REG. C.E. NO. 11308

FOR LEGEND SEE PLAN NO.

NOTE:

1. PROFILE STAGES ON THE PROPERTY LINE OR PROPERTY LINES PRODUCED AT RIGHT ANGLES TO THE SEWER LINE AT THE CENTER LINE OF EACH MANHOLE.
2. NO REPRESENTATIVE OF THE COUNTY ENGINEER WILL SURVEY OR LAY OUT ANY PORTION OF THE WORK.
3. THE PRIVATE ENGINEER SHALL FURNISH THE COUNTY ENGINEER WITH GRADE SHEETS AND STATIONING FOR ALL HOUSE LATERALS AND "Y" OR "Y" BRANCHES AND SHALL PROVIDE STAGES FOR THEM AT THEIR PROPER LOCATIONS WITH STATIONING PLANTY MARKERS. ALL HOUSE LATERALS SHALL BE CONSTRUCTED IN A STRAIGHT ALIGNMENT AT RIGHT ANGLES FROM THE MAIN LINE SEWER EXCEPT AS SHOWN ON THE PLANS. HOUSE LATERALS FROM CHIMNEYS SHALL NOT HAVE AN ANGLE OF LESS THAN 45° WITH THE MAIN LINE SEWER. ANY CHANGE IN ALIGNMENT SHALL BE REQUESTED BY WRITING BY THE PRIVATE ENGINEER.
4. THE PRIVATE ENGINEER SHALL MARK THE HOUSE LATERAL SHIFTS AT THE PROPERTY LINE BELOW THE TOP OF CURB ELEVATION FOR EACH HOUSE LATERAL ON THE GRADE SHEET.
5. NO REVISIONS SHALL BE MADE IN THESE PLANS WITHOUT THE APPROVAL OF THE COUNTY ENGINEER.
6. THE CONTRACTOR SHALL NOTIFY THE REGIONAL DIVISION BY TELEPHONE, (818) 974-7263, AT LEAST TWENTY-FOUR HOURS BEFORE STARTING ANY WORK UNDER THIS CONTRACT.
7. ALL STRUCTURES SHALL BE EITHER BRICK MANHOLES PER S-3 OR PRECAST CONCRETE MANHOLES PER S-3A EXCEPT AS NOTED.
8. "Y" OR "Y" BRANCHES MAY BE USED FOR CONNECTIONS TO MAINLINE SEWERS EXCEPT AS NOTED.
9. MANHOLE TOPS IN UNIMPROVED RIGHTS-OF-WAY TO BE SIX INCHES ABOVE FINISHED GRADE.
10. USE EXTRA STRENGTH PIPE. ALL PIPE IS STANDARD DEPTH EXCEPT AS NOTED.
11. VITRIFIED CLAY PIPE JOINTS SHALL BE TYPE "D", "P" OR "S" PER STANDARD SPECIFICATIONS SEC. 208-5. CASE II.
12. IF A POWER POLE IS WITHIN THREE FEET OF THE SEWER, THE SEWER SHALL BE ENCASED, PER S-33(A) TWO FEET ON EACH SIDE FROM THE POINT OF INTERFERENCE.
13. IF DURING THE COURSE OF CONSTRUCTION IT IS DETERMINED THAT THERE IS LESS THAN FOUR FEET OF COVER OVER THE TOP OF A MAIN LINE OR HOUSE LATERAL V.C.P. SEWER WHICH IS NOT INDICATED ON THE PLANS, THE PIPE SHALL BE ENCASED PER S-32, CASE II, UNLESS OTHERWISE APPROVED BY THE COUNTY ENGINEER.
14. HOUSE LATERALS TO BE CONSTRUCTED WITH A 1/4" RISE PER FOOT TO PROPERTY LINE. CITY AS NOTED.
15. RESURFACE ALL TRENCHES WITHIN PAVED AREAS TO MEET L.A. COUNTY ROAD DEPT. OR CALIFORNIA STATE HIGHWAY REQUIREMENTS IN ACCORDANCE WITH PERMITS.
16. SEWERS TO BE TESTED FOR LEAKAGE PER SEC. 306-16 OF THE STR. SPECS. AND SPECIAL PROVISIONS.
17. REFER TO SEC. 7-10.4.1 OF THE STANDARD SPECIFICATIONS REGARDING SAFETY DECKERS.
18. PRIOR TO ISSUANCE OF THE REQUIRED SEWER CONSTRUCTION PERMIT BY THE COUNTY ENGINEER, THE CONTRACTOR SHALL OBTAIN A PERMIT TO ESCAVATE FROM THE STATE OF CALIFORNIA, DIVISION OF INDUSTRIAL SAFETY, 230 E. 4TH STREET, LONG BEACH 90802.

THE FOLLOWING LATEST REVISED STANDARD PLANS ON FILE IN THE OFFICE OF THE COUNTY ENGINEER SHALL APPLY IN THE CONSTRUCTION OF THIS PROJECT.

LEGEND

BRICK MANNHOLE PUBLIC SAFETY REQUIREMENTS	S-1
BRICK MANNHOLE	S-2
NON-REINFORCED PRECAST CONC. MANHOLE	S-3
MANHOLE FRAME AND COVER	S-3A
STANDARD MANHOLE STEP	S-17
RECORDING FOR SEWER PIPE	S-21
WYE OR TEE SUPPORT	S-24
ALLOWABLE TRENCH WIDTH	S-25
CRADLING AND ENCASEMENT	S-33

NOTICE TO CONTRACTOR

The existence and location of any underground utility lines or structures shown on these plans are obtained by a search of the available records. To the best of my knowledge there are no existing utilities except as shown on these plans. The contractor is required to take due precautionary measures to protect the utility lines shown and any other lines not of record or not shown on these plans.

James E. Edwards
REG. E.S. NO. 11302

NOTE: GRADES TO WHICH THIS IMPROVEMENT IS TO BE CONSTRUCTED ARE SHOWN ON PLANS AND PROFILE. GRADE POINTS FOR TOP OF CURBS, CENTER LINE OF STREETS, OR CENTER LINE OF ALLEYS ARE SHOWN BY CIRCLES ON PROFILES AT ALL POINTS BETWEEN DESIGNATED ELEVATIONS AND IN FEET ABOVE U.S.C. & G.S. SEA LEVEL DATUM OF 1929.

THIS DRAWING AND THE DATA HEREON ARE HEREBY MADE A PART OF THE SPECIFICATIONS FOR PUBLIC WORKS CONSTRUCTION (1975 EDITION) AND SHALL BE PROSECUTED ONLY IN THE PRESENCE OF THE COUNTY ENGINEER.

BEFORE WORK CAN BE STARTED, THE CONTRACTOR MUST OBTAIN A PERMIT TO ESCAVATE IN COUNTY STREETS FROM THE L.A. COUNTY ROAD DEPT., DISTRICT OFFICE NO. 3, 3000 WILSON AVENUE, TORRANCE, CALIF. 90504. SUCH A PERMIT SHALL COVER THE COST OF CONSTRUCTION INSPECTION AND RECORD PLANS.

APPROVAL OF THIS PLAN BY THE COUNTY OF LOS ANGELES DOES NOT CONSTITUTE A REPRESENTATION AS TO THE ACCURACY OF THE LOCATION OF OR THE EXISTENCE OR NON-EXISTENCE OF ANY UNDERGROUND UTILITY PIPE, OR STRUCTURE WITHIN THE LIMITS OF THIS PROJECT. THIS NOTE APPLIES TO ALL PAGES.

IF WORK IS TO BE DONE IN A STATE HIGHWAY, A PERMIT MUST BE OBTAINED FROM THE STATE OF CALIFORNIA, DIVISION OF HIGHWAY, 120 SOUTH SPRING STREET, LOS ANGELES, CALIFORNIA.

COUNTY OF LOS ANGELES, CALIFORNIA
 HARVEY T. BRANDT, COUNTY ENGINEER
 APPROVED BY: *Mark L. Murphy* 10-27-75 REGIONAL ENGINEER
 J. D. PARKHURST, CHIEF ENGINEER
 CO. SAN. DIST. NO. 5
 APPROVED BY: *J. D. Parkhurst* OFFICE ENGINEER

CHECKED BY: *Mark L. Murphy* 10-27-75
 REG. C.E. NO. 11308
 REVISION NO. 1 DATE: 2-10-76
 REVISED SEWER PAGE 2 TO CONSTRUCT BY OPEN TRENCH AND DELETE JACKING METHOD
 APPROVED BY: *Mark L. Murphy* 2-10-76
 45368
 J.N. 0358.01

REPLAT OF BLK'S D & E
 OF STRAWBERRY PARK TRACT
 M.B. 8-138
 LOT 63

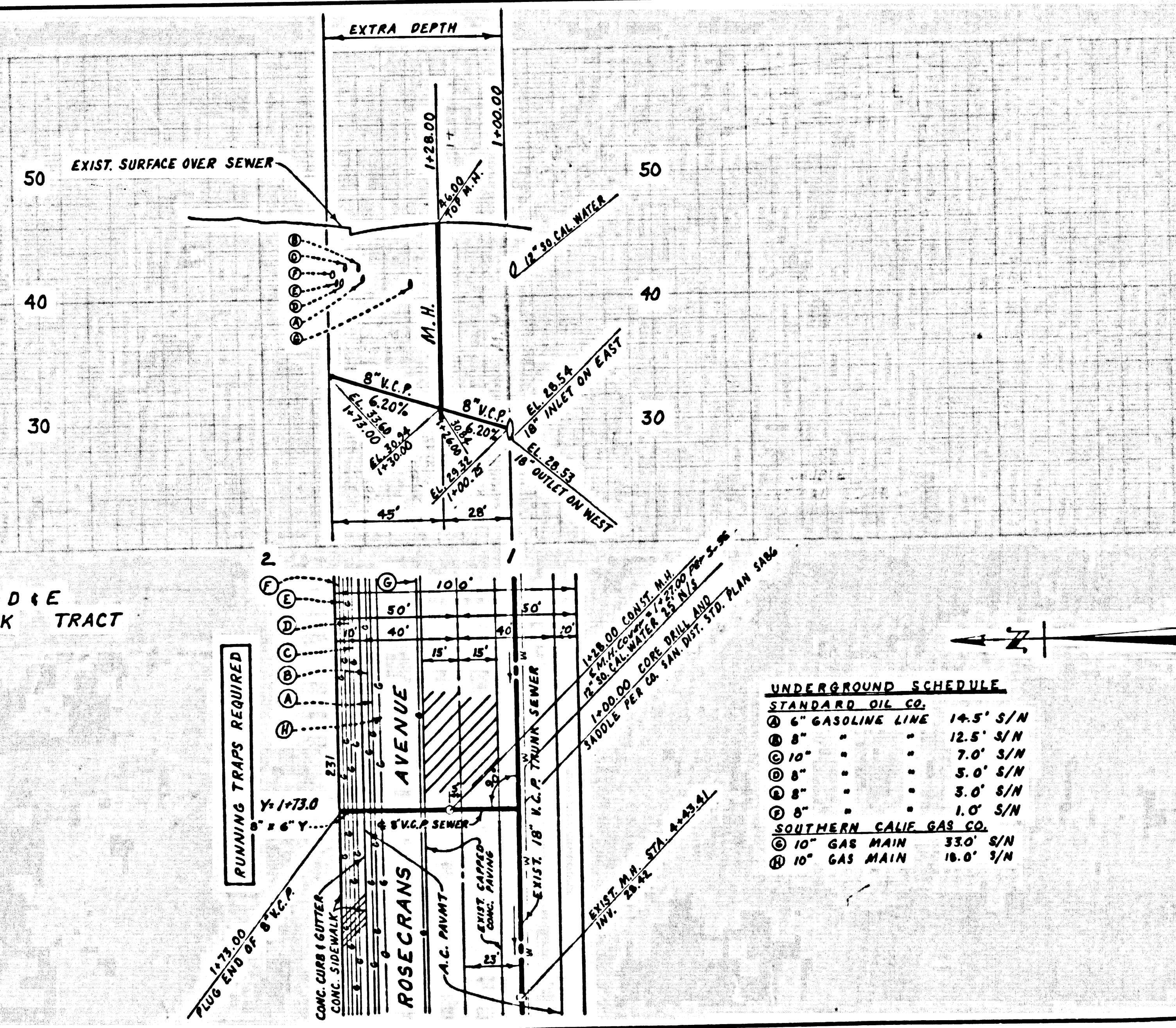

UNDERGROUND SCHEDULE

STANDARD OIL CO.	
6" GASOLINE LINE	14.5' S/N
8" "	12.5' S/N
10" "	7.0' S/N
8" "	5.0' S/N
6" "	3.0' S/N
8" "	1.0' S/N
SOUTHERN CALIF. GAS CO.	
10" GAS MAIN	33.0' S/N
10" GAS MAIN	18.0' S/N

P.C. 9197 PAGE 2

NO CHARGE FOR CONNECTIONS
DOUBLE SCALE

45369