

B.M. 7243 ELEV. 51.248  
 RDBM TAG N.C.B. 1 FT. W. B.C.R. @ N.W. COR. PRAIRIE AVE. + COMPTON BLVD.  
 75 FT. W. + 32 FT. N. C/L INTERSECTION.  
 TORRANCE QUAD. 1970

LENNOX BLDG. DIST. NO. 7

PROFILE ALIGNMENT AND GRADE OF  
 SANITARY SEWERS  
 TO BE CONSTRUCTED IN  
 P.C. 9262  
 PAGE 1

TRACT NO 31494  
 PRIVATE CONTRACT NO. 9262

W.S. 25  
 2 SHEETS; 4 PAGES  
 SCALE: VERT. 1"=8'  
 HORIZ. 1"=40'  
 MAY, 1976  
 45,625  
 PREPARED IN THE OFFICES OF  
 ENGINEERING SERVICE CORPORATION  
 4676 ADMIRALTY WAY, SUITE 333, MARINA DEL REY, CALIFORNIA 90291  
 BY: J.K. Newville  
 REG. C. E. NO. 13095

NOTES:  
 1. 8" V.C.P. ON ALL STREETS  
 2. NUMBERS IN CIRCLES INDICATE PAGE NUMBER

NOTES CONTINUED:

- PRIOR TO THE ISSUANCE OF THE REQUIRED SEWER CONSTRUCTION PERMIT BY THE COUNTY ENGINEER, THE CONTRACTOR SHALL OBTAIN A PERMIT TO EXCAVATE FROM THE STATE OF CALIFORNIA, DIVISION OF INDUSTRIAL SAFETY.
- ALL JOINTS BETWEEN CAST IRON PIPE AND VITRIFIED CLAY PIPE SHALL BE MADE WITH A RUBBER SLEEVE JOINT, TYPE "C" OR "D" (WITH BUSHING IF NECESSARY) PER STANDARD SPECIFICATIONS, SECTION 208-2.
- THE JAMES BEHNER (21) 776-7220 SHALL BE NOTIFIED A MINIMUM OF 48 HOURS PRIOR TO COMMENCING CONSTRUCTION OR EXCAVATION IN THE VICINITY OF THE DISTRICT TRUNK SEWER.
- THE EXISTING MANHOLE IN PROPOSED 152 ND STREET WILL BE ADJUSTED TO NEW GRADE BY DISTRICT PERSONNEL IN ACCORDANCE WITH THE PROCEEDURE OF FORM 1-128.
- A MINIMUM COVER OVER THE DISTRICT TRUNK SEWER SHALL NOT BE LESS THAN 4.5 FEET, AND GRADING EQUIPMENT SHALL NOT EXCEED A LOADING OF 3700 POUNDS PER WHEEL OVER THE TRUNK SEWER.
- ALL COMPLIANCE WITH SECTION 306-1.3.5 OF THE SPECIAL PROVISIONS WILL BE REQUIRED FOR BACKFILL IN STREETS.
- CERTIFICATION OF BACKFILL COMPACTION AND SAND EQUIVALENTS BY A QUALIFIED, REGISTERED TESTING LABORATORY SHALL BE PROVIDED BY THE PERMITTEE PRIOR TO THE ISSUANCE OF A CERTIFICATE OF PARTIAL ACCEPTANCE.

REVISION NO. 2 SEPT. 1, 1976  
 RAISED SEWER LINE BY 2' FOR POLLY AVE. AND ADJUSTED SEWER LINE GRADE FOR 152 ND ST.  
 APPROVED: Michael Hagan  
 R.C.E. NO. 22022

- PROVIDE STAKES ON THE PROPERTY LINE OR PROPERTY LINES PRODUCED AT RIGHT ANGLES TO THE SEWER LINE AT THE CENTER LINE OF EACH MANHOLE.
- NO REPRESENTATIVE OF THE COUNTY ENGINEER WILL SURVEY OR LAY OUT ANY PORTION OF THE WORK.
- THE PRIVATE ENGINEER SHALL FURNISH THE COUNTY ENGINEER WITH GRADE SHEETS AND STATIONING FOR ALL HOUSE LATERALS AND "T" OR "Y" BRANCHES AND SHALL PROVIDE STAKES FOR THEM AT THEIR PROPER LOCATIONS WITH STATIONING PLAINLY MARKED. ALL HOUSE LATERALS SHALL BE CONSTRUCTED IN A STRAIGHT ALIGNMENT AT RIGHT ANGLES FROM THE MAIN LINE SEWER EXCEPT AS SHOWN ON THE PLANS. HOUSE LATERALS FROM CHIMNEYS SHALL NOT HAVE AN ANGLE OF LESS THAN 45° WITH THE MAIN LINE SEWER. ANY CHANGE IN ALIGNMENT SHALL BE REQUESTED IN WRITING BY THE PRIVATE ENGINEER.
- THE PRIVATE ENGINEER SHALL FURNISH THE HOUSE LATERAL DEPTH AT THE PROPERTY LINE BELOW THE TOP OF CURB ELEVATION FOR EACH HOUSE LATERAL ON THE GRADE SHEET.
- NO REVISIONS SHALL BE MADE IN THESE PLANS WITHOUT THE APPROVAL OF THE COUNTY ENGINEER.
- THE CONTRACTOR SHALL NOTIFY THE DESIGN DIVISION BY TELEPHONE, MADISON 3747283, AT LEAST TWENTY-FOUR HOURS BEFORE STARTING ANY WORK UNDER THIS CONTRACT.
- ALL MANHOLES SHALL BE BRICK SEWER STRUCTURES OR PRECAST CONCRETE MANHOLES PER S-36, EXCEPT AS NOTED.
- WYE OR TEE BRANCHES MAY BE USED FOR CONNECTIONS TO MAIN LINE SEWERS, EXCEPT AS NOTED.
- MANHOLE TOPS IN UNIMPROVED RIGHTS-OF-WAY TO BE SIX INCHES ABOVE FINISHED GRADE.
- USE EXTRA STRENGTH PIPE. ALL PIPE IS STANDARD DEPTH EXCEPT AS NOTED.
- VITRIFIED CLAY PIPE JOINTS SHALL BE TYPE "D" OR "B" PER STD. SPEC'S SEC. 208-2.
- IF A POWER POLE IS WITHIN THREE FEET OF THE SEWER, THE SEWER SHALL BE ENCASED, PER S-23, TWO FEET ON EACH SIDE FROM THE POINT OF INTERFERENCE.
- IF DURING THE COURSE OF CONSTRUCTION IT IS DETERMINED THAT THERE IS LESS THAN FOUR FEET OF COVER OVER THE TOP OF A MAIN LINE OR HOUSE LATERAL V.C.P. SEWER WHICH IS NOT INDICATED ON THE PLANS, THE PIPE SHALL BE ENCASED PER S-23, UNLESS OTHERWISE APPROVED BY THE COUNTY ENGINEER.
- HOUSE LATERALS TO BE CONSTRUCTED WITH INVERTS AT PROPERTY LINE 4 FEET BELOW CURB GRADE EXCEPT AS NOTED.
- RESURFACE ALL TRENCHES WITHIN PAVED AREAS TO MEET L.A. COUNTY ROAD DEPT. OR CALIFORNIA STATE HIGHWAY REQUIREMENTS IN ACCORDANCE WITH PERMITS.
- SEWERS TO BE TESTED FOR LEAKAGE PER SECTION 306-1.4 UNIFORM STANDARD SPECIFICATIONS.
- REFER TO SECTION 7-10.4.1 OF THE STANDARD SPECIFICATIONS, REGARDING SAFETY ORDERS.
- SPECIAL BACKFILL IN DESIGNATED AREAS:  
 (a) BACKFILL TRENCH AND REPLACE OTHER EARTH REMOVED SO AS TO ACHIEVE THE NATURAL OR FINISHED GRADES AND SLOPES SHOWN ON THE GRADING PLAN APPROVED FOR THE TRACT BY THE BUILDING AND SAFETY DIVISION.  
 (b) ALL BACKFILL AND EARTH REPLACED SHALL BE COMPACTED TO A MINIMUM OF 90% OF MAXIMUM DENSITY PER A.S.T.M. STAND. AND METHOD OF TEST D998-57 AS MODIFIED. ACCEPTABLE CERTIFICATION OF SUCH COMPACTION SHALL BE SUBMITTED TO THE DESIGN DIVISION.  
 (c) OIL AND GAS LINES SHOWN HEREON WILL BE REMOVED WITHIN STREET RIGHTS OF WAY PRIOR TO CONSTRUCTION OF SANITARY SEWERS. CONTRACTOR TO VERIFY WITH ENGINEER THE FOLLOWING LATEST REVISED STANDARD PLANS OF FILL IN THE OFFICE OF THE COUNTY ENGINEER SHALL APPLY IN THE CONSTRUCTION OF THIS PROJECT.

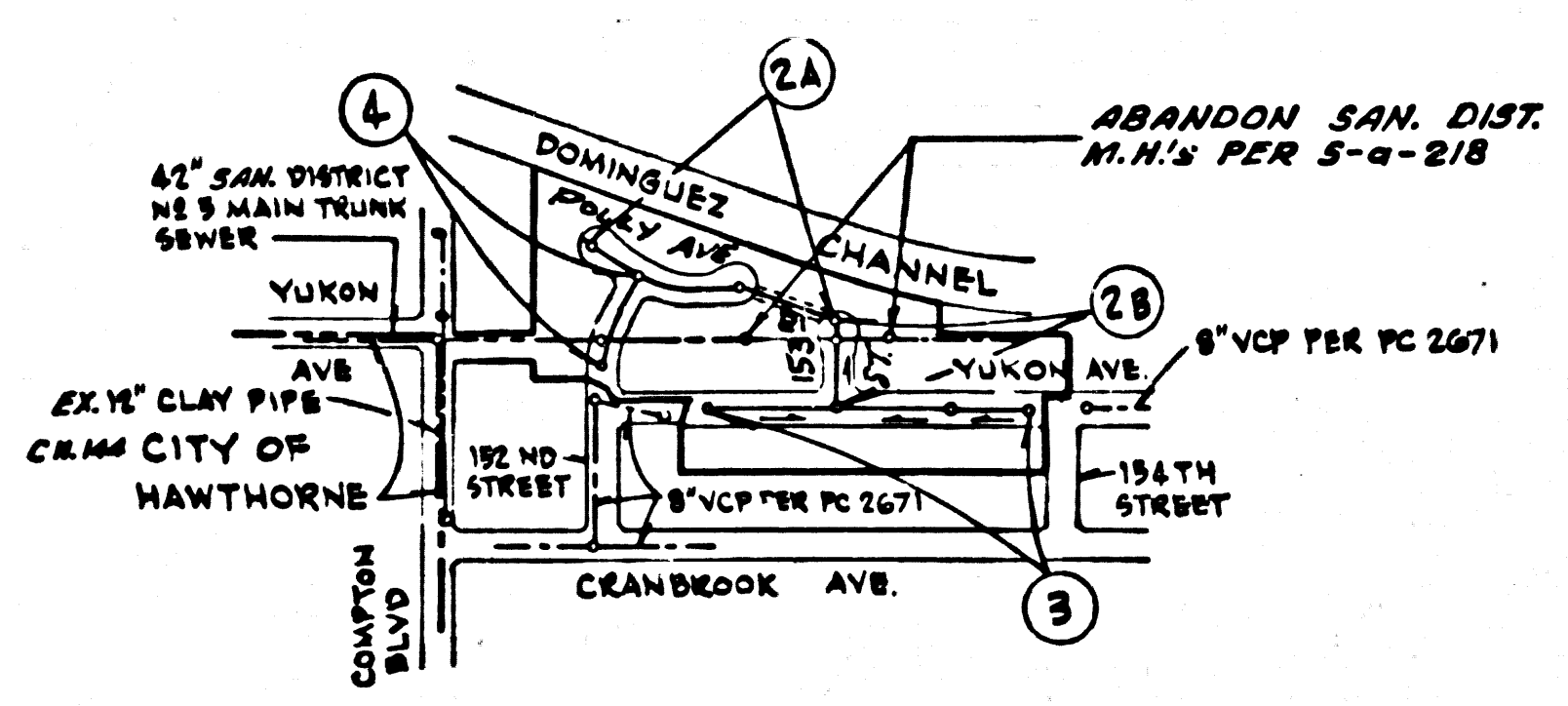

INDEX MAP  
 TRACT NO 31494  
 P.C. 9262  
 SCALE 1"=600'

PRIVATE ENGINEER'S  
 NOTICE TO CONTRACTOR

THE EXISTENCE AND LOCATION OF ANY UNDERGROUND UTILITY PIPES OR STRUCTURES SHOWN ON THESE PLANS ARE OBTAINED BY A SEARCH OF THE AVAILABLE RECORDS, TO THE BEST OF OUR KNOWLEDGE. THERE ARE NO EXISTING UTILITIES EXCEPT AS SHOWN ON THIS MAP. THE CONTRACTOR IS REQUIRED TO TAKE PRECAUTIONARY MEASURES TO PROTECT THE UTILITY LINES SHOWN AND ANY OTHER LINES NOT BE RECORDED OR NOT SHOWN ON THIS DRAWING.

REVISION NO. 1 AUG. 24, 1976  
 ELIMINATED TRAP CASTING AT M.H. STA. 1+25.45 2-8, AND M.H. STA. 2+60.17 2-C.  
 APPROVED: [Signature]  
 R.C.E. NO. 16610

OIL COMPANIES  
 GULF OIL (23) 821-3501  
 STD. OIL " 521-5200  
 TEXACO " 634-2269

COLLECT CHARGES  
 AS INDICATED

COUNTY OF LOS ANGELES, CALIFORNIA  
 DEPARTMENT OF COUNTY ENGINEER  
 APPROVED BY: [Signature]  
 REGIONAL ENGINEER

CHECKED BY: Martin L. Murphy, J-1-76  
 REG. C.E. NO. 18,594

J.N. 0250.02

NO CONNECTION FOR THE DISPOSAL OF INDUSTRIAL WASTES SHALL BE MADE TO SEWERS SHOWN ON THESE DRAWINGS UNTIL A PERMIT FOR INDUSTRIAL WASTE WATER DISCHARGE HAS BEEN ISSUED BY THE SANITATION DISTRICTS FOR SAID CONNECTION.

Contractor agrees that he shall assume sole and complete responsibility for job site conditions during the course of construction of this Project, including safety of all persons and property; that this requirement shall apply continuously and not be limited to normal working hours; and that the Contractor shall defend, indemnify and hold the Owner and the Engineer harmless from any and all liability, real or alleged, in connection with the performance of work on this Project, excepting for liability arising from the sole negligence of the Owner or the Engineer.

NOTE: LOT 1 SERVED FROM EXIST. H.L. IN COMPTON BLVD PER P.C. 2671

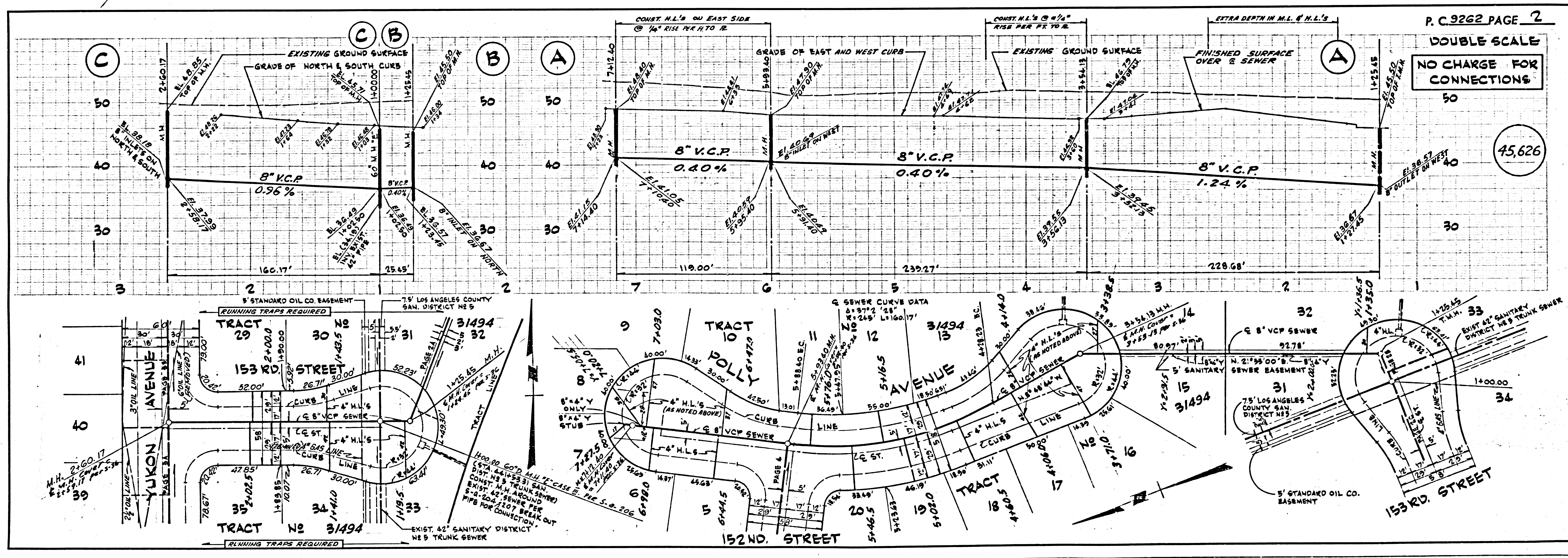

P.C. 9262 PAGE 2  
 DOUBLE SCALE  
 NO CHARGE FOR CONNECTIONS  
 45,626

