

B.M. 9043 ELEV 728.626
R.O. B.M. 209 IN C.D. 2'S B.C.R. 25 11'S
1/48° E. INT. LAS VIRGENES RD.
1/4 OLD HIGHWAY ON RAMP/ARCADE ST.
MALIBU QUAD. 19 72

- 1. ALL CONTRACTORS TO BE CERTIFIED UNDER THE GENERAL PROVISIONS THAT ALL CONTRACTS FOR SEWER WORK SHALL BE SUBJECT TO THE GENERAL PROVISIONS AND THAT CONTRACTORS SHALL BE REQUIRED TO BE A QUALIFIED, LICENSED TRADE LABORER, WHO SHALL BE EMPLOYED BY THE CONTRACTOR FOR THE PERFORMING OF THE WORK AND TO BE REGISTERED WITH THE STATE OF CALIFORNIA.
 - 2. THE CONTRACTOR SHALL BE RESPONSIBLE FOR THE PROTECTION OF ALL UTILITIES WHICH ARE LOCATED UNDER THE SURFACE OF THE PROJECT AND SHALL BE REQUIRED TO REPAIR OR REPLACE ANY UTILITIES WHICH ARE DAMAGED BY HIS OPERATIONS.
- THE FOLLOWING LISTED SEWER STRUCTURES SHALL BE THE PROPERTY OF THE COUNTY ENGINEER:
- | | |
|--------------------------|-----|
| 1. ALL SEWER STRUCTURES | 8-1 |
| 2. ALL SEWER STRUCTURES | 8-1 |
| 3. ALL SEWER STRUCTURES | 8-1 |
| 4. ALL SEWER STRUCTURES | 8-1 |
| 5. ALL SEWER STRUCTURES | 8-1 |
| 6. ALL SEWER STRUCTURES | 8-1 |
| 7. ALL SEWER STRUCTURES | 8-1 |
| 8. ALL SEWER STRUCTURES | 8-1 |
| 9. ALL SEWER STRUCTURES | 8-1 |
| 10. ALL SEWER STRUCTURES | 8-1 |
| 11. ALL SEWER STRUCTURES | 8-1 |
| 12. ALL SEWER STRUCTURES | 8-1 |
| 13. ALL SEWER STRUCTURES | 8-1 |
| 14. ALL SEWER STRUCTURES | 8-1 |
| 15. ALL SEWER STRUCTURES | 8-1 |

NOTE: Figures in circles indicate page numbers.

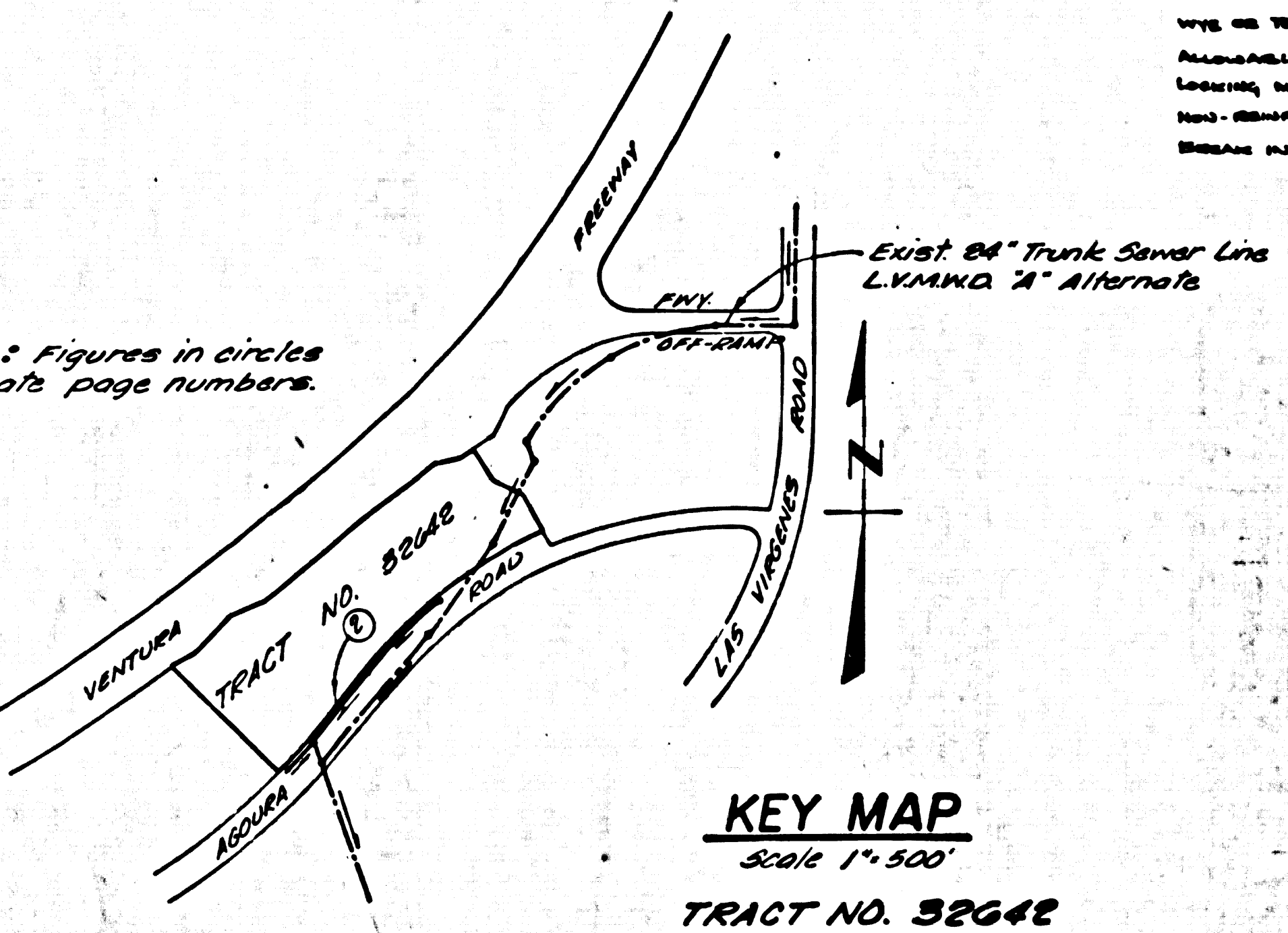

REVISION NO. 2 DATE 6/2/85
ADDED M.H. AT STA. 3402.00 AND REVERSED GRADE BET. STA. 3404.00 & STA. 3406.00, INCLUDE S.D.I.P. BETWEEN STA. 3406.00 & STA. 3408.00 TO AVOID INTERFERENCE WITH EXISTING 60" L.V. M.H.C.D., MARK OF PAGE 2-B.
Sally G. Bell
OFFICIAL COUNTY ENGINEER

REVISION NO. 1 DATE 5/27/84
LOWERED 8" V.C.P. SEWER BETWEEN STA. 3102.00 AND STA. 3106.00, ENCRUSTMENT AT STA. 3104.57 AND 8" TO AVOID INTERFERENCE WITH EXISTING 60" L.V. M.H.C.D.
Sally G. Bell
OFFICIAL COUNTY ENGINEER

COLLECT CHARGES AS INDICATED

DOUBLE SCALE CALABASAS BLDG. DIST. NO. 91

PROFILE, ALIGNMENT AND GRADE OF
SANITARY SEWERS PAGE 1
TO BE CONSTRUCTED IN

TRACT NO. 32642
PRIVATE CONTRACT NO. 9323

W.S. 90
1 SHEETS, 2 PAGES
SCALE: VERT. 1"=4'
HORIZ. 1"=40'
AUGUST, 1976

51059

PREPARED BY THE OFFICE OF
JENNINGS ENGINEERING COMPANY
7144 Balboa Boulevard Van Nuys, California 91405

FOR LEGEND SEE PLAN NO. S-1

GRABES TO WHICH THE IMPROVEMENT IS TO BE CONSTRUCTED ARE INDICATED ON PLANS AND PROFILES. GRADE POINTS FOR TOP OF CURB, CENTER LINE OF STREET, OR CENTER LINE OF HIGHWAY ARE SHOWN BY DOTTED OR SOLID LINE BETWEEN INDICATED POINTS. THE GRADE SHALL BE ESTABLISHED AS APPLICABLE TO A STANDARD LINE DRAWING BETWEEN SAID INDICATED POINTS IN ACCORDANCE WITH THE LATEST EDITION OF THE U.S. GOVERNMENT PRINTING OFFICE STANDARD DRAWING SYSTEM. THE CONTRACTOR SHALL BE RESPONSIBLE FOR OBTAINING ANY NECESSARY PERMITS FROM THE CITY, COUNTY, STATE, FEDERAL GOVERNMENT OR ANY OTHER AGENCY THAT MAY BE NECESSARY FOR THE PROTECTION OF UTILITIES WHICH ARE LOCATED UNDER THE SURFACE OF THE PROJECT AND SHALL BE REQUIRED TO REPAIR OR REPLACE ANY UTILITIES WHICH ARE DAMAGED BY HIS OPERATIONS.

COUNTY OF LOS ANGELES, CALIFORNIA
STEPHEN J. HODGINS COUNTY ENGINEER
APPROVED *[Signature]* DATE 11/29/77
PROF. ENGR. REG. NO. 17723

GENERAL MANAGER

J.N. 0180-02

