

B.M. BL 1740 ELEV 1305.664  
 U.S.G.S. MARK 3 in UP CORNER SE COR BRUNET C.V.  
 RD UNDER TRANSMISSION LINE 0.1 M. N.W.  
 SUSAN BETH WAY AND K2 NE 2 1/2 IN 3 FT UP  
 2 FT W  
 NEWHALL QUAD. 1972

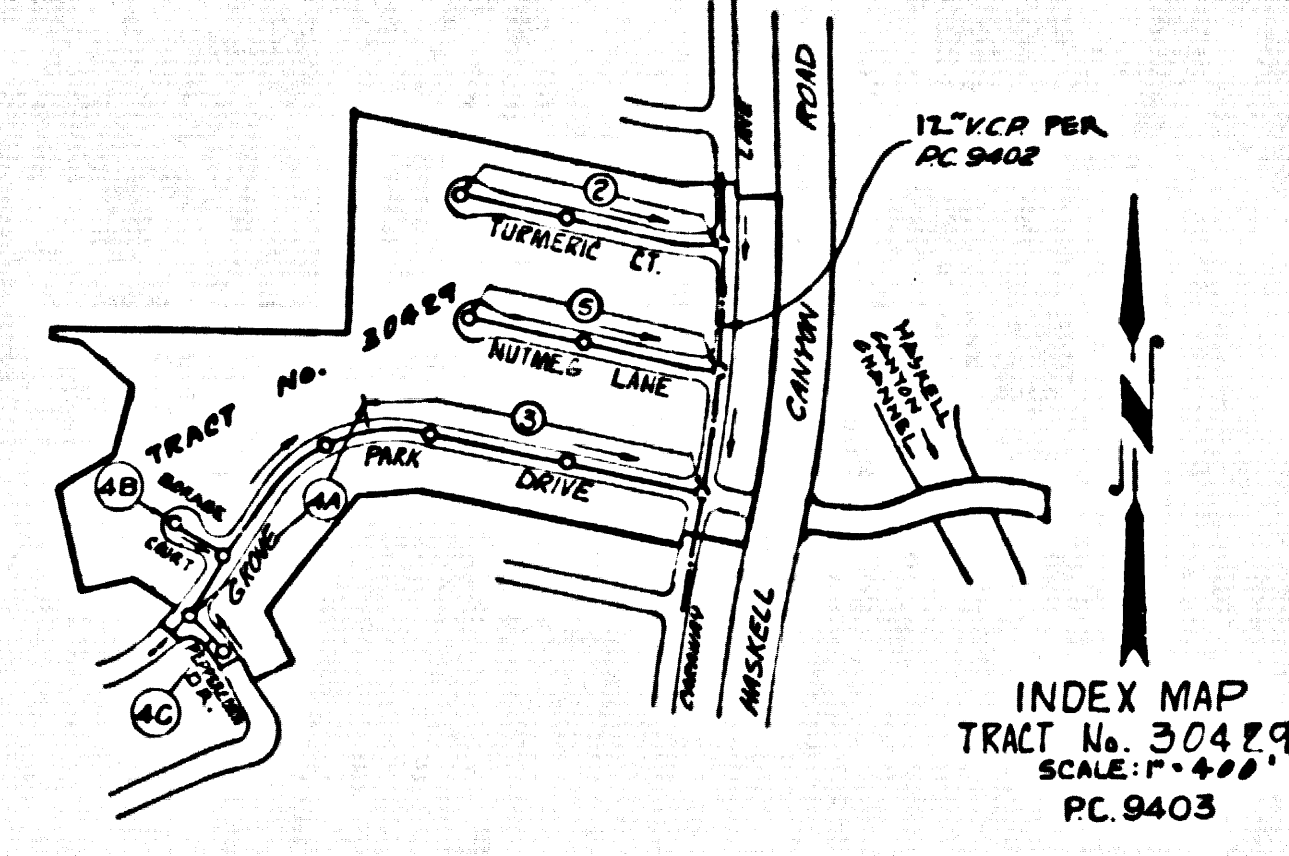

ALLOW NO CONNECTIONS  
 UNTIL P.C. SCALE IS  
 PRINTED PER P.S. 1336-19-8

LOTS 81 TO 88 INCLUSIVE TO  
 BE SERVED FROM P.C. 9402

- GENERAL NOTES:**
1. SECTIONS ARE IN FEET ABOVE M.S.L. & S.E. SEA LEVEL DATUM OF 1929.
  2. NO SECTIONS SHALL BE MADE IN THESE PLANS WITHOUT THE APPROVAL OF THE COUNTY ENGINEER.
  3. NO REPRESENTATIVE OF THE COUNTY ENGINEER WILL BE ON THE JOB AT ANY TIME OF THE WORK.
  4. GRADES TO WHICH THE IMPROVEMENT IS TO BE CONSTRUCTED ARE SHOWN ON PLANS AND PROFILES. GRADE POINTS FOR P.O.P. OF CURVE, CENTER LINE OF STRAIGHT, OR CENTER LINE OF ALLEYS ARE SHOWN BY CIRCLES ON PROFILES AT ALL POINTS BETWEEN B.Y.P.S. AND POINTS WHERE THE GRADE SHALL BE ESTABLISHED AS TO CORNER TO A STRAIGHT LINE BEHIND THE LAST DESIGNATED POINT.
  5. THE PRIVATE ENGINEER SHALL FURNISH THE COUNTY ENGINEER WITH GRADE SHEETS AND STATIONING FOR ALL HOUSE LATERALS AND "T" OR "Y" BRANCHES AND SHALL PROVIDE STAKES FOR THEM AT PROPER LOCATIONS WITH STATIONING PLAINLY MARKED. ALL HOUSE LATERALS SHALL BE CONSTRUCTED BY A STRAIGHT ALIGNMENT OF HOUSE LATERALS FROM THE MAIN LINE SEWER EXCEPT AS SHOWN ON THE PLANS. HOUSE LATERALS FROM CHIMNEYS SHALL HAVE AN ANGLE OF LESS THAN 45° WITH THE MAIN LINE SEWER. ANY CHANGE IN ALIGNMENT SHALL BE INDICATED BY WRITING ON THE IMPART DRAWING.
  6. THE PRIVATE ENGINEER SHALL FURNISH THE HOUSE LATERAL SHEET AT THE PROPERTY AND SHOW THE TOP OF CURVE STATIONING FOR EACH HOUSE LATERAL ON THE GRADE SHEET.
  7. BEFORE WORK CAN BE STARTED, THE CONTRACTOR MUST OBTAIN A PERMIT TO EXCAVATE IN COUNTY STREETS FROM THE L.A. COUNTY ROAD DEPT., DISTRICT OFFICE NO. 8, AND PAY A FEE TO THE COUNTY ENGINEER, SANTA CLARITA VALLEY.
  8. IF WORK IS TO BE DONE ON A STATE HIGHWAY, A PERMIT MUST BE OBTAINED FROM THE STATE OF CALIFORNIA, DIVISION OF HIGHWAYS, 120 SOUTH BRIDGE STREET, LOS ANGELES, CALIFORNIA.
  9. APPROVAL OF THE PLAN BY THE COUNTY OF LOS ANGELES DOES NOT CONSTITUTE A REPRESENTATION AS TO THE ACCURACY OF THE LOCATION OF OR THE EXISTENCE OR NON-EXISTENCE OF ANY UNDERGROUND SERVICE PIPE, OR STRUCTURE WITHIN THE LIMITS OF THE PROJECT THE NOTE APPLIES TO ALL NOTES.
  10. REFER TO SECTION 7.16.4.1 OF THE STANDARD SPECIFICATIONS, PROVISIONS, PROVISIONS, SAFETY CODES.
  11. PRIOR TO THE COMMENCEMENT OF CONSTRUCTION FROM THE COUNTY ENGINEER, THE CONTRACTOR SHALL OBTAIN A "TREATY TO EXCAVATE" FROM THE STATE OF CALIFORNIA DIVISION OF INDUSTRIAL SAFETY.

PROFILE, ALIGNMENT AND GRADE OF  
**SANITARY SEWERS** PAGE 1  
 TO BE CONSTRUCTED BY  
**TRACT No. 30429**  
 PRIVATE CONTRACT NO. 9403  
 INDEX 273-S-129  
 W.S. 621-B-1 (47633)  
 3 SHEETS, 5 PAGES  
 SCALE: HORIZ. 1" = 40' VERT. 1" = 4'  
 MAY, 1977  
 PREPARED IN THE OFFICE OF  
**SPINDLER ENGINEERING CORPORATION**  
 13720 BIVENSIDE DR., SHEERMAN OAKS, CALIF., 91423  
 BY: *Spindler*  
 REG. C. E. No. 13774

- CONSTRUCTION NOTES:**
1. WORK SHALL BE CONSTRUCTED ACCORDING TO THE STANDARD SPECIFICATIONS FOR PUBLIC WORKS CONSTRUCTION WITH SECTION 7.16.4.1 OF THE STANDARD SPECIFICATIONS FOR THE CONSTRUCTION OF SANITARY SEWERS BATTER 1:4 TO 1:6.
  2. THE CONTRACTOR SHALL VERIFY THE EXISTING ELEVATION BY MEANS OF A LEVEL FROM THE POINT OF BEGINNING OF THE CONTRACT.
  3. HOUSE LATERALS TO BE CONSTRUCTED WITH BATTERS AS INDICATED ON THE PLAN. EXCEPT AS SHOWN OTHERWISE ON THE PLAN.
  4. ALL STRUCTURES SHALL BE BUILT TO THE STANDARD SPECIFICATIONS FOR 24" DIA. RCP WITH A MINIMUM COVER OF 24" UNLESS OTHERWISE APPROVED BY THE COUNTY ENGINEER.
  5. ALL JOINTS BETWEEN CAST IRON PIPE AND VITRIFIED CLAY PIPE SHALL BE MADE WITH A RUBBER GASKET JOINT, TYPE "C" OR "D", WITH JOINTS OF NECESSARY FOR STANDARD SPECIFICATIONS, SECTION 7.16.4.
  6. BEFORE THE COMMENCEMENT OF CONSTRUCTION IT IS THE RESPONSIBILITY OF THE CONTRACTOR TO OBTAIN A PERMIT TO EXCAVATE FROM THE COUNTY ENGINEER, SANTA CLARITA VALLEY.
  7. BEFORE THE COMMENCEMENT OF CONSTRUCTION IT IS THE RESPONSIBILITY OF THE CONTRACTOR TO OBTAIN A PERMIT TO EXCAVATE FROM THE COUNTY ENGINEER, SANTA CLARITA VALLEY.
  8. BEFORE THE COMMENCEMENT OF CONSTRUCTION IT IS THE RESPONSIBILITY OF THE CONTRACTOR TO OBTAIN A PERMIT TO EXCAVATE FROM THE COUNTY ENGINEER, SANTA CLARITA VALLEY.
  9. BEFORE THE COMMENCEMENT OF CONSTRUCTION IT IS THE RESPONSIBILITY OF THE CONTRACTOR TO OBTAIN A PERMIT TO EXCAVATE FROM THE COUNTY ENGINEER, SANTA CLARITA VALLEY.
  10. BEFORE THE COMMENCEMENT OF CONSTRUCTION IT IS THE RESPONSIBILITY OF THE CONTRACTOR TO OBTAIN A PERMIT TO EXCAVATE FROM THE COUNTY ENGINEER, SANTA CLARITA VALLEY.
  11. BEFORE THE COMMENCEMENT OF CONSTRUCTION IT IS THE RESPONSIBILITY OF THE CONTRACTOR TO OBTAIN A PERMIT TO EXCAVATE FROM THE COUNTY ENGINEER, SANTA CLARITA VALLEY.
  12. BEFORE THE COMMENCEMENT OF CONSTRUCTION IT IS THE RESPONSIBILITY OF THE CONTRACTOR TO OBTAIN A PERMIT TO EXCAVATE FROM THE COUNTY ENGINEER, SANTA CLARITA VALLEY.
  13. BEFORE THE COMMENCEMENT OF CONSTRUCTION IT IS THE RESPONSIBILITY OF THE CONTRACTOR TO OBTAIN A PERMIT TO EXCAVATE FROM THE COUNTY ENGINEER, SANTA CLARITA VALLEY.
  14. BEFORE THE COMMENCEMENT OF CONSTRUCTION IT IS THE RESPONSIBILITY OF THE CONTRACTOR TO OBTAIN A PERMIT TO EXCAVATE FROM THE COUNTY ENGINEER, SANTA CLARITA VALLEY.

THE FOLLOWING LISTED STANDARD PLANS ON FILE IN THE OFFICE OF THE COUNTY ENGINEER SHALL APPLY IN THE CONSTRUCTION OF THIS PROJECT:

STANDARD PUBLIC SAFETY ENGINEERING	5-1
STANDARD SANITARY ENGINEERING	5-2
STANDARD SEWER PIPE	5-3
STANDARD SEWER MANHOLE	5-4
STANDARD SEWER TRENCH	5-5
STANDARD SEWER VALVE	5-6
STANDARD SEWER CLEANOUT	5-7
STANDARD SEWER CLEANOUT VALVE	5-8
STANDARD SEWER CLEANOUT VALVE COVER	5-9
STANDARD SEWER CLEANOUT VALVE COVER	5-10
SPECIAL HOUSE LATERALS	5-11

COUNTY OF LOS ANGELES, CALIFORNIA  
 STEPHEN J. KOHCE ACTING COUNTY ENGINEER JOHN D. PARKHURST, CHIEF ENGINEER  
 APPROVED *Spindler* DATE APPROVED *Parkhurst* DATE  
 CHECKED *Spindler* DATE  
 REG. C. E. No. 16742  
 SANTA CLARITA VALLEY BLDG. DIST. B.2 1 N. 0250 02

