

B.M. BY 9189 ELEV. 1013.58
 LEAD AND BRASS NAIL, WEST CURB
 UNDER GANTRY ROAD 1 FT SOUTH OF
 B.C.R. 80 FT SOUTH & 45 FT WEST OF
 CENTERLINE INTERSECTION THOUSAND OAKS
 BOULEVARD
 MALIBU QUAD. 19 24

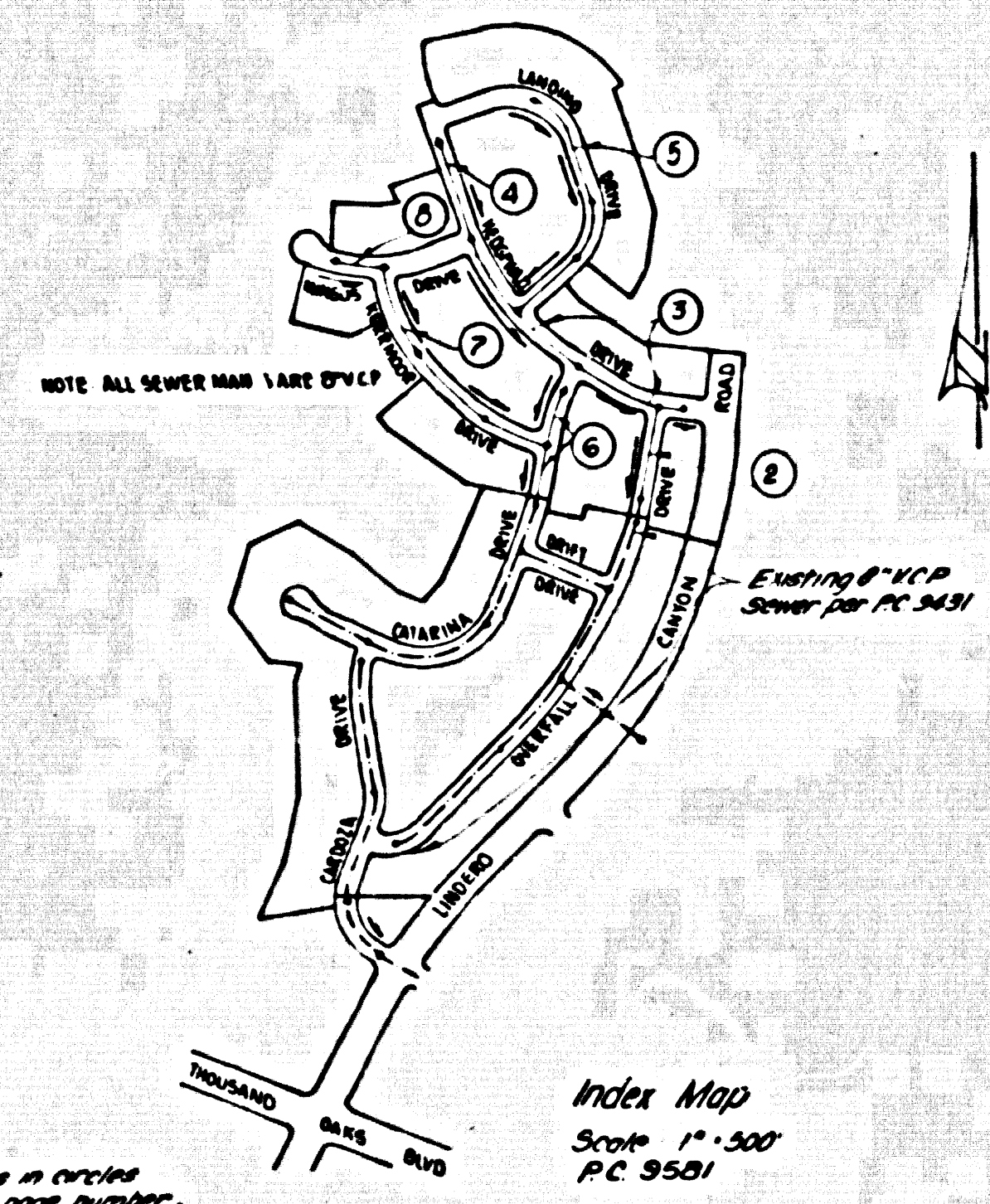

NOTE: Number in circles refer to page number.

NOTE: LOTS 17, 18, 19 & 20 ARE OPEN SPACES NO HOUSE LATERALS ARE REQUIRED.

ISSUE NO PERMITS UNTIL PC 9581, TRACT NO. 32994 IS ACCEPTED.

GENERAL NOTES:

1. REVISIONS ARE TO BE MADE BY THE COUNTY ENGINEER.
2. NO REVISIONS SHALL BE MADE AT THESE PLANS WITHOUT THE APPROVAL OF THE COUNTY ENGINEER.
3. NO REPRESENTATIVE OF THE COUNTY ENGINEER SHALL BE PRESENT AT THE CONSTRUCTION OF SANITARY SEWERS EXCEPT FOR THE PURPOSE OF OBSERVING THE CONSTRUCTION.
4. GRADES TO WHICH THE IMPROVEMENTS ARE TO BE CONSTRUCTED ARE SHOWN BY CIRCLES ON PROFILES AT ALL POINTS BETWEEN THE CURB CENTER LINE AND THE CENTER LINE OF CURBS. GRADES ARE SHOWN BY CIRCLES ON PROFILES AT ALL POINTS BETWEEN THE CURB CENTER LINE AND THE CENTER LINE OF CURBS. GRADES ARE SHOWN BY CIRCLES ON PROFILES AT ALL POINTS BETWEEN THE CURB CENTER LINE AND THE CENTER LINE OF CURBS.
5. THE PRIVATE CONTRACTOR SHALL FURNISH THE COUNTY ENGINEER WITH GRADE SHEETS AND STATIONING FOR ALL HOUSE LATERALS AND 1" OR 1.5" DIAMETER AND SHALL PROVIDE STAKES FOR THEM AT THEIR PROPER LOCATIONS WITH STATIONING. HOUSE LATERALS SHALL BE CONSTRUCTED IN A STRAIGHT ALIGNMENT AT RIGHT ANGLES FROM THE MAIN LINE TO THE CURB. AS SHOWN ON THE PLANS HOUSE LATERALS FROM CURBS SHALL NOT HAVE AN ANGLE OF LESS THAN 45° WITH THE MAIN LINE AND BRUSH AND CHANGE IN ALIGNMENT SHALL BE REQUESTED IN WRITING BY THE PRIVATE CONTRACTOR.
6. THE PRIVATE CONTRACTOR SHALL FURNISH THE HOUSE LATERAL DEPTH AT THE PROPERTY LINE BELOW THE TOP OF CURB DEPTH FOR EACH HOUSE LATERAL ON THE GRADE SHEET.
7. BEFORE WORK CAN BE STARTED THE CONTRACTOR MUST OBTAIN A PERMIT TO EXCAVATE IN COUNTY STREETS FROM THE L.A. COUNTY ROAD DEPT. (SECTION 17178) AND COUNTY ENGINEER SPECIAL PERMITS FOR THE CONSTRUCTION OF SANITARY SEWERS BY THE COUNTY ENGINEER. TO COVER THE COST OF CONSTRUCTION, INSPECTION AND RECORD PLANS.
8. IF WORK IS TO BE DONE IN A STATE HIGHWAY A PERMIT MUST BE OBTAINED FROM THE STATE OF CALIFORNIA, DIVISION OF HIGHWAYS, 120 SOUTH BRIDGE STREET, LOS ANGELES, CALIFORNIA.
9. APPROVAL OF THIS PLAN BY THE COUNTY OF LOS ANGELES DOES NOT CONSTITUTE A REPRESENTATION AS TO THE ACCURACY OF THE LOCATION OF THE EXISTING OR PROPOSED UTILITIES OR THE EXISTING OR PROPOSED STRUCTURE WITHIN THE LIMITS OF THE PROJECT. THE OWNER ASSUMES ALL RISK.
10. OWNER TO NOTIFY THE COUNTY ENGINEER OF ANY CHANGES TO THE PROJECT AS SHOWN ON THESE PLANS.
11. OWNER TO OBTAIN A PERMIT TO EXCAVATE FROM THE STATE OF CALIFORNIA, DIVISION OF INDUSTRIAL SAFETY AND FILE A CERTIFICATE OF WORKERS COMPENSATION AND LIABILITY INSURANCE.
12. THE UNDERGROUND UTILITIES (ELECTRICITY, GAS, WATER, TELEPHONE, CABLE, ETC.) SHALL BE SHOWN ON THE PROJECT AS SHOWN ON THE PLANS.
13. THE CONTRACTOR SHALL BE RESPONSIBLE FOR OBTAINING ALL NECESSARY PERMITS AND SPECIAL PERMITS FROM THE COUNTY ENGINEER AND THE COUNTY ENGINEER SHALL BE RESPONSIBLE FOR OBTAINING ALL NECESSARY PERMITS AND SPECIAL PERMITS FROM THE COUNTY ENGINEER.
14. THE CONTRACTOR SHALL BE RESPONSIBLE FOR OBTAINING ALL NECESSARY PERMITS AND SPECIAL PERMITS FROM THE COUNTY ENGINEER.
15. THE CONTRACTOR SHALL BE RESPONSIBLE FOR OBTAINING ALL NECESSARY PERMITS AND SPECIAL PERMITS FROM THE COUNTY ENGINEER.
16. THE CONTRACTOR SHALL BE RESPONSIBLE FOR OBTAINING ALL NECESSARY PERMITS AND SPECIAL PERMITS FROM THE COUNTY ENGINEER.
17. THE CONTRACTOR SHALL BE RESPONSIBLE FOR OBTAINING ALL NECESSARY PERMITS AND SPECIAL PERMITS FROM THE COUNTY ENGINEER.
18. THE CONTRACTOR SHALL BE RESPONSIBLE FOR OBTAINING ALL NECESSARY PERMITS AND SPECIAL PERMITS FROM THE COUNTY ENGINEER.
19. THE CONTRACTOR SHALL BE RESPONSIBLE FOR OBTAINING ALL NECESSARY PERMITS AND SPECIAL PERMITS FROM THE COUNTY ENGINEER.
20. THE CONTRACTOR SHALL BE RESPONSIBLE FOR OBTAINING ALL NECESSARY PERMITS AND SPECIAL PERMITS FROM THE COUNTY ENGINEER.

CONSTRUCTION NOTES:

1. WORK SHALL BE CONSTRUCTED ACCORDING TO THE STANDARD SPECIFICATIONS FOR PUBLIC WORKS CONSTRUCTION, 1976 EDITION, SECTION 05110, AND COUNTY ENGINEER SPECIAL PERMITS FOR THE CONSTRUCTION OF SANITARY SEWERS BY THE COUNTY ENGINEER.
2. THE CONTRACTOR SHALL NOTIFY THE SANITARY SEWER DIVISION BY TELEPHONE 974-7228 AT LEAST TWENTY (20) DAYS BEFORE STARTING WORK UNDER THIS CONTRACT.
3. HOUSE LATERALS TO BE CONSTRUCTED WITHIN PROPERTY LINE SHALL BE CONSTRUCTED WITHIN PROPERTY LINE.
4. CURB OR THE BRANCHLINE SHALL BE USED FOR CONSTRUCTION TO BURNING BRUSH EXCEPT AS NOTED.
5. ALL STRUCTURES SHALL BE BUILT WITH REINFORCED CONCRETE AND SHALL BE BUILT AS NOTED.
6. HOUSE LATERALS ON THE PROPERTY LINE OR NEARER TO THE PROPERTY LINE SHALL BE CONSTRUCTED WITHIN PROPERTY LINE.
7. BRANCHLINE SHALL BE CONSTRUCTED WITHIN PROPERTY LINE.
8. UNPAVED FLAT AND JOINTS SHALL BE 1" OR 1.5" OR 2" PER STANDARD SPECIFICATIONS, SECTION 05110.
9. IF A PERMIT IS OBTAINED FROM THE COUNTY ENGINEER FOR THE CONSTRUCTION OF SANITARY SEWERS BY THE COUNTY ENGINEER, THE CONTRACTOR SHALL BE RESPONSIBLE FOR OBTAINING ALL NECESSARY PERMITS AND SPECIAL PERMITS FROM THE COUNTY ENGINEER.
10. IF A PERMIT IS OBTAINED FROM THE COUNTY ENGINEER FOR THE CONSTRUCTION OF SANITARY SEWERS BY THE COUNTY ENGINEER, THE CONTRACTOR SHALL BE RESPONSIBLE FOR OBTAINING ALL NECESSARY PERMITS AND SPECIAL PERMITS FROM THE COUNTY ENGINEER.
11. IF A PERMIT IS OBTAINED FROM THE COUNTY ENGINEER FOR THE CONSTRUCTION OF SANITARY SEWERS BY THE COUNTY ENGINEER, THE CONTRACTOR SHALL BE RESPONSIBLE FOR OBTAINING ALL NECESSARY PERMITS AND SPECIAL PERMITS FROM THE COUNTY ENGINEER.
12. IF A PERMIT IS OBTAINED FROM THE COUNTY ENGINEER FOR THE CONSTRUCTION OF SANITARY SEWERS BY THE COUNTY ENGINEER, THE CONTRACTOR SHALL BE RESPONSIBLE FOR OBTAINING ALL NECESSARY PERMITS AND SPECIAL PERMITS FROM THE COUNTY ENGINEER.
13. IF A PERMIT IS OBTAINED FROM THE COUNTY ENGINEER FOR THE CONSTRUCTION OF SANITARY SEWERS BY THE COUNTY ENGINEER, THE CONTRACTOR SHALL BE RESPONSIBLE FOR OBTAINING ALL NECESSARY PERMITS AND SPECIAL PERMITS FROM THE COUNTY ENGINEER.
14. IF A PERMIT IS OBTAINED FROM THE COUNTY ENGINEER FOR THE CONSTRUCTION OF SANITARY SEWERS BY THE COUNTY ENGINEER, THE CONTRACTOR SHALL BE RESPONSIBLE FOR OBTAINING ALL NECESSARY PERMITS AND SPECIAL PERMITS FROM THE COUNTY ENGINEER.
15. IF A PERMIT IS OBTAINED FROM THE COUNTY ENGINEER FOR THE CONSTRUCTION OF SANITARY SEWERS BY THE COUNTY ENGINEER, THE CONTRACTOR SHALL BE RESPONSIBLE FOR OBTAINING ALL NECESSARY PERMITS AND SPECIAL PERMITS FROM THE COUNTY ENGINEER.
16. IF A PERMIT IS OBTAINED FROM THE COUNTY ENGINEER FOR THE CONSTRUCTION OF SANITARY SEWERS BY THE COUNTY ENGINEER, THE CONTRACTOR SHALL BE RESPONSIBLE FOR OBTAINING ALL NECESSARY PERMITS AND SPECIAL PERMITS FROM THE COUNTY ENGINEER.
17. IF A PERMIT IS OBTAINED FROM THE COUNTY ENGINEER FOR THE CONSTRUCTION OF SANITARY SEWERS BY THE COUNTY ENGINEER, THE CONTRACTOR SHALL BE RESPONSIBLE FOR OBTAINING ALL NECESSARY PERMITS AND SPECIAL PERMITS FROM THE COUNTY ENGINEER.
18. IF A PERMIT IS OBTAINED FROM THE COUNTY ENGINEER FOR THE CONSTRUCTION OF SANITARY SEWERS BY THE COUNTY ENGINEER, THE CONTRACTOR SHALL BE RESPONSIBLE FOR OBTAINING ALL NECESSARY PERMITS AND SPECIAL PERMITS FROM THE COUNTY ENGINEER.
19. IF A PERMIT IS OBTAINED FROM THE COUNTY ENGINEER FOR THE CONSTRUCTION OF SANITARY SEWERS BY THE COUNTY ENGINEER, THE CONTRACTOR SHALL BE RESPONSIBLE FOR OBTAINING ALL NECESSARY PERMITS AND SPECIAL PERMITS FROM THE COUNTY ENGINEER.
20. IF A PERMIT IS OBTAINED FROM THE COUNTY ENGINEER FOR THE CONSTRUCTION OF SANITARY SEWERS BY THE COUNTY ENGINEER, THE CONTRACTOR SHALL BE RESPONSIBLE FOR OBTAINING ALL NECESSARY PERMITS AND SPECIAL PERMITS FROM THE COUNTY ENGINEER.

PROFILE, ALIGNMENT AND GRADE OF
SANITARY SEWERS PAGE 1
 TO BE CONSTRUCTED IN
 TRACT NO. 32994

PRIVATE CONTRACT NO. 9581

W.S. 93, C-1
 4 SHEETS, 8 PAGES (47656)
 SCALE: HORIZ. 1" = 40' VERT. 1" = 4'
 PREPARED BY THE OFFICES OF
 McCUTCHEAN AND ASSOCIATES, INC.
 2100 E. VIOLET HILL BLVD., PASADENA, CALIF.
 BY: _____ REG. C.E. No. 9890

THE FOLLOWING LISTED REVISIONS SHOWN ON THESE PLANS ARE THE PROPERTY OF THE COUNTY ENGINEER AND SHALL BE THE PROPERTY OF THE COUNTY ENGINEER.

REVISION	DATE
1	10/1/78
2	10/1/78
3	10/1/78
4	10/1/78
5	10/1/78
6	10/1/78
7	10/1/78
8	10/1/78
9	10/1/78
10	10/1/78
11	10/1/78
12	10/1/78
13	10/1/78
14	10/1/78
15	10/1/78
16	10/1/78
17	10/1/78
18	10/1/78
19	10/1/78
20	10/1/78

COUNTY OF LOS ANGELES, CALIFORNIA
 STEPHEN J. NODDIE, COUNTY ENGINEER LAS VIRGENES MUNICIPAL WATER DISTRICT
 APPROVED: _____ DATE: 9-3-78
 CHECKED: _____ DATE: 5/3/79
 CAL 84543 BLDG DIST 91 J N 0250.02

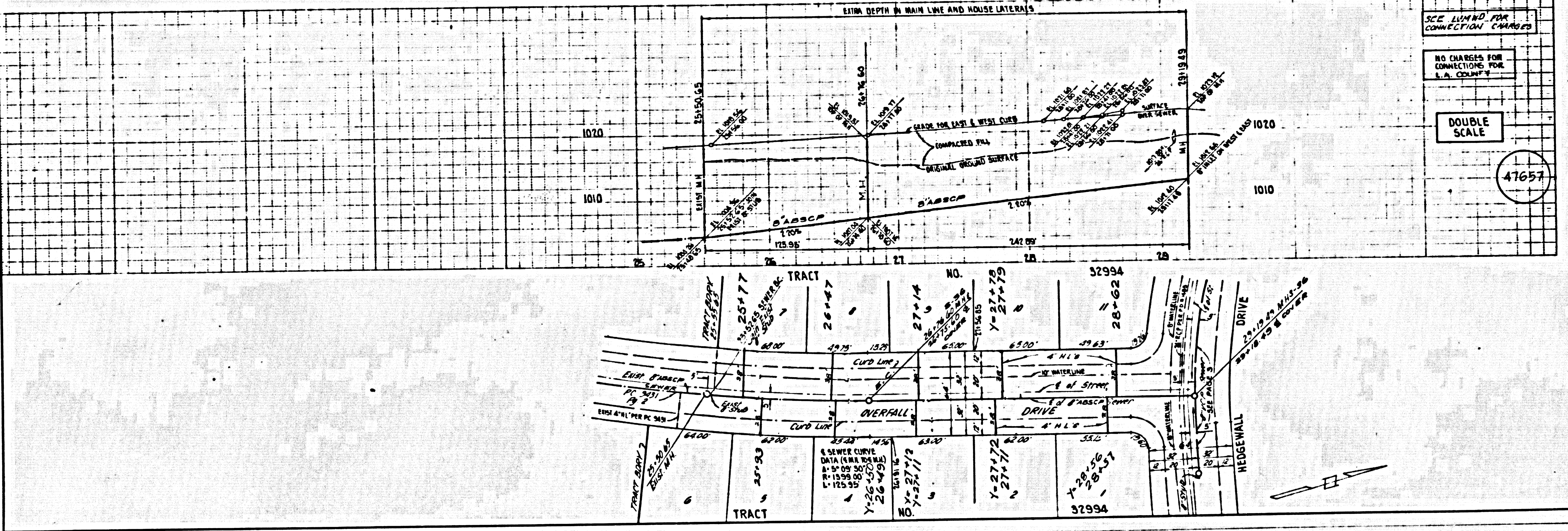

SEE LISTING FOR CONNECTION CHARGES
 NO CHARGES FOR CONNECTIONS TO L.A. COUNTY
 DOUBLE SCALE
 (47657)

