

B.M. 25387 ELEV. 471.84  
 R.O.M. 100' to 500' S. of S. of A.C.R. 40' 10" S. of E. of S. of Industrial of Highway Street & Quince Street  
 OTTERBURN QUAD. 1922

REVISION NO. 1 DATE June 24, 1971  
 Approved March from 5:00 a.m. to 4:30 p.m.  
 APPROVED: Dean Chellian 6-24-71  
 Office of County Engineer No. 12 8339

PROFILE, ALIGNMENT AND GRADE OF  
**SANITARY SEWERS** PAGE 1  
 TO BE CONSTRUCTED IN  
 PARCEL MAP LB 10886  
 AND  
 RIGHTS OF WAY  
**PRIVATE CONTRACT NO. 9605**  
 W.S. 39  
 1 SHEET, 2 PAGES  
 SCALE: VERT. 1" = 4' HORIZ. 1" = 40'  
 OCTOBER, 1978  
 PREPARED IN THE OFFICES OF  
 H.M. SCOTT & ASSOCIATES, INC.  
 BY: Michael J. Scott  
 REG. C.E. No. 2320

49478

NO REMEDIATION FOR THE DISPOSAL OF INDUSTRIAL WASTES SHALL BE MADE TO SEWERS SHOWN ON THESE DRAWINGS UNLESS A PERMIT FOR INDUSTRIAL WASTE WATER DISCHARGE HAS BEEN ISSUED BY THE SANITATION DISTRICT FOR SAID CONNECTION.  
 BEFORE BREAKING INTO OR CONSTRUCTION ON A COUNTY SANITATION DISTRICT SEWER AND PRIOR TO FINAL ACCEPTANCE OF THE PROJECT SANITATION DISTRICT INSPECTOR SHALL BE NOTIFIED BY PHONE AND SO THAT REQUIRED INSPECTION CAN BE MADE.

**PRIVATE ENGINEER'S NOTICE TO CONTRACTOR**

The Contractor shall notify all utility companies prior to construction of improvements shown on this plan. The location of known underground utility pipes or structures shown on the sewer plan was obtained by a search of available records. To the best of my knowledge, there are no existing utilities, except as shown thereon.  
 The Contractor is required to take out precautionary measures to protect the utility lines shown and any other lines not of record or not shown on the plan.

Michael J. Scott September 13, 1978  
 H.M. Scott & Associates, Inc. 2320

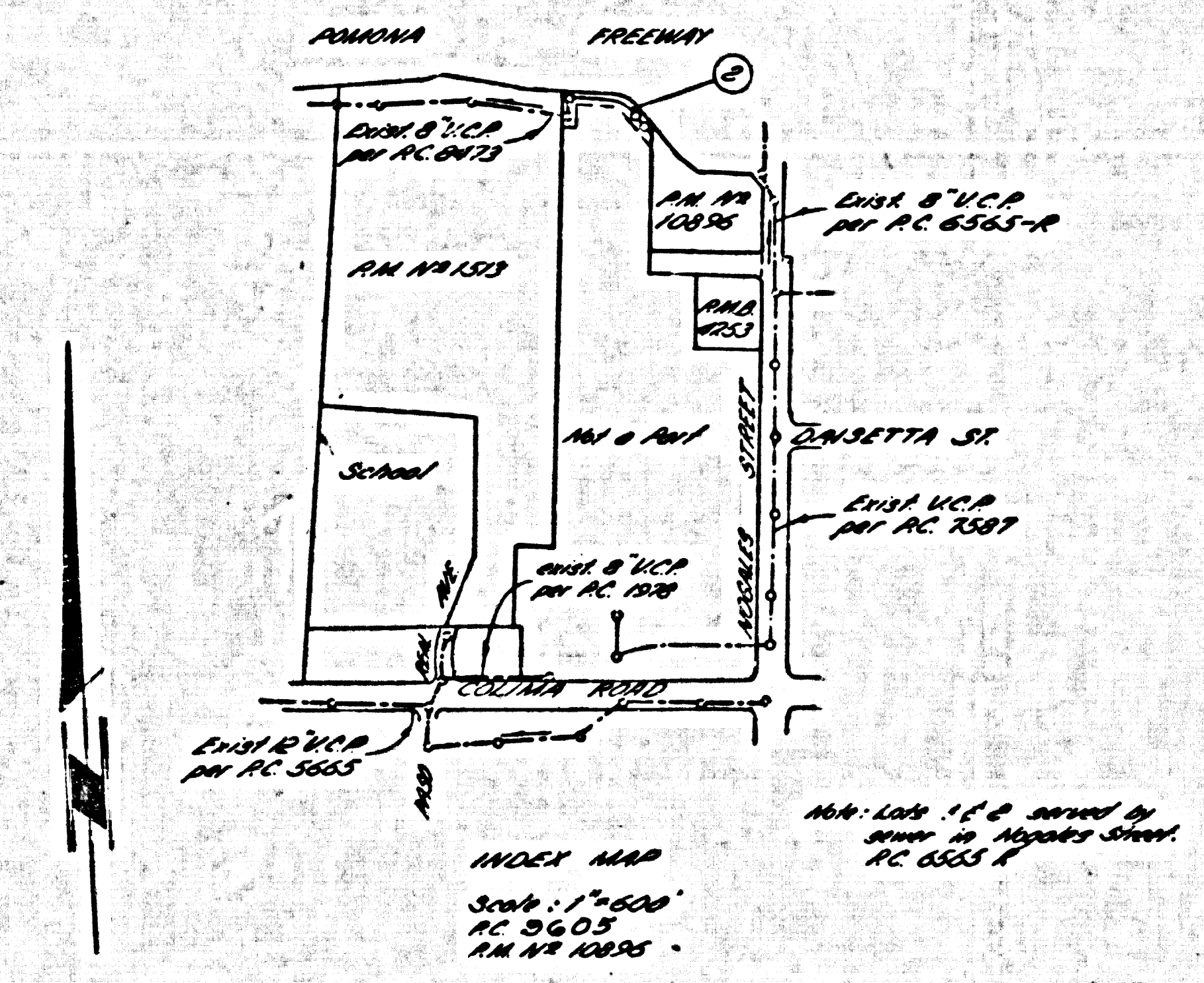

Contractor agrees that he shall assume sole and complete responsibility for job site conditions during the course of construction of this Project, including safety of all persons and property; that this requirement shall apply continuously and not be limited to normal working hours; and that the Contractor shall defend, indemnify and hold the Owner and the Engineer harmless from any and all liability, real or alleged, in connection with the performance of work on this Project, excepting for liability arising from the sole negligence of the Owner or the Engineer.

- GENERAL NOTES:**
1. IMPROVEMENTS ARE TO BE MADE IN ACCORDANCE WITH THE STANDARD SPECIFICATIONS FOR PUBLIC WORKS CONSTRUCTION AND SPECIAL PROVISIONS FOR THE CONSTRUCTION OF SANITARY SEWERS DATED SEPTEMBER 1, 1978.
  2. NO REVISIONS SHALL BE MADE IN THESE PLANS WITHOUT THE APPROVAL OF THE COUNTY ENGINEER.
  3. NO REPRESENTATIVE OF THE COUNTY ENGINEER WILL SURVEY OR LAY OUT ANY PORTION OF THE WORK.
  4. GRADES TO WHICH THIS IMPROVEMENT IS TO BE CONSTRUCTED ARE SHOWN ON PLANS AND PROFILES. GRADE POINTS FOR TOP OF CURB, CENTER LINE OF STREETS, OR CENTER LINE OF ALLEYS ARE SHOWN BY CIRCLES ON PROFILES. AT ALL POINTS BETWEEN BENCHMARK POINTS THE GRADE SHALL BE ESTABLISHED SO AS TO CONFORM TO A STRAIGHT LINE DRAWN BETWEEN SAID BENCHMARK POINTS.
  5. THE PRIVATE ENGINEER SHALL FURNISH THE COUNTY ENGINEER WITH GRADE SHEETS AND STATIONING FOR ALL HOUSE LATERALS AND 12" OR 18" BRANCHES AND SHALL PROVIDE STAKES FOR THEM AT THESE PROPER LOCATIONS WITH STATIONING PLAINLY MARKED. ALL HOUSE LATERALS SHALL BE CONSTRUCTED IN A STRAIGHT ALIGNMENT AT RIGHT ANGLES FROM THE MAIN LINE SEWER EXCEPT AS SHOWN ON THE PLANS. HOUSE LATERALS FROM CHIMNEYS SHALL NOT HAVE AN ANGLE OF LESS THAN 45° WITH THE MAIN LINE SEWER. ANY CHANGE IN ALIGNMENT SHALL BE REQUESTED BY WRITING BY THE PRIVATE ENGINEER.
  6. THE PRIVATE ENGINEER SHALL FURNISH THE COUNTY ENGINEER WITH A PERMIT TO EXCAVATE IN COUNTY STREETS FROM THE L.A. COUNTY ROAD DEPT. DISTRICT OFFICE NO. 1 AND PAY A FEE TO THE COUNTY ENGINEER, 225 E. BROADWAY, 3RD FLOOR, REGIONAL OFFICE, TO COVER THE COST OF CONSTRUCTION INSPECTION AND RECORD PLANS.
  7. IF WORK IS TO BE DONE IN A STATE HIGHWAY, A PERMIT MUST BE OBTAINED FROM THE STATE OF CALIFORNIA, DIVISION OF HIGHWAYS, 138 SOUTH BRIDGE STREET, LOS ANGELES, CALIFORNIA.
  8. APPROVAL OF THIS PLAN BY THE COUNTY OF LOS ANGELES DOES NOT CONSTITUTE A REPRESENTATION AS TO THE ACCURACY OF THE LOCATION OF OR THE EXISTENCE OR NON-EXISTENCE OF ANY UNDERGROUND UTILITY PIPE, OR STRUCTURE WITHIN THE LIMITS OF THIS PROJECT. THIS NOTE APPLIES TO ALL PAGES.
  9. REFER TO SECTION 7-16.41 OF THE STANDARD SPECIFICATIONS, REGARDING SAFETY SIGNALS.
  10. THIS PLAN IS ACCURATE AS FAR AS THE REQUIRED SEWER CONSTRUCTION PLANNED BY THE COUNTY ENGINEER. THE CONTRACTOR SHALL OBTAIN A PERMIT TO EXCAVATE FROM THE STATE OF CALIFORNIA DEPARTMENT OF INDUSTRIAL RELATIONS, DIVISION OF INDUSTRIAL SAFETY, AND SHALL OBTAIN A CERTIFICATE OF SAFETY COMPLIANCE FROM THE COUNTY ENGINEER.

- CONSTRUCTION NOTES:**
1. WORK SHALL BE CONSTRUCTED ACCORDING TO THE STANDARD SPECIFICATIONS FOR PUBLIC WORKS CONSTRUCTION AND SPECIAL PROVISIONS FOR THE CONSTRUCTION OF SANITARY SEWERS DATED SEPTEMBER 1, 1978.
  2. THE CONTRACTOR SHALL NOTIFY THE COMMUNITY DEVELOPMENT DEPARTMENT, PLAN 20-500-282 AT LEAST TWENTY-FOUR HOURS BEFORE STARTING ANY WORK UNDER THIS CONTRACT.
  3. HOUSE LATERALS TO BE CONSTRUCTED WITH INVERTS AT PROPERTY LINE AS PER BELOW CURB GRADE EXCEPT AS NOTED.
  4. VISE OR THE BRANCHES MAY BE USED FOR CONNECTIONS TO MAINLINE SEWERS EXCEPT AS NOTED.
  5. ALL STRUCTURES SHALL BE EITHER BRICK MANHOLES PER S-2 OF PRECAST CONCRETE MANHOLES PER S-2A, EXCEPT AS NOTED.
  6. PROVIDE STAKES ON THE PROPERTY LINE OR PROPERTY LINE PROJECTIONS AT RIGHT ANGLES TO THE SEWER LINE AT THE CENTER LINE OF EACH MANHOLE.
  7. MANHOLE TOPS IN UNIMPROVED RIGHTS OF WAY TO BE SIX INCHES ABOVE FINISHED GRADE.
  8. INTERFERED CLAY PIPE JOINTS SHALL BE TYPE "B", "C", OR "D" PER STANDARD SPECIFICATIONS SECTION 306-2.
  9. IF A POWER POLE IS WITHIN THREE FEET OF THE SEWER, THE SEWER SHALL BE ENCASED, PER S-25, CASE II, TWO FEET ON EACH SIDE FROM THE POINT OF INTERFERENCE.
  10. IF DURING THE COURSE OF CONSTRUCTION IT IS DETERMINED THAT THERE IS LESS THAN FOUR FEET OF COVER OVER THE TOP OF A MAIN LINE OR HOUSE LATERAL V.C.P. SEWER WHICH IS NOT INDICATED ON THE PLANS, THE PIPE SHALL BE ENCASED PER S-25, CASE II UNLESS OTHERWISE APPROVED BY THE COUNTY ENGINEER.
  11. ALL JOINTS BETWEEN CLAY PIPE AND VITRIFIED CLAY PIPE SHALL BE MADE WITH A RUBBER SLAVE JOINT, TYPE "C" OR "D", WITH BURNING IN NECESSARY PER STANDARD SPECIFICATIONS, SECTION 306-2.
  12. SEWERS TO BE TESTED FOR LEAKAGE PER SECTION 306-3.14 OF THE STANDARD SPECIFICATIONS AND SPECIAL PROVISIONS.
  13. RETAINAGE ALL TRENCHES WITHIN FIVE FEET OF THE L.A. COUNTY ROAD DEPT. OR CALIFORNIA STATE HIGHWAY RIGHT-OF-WAYMENTS BY ACCORDANCE WITH PERMITS.
  14. FULL COMPLIANCE WITH SECTION 306-1.10 OF THE SPECIAL PROVISIONS WILL BE REQUIRED FOR BACKFILL IN STREETS. CERTIFICATION OF BACKFILL COMPACTION AND SAND FORTIFICATION BY A QUALIFIED, REGISTERED TESTING LABORATORY SHALL BE PROVIDED BY THE PERMITTEE PRIOR TO THE ISSUANCE OF A CERTIFICATE OF PARTIAL ACCEPTANCE.

THE FOLLOWING LATEST REVISION STANDARD PLANS ON FILE IN THE OFFICE OF THE COUNTY ENGINEER SHALL APPLY IN THE CONSTRUCTION OF THIS PROJECT:

BRICK	5-1
BRICKWORK	5-2
BRICK MANHOLE	5-3
BRICKWORK FOR SEWER PIPE	5-7
CASTING AND ENCASEMENT	5-20
VISE OR THE BRANCH	5-26
ALLOWABLE TRENCH WIDTHS	5-28
LOCATING MANHOLES PLANS AND COVERS	5-28
NON-REINFORCED PRECAST CONCRETE MANHOLES	5-28

COUNTY OF LOS ANGELES, CALIFORNIA  
 STEPHEN J. KENNEDY, COUNTY ENGINEER W. E. GARRISON, CHIEF ENGINEER  
 APPROVED: Gordon W. Keiff 1-12-79 APPROVED: Frank D. ... 7/25/79  
 OFFICE ENGINEER  
 CHECKED: Edward J. Volody 7/25/79  
 BLDG. DIST. 2  
 LA FUENTE

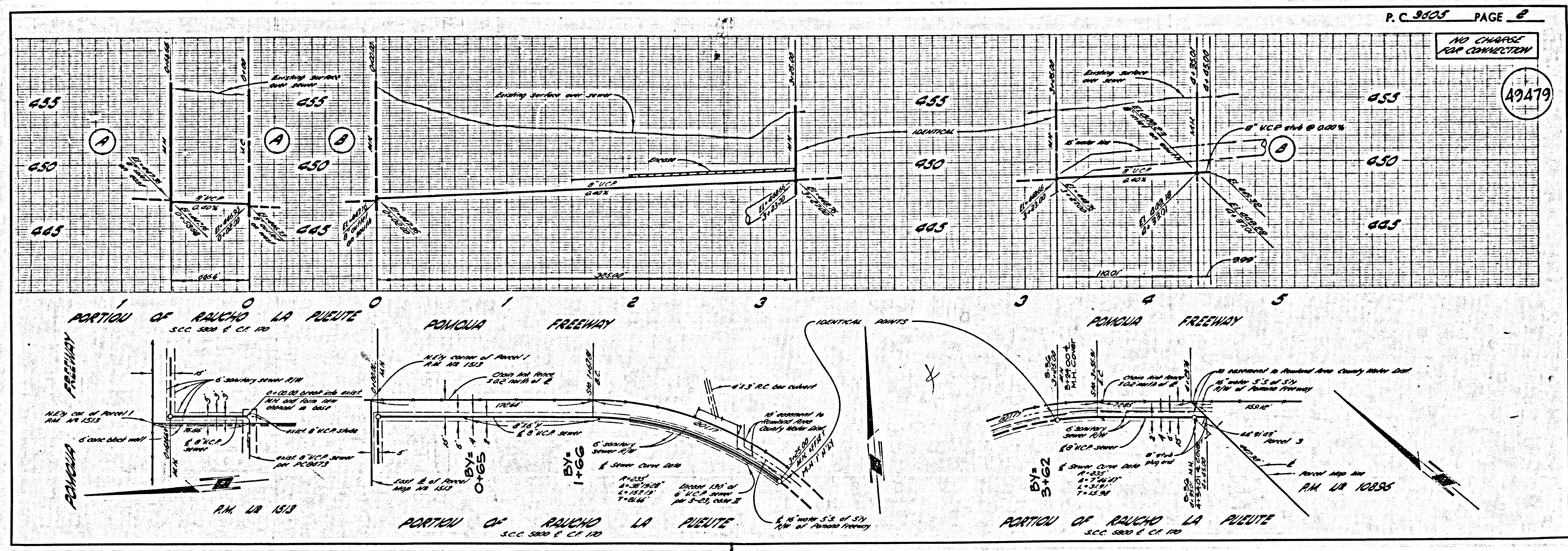

LA COUNTY SEWER SHEET NO. 1 SOUTHERN CALIFORNIA BLUEPRINT CO. 252 477

252 39 8339 12 8339 12

SH 16