

B.M. C.G. 3889 ELEV. 456.878
 P.O. B.M. TAG IN C.B. 21 W/10 C.B.
 END 40' NORTH AND 21' WEST OF
 4 INTER. COLIMA RD. & ALLISA RD.
 OTTOMEN QUAD. 1939

PRIVATE ENGINEERS NOTICE TO CONTRACTORS

THE EXISTENCE AND APPROXIMATE LOCATION OF UNDERGROUND UTILITIES OR STRUCTURES SHOWN ON THESE PLANS WERE DETERMINED BY A SEARCH OF AVAILABLE PUBLIC RECORDS. TO THE BEST OF OUR KNOWLEDGE THERE ARE NO EXISTING UNDERGROUND UTILITIES OR STRUCTURES SHOWN ON THESE PLANS.

THE CONTRACTOR IS REQUIRED TO TAKE DUE PRECAUTIONARY MEASURES TO PROTECT THE EXISTING UNDERGROUND UTILITIES OR STRUCTURES SHOWN AND ANY OTHER EXISTING UNDERGROUND UTILITIES OR STRUCTURES NOT OF RECORD OR NOT SHOWN ON THESE PLANS.

CONTRACTOR AGREES THAT HE SHALL ASSUME SOLE AND COMPLETE RESPONSIBILITY FOR JOB SITE CONDITIONS DURING THE COURSE OF CONSTRUCTION OF THIS PROJECT, INCLUDING SAFETY OF ALL PERSONS AND PROPERTY; THAT THIS REQUIREMENT SHALL APPLY CONTINUOUSLY AND NOT BE LIMITED TO NORMAL WORKING HOURS, AND THAT THE CONTRACTOR SHALL DEFEND, INDEMNIFY AND HOLD THE OWNER AND ENGINEER HARMLESS FROM ANY AND ALL LIABILITY, REAL OR ALLEGED, IN CONNECTION WITH PERFORMANCE OF WORK ON THIS PROJECT, EXCEPTING FOR LIABILITY ARISING FROM THE SOLE NEGLIGENCE OF THE OWNER OR ENGINEER.

Robert R. Flores
 ROBERT R. FLORES, R.C.E. 11349 DATE

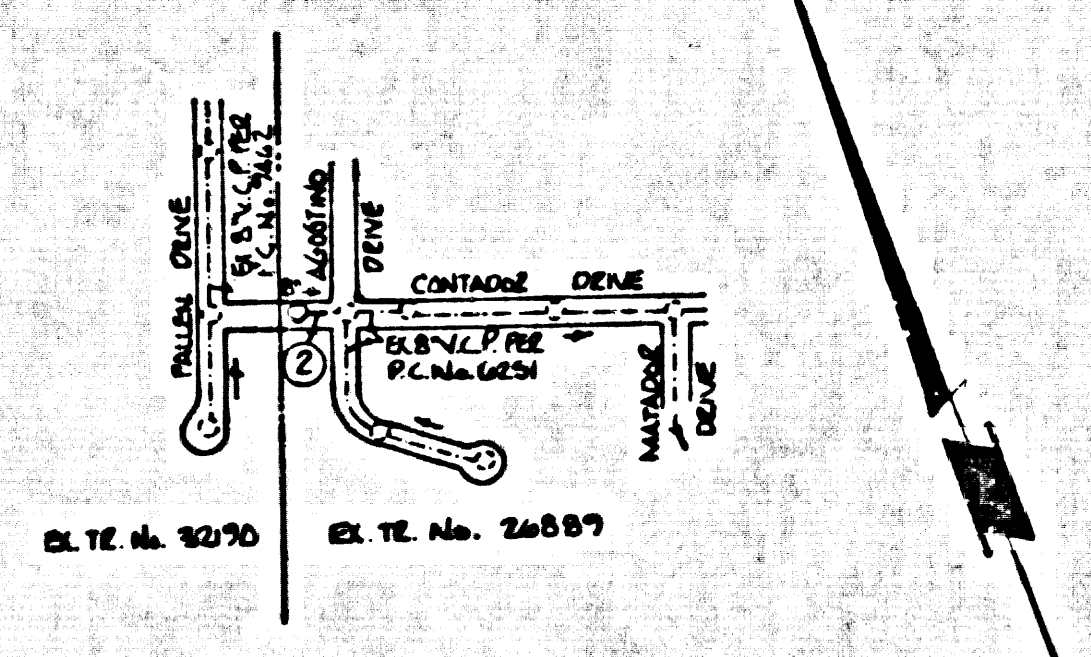

INDEX MAP
 SEWER RECONSTRUCTION IN CONTADOR DRIVE
 P.C. No. 9635
 SCALE: 1"=800'

NO CONNECTION FOR THE DISPOSAL OF INDUSTRIAL WASTES SHALL BE MADE TO SEWERS SHOWN ON THESE PLANS UNLESS A PERMIT FOR INDUSTRIAL WASTE WATER DISCHARGE HAS BEEN ISSUED BY THE SANITATION DISTRICTS IN SAID CONNECTION.

BEFORE BREAKING INTO OR CONSTRUCTION ON A COUNTY SANITATION DISTRICT SEWER AND PRIOR TO FINAL ACCEPTANCE OF THE PROJECT SANITATION DISTRICT INSPECTOR SHALL BE NOTIFIED BY PHONE OR 800-530 THAT REQUIRED INSPECTION CAN BE MADE.

GENERAL NOTES: DOUBLE SCALE

1. DIMENSIONS ARE IN FEET UNLESS OTHERWISE NOTED.
2. ALL DIMENSIONS SHALL BE MADE IN THREE PLACES WITHOUT THE APPROVAL OF THE COUNTY ENGINEER.
3. NO REPRESENTATIVE OF THE COUNTY ENGINEER WILL SURVEY OR LAY OUT ANY PORTION OF THE WORK.
4. GRADES TO WHICH THIS IMPROVEMENT IS TO BE CONSTRUCTED ARE SHOWN ON PLANS AND PROFILE GRADE POINTS FOR TOP OF CURB, CENTER LINE OF STREET, OR CENTER LINE OF ALLEY ARE SHOWN BY CIRCLES ON PROFILES. AT ALL POINTS BETWEEN DESIGNATED POINTS THE GRADE SHALL BE ESTABLISHED SO AS TO CONFORM TO A STRAIGHT LINE BETWEEN SAID DESIGNATED POINTS.
5. THE PRIVATE ENGINEER SHALL FURNISH THE COUNTY ENGINEER WITH GRADE SHEETS AND ELEVATIONS FOR ALL HOUSE LATERALS AND 12" TO 18" BRANCHES AND SHALL PROVIDE STAKES FOR THEM AT THEIR PROPER LOCATIONS WITH CALIFORNIA PLANNED MARKERS. ALL HOUSE LATERALS SHALL BE CONSTRUCTED AT A STRAIGHT ALIGNMENT AT RIGHT ANGLES FROM THE MAIN LINE SEWER EXCEPT AS SHOWN ON THE PLANS. HOUSE LATERALS FROM CHIMNEYS SHALL NOT HAVE AN ANGLE OF LESS THAN 45° WITH THE MAIN LINE SEWER. ANY CHANGE IN ALIGNMENT SHALL BE REQUESTED IN WRITING BY THE PRIVATE ENGINEER.
6. THE PRIVATE ENGINEER SHALL FURNISH THE HOUSE LATERAL DEPTH AT THE PROPERTY LINE BELOW THE TOP OF CURB ELEVATION FOR EACH HOUSE LATERAL ON THE GRADE SHEET.
7. BEFORE WORK CAN BE STARTED, THE CONTRACTOR MUST OBTAIN A PERMIT TO EXCAVATE IN COUNTY STREETS FROM THE L.A. COUNTY ROAD DEPT., DISTRICT OFFICE NO. 1, AND PAY A FEE TO THE COUNTY ENGINEER, 221 E. TEMPLE, INC., SAN ANTONIO, TEXAS, DISTRICT OFFICE, TO COVER THE COST OF CONSTRUCTION INSPECTION AND RECORD PLANS.
8. IF WORK IS TO BE DONE IN A STATE HIGHWAY, A PERMIT MUST BE OBTAINED FROM THE STATE OF CALIFORNIA, DIVISION OF HIGHWAYS, 120 SOUTH SPRING STREET, LOS ANGELES, CALIFORNIA.
9. APPROVAL OF THIS PLAN BY THE COUNTY OF LOS ANGELES DOES NOT CONSTITUTE A REPRESENTATION AS TO THE ACCURACY OF THE LOCATION OF OR THE EXISTENCE OR NON-EXISTENCE OF ANY UNDERGROUND UTILITY PIPE, OR STRUCTURE WITHIN THE LIMITS OF THIS PROJECT. THIS NOTE APPLIES TO ALL PAGES.
10. WITHIN THE LIMITS OF THE STANDARD SPECIFICATIONS, REBAR SHALL BE USED IN ALL CONCRETE STRUCTURES. THE CONTRACTOR SHALL OBTAIN A PERMIT TO EXCAVATE FROM THE STATE OF CALIFORNIA, DIVISION OF INDUSTRIAL SAFETY AND SHALL TAKE A CERTIFICATE OF INDUSTRY COMPENSATED INSURANCE AND LIABILITY INSURANCE WITH THE COUNTY ENGINEER.

CONSTRUCTION NOTES:

1. WORK SHALL BE CONSTRUCTED ACCORDING TO THE STANDARD SPECIFICATIONS FOR PUBLIC WORKS CONSTRUCTION 1976 EDITION AND COUNTY ENGINEER SPECIAL PROVISIONS FOR THE CONSTRUCTION OF SANITARY SEWERS DATED SEPTEMBER 21, 1978 AND SHALL BE PROCEEDED ONLY IN THE PRESENCE OF THE COUNTY ENGINEER.
2. THE CONTRACTOR SHALL NOTIFY THE COUNTY ENGINEER, DISTRICT OFFICE, PHONE (213) 974-7235, AT LEAST TWENTY-FOUR HOURS BEFORE BEGINNING ANY WORK UNDER THIS CONTRACT.
3. HOUSE LATERALS TO BE CONSTRUCTED WITH INVERTS AT PROPERTY LINE & FEET BELOW CURB GRADE EXCEPT AS NOTED.
4. WYE OR THE BRANCHES MAY BE USED FOR CONNECTIONS TO MAINLINE SEWERS EXCEPT AS NOTED.
5. ALL STRUCTURES SHALL BE BUILT TO SPECIFICATIONS FOR 2-4" OR PRECAST CONCRETE MANHOLES PER S.31, EXCEPT AS NOTED.
6. PROFILE GRADES ON THE PROPERTY LINE OR PROPERTY LINE PRODUCED AT RIGHT ANGLES TO THE SEWER LINE AT THE CENTER LINE OF EACH MANHOLE.
7. MANHOLES TO BE UNREINFORCED UNLESS OTHERWISE NOTED.
8. WITHIN CLAY PIPE JOINTS SHALL BE TYPE "T", "F", OR "C" PER STANDARD SPECIFICATIONS SECTION 301-2.
9. IF A POWER POLE IS WITHIN THREE FEET OF THE SEWER, THE SEWER SHALL BE SHICASED, PER S.31, CASE II, TWO FEET ON EACH SIDE FROM THE POINT OF INTERFERENCE.
10. IF BURNING IS THE COURSE OF CONSTRUCTION IT IS DETERMINED THAT THERE IS LESS THAN FOUR FEET OF COVER OVER THE TOP OF A MAIN LINE OR HOUSE LATERAL V.C.P. SEWER WHICH IS NOT INDICATED ON THE PLANS, THE PIPE SHALL BE SHICASED PER S.31, CASE II UNLESS OTHERWISE APPROVED BY THE COUNTY ENGINEER.
11. ALL JOINTS BETWEEN CLAY PIPE FROM PIPE AND WITHIN CLAY PIPE SHALL BE MADE WITH A RUBBER SLAVE JOINT, TYPE "C" OR "F", PER STANDARD SPECIFICATIONS FOR 2-4" OR PRECAST CONCRETE MANHOLES PER S.31, EXCEPT AS NOTED.
12. SEWERS TO BE TESTED FOR LEAKAGE PER SECTION 301-4 OF THE STANDARD SPECIFICATIONS AND SPECIAL PROVISIONS.
13. REBARFACE ALL TRENCHES WITHIN PAVED AREAS TO MEET L.A. COUNTY ROAD DEPT. OF CALIFORNIA STATE HIGHWAY REQUIREMENTS IN ACCORDANCE WITH PERMITS.
14. FULL COMPLIANCE WITH SECTION 301-15 OF THE SPECIAL PROVISIONS WILL BE REQUIRED FOR BACKFILL IN STREETS. CERTIFICATION OF BACKFILL COMPACTION AND SAND EQUIVALENCY BY A QUALIFIED, REGISTERED TESTING LABORATORY SHALL BE PROVIDED BY THE PERMITTEE PRIOR TO THE ISSUANCE OF A CERTIFICATE OF FINAL ACCEPTANCE.

TO BE CONSTRUCTED IN
 SEWER RECONSTRUCTION IN CONTADOR DRIVE
PRIVATE CONTRACT NO. 9635

W.S. 58-C-4
 1 SHEETS, 2 PAGES
 SCALE: 1"=8' HORIZ. 1"=4' VERT. DECEMBER, 1978
 PREPARED IN THE OFFICES OF
 KEVMEYER ENGINEERING CO., INC.
 8100 S. PHOENIX AVE. VAN Nuys, CALIF. 91411 (818) 708-0791
 BY: *Robert R. Flores*
 REG. C. E. No. 11349

THE FOLLOWING LATEST REVISED STANDARD PLANS ON FILE IN THE OFFICE OF THE COUNTY ENGINEER SHALL APPLY IN THE CONSTRUCTION OF THIS PROJECT:

MANHOLE	5-1
MINIMUM PUBLIC SAFETY REQUIREMENTS	5-2
BRICK MANHOLES	5-3
STANDARD MANHOLE RING	5-4
BRICKS FOR SEWER PIPE	5-5
CLADDING AND ENCASEMENT	5-6
WYE OR THE SURFACE	5-7
ALTERNATE THROUGH JOINTS	5-8
EXCISE MANHOLES PLANS AND COVER	5-9
NON-REINFORCED PRECAST CONCRETE MANHOLES	5-10

COUNTY OF LOS ANGELES, CALIFORNIA
 STEPHEN J. WOOLCE, COUNTY ENGINEER JOHN D. PARKHURST, CHIEF ENGINEER
 APPROVED: *Samuel Miller* 12/10/78 REGIONAL ENGINEER DATE APPROVED: *Samuel Miller* 12/10/78 DISTRICT OFFICE ENGINEER DATE
 CHECKED: *Samuel Miller* 12/10/78 DATE
 S.S. No. 12473
 L.A. PUENTE BLDG. DIST. 2 I.N. 0358.01

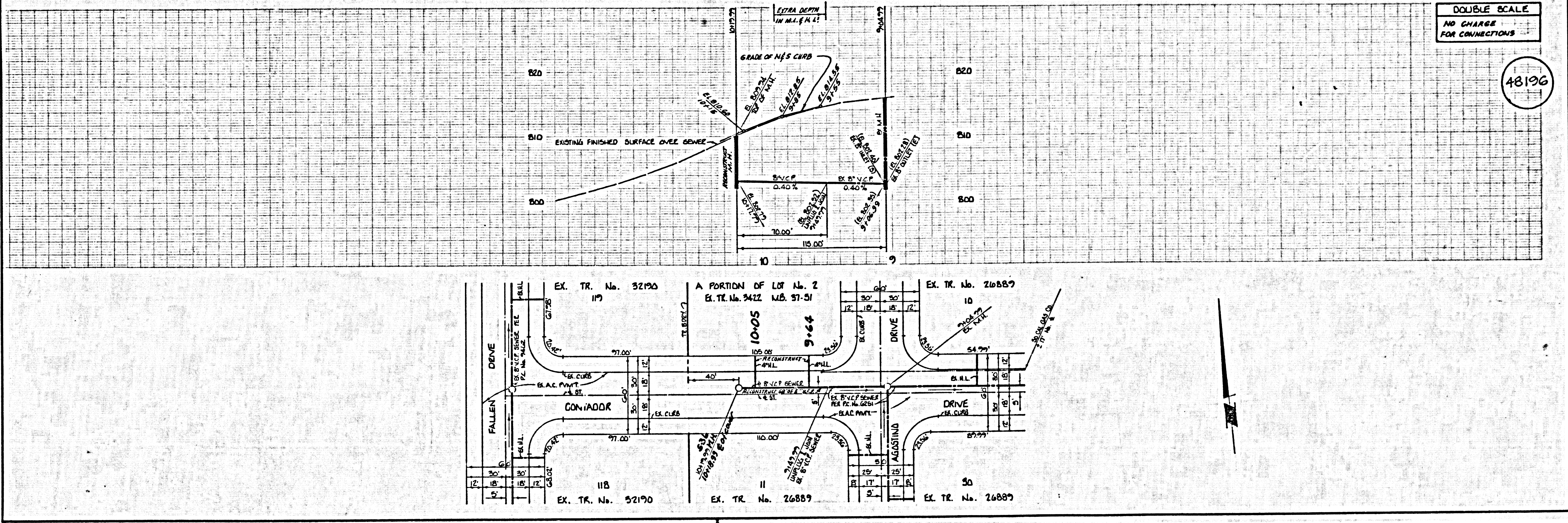

DOUBLE SCALE
 NO CHANGE FOR CONNECTIONS

48196

SERIES RECONSTRUCTION IN CONTADOR DRIVE BC 2832