

17363

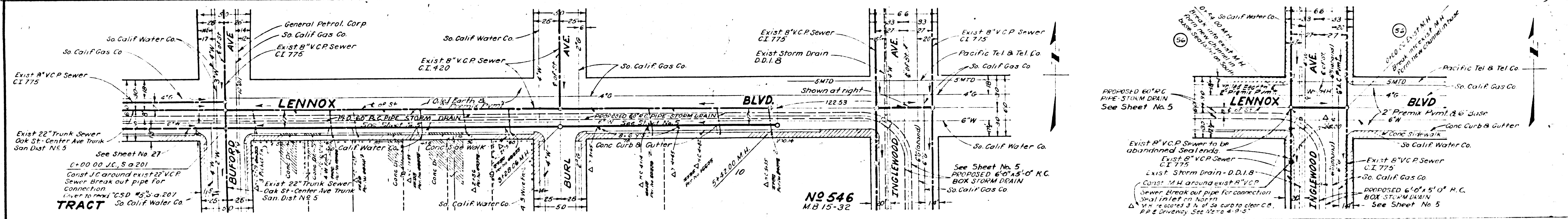
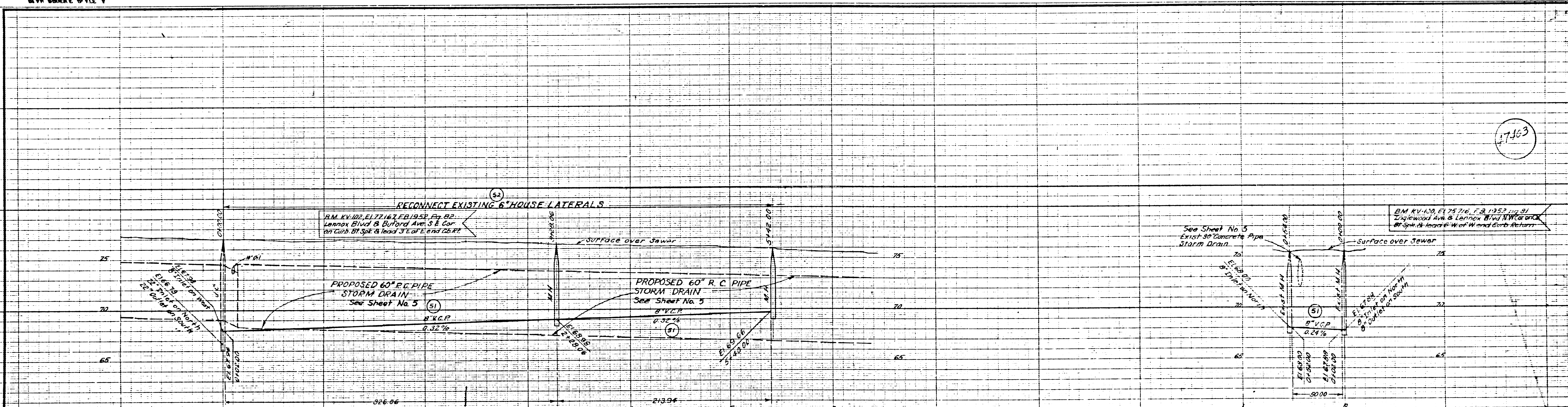

NO 546
M.B. 15-32

REF. P.C. # 9791

PREPARED BY		REVISIONS		LOS ANGELES COUNTY FLOOD CONTROL DISTRICT
WILLIAM J. FOX		MARK	DESCRIPTION	
COUNTY ENGINEER		Δ	7-22-58 As Built	PROJECT NO. 13 INGLEWOOD AVE-CENTURY BLVD LINE A SANITARY SEWER RECONSTRUCTION PLAN AND PROFILE
RECOMMENDED BY				
DRAWN BY L.S. Finnegan		CHECKED BY [Signature]		APPROVED BY [Signature]
DESIGNED BY L.S. Finnegan		TRACED BY [Signature]		SCALE: HORIZ. 1"=40'
CHECKED BY F.A. McGinn		DATE: NOV 1955		DATE: NO. 18-13-DI. 26
				MAY 1956 SHEET 26 OF 35

BYM MONITE STYLE V

BYM MONITE STYLE V

B.M. KV-103 E. 79 382 F.B. 1952 pg. 83
Lennox Blvd. & Felton Ave. N.W. Cor. on Curb.
Bl. Sbk. & Lead 5' N. of N. end of Curb Return.

B.M. KV-102 E. 77 167 F.B. 1952 pg. 82
Lennox Blvd. & Buford Ave. S.E. Cor. on Curb.
Bl. Sbk. & Lead 3' E. of E. end of Curb Return.

47464

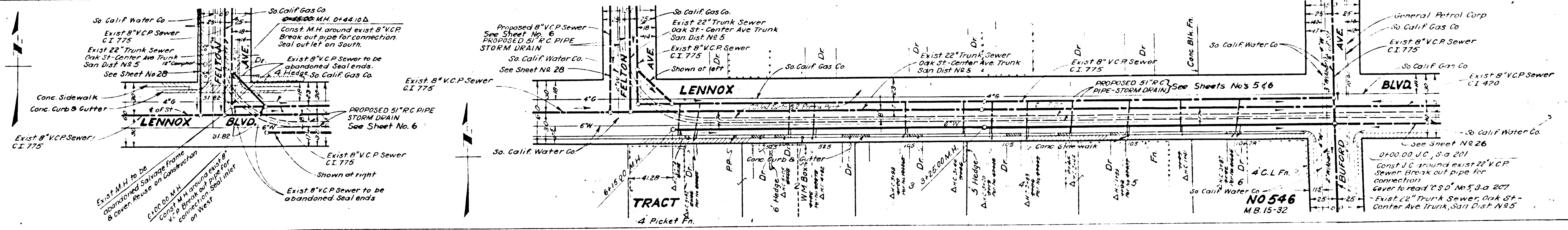
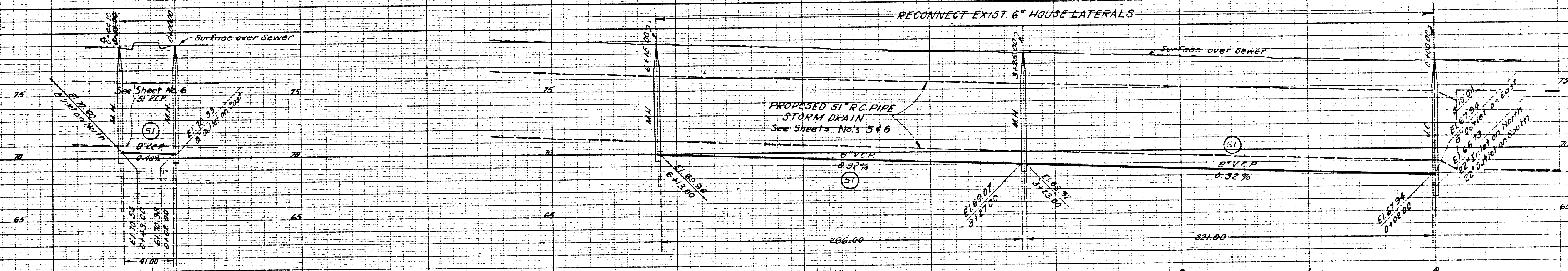

REF. P.C. # 9791

PREPARED BY		REVISIONS		LOS ANGELES COUNTY FLOOD CONTROL DISTRICT	
WILLIAM J. FOX		MARK	DATE	PROJECT NO. 13	
COUNTY ENGINEER		Δ	7-22-58	INGLEWOOD AVE-CENTURY BLVD	
RECOMMENDED BY		DESCRIPTION		LINE A	
<i>A.P. Cline</i>		As Built		SANITARY SEWER RECONSTRUCTION	
CONSTRUCTION AND STORM DRAIN ENGINEER		DRAWN BY COUNTY OF L.A.		PLAN AND PROFILE	
DRAWN BY L.S. FINNEGAN		CHECKED BY COUNTY OF L.A.		APPROVED BY <i>W. J. Fox</i>	
SUBMITTED BY W. J. FOX		REVISIONS BY W. J. FOX		DATE: MAY 1956	
CHECKED BY F.A. WOOD		DATE: NOV 1955		SHEET 27 OF 38	

DIETZGEN
2007-8-16
STAINLESS

WYV UPRATE WYLE V

WYV UPRATE WYLE V

47405

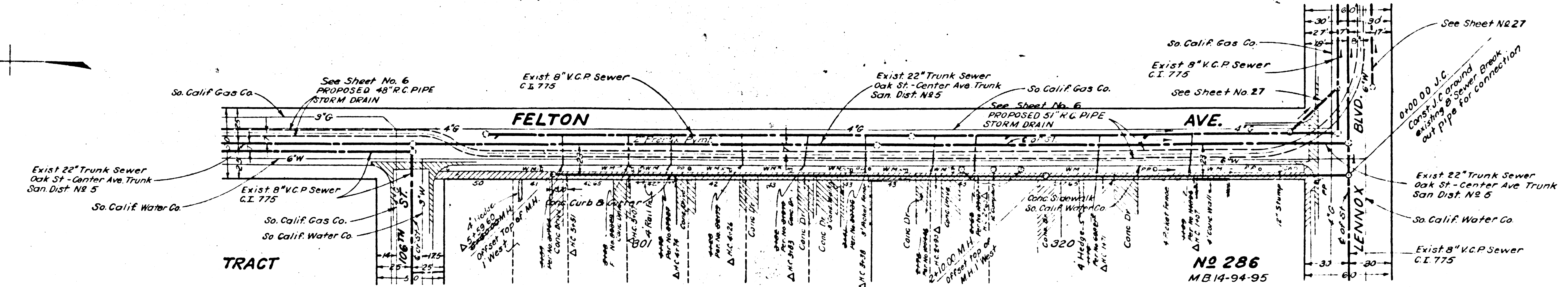
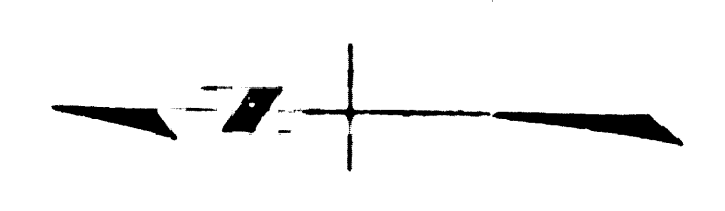
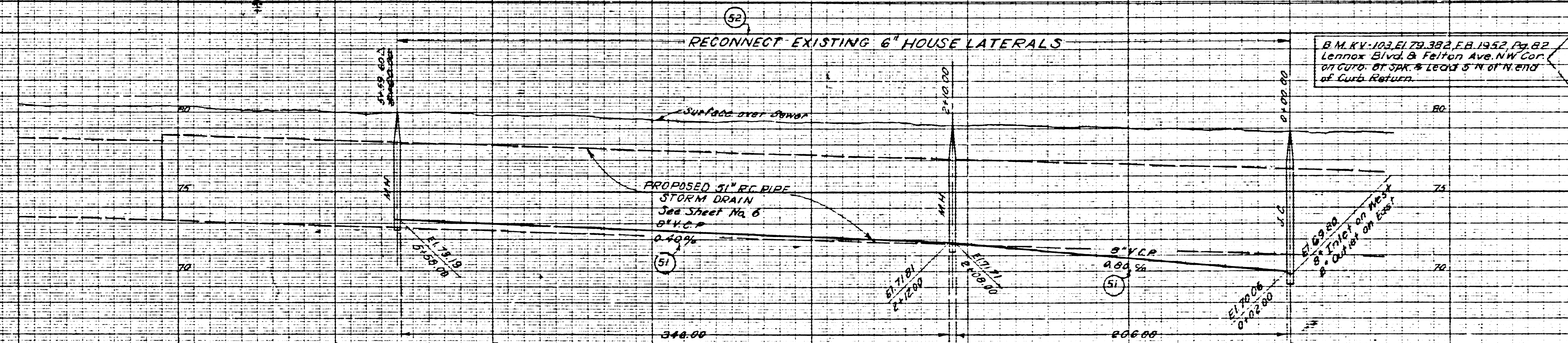

N2 286
MB 14-94-95

REF. P.C. # 9791

COUNTY STORM DRAIN BOND ISSUE

PREPARED BY WILLIAM J. FOX COUNTY ENGINEER RECOMMENDED BY <i>[Signature]</i> SANITATION ENGINEER <small>DRAWN BY: L. J. FINNEGAN CHECKED BY: F. A. WOOD</small>	REVISIONS <small>MARK DATE DESCRIPTION</small> Δ 7-22-56 As Built		LOS ANGELES COUNTY FLOOD CONTROL DISTRICT PROJECT NO. 13 INGLEWOOD AVE.-CENTURY BLVD. LINE A SANITARY SEWER RECONSTRUCTION PLAN AND PROFILE <small>SCALE: HORIZONTAL 1"=40' VERTICAL 1"=4'</small>
	<small>DATE NOV. 1956</small>	<small>DATE MAY 1956</small>	

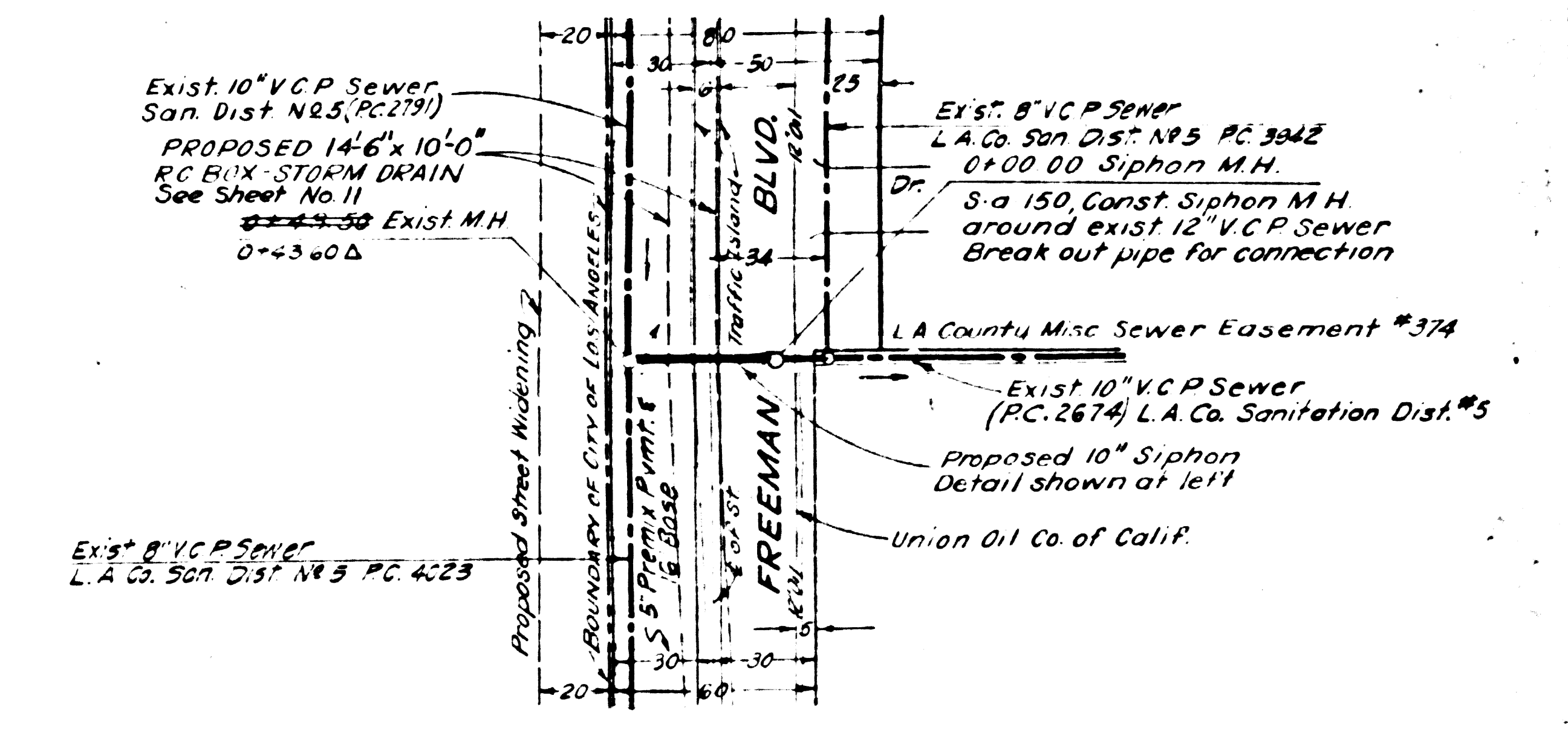
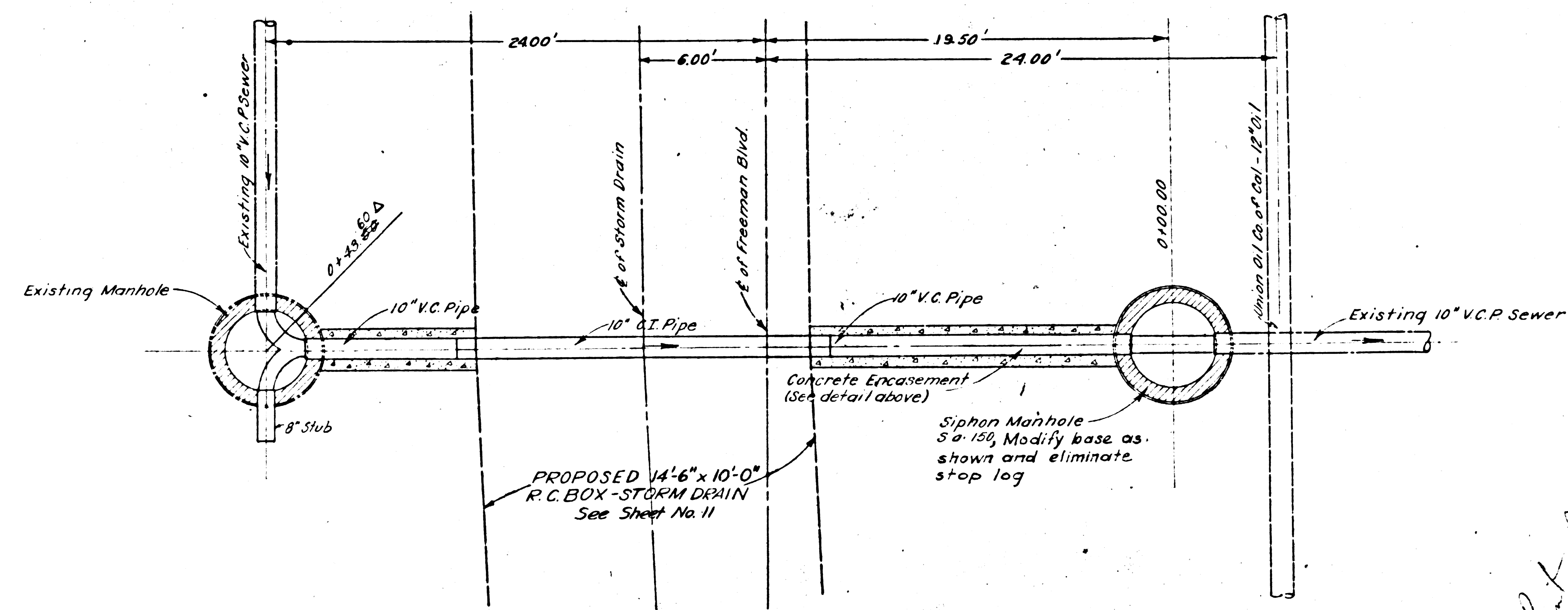
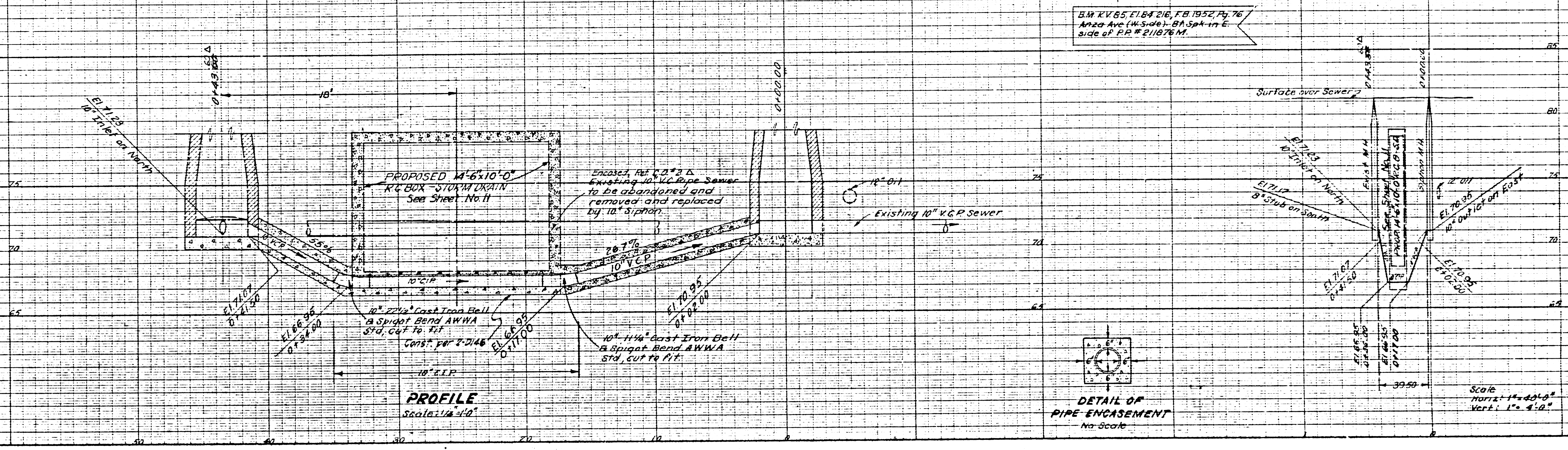

**PROPOSED 10" SIPHON
FREEMAN BLVD.
Scale: 1/4" = 1'-0"**

SANITARY SEWER SIPHON "B"

REF. PG. # 9791

PREPARED BY		REVISIONS		LOS ANGELES COUNTY FLOOD CONTROL DISTRICT	
WILLIAM J. FOX		MARK	DATE	DESCRIPTION	PROJECT NO. 13
COUNTY ENGINEER		Δ	2-25-58	As Built	INGLEWOOD AVE.-CENTURY BLVD. LINE B
RECOMMENDED BY					SANITARY SEWER RECONSTRUCTION PLAN AND PROFILE
A.P.C. [Signature]					
DRAWN BY L.S. FINNEGAN		DESIGNED BY COUNTY OF L.A.		APPROVED BY [Signature]	
CHECKED BY W.J.F.		TRACED BY COUNTY OF L.A.		CHIEF ENGINEER	
RECOMMENDED BY [Signature]		SUBMITTED BY W.J.F.		SCALE DATE NO. 181-13-D1.34	
PUBLISHED BY L.A. COUNTY		REV. NOV. 1945		AS SHOWN MAY 1958 SHEET 34 OF 28	

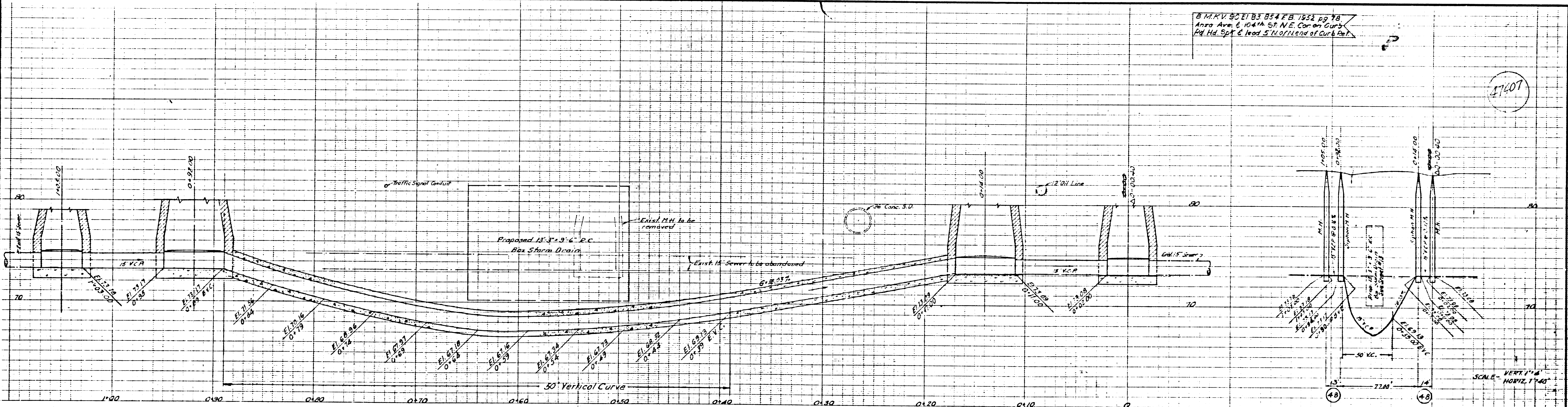

B.M. KV 50 E 1 B 3 B 5 4 F B 1 5 5 2 0 9 7 8
 Anza Ave. E 154th St. N.E. Cor. on Curb
 Peg Hd. Sp. E. Lead 5' N. of End of Curb Peg

11601

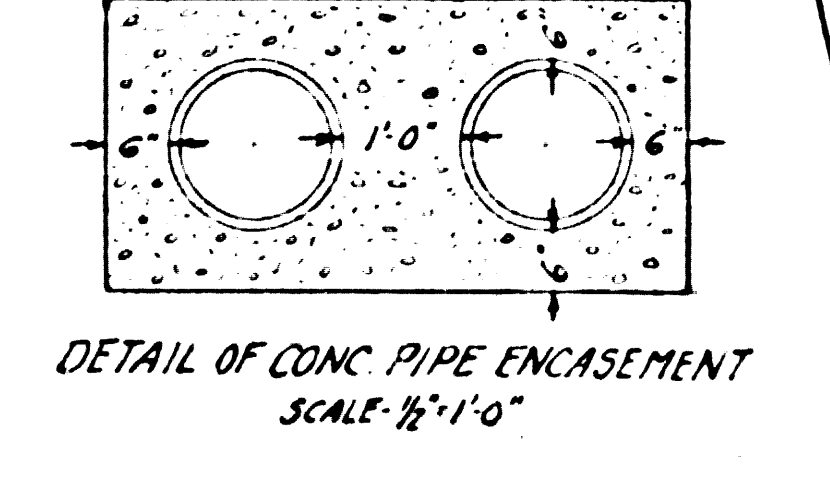
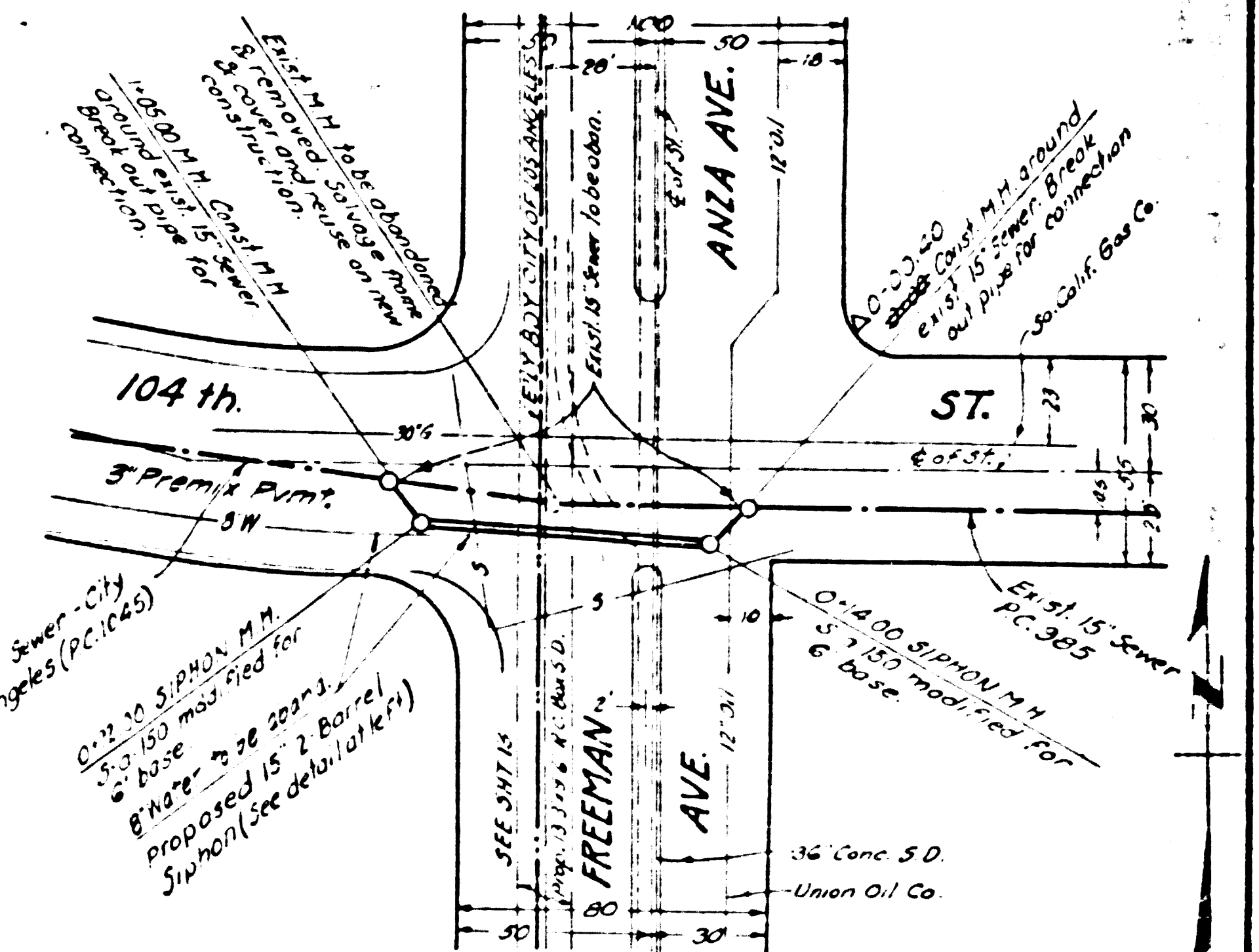
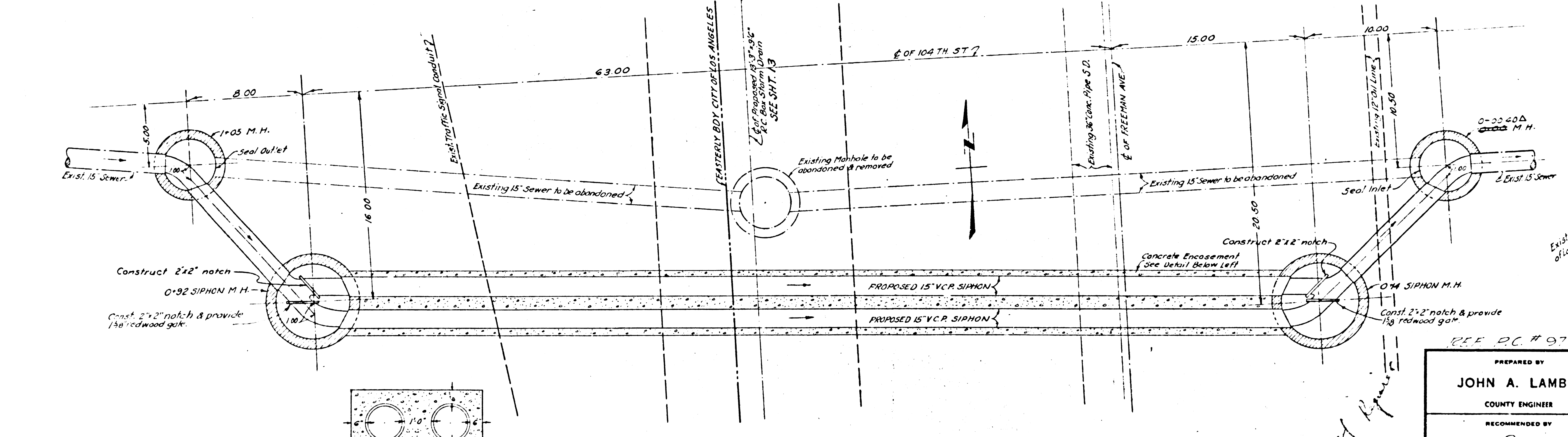
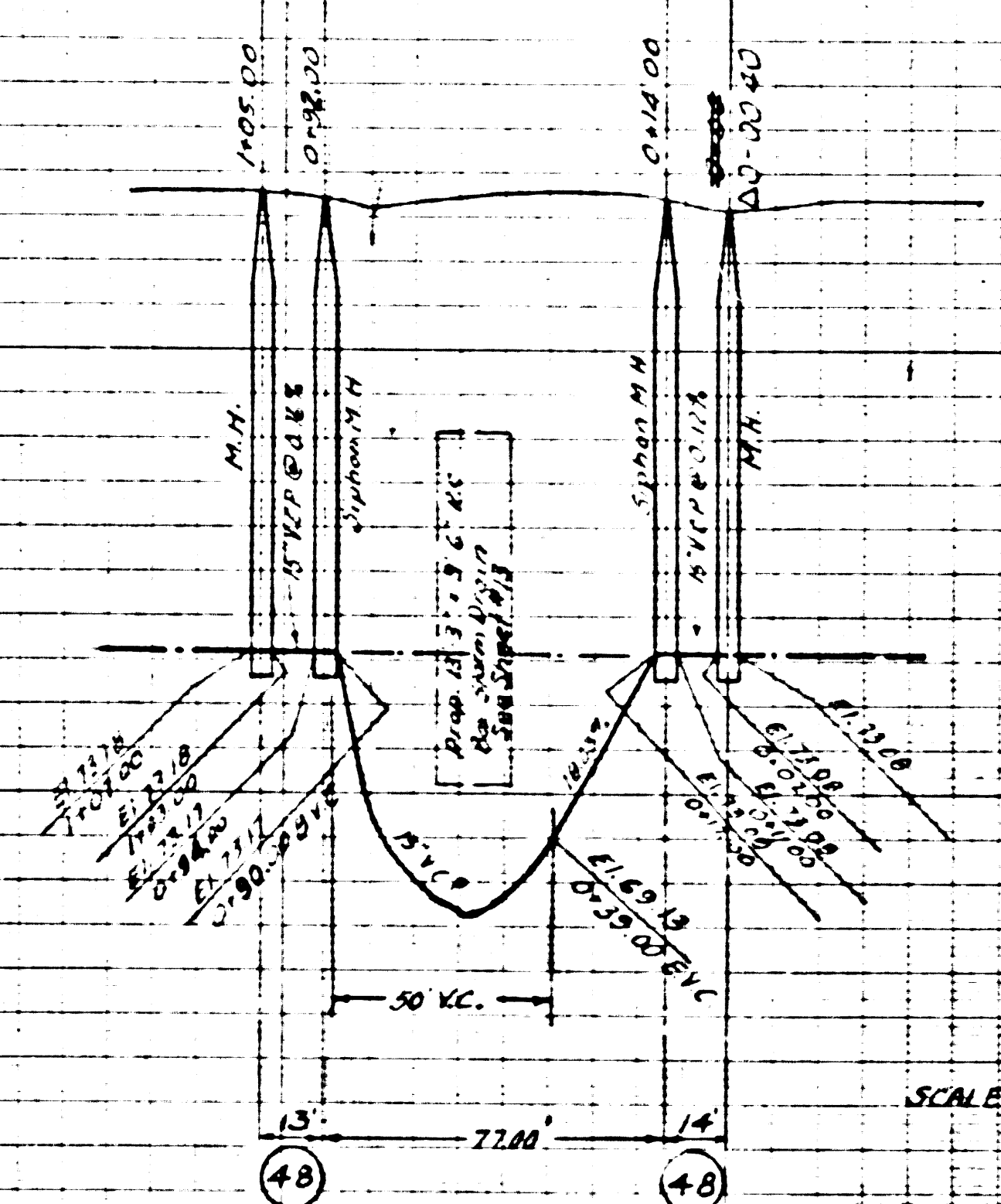

Proposed 2-Barrel 15" V.C.P. Siphon
 104th St. & FREEMAN AVE.

SCALE - VERT. 1" = 4'-0"
 HORIZ. 1" = 40'-0"

SANITARY SEWER SIPHON "E"

PREPARED BY JOHN A. LAMBIE COUNTY ENGINEER		COUNTY STORM DRAIN BOND ISSUE		LOS ANGELES COUNTY FLOOD CONTROL DISTRICT	
RECOMMENDED BY <i>A. J. Collins</i> SANITATION ENGINEER		REVISIONS MARK DATE DESCRIPTION Δ 2-23-38 AS BUILT		PROJECT NO. 13 ANGLEWOOD AVE-CENTURY BLVD LINE B SANITARY SEWER RECONSTRUCTION PLAN AND PROFILE	
DRAWN BY E.A. WOOD CHECKED BY E.J. BEVIER		DESIGNED BY E.A. WOOD DATE JUNE 1936		APPROVED BY <i>H. J. ...</i> CHIEF ENGINEER	
SCALE AS SHOWN		DATE MAY 1936		SHEET 35 OF 38	