

B.M. C.C. 3922 ELEV. 872.750
 S. 41 L. IN C.B. S'S. B.C.R. 20' W'LY.
 88' 31" & INTERSECTION DIAMOND
 BAR BLVD. AND SOLAIRE STREET.
 OTTERBEIN QUAD. 1975.

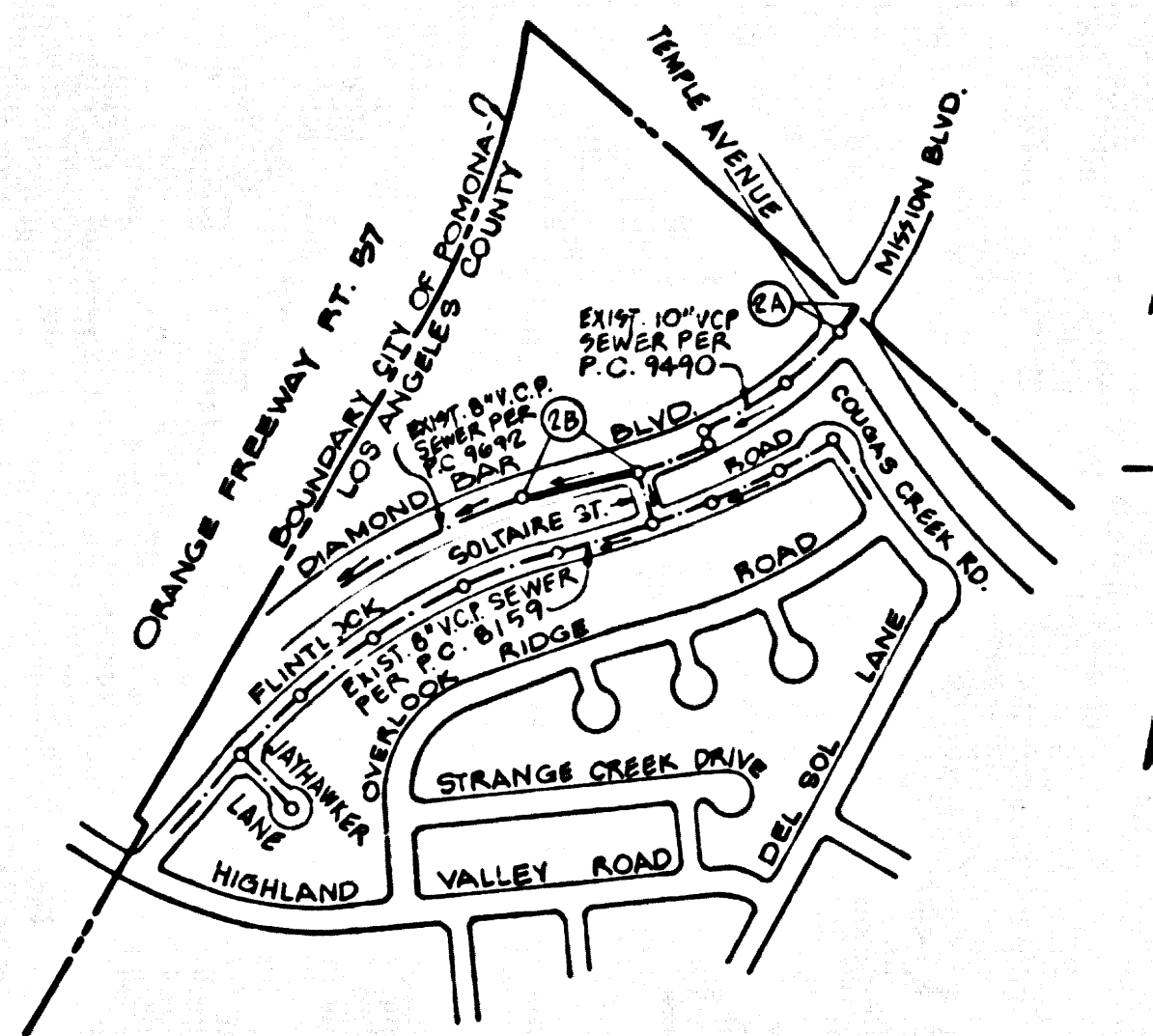

INDEX MAP
 SCALE: 1" = 600'
 P.C. 9825

NO GUARANTEE FOR THE PRECISION OF THE DATA SHOWN HEREON. THE ENGINEER HAS CONDUCTED VISUAL INSPECTIONS OF THE EXISTING UTILITIES AND RECORDS AND HAS FOUND THEM TO BE CORRECT. THE ENGINEER HAS NOT CONDUCTED SURVEYS OF THE EXISTING UTILITIES AND RECORDS. THE ENGINEER HAS NOT CONDUCTED SURVEYS OF THE EXISTING UTILITIES AND RECORDS. THE ENGINEER HAS NOT CONDUCTED SURVEYS OF THE EXISTING UTILITIES AND RECORDS.

GENERAL NOTES:

1. EXISTING LINES ARE SHOWN AS D.C. & S.E. BY DATE OF 1958.
2. NO REVISIONS SHALL BE MADE IN THESE PLANS WITHOUT THE APPROVAL OF THE COUNTY ENGINEER.
3. NO REPRESENTATIVE OF THE COUNTY ENGINEER SHALL BE REQUIRED TO BE ON ANY PORTION OF THE WORK.
4. GRADE TO WHICH THE IMPROVEMENT IS TO BE CONSTRUCTED AND SHOWN ON THESE PLANS SHALL BE SHOWN AS GRADE POINTS FOR TOP OF CURB, CENTER LINE OF STREET, OR CENTER LINE OF ALLEYS AS SHOWN BY CIRCLES ON PROFILES AT ALL POINTS BETWEEN SETBACK POINTS. THE GRADE SHALL BE ESTABLISHED AS TO CONDITIONS OF A STRAIGHT LINE BETWEEN SUCH SETBACK POINTS.
5. THE PRIVATE ENGINEER SHALL FURNISH THE COUNTY ENGINEER WITH GRADE SHEETS AND STATIONING FOR ALL HOUSE LATERALS AND "T" OR "T" BRANCHES AND SHALL PROVIDE STAKES FOR THEM AT THEIR PROPER LOCATIONS WITH STATIONING PLAINLY ALIGNED. ALL HOUSE LATERALS SHALL BE CONSTRUCTED IN A STRAIGHT ALIGNMENT AT RIGHT ANGLES FROM THE MAIN LINE SEWER EXCEPT AS SHOWN ON THE PLANS. HOUSE LATERALS FROM CHIMNEYS SHALL NOT EXCEED AN ANGLE OF LESS THAN 45° WITH THE MAIN LINE SEWER. ANY CHANGE IN ALIGNMENT SHALL BE INDICATED BY THE PRIVATE ENGINEER.
6. THE PRIVATE ENGINEER SHALL FURNISH THE HOUSE LATERAL SHEETS AT THE PROPERTY LINE BEHIND THE TOP OF CURB REVISION FOR EACH HOUSE LATERAL ON THE GRADE SHEET.
7. BEFORE WORK CAN BE STARTED, THE CONTRACTOR MUST OBTAIN A PERMIT TO EXCAVATE IN COUNTY STREETS FROM THE L.A. COUNTY ROAD DEPT., DISTRICT OFFICE NO. 1, AND PAY A FEE TO THE COUNTY ENGINEER, 201 E. BROADWAY, 5TH FLOOR, SAN DIMAS REGIONAL OFFICE TO COVER THE COST OF CONSTRUCTION INSPECTION AND RECORD PLANS.
8. IF WORK IS TO BE DONE IN A STATE HIGHWAY, A PERMIT MUST BE OBTAINED FROM THE DEPT. OF CALIFORNIA, DIVISION OF HIGHWAYS, 120 SOUTH BRIDGE STREET, LOS ANGELES, CALIFORNIA.
9. APPROVAL OF THIS PLAN BY THE COUNTY OF LOS ANGELES DOES NOT CONSTITUTE AN ENDORSEMENT AS TO THE ACCURACY OF THE LOCATION OF OR THE EXISTENCE OR WITH EXISTENCE OF ANY UNDERGROUND UTILITY PIPE, OR STRUCTURE WITHIN THE LIMITS OF THE PROJECT. THIS NOTE APPLIES TO ALL PAGES.
10. REFER TO SECTION 206.1.8 OF THE STANDARD SPECIFICATIONS, REGARDING LIFTY COVER.
11. PRIOR TO TRENCHING OF THE EXISTING SEWER CONSTRUCTION SHALL BE IN THE COUNTY ENGINEER'S OFFICE. THE CONTRACTOR SHALL NOTIFY THE ENVIRONMENTAL DEVELOPMENT DIVISION BY TELEPHONE 758-2166 AT LEAST THIRTY-FOUR HOURS BEFORE STARTING ANY WORK UNDER THIS CONTRACT.

CONSTRUCTION NOTES:

1. WORK SHALL BE CONSTRUCTED ACCORDING TO THE STANDARD SPECIFICATIONS FOR PUBLIC WORKS CONSTRUCTION (TYPE EDITION) WITH THE COMMENTS AND COUNTY ENGINEER SPECIAL PROVISIONS FOR THE CONSTRUCTION OF SANITARY SEWERS UNDER SECTION 206.1.1378.
2. THE CONTRACTOR SHALL NOTIFY THE ENVIRONMENTAL DEVELOPMENT DIVISION BY TELEPHONE 758-2166 AT LEAST THIRTY-FOUR HOURS BEFORE STARTING ANY WORK UNDER THIS CONTRACT.
3. HOUSE LATERALS TO BE CONSTRUCTED WITH INVERTS AT PROPERTY LINE & FIVE INCHES CURB GRADE EXCEPT AS NOTED.
4. VETS OR THE BRANCHES MAY BE USED FOR CONNECTIONS TO MAINLINE SEWERS EXCEPT AS NOTED.
5. ALL STRUCTURES SHALL BE SETBACK MANHOLES PER 5.0 OR PRECAST CONCRETE MANHOLES PER 5.23, EXCEPT AS NOTED.
6. APPROVAL STAKES ON THE PROPERTY LINE OR PROPERTY LINES PROVIDED AT RIGHT ANGLES TO THE SEWER LINE AT THE CENTER LINE OF EACH MANHOLE.
7. MANHOLES FROM AN UNIMPROVED PORTION OF WAY TO BE SIX INCHES ABOVE FINISHED GRADE.
8. VERTICAL CURB PER 20.01 SHALL BE TYPE "C", "D", OR "E" PER STANDARD SPECIFICATIONS SECTION 206.1.
9. IF A POWER POLE IS WITHIN THREE FEET OF THE SEWER, THE SEWER SHALL BE ENCASED PER 5.23, CASE 2, TWO FEET ON EACH SIDE FROM THE POINT OF INTERFERENCE.
10. IF DURING THE COURSE OF CONSTRUCTION IT IS DETERMINED THAT THERE IS LESS THAN FOUR FEET OF COVER OVER THE TOP OF A MAIN LINE OR HOUSE LATERAL V.C.P. SEWER WHICH IS NOT INDICATED ON THE PLANS, THE PIPE SHALL BE ENCASED PER 5.23, CASE 2, UNLESS OTHERWISE APPROVED BY THE COUNTY ENGINEER.
11. ALL JOINTS BETWEEN CAST IRON PIPE AND VITRIFIED CLAY PIPE SHALL BE MADE WITH A RUBBER SLEEVE JOINT, TYPE "C" OR "F", WITH SLEEVES AS NECESSARY PER STANDARD SPECIFICATIONS SECTION 206.1.
12. SEWERS TO BE TESTED FOR LEAKAGE PER SECTION 206.1.9 OF THE STANDARD SPECIFICATIONS AND SPECIAL PROVISIONS.
13. INSURE ALL TRENCHES WITHIN PAVED AREAS TO MEET L.A. COUNTY ROAD DEPT. OR CALIFORNIA STATE HIGHWAY REQUIREMENTS AS ACCORDANCE WITH PERMITS.
14. FULL COMPLIANCE WITH SECTION 206.1.8 OF THE SPECIAL PROVISIONS WILL BE REQUIRED FOR BACKFILL IN STREETS. CERTIFICATION OF BACKFILL CONSTRUCTION AND SOIL STABILIZATION BY A QUALIFIED REGISTERED TESTING LABORATORY SHALL BE PROVIDED BY THE PERMITTEE PRIOR TO THE ISSUANCE OF A CERTIFICATE OF PARTIAL ACCEPTANCE.

PROFILE, ALIGNMENT AND GRADE OF
 SANITARY SEWERS PAGE 1

TO BE CONSTRUCTED IN
 DIAMOND BAR BOULEVARD
 PRIVATE CONTRACT NO. 9825

W.S. 39-D1
 1 SHEET, 2 PAGES (47673)
 SCALE: HORIZ. 1" = 80' VERT. 1" = 4'
 FEBRUARY, 1980
 PREPARED IN THE OFFICES OF
 COOPER-SHERMAN ENGINEERING COMPANY
 10960 WILSHIRE BOULEVARD, LOS ANGELES, CA 90024
 BY: *Stacy K. W...* (REG. C.E. No. 22581)

THE FOLLOWING LISTED SEWER MATERIALS PLANS ON FILE IN THE OFFICE OF THE COUNTY ENGINEER SHALL APPLY IN THE CONSTRUCTION OF THIS PROJECT.

LEADING	5.1
BRICK MANHOLE	5.2
STANDARD MANHOLE TOP	5.27
REINFORCED CONCRETE PIPE	5.28
CASTING AND ENCASEMENT	5.29
TYPE OF THE SUPPORT	5.30
ADDITIONAL TRENCH WIDTH	5.31
LOCATING MANHOLE FRAME AND COVER	5.32
NON-REINFORCED PRECAST CONCRETE MANHOLE	5.33

COUNTY OF LOS ANGELES, CALIFORNIA
 STEPHEN J. KOONCE COUNTY ENGINEER WALTER E. GARANSON, CHIEF ENGINEER
 APPROVED: *Stephen J. Koonce* (DATE: 2/1/80) *Walter E. Garanson* (DATE: 2/1/80)
 CHECKED: *Ralph David Smith* 3/17/80 (DATE: 3/17/80)
 REG. C.E. NO. 16883
 SAN DIMAS BLDG. DIST. 10

P.C. 9825 PAGE 2

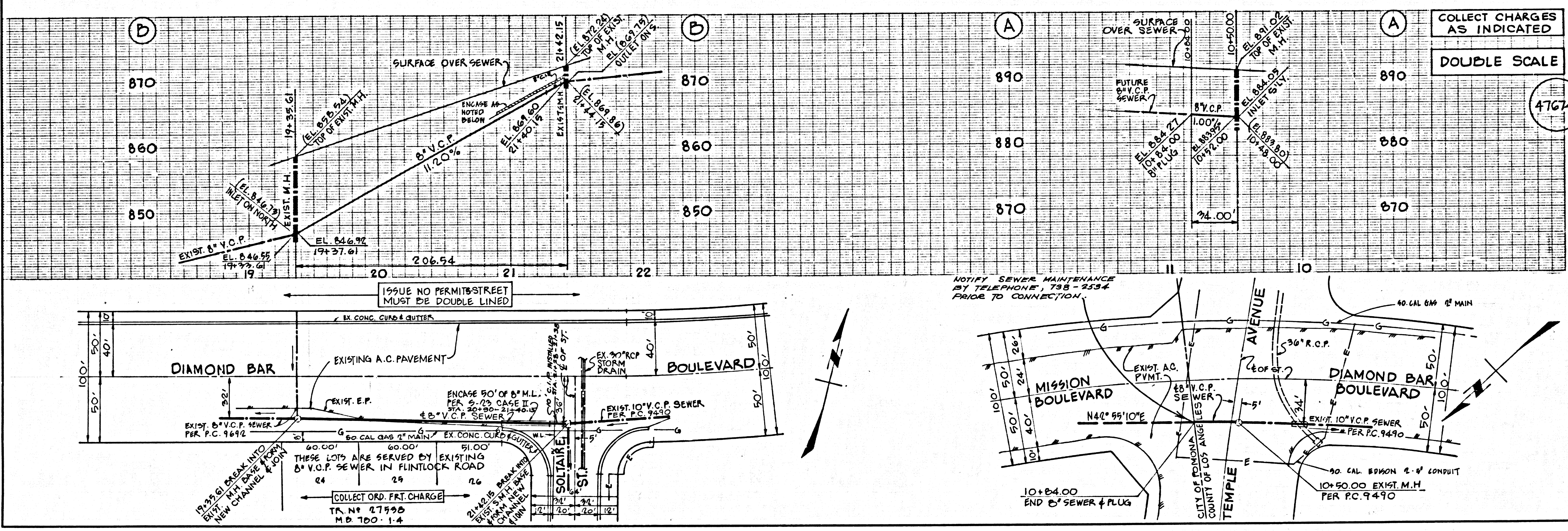

COLLECT CHARGES AS INDICATED
 DOUBLE SCALE (47674)