

SANITARY SEWERS

TO BE CONSTRUCTED IN

TRACT NO. 34287
PRIVATE CONTRACT NO. 9915

W.S. 38-A4
1 SHEET 2 PAGES

SCALE: VERT. 1" = 4'
HORIZ. 1" = 40'

DATE: DECEMBER 1980
PREPARED IN THE OFFICES OF
JOHN D. ROSE & ASSOCIATES
170 S. BREA BLVD.
BREA, CALIF. 92621

BY: John D. Rose
REG. C. E. No. 12437

50177

THE FOLLOWING LATEST REVISED STANDARD PLANS ON FILE IN THE OFFICE OF THE COUNTY ENGINEER SHALL APPLY IN THE CONSTRUCTION OF THIS PROJECT:

LEGEND	5-1
MINIMUM PUBLIC SAFETY REQUIREMENTS	5-2
BRICK MANHOLE	5-3
STANDARD MANHOLE RISE	5-4
BRASSING FOR SEWER PIPE	5-5
CHANGING AND RECESSMENT	5-6
WYE OR THE SUPPORT	5-7
ALLOWABLE TRENCH WIDTHS	5-8
LOADING MANHOLE FRAME AND COVER	5-9
NON-REINFORCED PRECAST CONCRETE MANHOLE	5-10
PRECAST CONCRETE SHALLOW MANHOLE	5-11
RECTANGULAR MANHOLE FRAME/COVER	5-12

COUNTY OF LOS ANGELES, CALIFORNIA

STEPHEN J. LADONCE, COUNTY ENGINEER
WALTER E. GARDNER, CHIEF ENGINEER

APPROVED: Sam Miller 1/24/82
SAN DIMAS REGIONAL ENGINEER

CHECKED: Ralph D. Rose 1/21/82
DATE

MR. C.E. NO. 16443
LA PUENTE BLDG. DIST. 2.00

GENERAL NOTES:

- ELEVATIONS ARE IN FEET ABOVE U.S.C. & G.S. SEA LEVEL, DATUM OF 1929.
- NO REVISIONS SHALL BE MADE IN THESE PLANS WITHOUT THE APPROVAL OF THE COUNTY ENGINEER.
- NO REPRESENTATIVE OF THE COUNTY ENGINEER WILL SURVEY OR LAY OUT ANY PORTION OF THE WORK.
- GRADES TO WHICH THE IMPROVEMENTS ARE TO BE CONSTRUCTED ARE SHOWN ON PLANS AND HOUSE HOUSING GRADE POINTS FOR TOP OF CURBS, CENTER LINE OF STREETS, OR CENTER LINE OF ALLEYS ARE SHOWN BY CIRCLES OR TRIANGLES AT ALL POINTS BETWEEN DESIGNATED POINTS. THE GRADE SHALL BE ESTABLISHED SO AS TO CONFORM TO A STRAIGHT LINE DRAWN BETWEEN SAID DESIGNATED POINTS.
- THE PRIVATE ENGINEER SHALL FURNISH THE COUNTY ENGINEER WITH GRADE SHEETS AND STATIONING FOR ALL HOUSE LATERALS AND "Y" OR "T" BRANCHES AND SHALL PROVIDE STAKES FOR THEM AT THEIR PROPER LOCATIONS WITH STATIONING PLAINLY MARKED. ALL HOUSE LATERALS SHALL BE CONSTRUCTED IN A STRAIGHT ALIGNMENT AT RIGHT ANGLES FROM THE MAIN LINE SEWER EXCEPT AS SHOWN ON THE PLANS. HOUSE LATERALS FROM COTTAGES SHALL NOT HAVE AN ANGLE OF LESS THAN 45° WITH THE MAIN LINE SEWER. ANY CHANGE IN ALIGNMENT SHALL BE REQUESTED IN WRITING BY THE PRIVATE ENGINEER.
- THE PRIVATE ENGINEER SHALL FURNISH THE HOUSE LATERAL DEPTH AT THE PROPERTY LINE BELOW THE TOP OF CURB ELEVATION FOR EACH HOUSE LATERAL ON THE GRADE SHEET.
- BEFORE WORK CAN BE STARTED, THE CONTRACTOR MUST OBTAIN A PERMIT TO EXCAVATE IN COUNTY STREETS FROM THE L.A. COUNTY ROAD DEPT., DISTRICT OFFICE NO. 1, AND PAY A FEE TO THE COUNTY ENGINEER, 850 E. BOWTIE AVE., SAN GABRIEL REGIONAL OFFICE TO COVER THE COST OF CONSTRUCTION INSPECTION AND RECORD PLANS.
- IF WORK IS TO BE DONE IN A STATE HIGHWAY, A PERMIT MUST BE OBTAINED FROM THE STATE OF CALIFORNIA, DIVISION OF HIGHWAYS, 120 SOUTH SPRING STREET, LOS ANGELES, CALIFORNIA.
- APPROVAL OF THIS PLAN BY THE COUNTY OF LOS ANGELES DOES NOT CONSTITUTE A REPRESENTATION AS TO THE ACCURACY OF THE LOCATION OF OR THE EXISTENCE OR NON-EXISTENCE OF ANY UNDERGROUND UTILITY PIPE, OR STRUCTURE WITHIN THE LIMITS OF THIS PROJECT. THIS NOTE APPLIES TO ALL PAGES.
- REFER TO SECTION 214.01 OF THE STANDARD SPECIFICATIONS REGARDING SAFETY UNIFORMS.
- PRIOR TO THE ISSUANCE OF THE REQUIRED SEWER CONSTRUCTION PERMIT BY THE COUNTY ENGINEER, THE CONTRACTOR SHALL OBTAIN A PERMIT TO EXCAVATE FROM THE STATE OF CALIFORNIA DEPARTMENT OF INDUSTRIAL RELATIONS, DIVISION OF INDUSTRIAL SAFETY. HE SHALL FILE A CERTIFICATE OF WORKERS COMPENSATION INSURANCE WITH THE COUNTY ENGINEER NAMED AS THE CERTIFICATE HOLDER TO BE NOTIFIED 30 DAYS PRIOR TO CANCELLATION OF POLICY.

CONSTRUCTION NOTES:

- WORK SHALL BE CONSTRUCTED ACCORDING TO THE STANDARD SPECIFICATIONS FOR PUBLIC WORKS CONSTRUCTION (SECTION 214.01) SUPPLEMENTED BY COUNTY ENGINEER SPECIAL PROVISIONS FOR THE CONSTRUCTION OF SANITARY SEWERS DATED 12/22/76 AND SHALL BE PROCEEDED ONLY IN THE PRESENCE OF THE COUNTY ENGINEER.
- THE CONTRACTOR SHALL NOTIFY THE SANITATION DISTRICT OFFICIALS (924) 378-256, AT LEAST TWENTY-FOUR HOURS BEFORE STARTING ANY WORK UNDER THIS CONTRACT.
- HOUSE LATERALS TO BE CONSTRUCTED WITH INVERTS AT PROPERTY LINE 4 FEET BELOW CURB GRADE EXCEPT AS NOTED.
- WYE OR THE BRANCHES MAY BE USED FOR CONNECTION TO MAINLINE SEWERS EXCEPT AS NOTED.
- ALL STRUCTURE SHALL BE EITHER BRICK MANHOLES PER L.A. OR PRECAST CONCRETE MANHOLES PER S-3, EXCEPT AS NOTED.
- PROVIDE STAKES ON THE PROPERTY LINE OR PROPERTY LINES PRODUCED AT RIGHT ANGLES TO THE SEWER LINE AT THE "W" LINE OF EACH MANHOLE.
- MANHOLE TOPS IN UNIMPROVED PORTS OF WAY TO BE 2 FEET ABOVE FINISHED GRADE.
- WYTHEM CLAY PIPE JOINTS SHALL BE THE TYPE OF PIPE STANDARD SPECIFICATIONS SECTION 204-2.
- IF A POWER POLE IS WITHIN THREE FEET OF THE SEWER SHALL BE ENCASED, PER S-23, CASE II, TWO FEET ON EACH SIDE FROM THE POINT OF INTERFERENCE.
- IF DURING THE COURSE OF CONSTRUCTION IT IS DETERMINED THAT THERE IS LESS THAN FOUR FEET OF COVER OVER THE TOP OF A MAIN LINE OR HOUSE LATERAL V.C.P. SEWER WHICH IS NOT INDICATED ON THE PLANS, THE PIPE SHALL BE ENCASED PER S-23, CASE II UNLESS OTHERWISE APPROVED BY THE COUNTY ENGINEER.
- ALL JOINTS BETWEEN CLAY PIPE AND WYTHEM CLAY PIPE SHALL BE MADE WITH A RUBBER SLEEVE JOINT, TYPE "C" OR "D", WITH GASKETS IF NECESSARY PER STANDARD SPECIFICATIONS, SECTION 204-2.
- SEWERS TO BE TESTED FOR LEAKAGE PER SECTION 204-6. ON THE STANDARD SPECIFICATIONS AND SPECIAL PROVISIONS.
- REPAIRS TO ALL TRENCHES WITHIN PAVED AREAS TO MEET L.A. COUNTY ROAD DEPT. OR CALIFORNIA STATE HIGHWAY REQUIREMENTS IN ACCORDANCE WITH PERMITS.
- PERFORMANCE WITH SECTION 204-1.3.6 OF THE SPECIAL PROVISIONS WILL BE REQUIRED FOR BACKFILL IN STREETS. CERTIFICATION OF BACKFILL COMPACTION AND SAME EQUIVALENTS BY A QUALIFIED, REGISTERED TESTING LABORATORY SHALL BE PROVIDED BY THE PERMITTEE PRIOR TO THE ISSUANCE OF A CERTIFICATE OF PARTIAL ACCEPTANCE.
- FOR ALL BACKFILL (IN UNIMPROVED AREAS):
(a) BACKFILL TRENCHES & REPLACE OTHER EARTH REMOVED SO AS TO ACHIEVE THE NATURAL OR UNDISTURBED GRADE OF THE ORIGINAL GROUND ON THE ADJACENT PLANS APPROVED FOR THIS TRACT.
(b) ALL BACKFILL SHALL BE REPLACED WITH A MINIMUM OF 90% OF MAX. DENSITY PER A S.T.M. STD. METHOD OF TESTING. (S-28) STAB MODIFIED, ACCEPTABLE CERTIFICATION OF THE COMPACTION SHALL BE SUBMITTED TO THE ENVIRONMENTAL DEVELOPMENT DIV.

B.M. C6 2579 ELEV. 438.768
R.D. MON IN WELL 3" IN DN AT C/L
INT HACIENDA BLVD. + TETLEY
ST MKD (RD DEPT 1962)
BASELINE QUAD. 1975

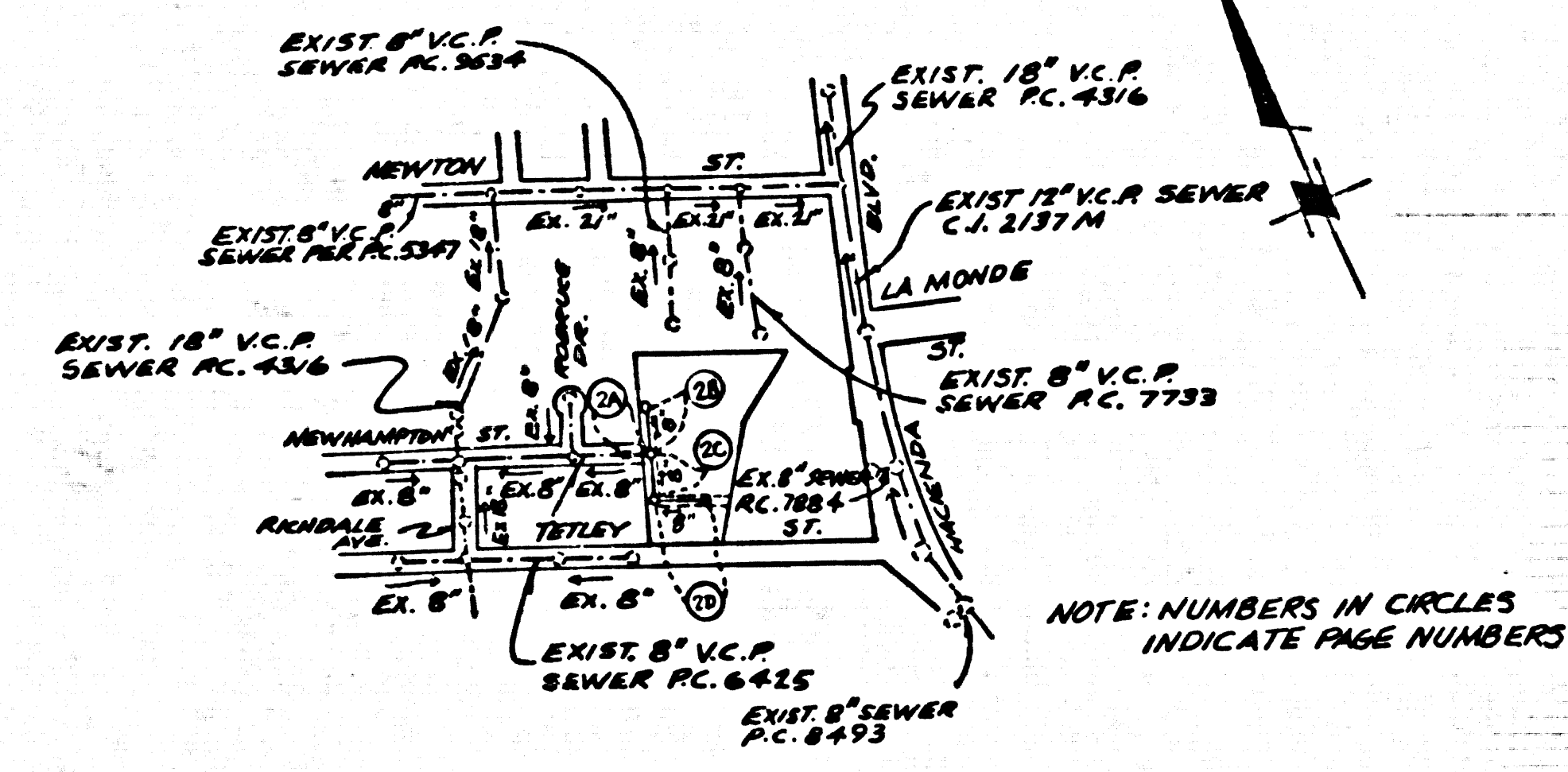

REVISION NO. 1, 4-19-83
ALL REVISIONS ARE ON PAGE 2: RAISED SURFACE OVER SEWER ON ALL SECTIONS; CHANGED TO STD. M.H. @ STA. 5+33.66 SECTION A-A; ALSO @ STA. 0+00 ON SECTION B-C; CHANGED RATE OF SEWER GRADE ON SECTION C-C; RAISED R.L. OF SEWER ON SECTION D-D; SHORTENED SEWER 7.33' ON SECTION D-D; SHORTENED LENGTH OF EASEMENT PER TRACT MAP ON SECTION D-D; CHANGED LOT NUMBERS ON ALL SECTIONS; CHANGED "CHARGE NOTE" ON RIGHT SIDE OF PLAN OF SECTION D-D.
APPROVED: Ralph D. Rose 4/19/83 16443
OFFICE OF COUNTY ENGINEER, R.C.E.

NO CONNECTION FOR THE DISPOSAL OF INDUSTRIAL WASTES SHALL BE MADE TO SEWERS SHOWN ON THESE DRAWINGS UNTIL A PERMIT FOR INDUSTRIAL WASTEWATER DISCHARGE HAS BEEN ISSUED BY THE SANITATION DISTRICTS FOR SAID CONNECTION.
BEFORE BREAKING INTO OR CONSTRUCTION ON A COUNTY SANITATION DISTRICT SEWER AND PRIOR TO FINAL ACCEPTANCE OF THE PROJECT, SANITATION DISTRICT INSPECTOR SHALL BE NOTIFIED BY PHONE - 942-8605, 858-2281 SO THAT REQUIRED INSPECTION CAN BE MADE.

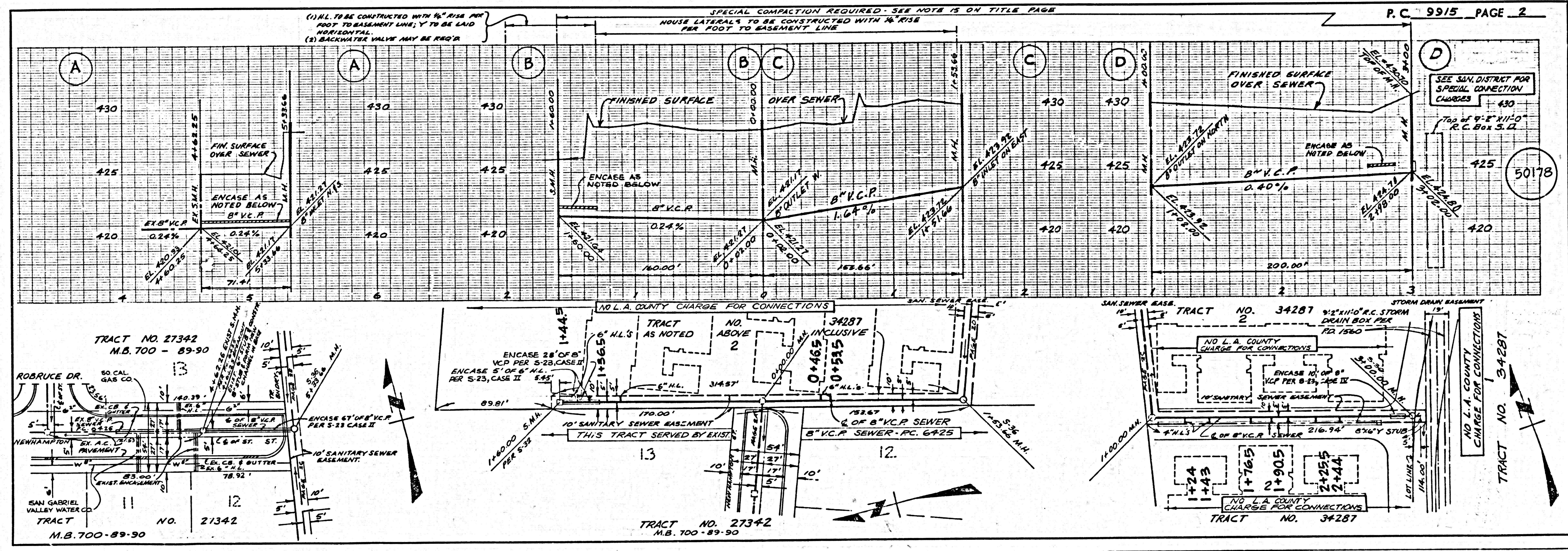

210029

18543-01-13421-1