

MOUNT SAWTOOTH DRIVE
 (TEMPORARY SEWER OUTLET FOR TENTATIVE TRACT 25210)
 PRIVATE CONTRACT NO. 9918

W.S. 28
 1 SHEET, 2 PAGES
 SCALE: VERT. 1"=8'
 HORIZ. 1"=40'
 DEC. 1980
 PREPARED IN THE OFFICES OF
LANCO ENGINEERING
 17430 S. Prairie Avenue, Torrance, Calif., 90504
 BY: *C. W. Lead*
 REG. C.E. No. 13167

49141

B.M. 7297 ELEV. 229.292
 C.S. MON. 17. IN C.B. @ SW. COR. WILSON AVE. &
 TOSCANINI DR. 80 FT 3 IN. W. / E. NT. MED.
 (BM 95-3A 1964)
 PALOS VERDES QUAD. 19 75 ADJ.

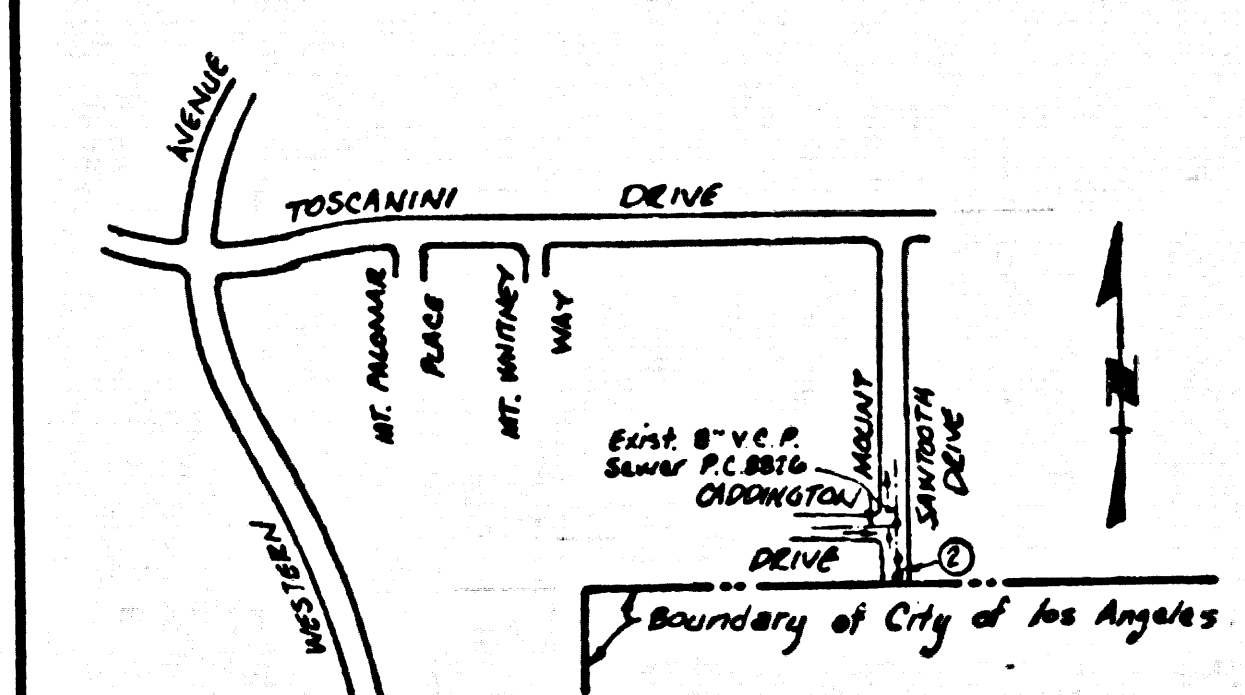

INDEX MAP
 SCALE: 1"=600'
 P.C. 9918

REVISIONS

△	REVISED ALIGNMENT TO 5' EAST OF E OF ST.
	REVISED BY: <i>Ma. M. Lopez</i> R.E. NO. 11504
	APPROVED BY: <i>Ralph David Sweet</i> DATE: 11/14/81

NO CONNECTION FOR THE DISPOSAL OF INDUSTRIAL WASTES SHALL BE MADE TO SEWERS SHOWN ON THESE DRAWINGS UNTIL A PERMIT FOR INDUSTRIAL WASTEWATER DISCHARGE HAS BEEN ISSUED BY THE SANITATION DISTRICTS FOR SAID CONNECTION.

BEFORE BREAKING INTO OR CONSTRUCTION ON A COUNTY SANITATION DISTRICT SEWER AND PRIOR TO FINAL ACCEPTANCE OF THE PROJECT, SANITATION DISTRICT INSPECTOR SHALL BE NOTIFIED BY PHONE - 482-0000, 638-1161 SO THAT REQUIRED INSPECTION CAN BE MADE.

NOTE:
 WHEN THE USE OF THIS TEMPORARY SEWER IS TERMINATED IT WILL BE THE RESPONSIBILITY OF THE DEVELOPER OF TRACT NO. 25210 IN THE CITY OF LOS ANGELES TO HAVE THE SEWER ABANDONED PER SPEC'S SEC. 306-5. CALL 758-8156 FOR INSPECTION.

- GENERAL NOTES:**
1. ELEVATIONS ARE IN FEET ABOVE U.S.C. & G.S. SEA LEVEL DATUM OF 1929.
 2. NO REVISIONS SHALL BE MADE IN THESE PLANS WITHOUT THE APPROVAL OF THE COUNTY ENGINEER.
 3. NO REPRESENTATIVE OF THE COUNTY ENGINEER WILL SURVEY OR LAY OUT ANY PORTION OF THE WORK.
 4. GRADES TO WHICH THIS IMPROVEMENT IS TO BE CONSTRUCTED ARE SHOWN ON PLANS AND PROFILES. GRADE POINTS FOR TOP OF CURBS, CENTER LINE OF STREETS, OR CENTER LINE OF ALLEYS ARE SHOWN BY CIRCLES ON PROFILES AT ALL POINTS BETWEEN DESIGNATED POINTS THE GRADE SHALL BE ESTABLISHED SO AS TO CONFORM TO A STRAIGHT LINE DRAWN BETWEEN SAID DESIGNATED POINTS.
 5. THE PRIVATE ENGINEER SHALL FURNISH THE COUNTY ENGINEER WITH GRADE SHEETS AND STATIONING FOR ALL HOUSE LATERALS AND "T" OR "Y" BRANCHES AND SHALL PROVIDE STAKES FOR THEM AT THEIR PROPER LOCATIONS WITH STATIONING PLAINLY MARKED. ALL HOUSE LATERALS SHALL BE CONSTRUCTED IN A STRAIGHT ALIGNMENT IF RIGHT ANGLES FROM THE MAIN LINE SEWER EXCEPT AS SHOWN ON THE PLANS. HOUSE LATERALS FROM CHIMNEYS SHALL NOT HAVE AN ANGLE OF LESS THAN 45° WITH THE MAIN LINE SEWER. ANY CHANGE IN ALIGNMENT SHALL BE REQUESTED IN WRITING BY THE PRIVATE ENGINEER.
 6. THE PRIVATE ENGINEER SHALL FURNISH THE HOUSE LATERAL DEPTH AT THE PROPERTY LINE BELOW THE TOP OF CURB ELEVATION FOR EACH HOUSE LATERAL ON THE GRADE SHEET.
 7. BEFORE WORK CAN BE STARTED, THE CONTRACTOR MUST OBTAIN A PERMIT TO EXCAVATE IN COUNTY STREETS FROM THE L.A. COUNTY ROAD DEPT., DISTRICT OFFICE NO. 5, AND PAY A FEE TO THE COUNTY ENGINEER 750 & VERNON AVE., L.A. OR 48129 MARSHALL AVE., LOMITA TO COVER THE COST OF CONSTRUCTION INSPECTION AND RECORD PLANS.
 8. IF WORK IS TO BE DONE IN A STATE HIGHWAY, A PERMIT MUST BE OBTAINED FROM THE STATE OF CALIFORNIA, DIVISION OF HIGHWAYS, 126 SOUTH SPRING STREET, LOS ANGELES, CALIFORNIA.
 9. APPROVAL OF THIS PLAN BY THE COUNTY OF LOS ANGELES DOES NOT CONSTITUTE A REPRESENTATION AS TO THE ACCURACY OF THE LOCATION OF OR THE EXISTENCE OR NON-EXISTENCE OF ANY UNDERGROUND UTILITY PIPE, OR STRUCTURE WITHIN THE LIMITS OF THIS PROJECT. THIS NOTE APPLIES TO ALL PAGES.
 10. REFER TO SECTION 218.1 OF THE STANDARD SPECIFICATIONS, REGARDING SAFETY ORDERS.
 11. PRIOR TO THE ISSUANCE OF THE REQUIRED SEWER CONSTRUCTION PERMIT, THE CONTRACTOR SHALL OBTAIN AND FILE WITH THE COUNTY ENGINEER COPIES OF A PERMIT TO EXCAVATE IN COUNTY STREETS FROM THE LOS ANGELES COUNTY ROAD DEPARTMENT, A PERMIT FOR EXCAVATIONS AND TRENCHES FROM THE STATE OF CALIFORNIA, DIVISION OF HIGHWAYS, SAFETY AND A CERTIFICATE OF WORKABLE COMMUNICATIONS FROM THE DEPARTMENT OF THE COUNTY ENGINEER, 900 SOUTH VERMONT, LOS ANGELES, CALIF., 90010 NAMED AS THE CONTRACTOR IN ACCORDANCE WITH SECTION 306.5 OF THE STANDARD SPECIFICATIONS OF PUBLIC WORKS.

- CONSTRUCTION NOTES:**
1. WORK SHALL BE CONSTRUCTED ACCORDING TO THE STANDARD SPECIFICATIONS FOR PUBLIC WORKS CONSTRUCTION (1977 EDITION) WITH "1980" SUPPLEMENT AND COUNTY ENGINEER SPECIAL PROVISIONS FOR THE CONSTRUCTION OF SANITARY SEWERS DATED 11/17/80 AND SHALL BE PROSECUTED ONLY IN THE PRESENCE OF THE COUNTY ENGINEER.
 2. THE CONTRACTOR SHALL NOTIFY THE SANITATION DIVISION BY TELEPHONE, 758-8156, AT LEAST TWENTY-FOUR HOURS BEFORE STARTING ANY WORK UNDER THIS CONTRACT.
 3. HOUSE LATERALS TO BE CONSTRUCTED WITH INVERTS AT PROPERTY LINE 6 FEET BELOW CURB GRADE EXCEPT AS NOTED.
 4. WYE OR TE BRANCHES MAY BE USED FOR CONNECTIONS TO ALIQUOT SEWERS EXCEPT AS NOTED.
 5. ALL STRUCTURES SHALL BE EITHER BRICK MANHOLES PER S-26, EXCEPT AS NOTED.
 6. PROVIDE STAKES ON THE PROPERTY LINE OR PROPERTY LINES PRODUCED AT RIGHT ANGLES TO THE SEWER LINE AT THE CENTER LINE OF EACH MANHOLE.
 7. MANHOLES TOPS IN UNIMPROVED RIGHTS OF WAY TO BE SIX INCHES ABOVE FINISHED GRADE.
 8. INVERTED CLAY PIPE JOINTS SHALL BE TYPE "T", "P", OR "O" PER STANDARD SPECIFICATIONS SECTION 306-3.
 9. IF A POWER POLE IS WITHIN THREE FEET OF THE SEWER, THE SEWER SHALL BE ENCASED, PER S-23, CASE II, TWO FEET ON EACH SIDE FROM THE POINT OF INTERFERENCE.
 10. IF DURING THE COURSE OF CONSTRUCTION IT IS DETERMINED THAT THERE IS LESS THAN FOUR FEET OF COVER OVER THE TOP OF A MAIN LINE OR HOUSE LATERAL V.C.P. BETWEEN WHICH IS NOT INDICATED ON THE PLANS, THE PIPE SHALL BE ENCASED PER S-23, CASE II UNLESS OTHERWISE APPROVED BY THE COUNTY ENGINEER.
 11. ALL JOINTS BETWEEN CAST IRON PIPE AND INVERTED CLAY PIPE SHALL BE MADE WITH A RUBBER SLEEVE JOINT, TYPE "C" OR "T", WITH WASHING IF NECESSARY PER STANDARD SPECIFICATIONS SECTION 306-4.
 12. SEWERS TO BE TESTED FOR LEAKAGE PER SECTION 306-1.6 OF THE STANDARD SPECIFICATIONS AND SPECIAL PROVISIONS.
 13. REFLECTANCE ALL TRENCHES WITHIN PAVED AREAS TO MEET L.A. COUNTY ROAD DEPT. OR CALIFORNIA STATE HIGHWAY REQUIREMENTS IN ACCORDANCE WITH PERMITS.
 14. FULL COMPLIANCE WITH SECTION 306-1.8 OF THE SPECIAL PROVISIONS WILL BE REQUIRED FOR BACKFILL IN STREETS. CERTIFICATION OF BACKFILL COMPACTION AND SAND EQUIVALENTS BY A QUALIFIED, REGISTERED TESTING LABORATORY SHALL BE PROVIDED BY THE PERMITTEE PRIOR TO THE ISSUANCE OF A CERTIFICATE OF PARTIAL ACCEPTANCE.
 15. SPECIAL PROVISIONS IN RESPECT OF CONSTRUCTION:
 - a) SPECIAL TRENCH AND BACKFILL SHALL BE MADE SO AS TO AVOID THE REMOVAL OF FINISHED GRADES AND SLOPES SHOWN ON THE ORIGINAL PLAN APPROVED FOR THIS DEVELOPMENT BY THE BUILDING AND SAFETY DIVISION.
 - b) ALL BACKFILL AND SAND BACKFILL SHALL BE CONFINED TO A MINIMUM OF 10% OF MAXIMUM DENSITY PER AASHTO STANDARD METHOD OF TEST D95-111 AS MODIFIED ACCEPTABLE CERTIFICATIONS OF SUCH COMPLETION SHALL BE SUBMITTED TO THE DIVISION/INTEGRITY DOCUMENTATION SECTION.

THE FOLLOWING LATEST REVISED STANDARD PLANS ON FILE IN THE OFFICE OF THE COUNTY ENGINEER SHALL APPLY IN THE CONSTRUCTION OF THIS PROJECT.

LEGEND	.. 51
MINIMUM PUBLIC SAFETY REQUIREMENTS	.. 52
BRICK MANHOLE	.. 53
STANDARD MANHOLE STEP	.. 57
BRICKING FOR SEWER PIPE	.. 58
CHANGING AND ENCASING	.. 59
WYE OR TE SUPPORT	.. 60
ALLOWABLE TRENCH WIDTHS	.. 63
LOADING MANHOLE PLANS AND COVER	.. 65
NON-BEHIND PRECAST CONCRETE MANHOLE	.. 66

COUNTY OF LOS ANGELES, CALIFORNIA
 STEPHEN J. KOONCE, COUNTY ENGINEER
 APPROVED: *Walter E. Garrison* 4-9-81 DATE: 4/10/81
 OFFICE ENGINEER
 SANITATION DIVISION: SEWER MAINTENANCE
 APPROVED: *B.E. Scanlon* 4-9-81 DATE: 4-9-81
 REG. C.E. NO. 16993
 LOMITA BLDG. DIST. 12

BC 2218

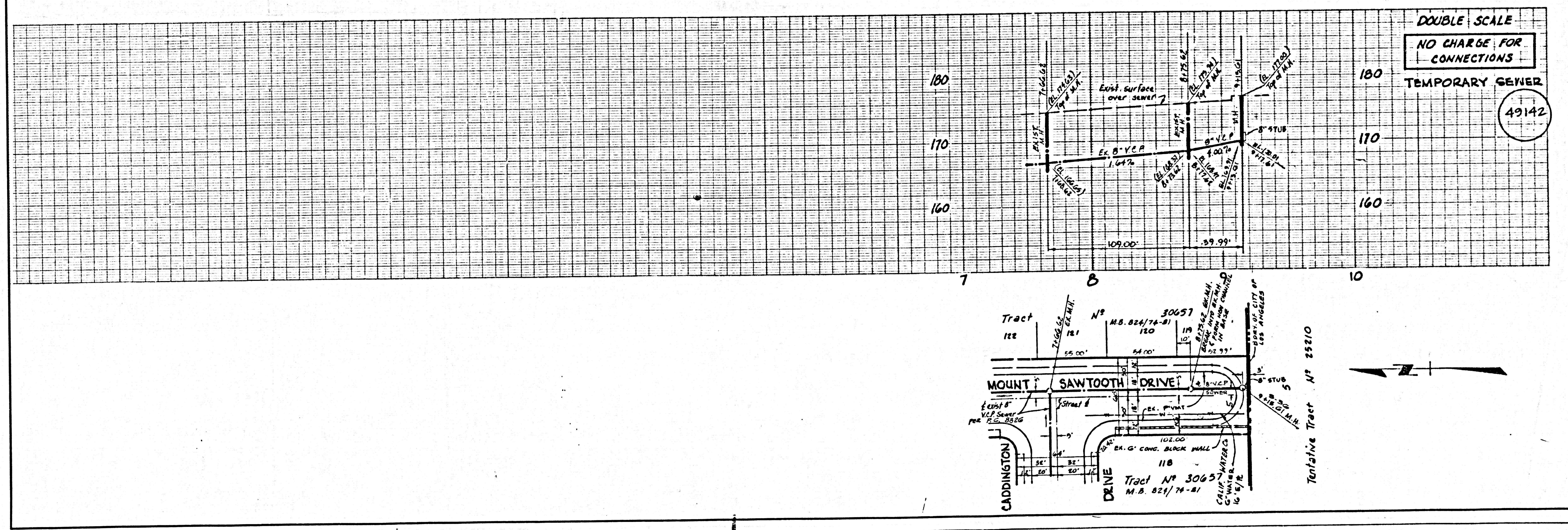

DOUBLE SCALE
 NO CHARGE FOR CONNECTIONS
 TEMPORARY SEWER
 49142