

B.M. CG 9932 ELEV. 895.964  
 LET IN EAST END C.B. 43 FT N.E.  
 96 FT W. OF E. INT. GRAND AVE. &  
 DIAMOND BAR BLVD. (M.K.D. S.M.C.-7)  
 OTTERBEIN QUAD. 1975

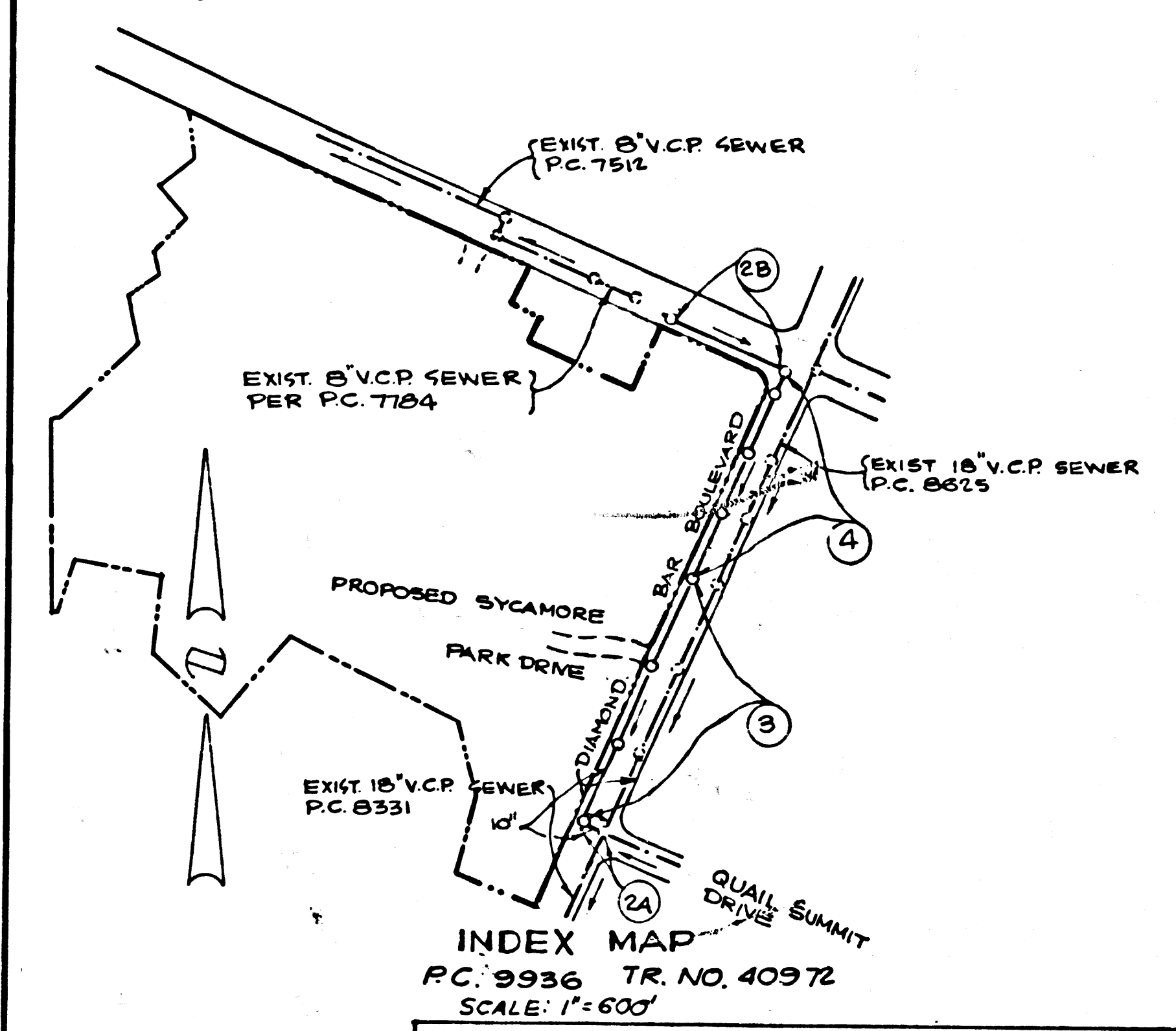

NOTE  
 NUMBERS IN CIRCLES INDICATE  
 PAGE NUMBERS.

REVISION NO. 4 DATE: 4-20-82  
 REVISED PAGE 25 A PLAN & PROFILE TO AVOID 16\"/>

**NO CONNECTIONS SHALL BE ALLOWED UNTIL THE PUMPS AND NECESSARY APPURTENANCES HAVE BEEN INSTALLED AND ARE FUNCTIONING IN THE FOUNTAIN SPRINGS PUMP STATION TO THE SATISFACTION OF THE COUNTY ENGINEER.**

REVISION NO. 1 DATE 9-2-81  
 PAGE 3 PLAN & PROFILE: MOVED M.H. FROM STA. 8+99.95 TO STA. 6+00.00; REVISED GRADES FROM STA. 1+00 TO STA. 3+64.40 TO 0.48% & CHANGED PIPE SIZE TO 10\"/>

REVISION NO. 2 DATE 10-21-81  
 IN ORDER TO AVOID GAS MAIN INTERFERENCE IT WAS NECESSARY TO REVISE PAGE 4 PLAN & PROFILE: MOVED MANHOLE FROM STA. 17+94.96 TO STA. 17+99.96, REVISED INVERT ELEVATION.  
 PAGE 28 REVISED MAIN LINE ALIGNMENT & INVERT ELEVATIONS

REVISION NO. 3 DATE 3-3-82  
 REVISED MAIN LINE GRADE DUE TO STORM DRAIN INTERFERENCE AT STA. 17+87.00 ADDED MANHOLE AT STA. 17+40.00 AND VERTICAL CURVE TO MAIN LINE ON PAGE 4; REVISED MAIN LINE GRADE AND ELIMINATED HOUSE LATERAL AT STA. 2+20 ON PAGE 2 B.

NO CONNECTION FOR THE DISPOSAL OF INDUSTRIAL WASTES SHALL BE MADE TO SEWERS SHOWN ON THESE DRAWINGS UNTIL A PERMIT FOR INDUSTRIAL WASTEWATER DISCHARGE HAS BEEN ISSUED BY THE SANITATION DISTRICTS FOR SAID CONNECTION.  
 BEFORE BREAKING INTO OR CONSTRUCTION ON A COUNTY SANITATION DISTRICT SEWER AND PRIOR TO FINAL ACCEPTANCE OF THE PROJECT, SANITATION DISTRICT INSPECTOR SHALL BE NOTIFIED BY PHONE 1-82-8665, 324-1143 OR WRITTEN, THE PROPOSITION PLAN BE MADE

- GENERAL NOTES:**
1. REVISIONS ARE IN PINK AND 812 C. & S. SEA LEVEL DATUM OF 1929.
  2. NO REVISIONS SHALL BE MADE IN THESE PLANS WITHOUT THE APPROVAL OF THE COUNTY ENGINEER.
  3. NO REPRESENTATIVE OF THE COUNTY ENGINEER WILL SURVEY OR LAY OUT ANY PORTION OF THE WORK.
  4. GRADES TO WHICH THIS IMPROVEMENT IS TO BE CONSTRUCTED ARE SHOWN ON PLANS AND PROFILES. GRADE POINTS FOR TOP OF CURB, CENTER LINE OF STREETS, OR CENTER LINE OF ALLEYS ARE SHOWN BY CIRCLES ON PROFILES. AT ALL POINTS BETWEEN DESIGNATED POINTS THE GRADE SHALL BE ESTABLISHED SO AS TO CONFORM TO A STRAIGHT LINE DRAWN BETWEEN SAID DESIGNATED POINTS.
  5. THE PRIVATE ENGINEER SHALL FURNISH THE COUNTY ENGINEER WITH GRADE SHEETS AND STATIONING FOR ALL HOUSE LATERALS AND 12\"/>

- CONSTRUCTION NOTES:**
1. WORK SHALL BE CONSTRUCTED ACCORDING TO THE STANDARD SPECIFICATIONS FOR PUBLIC WORKS CONSTRUCTION 1978 EDITION WITH 1982 SUPPLEMENT AND COUNTY ENGINEER SPECIAL PROVISIONS FOR THE CONSTRUCTION OF SANITARY SEWERS DATED SEPTEMBER 2, 1982 AND SHALL BE PROSECUTED ONLY IN THE PRESENCE OF THE COUNTY ENGINEER.
  2. THE CONTRACTOR SHALL NOTIFY THE ENVIRONMENTAL DEVELOPMENT DIVISION BY TELEPHONE (818) 798-2706 AT LEAST THIRTY-THREE HOURS BEFORE STARTING ANY HOUSE LATERAL OR MAIN LINE WORK.
  3. HOUSE LATERALS TO BE CONSTRUCTED WITH INVERTS AT PROPERTY LINE & FEET BELOW CURB GRADE EXCEPT AS NOTED.
  4. WYE OR TE BANCHES MAY BE USED FOR CONNECTIONS TO MAINLINE SEWERS EXCEPT AS NOTED.
  5. ALL STRUCTURES SHALL BE EITHER BRICK MANHOLES PER S-3 OR PRECAST CONCRETE MANHOLES PER S-3A, EXCEPT AS NOTED.
  6. PROVIDE STAKES ON THE PROPERTY LINE OR PROPERTY LINES PRODUCED AT RIGHT ANGLES TO THE SEWER LINE AT THE CENTER LINE OF EACH MANHOLE.
  7. MANHOLE TOPS IN UNIMPROVED RIGHTS OF WAY TO BE SIX INCHES ABOVE FINISHED GRADE.
  8. VITRIFIED CLAY PIPE JOINTS SHALL BE TYPE "B", OR "C" PER STANDARD SPECIFICATIONS SECTION 308-2.
  9. IF A POWER POLE IS WITHIN THREE FEET OF THE SEWER, THE SEWER SHALL BE ENCASED, PER S-23, CASE II, TWO FEET ON EACH SIDE FROM THE POINT OF INTERFERENCE.
  10. IF DURING THE COURSE OF CONSTRUCTION IT IS DETERMINED THAT THERE IS LESS THAN FOUR FEET OF COVER OVER THE TOP OF A MAIN LINE OR HOUSE LATERAL, V.C.P. SEWER WHICH IS NOT INDICATED ON THE PLANS, THE PIPE SHALL BE ENCASED PER S-23, CASE II UNLESS OTHERWISE APPROVED BY THE COUNTY ENGINEER.
  11. ALL JOINTS BETWEEN CAST IRON PIPE AND VITRIFIED CLAY PIPE SHALL BE MADE WITH A RUBBER SLEEVE JOINT, TYPE "C" OR "D", WITH GROMMETS IF NECESSARY PER STANDARD SPECIFICATIONS, SECTION 308-2.
  12. SEWERS TO BE TESTED FOR LEAKAGE PER SECTION 306-1.6 OF THE STANDARD SPECIFICATIONS AND SPECIAL PROVISIONS.
  13. REINFORCE ALL TRENCHES WITHIN PAVED AREAS TO MEET L.A. COUNTY ROAD DEPT. OR CALIFORNIA STATE HIGHWAY REQUIREMENTS IN ACCORDANCE WITH PERMITS.
  14. FULL COMPLIANCE WITH SECTION 306-1.5 OF THE SPECIAL PROVISIONS WILL BE REQUIRED FOR BACKFILL IN STREETS. CERTIFICATION OF BACKFILL COMPOSITION AND SAND EQUIVALENTS BY A QUALIFIED, REGISTERED TESTING LABORATORY SHALL BE PROVIDED BY THE PERMITTEE PRIOR TO THE ISSUANCE OF A CERTIFICATE OF PARTIAL ACCEPTANCE.

PROFILE, ALIGNMENT AND GRADE OF  
**SANITARY SEWERS**  
 TO BE CONSTRUCTED IN

**TRACT NO. 40972**  
 PRIVATE CONTRACT NO. 9936

W.S. 99-C-3  
 2 SHEETS, 4 PAGES  
 SCALE: VERT. 1"=4' HORIZ. 1"=40'  
 DECEMBER, 1980  
 PREPARED IN THE OFFICES OF  
**MADOLE AND ASSOCIATES, INC.**  
 180 E. 16TH STREET SANTA ANA CA 92701  
 PHONE (714) 836-1648  
 REG. C. E. NO. 14814

THE FOLLOWING LATEST REVISED STANDARD PLANS ON FILE IN THE OFFICE OF THE COUNTY ENGINEER SHALL APPLY IN THE CONSTRUCTION OF THIS PROJECT.

|   |      |
|---|------|
| LEGEND                                  | 8-1  |
| MINIMUM PUBLIC SAFETY REQUIREMENTS      | 8-2  |
| BRICK MANHOLE                           | 8-3  |
| STANDARD MANHOLE STEP                   | 8-4  |
| BEDDING FOR SEWER PIPE                  | 8-5  |
| CRADLING AND ENCASEMENT                 | 8-6  |
| WYE OR TE BANCH                         | 8-7  |
| ALLOWABLE TRENCH WIDTHS                 | 8-8  |
| LOCKING MANHOLE FRAME AND COVER         | 8-9  |
| NON-REINFORCED PRECAST CONCRETE MANHOLE | 8-10 |
| SPECIAL HOUSE LATERALS                  | 8-11 |

COUNTY OF LOS ANGELES, CALIFORNIA  
 STEPHEN J. KOONCE, COUNTY ENGINEER, WALTER G. GAZERSON, CHIEF ENGINEER  
 CO. SAN DIST. NO. 51  
 APPROVED: *John Miller* 5/4/81 APPROVED: *John Miller* 5/1/81  
 SAN DIMAS REGIONAL ENGINEER DATE JOE OFFICE ENGINEER  
 CHECKED: *Ralph David Leist* 5/1/81 DATE  
 REG. CE. NO. 16883  
 SAN DIMAS BLDG. DIST. 1000

