

B.M. CL 3825 ELEV. 1296.147
 LACS BM MON IN NE COR CONC BASE CITY OF
 LA W & P TOWER 1/4 1/4 150 FT W BOUQUET CYN
 RD 60 MI NWLY CL SUSAN BETH WAY MKD.
 (DM 204-71966)
 NEWHALL QUAD. 19 78

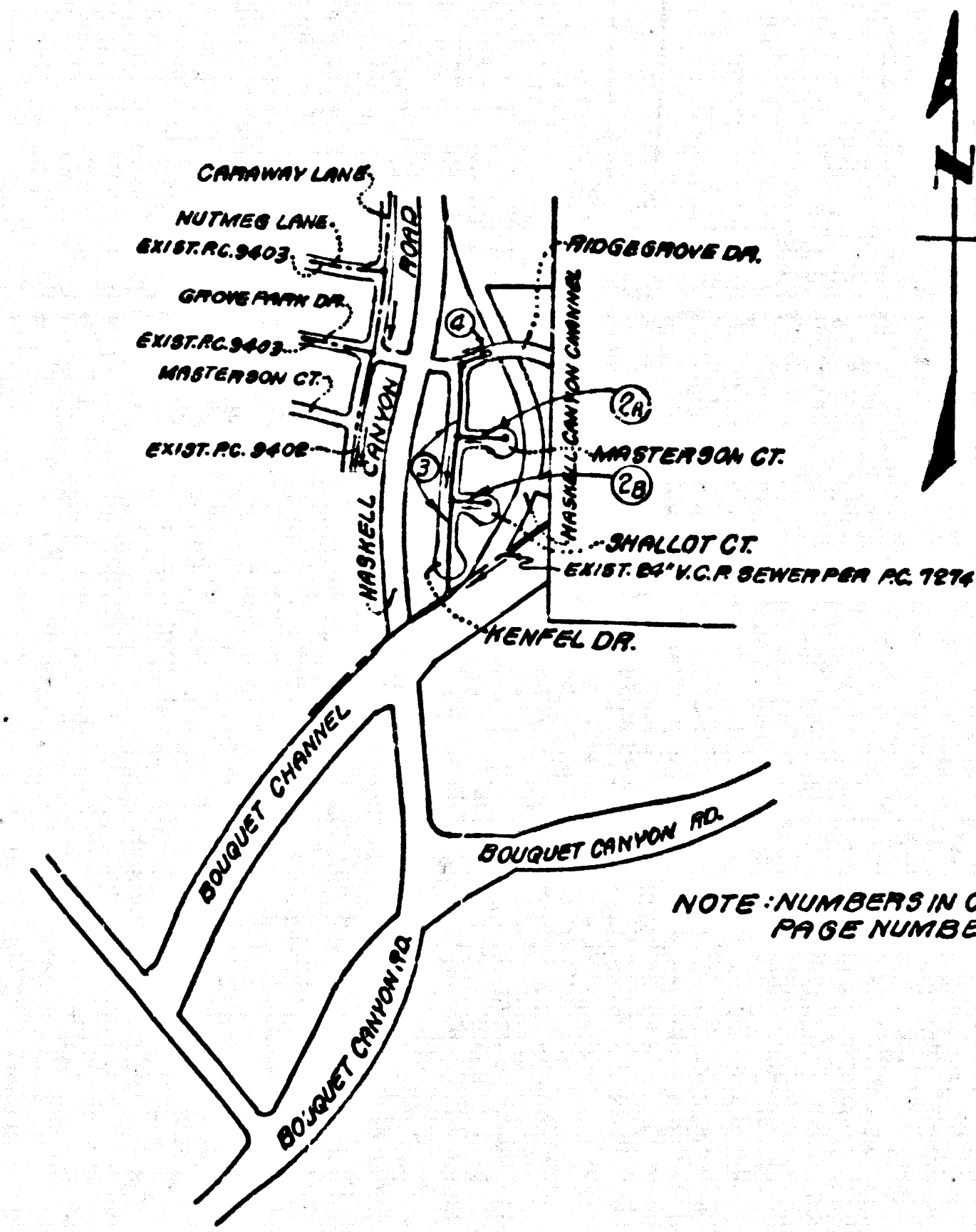

INDEX MAP
 TRACT No. 36334
 P.C. 9939
 SCALE: 1" = 600'

NO CONNECTION FOR THE DISPOSAL OF INDUSTRIAL WASTES SHALL BE MADE TO SEWERS SHOWN ON THESE DRAWINGS UNTIL A PERMIT FOR INDUSTRIAL WASTEWATER DISCHARGE HAS BEEN ISSUED BY THE SANITATION DISTRICTS FOR SAID CONNECTION.

BEFORE BREAKING INTO OR CONSTRUCTION OF A COUNTY SANITATION DISTRICT SEWER AND PRIOR TO FINAL ACCEPTANCE OF THE PROJECT, SANITATION DISTRICT INSPECTOR SHALL BE NOTIFIED BY PHONE (213) 485-8879, (213) 485-2382 SO THAT REQUIRED INSPECTION CAN BE MADE.

THE EXISTENCE AND LOCATION OF ANY UNDERGROUND UTILITY PIPES OR STRUCTURES SHOWN ON THESE PLANS ARE OBTAINED BY A SEARCH OF THE AVAILABLE RECORDS. TO THE BEST OF OUR KNOWLEDGE THERE ARE NO EXISTING UTILITIES EXCEPT AS SHOWN ON THIS MAP. THE CONTRACTOR IS REQUIRED TO TAKE PRECAUTIONARY MEASURES TO PROTECT THE UTILITY LINES SHOWN AND ANY OTHER LINES NOT OF RECORD OR NOT SHOWN ON THIS DRAWING.

Robert T. Quinn
 R.C.E. 4988

GENERAL NOTES:

1. ELEVATIONS ARE IN FEET ABOVE U.S.C. & G.S. SEA LEVEL DATUM OF 1929.
2. NO REVISIONS SHALL BE MADE IN THESE PLANS WITHOUT THE APPROVAL OF THE COUNTY ENGINEER.
3. NO REPRESENTATIVE OF THE COUNTY ENGINEER WILL SURVEY OR LAY OUT ANY PORTION OF THE WORK.
4. GRADES TO WHICH THIS IMPROVEMENT IS TO BE CONSTRUCTED ARE SHOWN ON PLANS AND HOUSE GRADE POINTS FOR TOP OF CURB, CENTER LINE OF STREET, OR CENTER LINE OF ALLEY ARE SHOWN BY CIRCLES ON PLANS. AT ALL POINTS BETWEEN DESIGNATED POINTS THE GRADE SHALL BE ESTABLISHED SO AS TO CONFORM TO A STRAIGHT LINE DRAWN BETWEEN SAID DESIGNATED POINTS.
5. THE PRIVATE ENGINEER SHALL FURNISH THE COUNTY ENGINEER WITH GRADE SHEETS AND STATIONING FOR ALL HOUSE LATERALS AND "T" OR "T" BRANCHES AND SHALL PROVIDE STAKES FOR THEM AT THEIR PROPER LOCATIONS WITH STATIONING PLAINLY MARKED. ALL HOUSE LATERALS SHALL BE CONSTRUCTED IN A STRAIGHT ALIGNMENT AT RIGHT ANGLES FROM THE MAIN LINE SEWER EXCEPT AS SHOWN ON THE PLANS. HOUSE LATERALS FROM CURBS SHALL NOT HAVE AN ANGLE OF 1/4" FROM 45" WITH THE MAIN LINE SEWER. ANY CHANGE IN ALIGNMENT SHALL BE REQUESTED IN WRITING BY THE PRIVATE ENGINEER.
6. THE PRIVATE ENGINEER SHALL FURNISH THE HOUSE LATERAL DEPTH AT THE PROPERTY LINE BELOW THE TOP OF CURB ELEVATION FOR EACH HOUSE LATERAL ON THE GRADE SHEET.
7. BEFORE WORK CAN BE STARTED, THE CONTRACTOR MUST OBTAIN A PERMIT TO EXCAVATE IN COUNTY STREETS FROM THE L.A. COUNTY ROAD DEPT., DISTRICT OFFICE NO. 8, AND PAY A FEE TO THE COUNTY ENGINEER, 800 W. PETERSON AVENUE, LOS ANGELES TO COVER THE COST OF CONSTRUCTION INSPECTION AND RECORD PLANS.
8. IF WORK IS TO BE DONE IN A STATE HIGHWAY, A PERMIT MUST BE OBTAINED FROM THE STATE OF CALIFORNIA, DIVISION OF HIGHWAYS, 120 SOUTH SPRING STREET, LOS ANGELES, CALIFORNIA.
9. APPROVAL OF THIS PLAN BY THE COUNTY OF LOS ANGELES DOES NOT CONSTITUTE AN REPRESENTATION AS TO THE ACCURACY OF THE LOCATION OF OR THE EXISTENCE OR NON-EXISTENCE OF ANY UNDERGROUND UTILITY PIPE, OR STRUCTURE WITHIN THE LIMITS OF THIS PROJECT. THE NOTE APPLIES TO ALL PAGES.
10. REFER TO SECTION 2.06.1 OF THE STANDARD SPECIFICATIONS, REGARDING SAFETY CHECKS.
11. PRIOR TO ISSUANCE OF THE PERMIT, SEWER CONNECTION PERMIT, THE CONTRACTOR SHALL OBTAIN AND FILE WITH THE COUNTY ENGINEER COPIES OF A PERMIT TO EXCAVATE IN COUNTY STREETS FROM THE L.A. COUNTY ROAD DEPT., DISTRICT OFFICE NO. 8, AND PAY A FEE TO THE COUNTY ENGINEER, 800 W. PETERSON AVENUE, LOS ANGELES TO COVER THE COST OF CONSTRUCTION INSPECTION AND RECORD PLANS.

PROFILE, ALIGNMENT AND GRADE OF
SANITARY SEWERS PAGE 1
 TO BE CONSTRUCTED IN
TRACT No. 36334

PRIVATE CONTRACT NO. 9939
 W.S. 62
 2 SHEETS, 4 PAGES (49835)
 SCALE: VERT. 1" = 4' HORIZ. 1" = 40'
 DATE: FEBRUARY, 1981
 PREPARED IN THE OFFICES OF
 F.L. PEARSON & ASSOCIATES
 1555 W. REDONDO BEACH BLVD., GARDENA, CALIF. 90247
 BY: Robert T. Quinn
 REG. C. E. No. 44988

CONSTRUCTION NOTES:

1. WORK SHALL BE CONSTRUCTED ACCORDING TO THE STANDARD SPECIFICATIONS FOR PUBLIC WORKS CONSTRUCTION (1978 EDITION) WITH THE SUPPLEMENTS AND COUNTY ENGINEER SPECIAL PROVISIONS FOR THE CONSTRUCTION OF SANITARY SEWERS (1978 EDITION) AND SHALL BE PROSECUTED ONLY IN THE PRESENCE OF THE COUNTY ENGINEER.
2. THE CONTRACTOR SHALL NOTIFY THE ENVIRONMENTAL DEVELOPMENT DIVISION BY PHONE (213) 485-8879 AT LEAST TWENTY-FOUR HOURS BEFORE BEGINNING ANY WORK UNDER THIS CONTRACT.
3. HOUSE LATERALS TO BE CONSTRUCTED WITH INVERTS AT PROPERTY LINE 4 FEET BELOW CURB GRADE EXCEPT AS NOTED.
4. WYE OR TE BRANCHES MAY BE USED FOR CONNECTIONS TO MAINLINE SEWERS EXCEPT AS NOTED.
5. ALL STRUCTURES SHALL BE EITHER BRICK MANHOLES PER L.A. OR PRECAST CONCRETE MANHOLES PER S. 26, EXCEPT AS NOTED.
6. PROPERTY STAKES ON THE PROPERTY LINE OR PROPERTY LINES PRODUCED AT RIGHT ANGLES TO THE SEWER LINE AT THE CENTER LINE OF EACH MANHOLE.
7. MANHOLES TOPS IN UNIMPROVED RIGHTS OF WAY TO BE 4 INCHES ABOVE FINISHED GRADE.
8. WITHIN CLAY PIPE JOINTS SHALL BE 1/2" OR 3/4" PER THE STANDARD SPECIFICATIONS SECTION 280-8.
9. IF A POWER POLE IS WITHIN THREE FEET OF THE SEWER, THE SEWER SHALL BE ENCASED, PER S. 25, CASE II, TWO FEET ON EACH SIDE FROM THE POINT OF INTERFERENCE.
10. IF DURING THE COURSE OF CONSTRUCTION IT IS DETERMINED THAT THERE IS LESS THAN FOUR FEET OF COVER OVER THE TOP OF A MAIN LINE HOUSE LATERAL OR SEWER WHICH IS NOT INDICATED ON THE PLANS, THE PIPE SHALL BE ENCASED PER S. 25, CASE II UNLESS OTHERWISE APPROVED BY THE COUNTY ENGINEER.
11. ALL JOINTS BETWEEN CAST IRON PIPE AND STEEL PIPE SHALL BE MADE WITH A RUBBER GASKET JOINT, TYPE "C" OR "D", WITH GASKETS AS NECESSARY TO MEET THE STANDARD SPECIFICATIONS, SECTION 280-8.
12. SEWERS TO BE TESTED FOR LEAKAGE PER SECTION 280-14. ON THE STANDARD SPECIFICATIONS AND SPECIAL PROVISIONS.
13. RESURFACE ALL TRENCHES WITHIN PAVED AREAS TO MEET L.A. COUNTY ROAD DEPT. OR CALIFORNIA STATE HIGHWAY REQUIREMENTS IN ACCORDANCE WITH PERMITS.
14. FULL COMPLIANCE WITH SECTION 280-1.5 OF THE SPECIAL PROVISIONS WILL BE REQUIRED FOR BACKFILL IN STREETS. CERTIFICATION OF BACKFILL COMPACTION AND SAND EQUIVALENT BY A QUALIFIED, REGISTERED TESTING LABORATORY SHALL BE PROVIDED BY THE PERMITTEE PRIOR TO THE ISSUANCE OF A CERTIFICATE OF PARTIAL ACCEPTANCE.
15. SPECIAL BACKFILL IN UNIMPROVED CONSTRUCTION ON BACKFILL, TRENCH AND REPLACE OTHER BACKFILLS AS TO EXISTING THE MATERIAL OF FILL AND SAND EQUIVALENT SHALL BE IN ACCORDANCE WITH THE SPECIAL PROVISIONS FOR THIS DATE. APPROVED BY THE BUILDING DEPARTMENT. THE CONTRACTOR SHALL SUBMIT TO THE COUNTY ENGINEER, 800 W. PETERSON AVENUE, LOS ANGELES, CALIF. 90012, A COPY OF THE SPECIAL PROVISIONS FOR THIS DATE. APPROVED BY THE BUILDING DEPARTMENT. THE CONTRACTOR SHALL SUBMIT TO THE COUNTY ENGINEER, 800 W. PETERSON AVENUE, LOS ANGELES, CALIF. 90012, A COPY OF THE SPECIAL PROVISIONS FOR THIS DATE. APPROVED BY THE BUILDING DEPARTMENT. THE CONTRACTOR SHALL SUBMIT TO THE COUNTY ENGINEER, 800 W. PETERSON AVENUE, LOS ANGELES, CALIF. 90012, A COPY OF THE SPECIAL PROVISIONS FOR THIS DATE.

THE FOLLOWING LATEST EDITION STANDARD PLANS ON FILE IN THE OFFICE OF THE COUNTY ENGINEER SHALL APPLY IN THE CONSTRUCTION OF THIS PROJECT:

LEGEND	5-1
MINIMUM PUBLIC SAFETY REQUIREMENTS	5-2
BRICK MANHOLES	5-3
STANDARD MANHOLE STEP	5-7
SEWERING FOR SEWER PIPE	5-8
CRACKING AND INCASING	5-9
WYE ON THE SUPPORT	5-10
ALLOY-STEEL TRENCH WITNESS	5-11
LOCKING MANHOLE PLANS AND COVERS	5-12
NON-REINFORCED PRECAST CONCRETE MANHOLE	5-13

COUNTY OF LOS ANGELES, CALIFORNIA
 STEPHEN J. HOONCE, COUNTY ENGINEER
 WALTER E. GARRISON, CHIEF ENGINEER
 APPROVED: Martin J. Magley 9/24/81
 APPROVED: Frank R. Davis 9/25/81
 CHECKED: Ralph Davis 9/24/81
 REG. C. E. NO. 16913
 SANTA CLARITA BLDG. DIST. 82

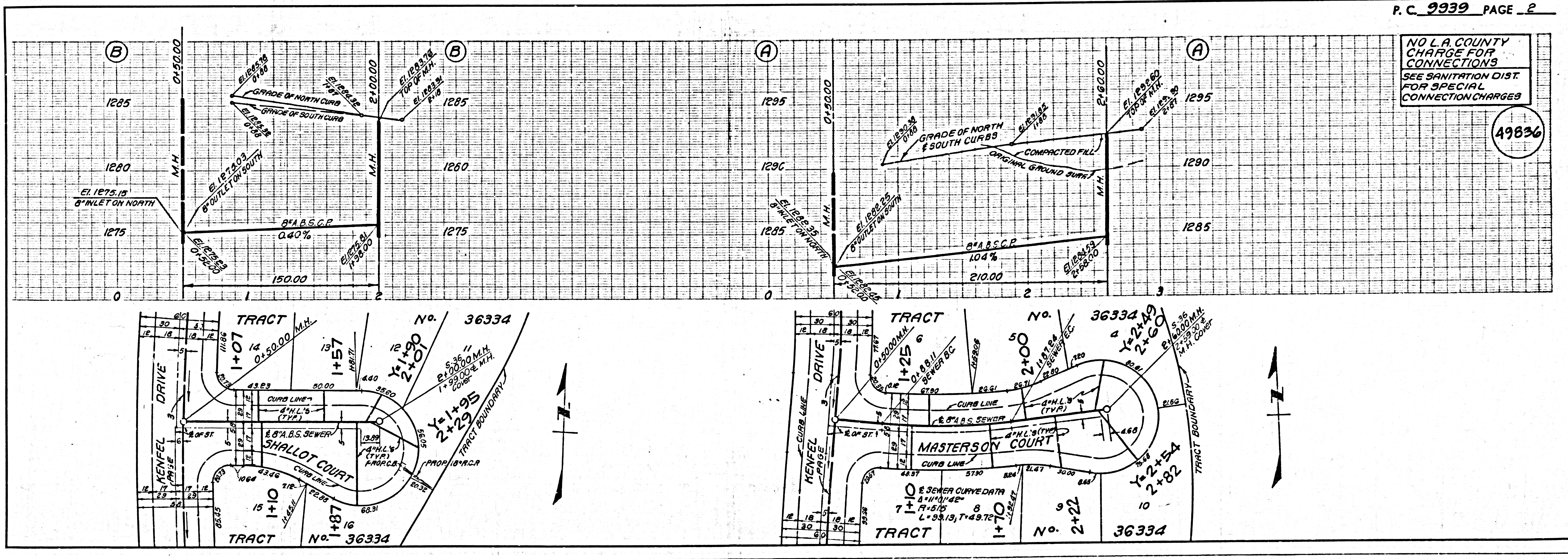

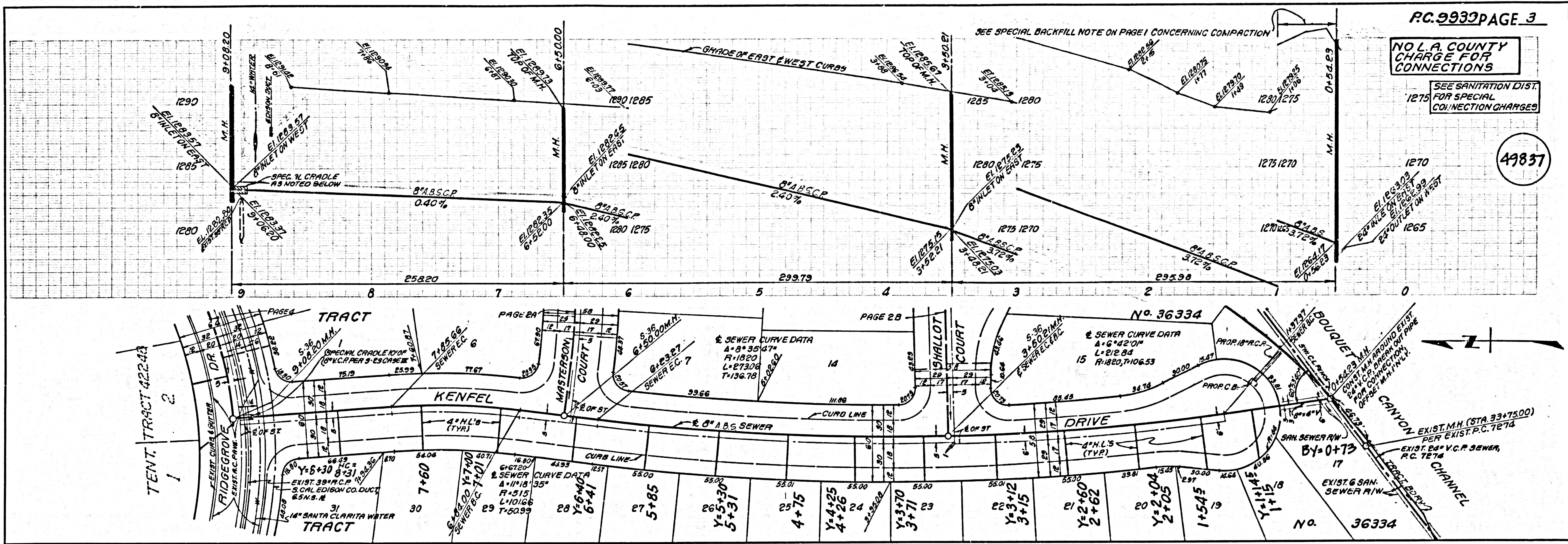

S
SEE 29 DECEMBER TRACT